

**This electronic collection of documents is provided
for the convenience of the user
and is Not a Certified Document –**

**The documents contained herein were originally issued
and sealed by the individuals whose names and license
numbers appear on each page, on the dates appearing
with their signature on that page.**

**This file or an individual page
shall not be considered a certified document.**

K:\RAL_Roadway\01036333 - U-5724 (Central Heights)Traffic-Pavement Marking and Signing\CADD\Pavement Marking Plans\U-5724_pmp_tshdgn

2/20/2020

T.I.P.: U-5724

STATE OF NORTH CAROLINA DEPARTMENT OF TRANSPORTATION

PAVEMENT MARKING PLAN WAYNE COUNTY

LOCATION: SR 1560 (ROYALL AVENUE) FROM (NORTH PARK DRIVE) TO US 13 (BERKELEY BLVD) AND SR 1709 (CENTRAL HEIGHTS ROAD) FROM US 13 (BERKELEY BOULEVARD) TO SR 1711 (OAK FOREST ROAD)

TIP NO. SHEET NO. U-5724 PMP-1 APPROVED: DATE: SEAL NORTH CAROLINA PROFESSIONAL ENGINEER JASON D. LAWING 032615 9/1/2022 DOCUMENT NOT CONSIDERED FINAL UNLESS ALL SIGNATURES COMPLETED

INDEX

Table with 2 columns: SHEET NO., DESCRIPTION. Rows include PMP-1 (PAVEMENT MARKING PLAN TITLE AND SCHEDULE SHEET) and PMP-2 THRU PMP-9 (PAVEMENT MARKING DETAIL).

ROADWAY STANDARD DRAWING

THE FOLLOWING ROADWAY STANDARDS AS APPEAR IN "ROADWAY STANDARD DRAWINGS" - PROJECT SERVICES UNIT - N.C. DEPARTMENT OF TRANSPORTATION - RALEIGH, N.C., DATED JANUARY 2018 ARE APPLICABLE TO THIS PROJECT AND BY REFERENCE HEREBY ARE CONSIDERED A PART OF THESE PLANS:

Table with 2 columns: STD. NO., TITLE. Lists standards for pavement markings, raised pavement markers, and object markers.

PAVEMENT MARKING SCHEDULE

Table with 2 columns: SYMBOL, DESCRIPTION. Lists symbols (T1, T2, T8, T9, TA, TB, TC, TD, TE, TF, TH, TI, TK, TL, TP, TQ, UA, UB, UC, UD, UE, UI, MA, MB) and their corresponding pavement marking descriptions.

GENERAL NOTES

- THE FOLLOWING GENERAL NOTES APPLY AT ALL TIMES FOR THE DURATION OF THE CONSTRUCTION PROJECT, EXCEPT WHEN OTHERWISE NOTED IN THE PLAN, OR DIRECTED BY THE ENGINEER. A) INSTALL PAVEMENT MARKINGS ON THE FINAL SURFACE AS FOLLOWS: B) TIE PROPOSED PAVEMENT MARKING LINES TO EXISTING PAVEMENT MARKING LINES. C) REMOVE/REPLACE ANY CONFLICTING/DAMAGED PAVEMENT MARKINGS AND MARKERS PER NCDOT STANDARD SPECIFICATIONS. D) STOP BAR LOCATION AT NON-SIGNALIZED INTERSECTIONS MAY BE ADJUSTED AS DIRECTED BY THE ENGINEER. E) UNLESS OTHERWISE SPECIFIED, HEATED-IN-PLACE THERMOPLASTIC MAY BE USED IN LIEU OF EXTRUDED THERMOPLASTIC FOR ARROWS, STOP BARS, SYMBOLS, CHARACTERS AND DIAGONALS. F) SEE ROADWAY PLANS FOR ALTERNATE CURB RAMP DESIGNS WHEN INDICATED ON PAVEMENT MARKING DETAIL SHEETS.

PLAN REVIEWED BY: N.C.D.O.T. SIGNING AND DELINEATION UNIT

A. ALQUDWAH, P.E. SIGNING & DELINEATION REGIONAL ENGINEER M. TRACEY, P.E. SIGNING & DELINEATION PROJECT DESIGN ENGINEER

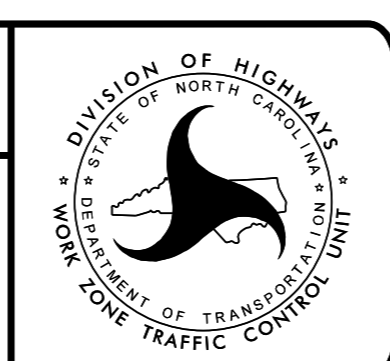

PLAN PREPARED BY: Kimley-Horn and Associates

Jason Lawing P.E. PROJECT DESIGN ENGINEER Elizabeth Lynch P.E. DESIGNER



PROJECT REFERENCE NO. U-5724	SHEET NO. PMP-2
R/W SHEET NO.	
ROADWAY DESIGN ENGINEER	
DOCUMENT NOT CONSIDERED FINAL UNLESS ALL SIGNATURES COMPLETED	

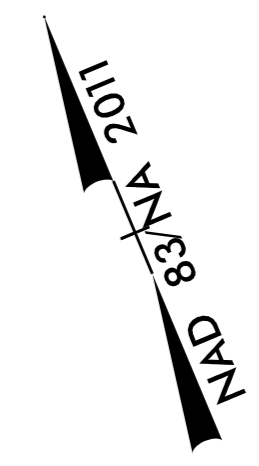

REVISIONS

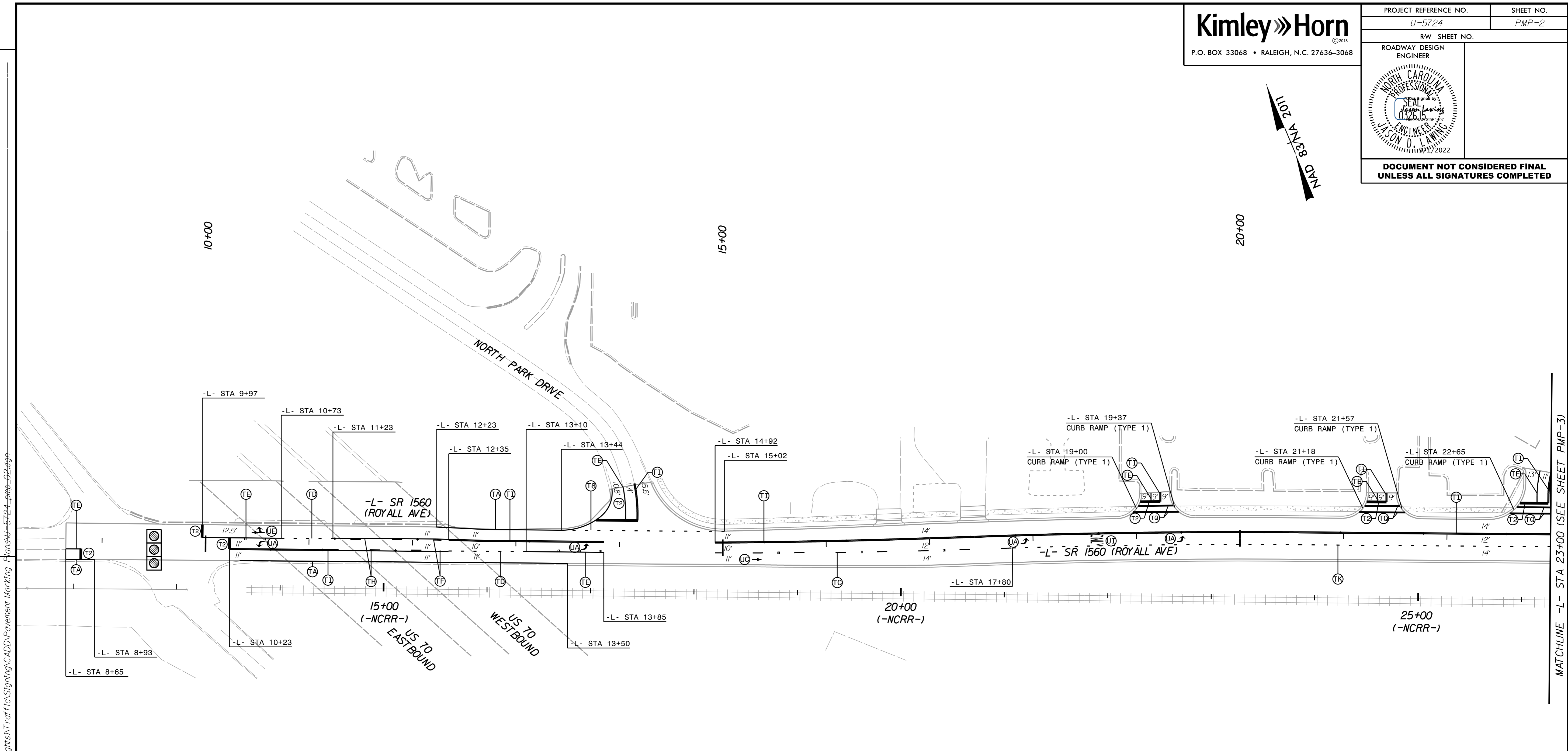

K:\RAL_Roadway\01036333 - U-5724 (Central Heights)\Traffic\Signing\CADD\Pavement Marking Plans\U-5724_pmp-02.dgn

2/20/2020

MATCHLINE -L- STA 23+00 (SEE SHEET PMP-3)

DENOTES SIGNALIZED INTERSECTION

PAVEMENT MARKER LEGEND

	- CRYSTAL / RED PAVEMENT MARKER
	- YELLOW / YELLOW PAVEMENT MARKER

PAVEMENT MARKING LINES

TA - THERMOPLASTIC (4" WHITE, 90 MILS)	EDGE LINE
TB - THERMOPLASTIC (4" YELLOW, 90 MILS)	EDGE LINE
TC - THERMOPLASTIC (4" WHITE, 90 MILS)	10' SKIP
TD - THERMOPLASTIC (4" WHITE, 90 MILS)	3' x 9'/SP MINI-SKIP
TE - THERMOPLASTIC (4" WHITE, 90 MILS)	SOLID LANE LINE
TF - THERMOPLASTIC (4" YELLOW, 90 MILS)	10' SKIP
TH - THERMOPLASTIC (4" YELLOW, 90 MILS)	SINGLE CENTER LINE
TI - THERMOPLASTIC (4" YELLOW, 90 MILS)	DOUBLE CENTER LINE
TK - THERMOPLASTIC (6" WHITE, 90 MILS)	3' x 9'/SP MINI-SKIP
TL - THERMOPLASTIC (6" WHITE, 90 MILS)	SOLID LANE LINE
TP - THERMOPLASTIC (8" YELLOW, 90 MILS)	DIAGONAL LINE
TQ - THERMOPLASTIC (8" WHITE, 90 MILS)	CROSSWALK LINE
T1 - THERMOPLASTIC (16" WHITE, 90 MILS)	RR X
T2 - THERMOPLASTIC (24" WHITE, 90 MILS)	STOP BAR
T8 - THERMOPLASTIC (4" WHITE, 90 MILS)	2'-6"/SP MINI-SKIP
T9 - THERMOPLASTIC (4" YELLOW, 90 MILS)	2'-6"/SP MINI-SKIP

PAVEMENT MARKING SYMBOLS/CHARACTERS

UA - THERMOPLASTIC (WHITE, 90 MILS)	LEFT TURN ARROW
UB - THERMOPLASTIC (WHITE, 90 MILS)	RIGHT TURN ARROW
UC - THERMOPLASTIC (WHITE, 90 MILS)	STRAIGHT ARROW
UD - THERMOPLASTIC (WHITE, 90 MILS)	COMBO LEFT/STRAIGHT ARROW
UE - THERMOPLASTIC (WHITE, 90 MILS)	COMBO RIGHT/STRAIGHT ARROW
UI - THERMOPLASTIC (WHITE, 90 MILS)	ALPHANUMERIC CHARACTER

PROJECT REFERENCE NO. U-5724	SHEET NO. PMP-3
RW SHEET NO.	
ROADWAY DESIGN ENGINEER	
DOCUMENT NOT CONSIDERED FINAL UNLESS ALL SIGNATURES COMPLETED	

REVISIONS

K:\RAL_Roadway\01035333 - U-5724 (Central Heights)NTrafficSigning\CADD\Pavement Marking Plans\U-5724-pmp-03.dgn
10/11/2022

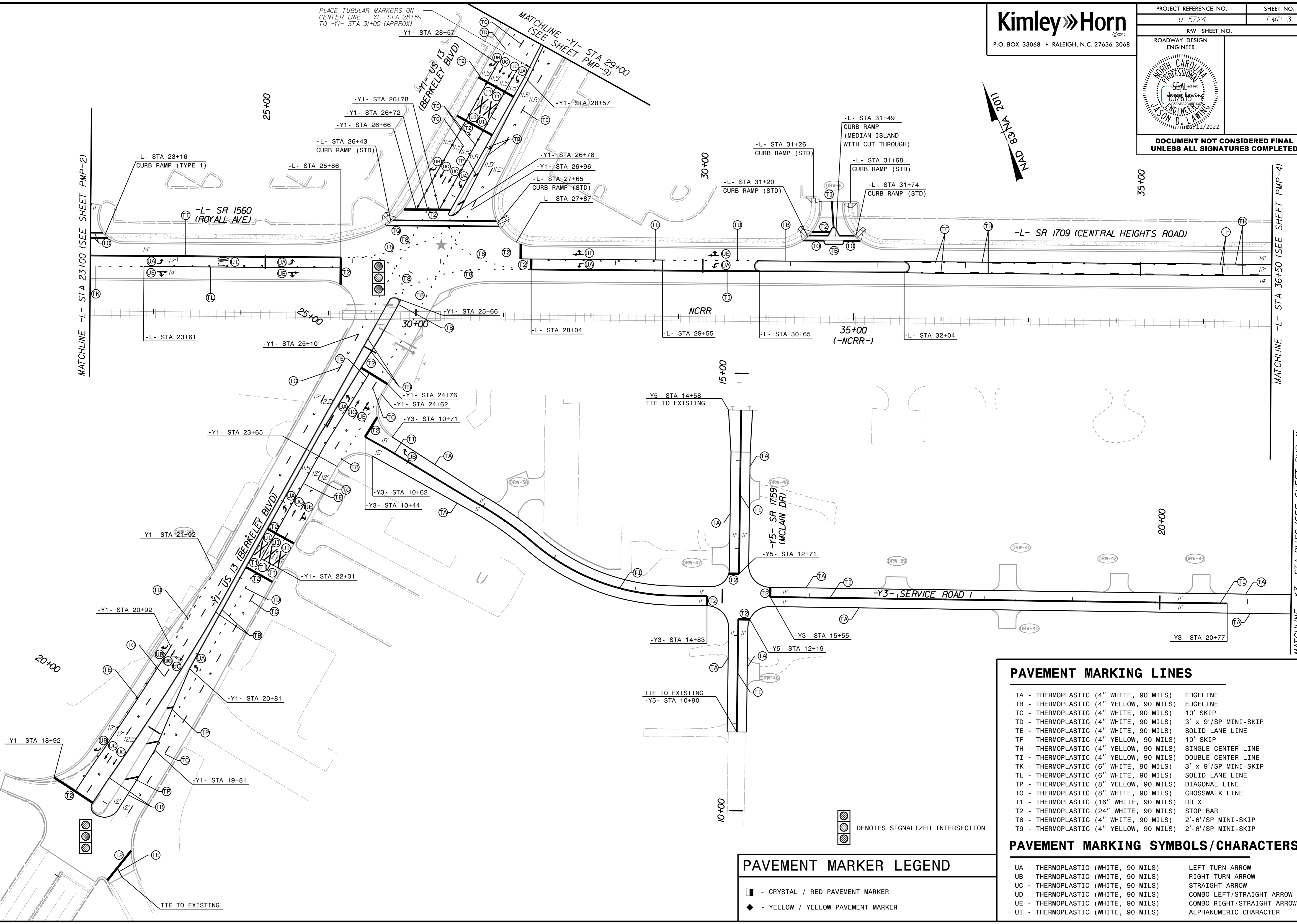

PAVEMENT MARKING LINES	
TA - THERMOPLASTIC (4" WHITE, 90 MILS)	EDGE LINE
TB - THERMOPLASTIC (4" YELLOW, 90 MILS)	EDGE LINE
TC - THERMOPLASTIC (4" WHITE, 90 MILS)	10' SKIP
TD - THERMOPLASTIC (4" WHITE, 90 MILS)	3' x 9'/SP MINI-SKIP
TE - THERMOPLASTIC (4" WHITE, 90 MILS)	SOLID LANE LINE
TF - THERMOPLASTIC (4" YELLOW, 90 MILS)	10' SKIP
TH - THERMOPLASTIC (4" YELLOW, 90 MILS)	SINGLE CENTER LINE
TI - THERMOPLASTIC (4" YELLOW, 90 MILS)	DOUBLE CENTER LINE
TK - THERMOPLASTIC (6" WHITE, 90 MILS)	3' x 9'/SP MINI-SKIP
TL - THERMOPLASTIC (6" WHITE, 90 MILS)	SOLID LANE LINE
TP - THERMOPLASTIC (8" YELLOW, 90 MILS)	DIAGONAL LINE
TQ - THERMOPLASTIC (8" WHITE, 90 MILS)	CROSSWALK LINE
TR - THERMOPLASTIC (16" WHITE, 90 MILS)	RR X
TS - THERMOPLASTIC (24" WHITE, 90 MILS)	STOP BAR
TU - THERMOPLASTIC (4" YELLOW, 90 MILS)	2'-6"/SP MINI-SKIP
T9 - THERMOPLASTIC (4" YELLOW, 90 MILS)	2'-6"/SP MINI-SKIP

PAVEMENT MARKING SYMBOLS/CHARACTERS	
UA - THERMOPLASTIC (WHITE, 90 MILS)	LEFT TURN ARROW
UB - THERMOPLASTIC (WHITE, 90 MILS)	RIGHT TURN ARROW
UC - THERMOPLASTIC (WHITE, 90 MILS)	STRAIGHT ARROW
UD - THERMOPLASTIC (WHITE, 90 MILS)	COMBO LEFT/STRAIGHT ARROW
UE - THERMOPLASTIC (WHITE, 90 MILS)	COMBO RIGHT/STRAIGHT ARROW
UI - THERMOPLASTIC (WHITE, 90 MILS)	ALPHANUMERIC CHARACTER

PAVEMENT MARKER LEGEND	
■ - CRYSTAL / RED PAVEMENT MARKER	
◆ - YELLOW / YELLOW PAVEMENT MARKER	

⦿ ⦿ ⦿ DENOTES SIGNALIZED INTERSECTION

PROJECT REFERENCE NO. U-5724	SHEET NO. PMP-4
R/W SHEET NO.	
ROADWAY DESIGN ENGINEER	
DOCUMENT NOT CONSIDERED FINAL UNLESS ALL SIGNATURES COMPLETED	



REVISIONS

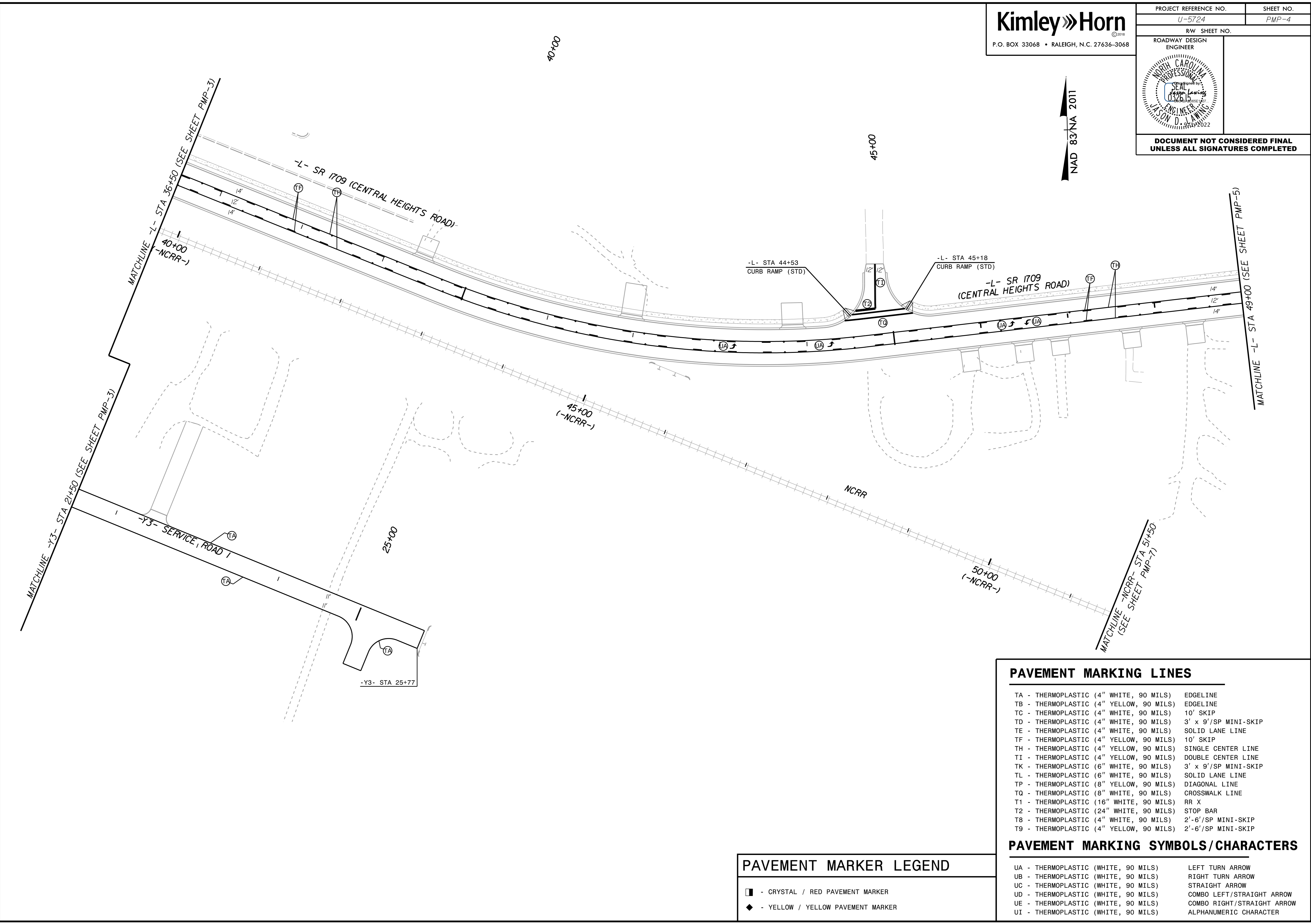

■	- CRYSTAL / RED PAVEMENT MARKER
◆	- YELLOW / YELLOW PAVEMENT MARKER

TA - THERMOPLASTIC (4" WHITE, 90 MILS)	EDGE LINE
TB - THERMOPLASTIC (4" YELLOW, 90 MILS)	EDGE LINE
TC - THERMOPLASTIC (4" WHITE, 90 MILS)	10' SKIP
TD - THERMOPLASTIC (4" WHITE, 90 MILS)	3' x 9'/SP MINI-SKIP
TE - THERMOPLASTIC (4" WHITE, 90 MILS)	SOLID LANE LINE
TF - THERMOPLASTIC (4" YELLOW, 90 MILS)	10' SKIP
TH - THERMOPLASTIC (4" YELLOW, 90 MILS)	SINGLE CENTER LINE
TI - THERMOPLASTIC (4" YELLOW, 90 MILS)	DOUBLE CENTER LINE
TK - THERMOPLASTIC (6" WHITE, 90 MILS)	3' x 9'/SP MINI-SKIP
TL - THERMOPLASTIC (6" WHITE, 90 MILS)	SOLID LANE LINE
TP - THERMOPLASTIC (8" YELLOW, 90 MILS)	DIAGONAL LINE
TQ - THERMOPLASTIC (8" WHITE, 90 MILS)	CROSSWALK LINE
T1 - THERMOPLASTIC (16" WHITE, 90 MILS)	RR X
T2 - THERMOPLASTIC (24" WHITE, 90 MILS)	STOP BAR
T8 - THERMOPLASTIC (4" WHITE, 90 MILS)	2'-6'/SP MINI-SKIP
T9 - THERMOPLASTIC (4" YELLOW, 90 MILS)	2'-6'/SP MINI-SKIP

UA - THERMOPLASTIC (WHITE, 90 MILS)	LEFT TURN ARROW
UB - THERMOPLASTIC (WHITE, 90 MILS)	RIGHT TURN ARROW
UC - THERMOPLASTIC (WHITE, 90 MILS)	STRAIGHT ARROW
UD - THERMOPLASTIC (WHITE, 90 MILS)	COMBO LEFT/STRAIGHT ARROW
UE - THERMOPLASTIC (WHITE, 90 MILS)	COMBO RIGHT/STRAIGHT ARROW
UI - THERMOPLASTIC (WHITE, 90 MILS)	ALPHANUMERIC CHARACTER

K:\RAL_Roadway\01036333 - U-5724 (Central Heights)\Traffic\Signing\CADD\Pavement Marking Plans\U-5724_pmp-04.dgn

2/20/2020

PROJECT REFERENCE NO. U-5724	SHEET NO. PMP-5
R/W SHEET NO.	
ROADWAY DESIGN ENGINEER	
DOCUMENT NOT CONSIDERED FINAL UNLESS ALL SIGNATURES COMPLETED	

NAD 83/NA 2011

REVISIONS

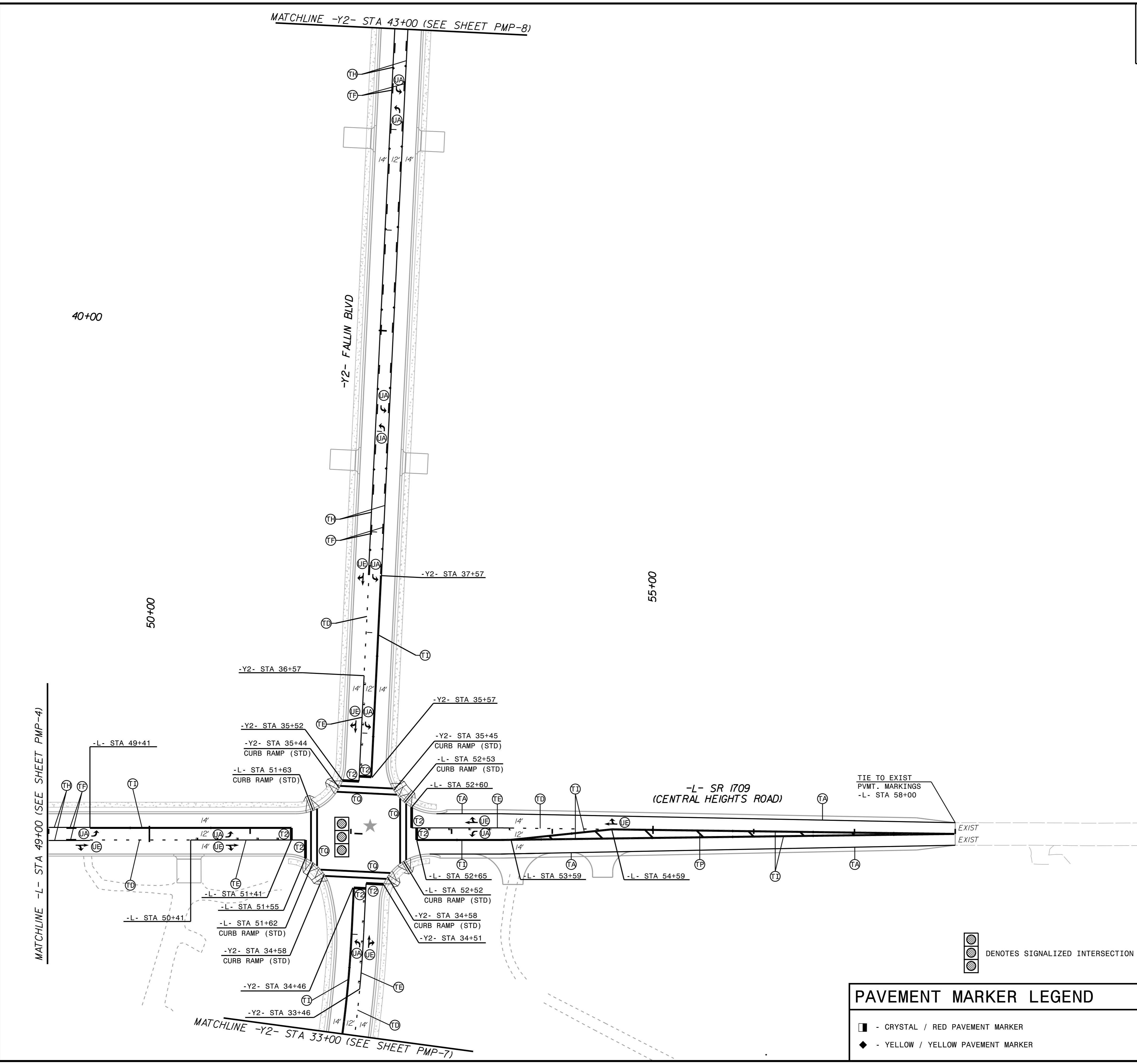

PAVEMENT MARKING LINES	
TA - THERMOPLASTIC (4" WHITE, 90 MILS)	EDGELINE
TB - THERMOPLASTIC (4" YELLOW, 90 MILS)	EDGELINE
TC - THERMOPLASTIC (4" WHITE, 90 MILS)	10' SKIP
TD - THERMOPLASTIC (4" WHITE, 90 MILS)	3' x 9'/SP MINI-SKIP
TE - THERMOPLASTIC (4" WHITE, 90 MILS)	SOLID LANE LINE
TF - THERMOPLASTIC (4" YELLOW, 90 MILS)	10' SKIP
TH - THERMOPLASTIC (4" YELLOW, 90 MILS)	SINGLE CENTER LINE
TI - THERMOPLASTIC (4" YELLOW, 90 MILS)	DOUBLE CENTER LINE
TK - THERMOPLASTIC (6" WHITE, 90 MILS)	3' x 9'/SP MINI-SKIP
TL - THERMOPLASTIC (6" WHITE, 90 MILS)	SOLID LANE LINE
TP - THERMOPLASTIC (8" YELLOW, 90 MILS)	DIAGONAL LINE
TQ - THERMOPLASTIC (8" WHITE, 90 MILS)	CROSSWALK LINE
T1 - THERMOPLASTIC (16" WHITE, 90 MILS)	RR X
T2 - THERMOPLASTIC (24" WHITE, 90 MILS)	STOP BAR
T8 - THERMOPLASTIC (4" WHITE, 90 MILS)	2'-6"/SP MINI-SKIP
T9 - THERMOPLASTIC (4" YELLOW, 90 MILS)	2'-6"/SP MINI-SKIP

PAVEMENT MARKING SYMBOLS/CHARACTERS	
UA - THERMOPLASTIC (WHITE, 90 MILS)	LEFT TURN ARROW
UB - THERMOPLASTIC (WHITE, 90 MILS)	RIGHT TURN ARROW
UC - THERMOPLASTIC (WHITE, 90 MILS)	STRAIGHT ARROW
UD - THERMOPLASTIC (WHITE, 90 MILS)	COMBO LEFT/STRAIGHT ARROW
UE - THERMOPLASTIC (WHITE, 90 MILS)	COMBO RIGHT/STRAIGHT ARROW
UI - THERMOPLASTIC (WHITE, 90 MILS)	ALPHANUMERIC CHARACTER

PAVEMENT MARKER LEGEND	
■ - CRYSTAL / RED PAVEMENT MARKER	
◆ - YELLOW / YELLOW PAVEMENT MARKER	

K:\RAL-Roadway\01036333 - U-5724 (Central Heights)TrafficSigning\CADD\Pavement Marking Plans\U-5724-pmp-05.dgn
 2/20/2020

PROJECT REFERENCE NO. U-5724	SHEET NO. PMP-6
R/W SHEET NO.	
ROADWAY DESIGN ENGINEER	
DOCUMENT NOT CONSIDERED FINAL UNLESS ALL SIGNATURES COMPLETED	

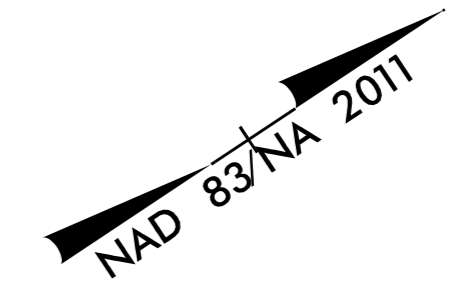

REVISIONS

K:\RAL_Roadway\01036333 - U-5724 (Central Heights)\Traffic\Signing\CADD\Pavement Marking Plans\U-5724.pmp-06.dgn

2/20/2020

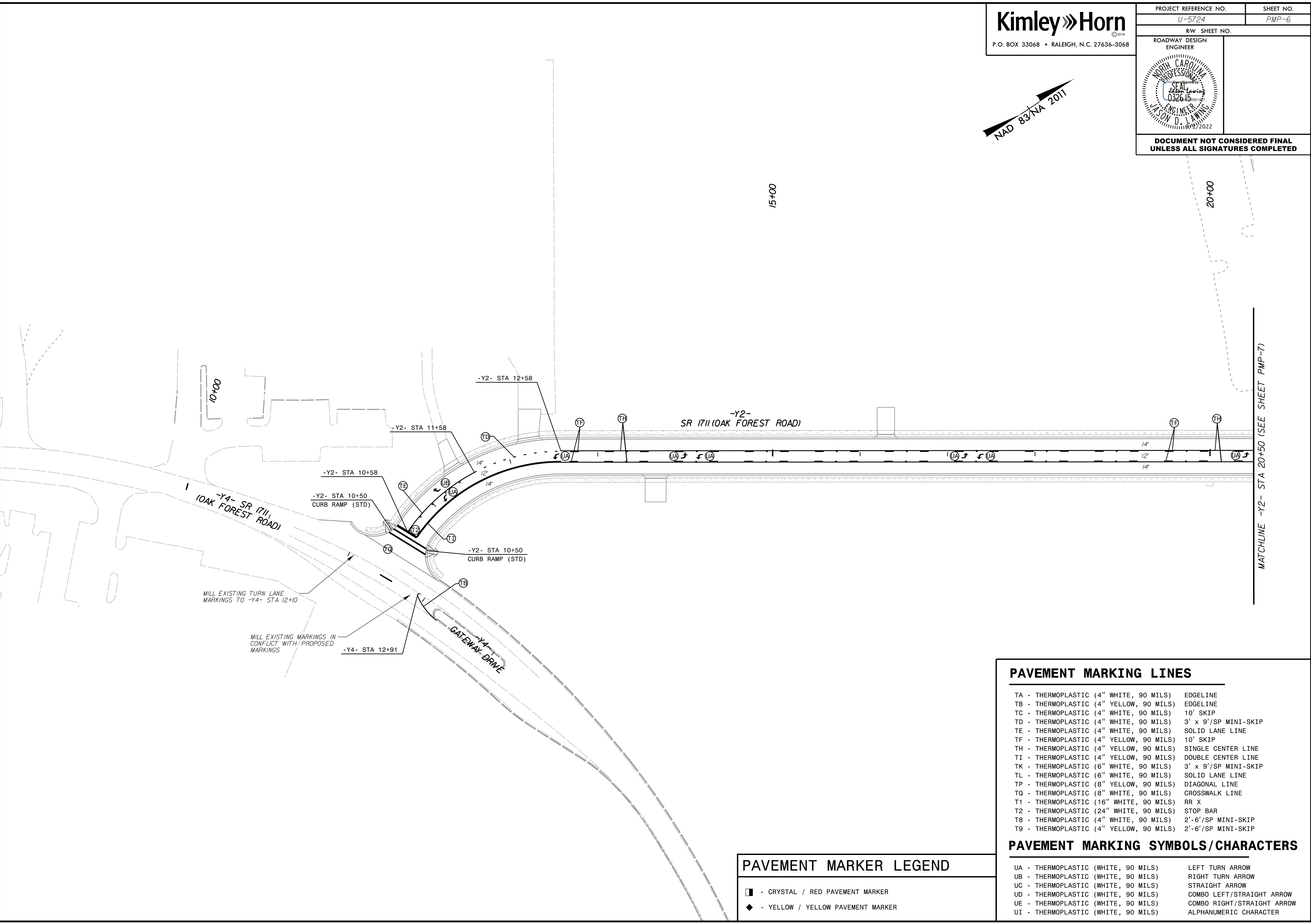

PAVEMENT MARKER LEGEND

- - CRYSTAL / RED PAVEMENT MARKER
- ◆ - YELLOW / YELLOW PAVEMENT MARKER

PAVEMENT MARKING LINES

- | | |
|---|----------------------|
| TA - THERMOPLASTIC (4" WHITE, 90 MILS) | EDGE LINE |
| TB - THERMOPLASTIC (4" YELLOW, 90 MILS) | EDGE LINE |
| TC - THERMOPLASTIC (4" WHITE, 90 MILS) | 10' SKIP |
| TD - THERMOPLASTIC (4" WHITE, 90 MILS) | 3' x 9'/SP MINI-SKIP |
| TE - THERMOPLASTIC (4" WHITE, 90 MILS) | SOLID LANE LINE |
| TF - THERMOPLASTIC (4" YELLOW, 90 MILS) | 10' SKIP |
| TH - THERMOPLASTIC (4" YELLOW, 90 MILS) | SINGLE CENTER LINE |
| TI - THERMOPLASTIC (4" YELLOW, 90 MILS) | DOUBLE CENTER LINE |
| TK - THERMOPLASTIC (6" WHITE, 90 MILS) | 3' x 9'/SP MINI-SKIP |
| TL - THERMOPLASTIC (6" WHITE, 90 MILS) | SOLID LANE LINE |
| TP - THERMOPLASTIC (8" YELLOW, 90 MILS) | DIAGONAL LINE |
| TQ - THERMOPLASTIC (8" WHITE, 90 MILS) | CROSSWALK LINE |
| T1 - THERMOPLASTIC (16" WHITE, 90 MILS) | RR X |
| T2 - THERMOPLASTIC (24" WHITE, 90 MILS) | STOP BAR |
| T8 - THERMOPLASTIC (4" WHITE, 90 MILS) | 2'-6"/SP MINI-SKIP |
| T9 - THERMOPLASTIC (4" YELLOW, 90 MILS) | 2'-6"/SP MINI-SKIP |

PAVEMENT MARKING SYMBOLS/CHARACTERS

- | | |
|-------------------------------------|----------------------------|
| UA - THERMOPLASTIC (WHITE, 90 MILS) | LEFT TURN ARROW |
| UB - THERMOPLASTIC (WHITE, 90 MILS) | RIGHT TURN ARROW |
| UC - THERMOPLASTIC (WHITE, 90 MILS) | STRAIGHT ARROW |
| UD - THERMOPLASTIC (WHITE, 90 MILS) | COMBO LEFT/STRAIGHT ARROW |
| UE - THERMOPLASTIC (WHITE, 90 MILS) | COMBO RIGHT/STRAIGHT ARROW |
| UI - THERMOPLASTIC (WHITE, 90 MILS) | ALPHANUMERIC CHARACTER |

PROJECT REFERENCE NO. U-5724	SHEET NO. PMP-7
R/W SHEET NO.	
ROADWAY DESIGN ENGINEER	
DOCUMENT NOT CONSIDERED FINAL UNLESS ALL SIGNATURES COMPLETED	

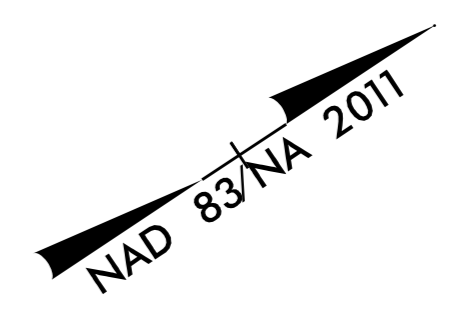

REVISIONS

K:\RAL_Roadway\01036333 - U-5724 (Central Heights)\Traffic\Signing\CADD\Pavement Marking Plans\U-5724-pmp-07.dgn

2/20/2020

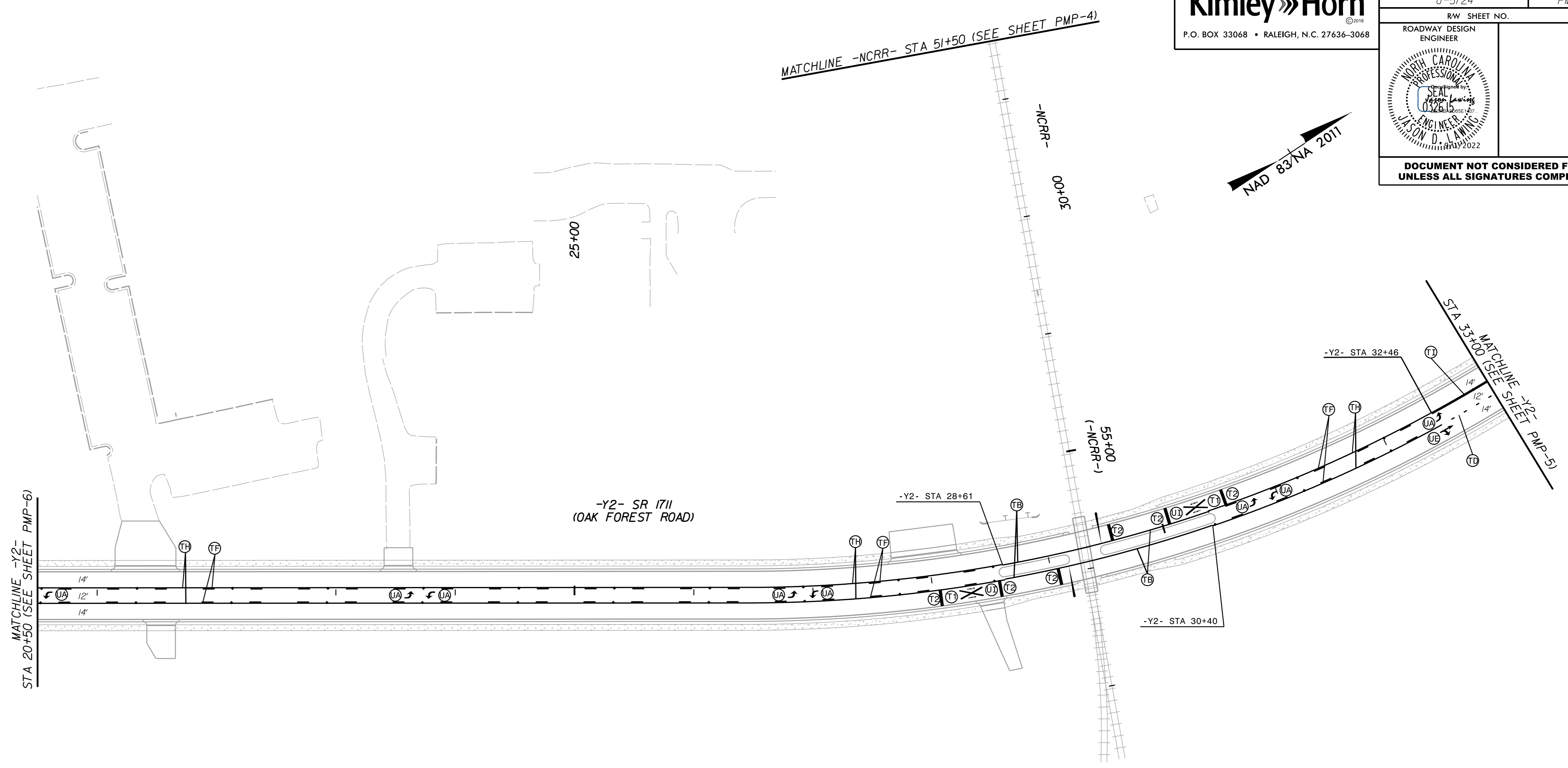

	- CRYSTAL / RED PAVEMENT MARKER
	- YELLOW / YELLOW PAVEMENT MARKER

TA - THERMOPLASTIC (4" WHITE, 90 MILS)	EDGE LINE
TB - THERMOPLASTIC (4" YELLOW, 90 MILS)	EDGE LINE
TC - THERMOPLASTIC (4" WHITE, 90 MILS)	10' SKIP
TD - THERMOPLASTIC (4" WHITE, 90 MILS)	3' x 9'/SP MINI-SKIP
TE - THERMOPLASTIC (4" WHITE, 90 MILS)	SOLID LANE LINE
TF - THERMOPLASTIC (4" YELLOW, 90 MILS)	10' SKIP
TH - THERMOPLASTIC (4" YELLOW, 90 MILS)	SINGLE CENTER LINE
TI - THERMOPLASTIC (4" YELLOW, 90 MILS)	DOUBLE CENTER LINE
TK - THERMOPLASTIC (6" WHITE, 90 MILS)	3' x 9'/SP MINI-SKIP
TL - THERMOPLASTIC (6" WHITE, 90 MILS)	SOLID LANE LINE
TP - THERMOPLASTIC (8" YELLOW, 90 MILS)	DIAGONAL LINE
TQ - THERMOPLASTIC (8" WHITE, 90 MILS)	CROSSWALK LINE
T1 - THERMOPLASTIC (16" WHITE, 90 MILS)	RR X
T2 - THERMOPLASTIC (24" WHITE, 90 MILS)	STOP BAR
T8 - THERMOPLASTIC (4" WHITE, 90 MILS)	2'-6"/SP MINI-SKIP
T9 - THERMOPLASTIC (4" YELLOW, 90 MILS)	2'-6"/SP MINI-SKIP

UA - THERMOPLASTIC (WHITE, 90 MILS)	LEFT TURN ARROW
UB - THERMOPLASTIC (WHITE, 90 MILS)	RIGHT TURN ARROW
UC - THERMOPLASTIC (WHITE, 90 MILS)	STRAIGHT ARROW
UD - THERMOPLASTIC (WHITE, 90 MILS)	COMBO LEFT/STRAIGHT ARROW
UE - THERMOPLASTIC (WHITE, 90 MILS)	COMBO RIGHT/STRAIGHT ARROW
UI - THERMOPLASTIC (WHITE, 90 MILS)	ALPHANUMERIC CHARACTER

PROJECT REFERENCE NO. U-5724	SHEET NO. PMP-8
R/W SHEET NO.	
ROADWAY DESIGN ENGINEER	
DOCUMENT NOT CONSIDERED FINAL UNLESS ALL SIGNATURES COMPLETED	



REVISIONS

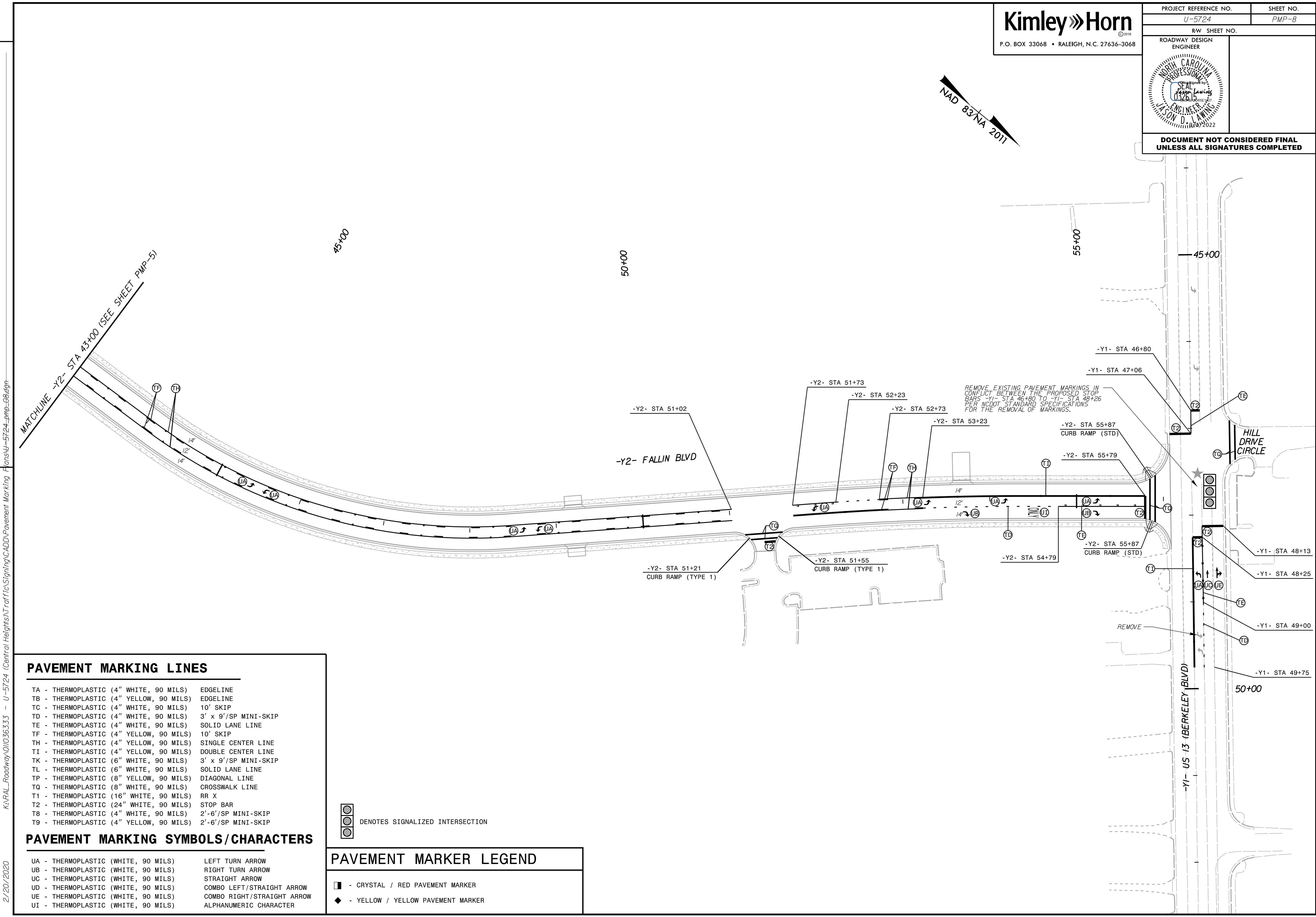

PAVEMENT MARKING LINES

TA - THERMOPLASTIC (4" WHITE, 90 MILS)	EDGELINE
TB - THERMOPLASTIC (4" YELLOW, 90 MILS)	EDGELINE
TC - THERMOPLASTIC (4" WHITE, 90 MILS)	10' SKIP
TD - THERMOPLASTIC (4" WHITE, 90 MILS)	3' x 9'/SP MINI-SKIP
TE - THERMOPLASTIC (4" WHITE, 90 MILS)	SOLID LANE LINE
TF - THERMOPLASTIC (4" YELLOW, 90 MILS)	10' SKIP
TH - THERMOPLASTIC (4" YELLOW, 90 MILS)	SINGLE CENTER LINE
TI - THERMOPLASTIC (4" YELLOW, 90 MILS)	DOUBLE CENTER LINE
TK - THERMOPLASTIC (6" WHITE, 90 MILS)	3' x 9'/SP MINI-SKIP
TL - THERMOPLASTIC (6" WHITE, 90 MILS)	SOLID LANE LINE
TP - THERMOPLASTIC (8" YELLOW, 90 MILS)	DIAGONAL LINE
TQ - THERMOPLASTIC (8" WHITE, 90 MILS)	CROSSWALK LINE
T1 - THERMOPLASTIC (16" WHITE, 90 MILS)	RR X
T2 - THERMOPLASTIC (24" WHITE, 90 MILS)	STOP BAR
T8 - THERMOPLASTIC (4" WHITE, 90 MILS)	2'-6"/SP MINI-SKIP
T9 - THERMOPLASTIC (4" YELLOW, 90 MILS)	2'-6"/SP MINI-SKIP

PAVEMENT MARKING SYMBOLS/CHARACTERS

UA - THERMOPLASTIC (WHITE, 90 MILS)	LEFT TURN ARROW
UB - THERMOPLASTIC (WHITE, 90 MILS)	RIGHT TURN ARROW
UC - THERMOPLASTIC (WHITE, 90 MILS)	STRAIGHT ARROW
UD - THERMOPLASTIC (WHITE, 90 MILS)	COMBO LEFT/STRAIGHT ARROW
UE - THERMOPLASTIC (WHITE, 90 MILS)	COMBO RIGHT/STRAIGHT ARROW
UI - THERMOPLASTIC (WHITE, 90 MILS)	ALPHANUMERIC CHARACTER

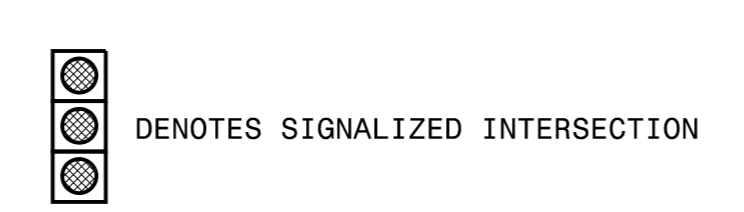

PAVEMENT MARKER LEGEND

■	- CRYSTAL / RED PAVEMENT MARKER
◆	- YELLOW / YELLOW PAVEMENT MARKER

K:\RAL_Roadway\01036333 - U-5724 (Central Heights\Traffic\Signing\CADD\Pavement Marking Plans\U-5724-pmp-08.dgn
 2/20/2020

PROJECT REFERENCE NO. U-5724	SHEET NO. PMP-9
R/W SHEET NO.	
ROADWAY DESIGN ENGINEER	
DOCUMENT NOT CONSIDERED FINAL UNLESS ALL SIGNATURES COMPLETED	

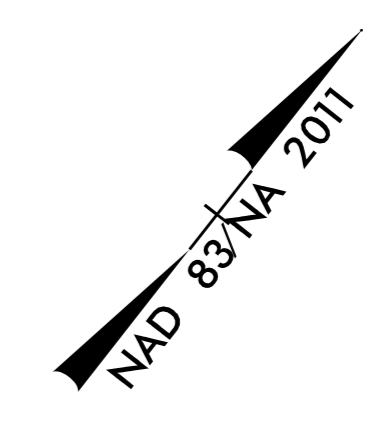

REVISIONS
 K:\RAL_Roadway\01036333 - U-5724 (Central Heights)\Traffic\Signing\CADD\Pavement Marking Plans\U-5724-pmp-09.dgn
 2/24/2020

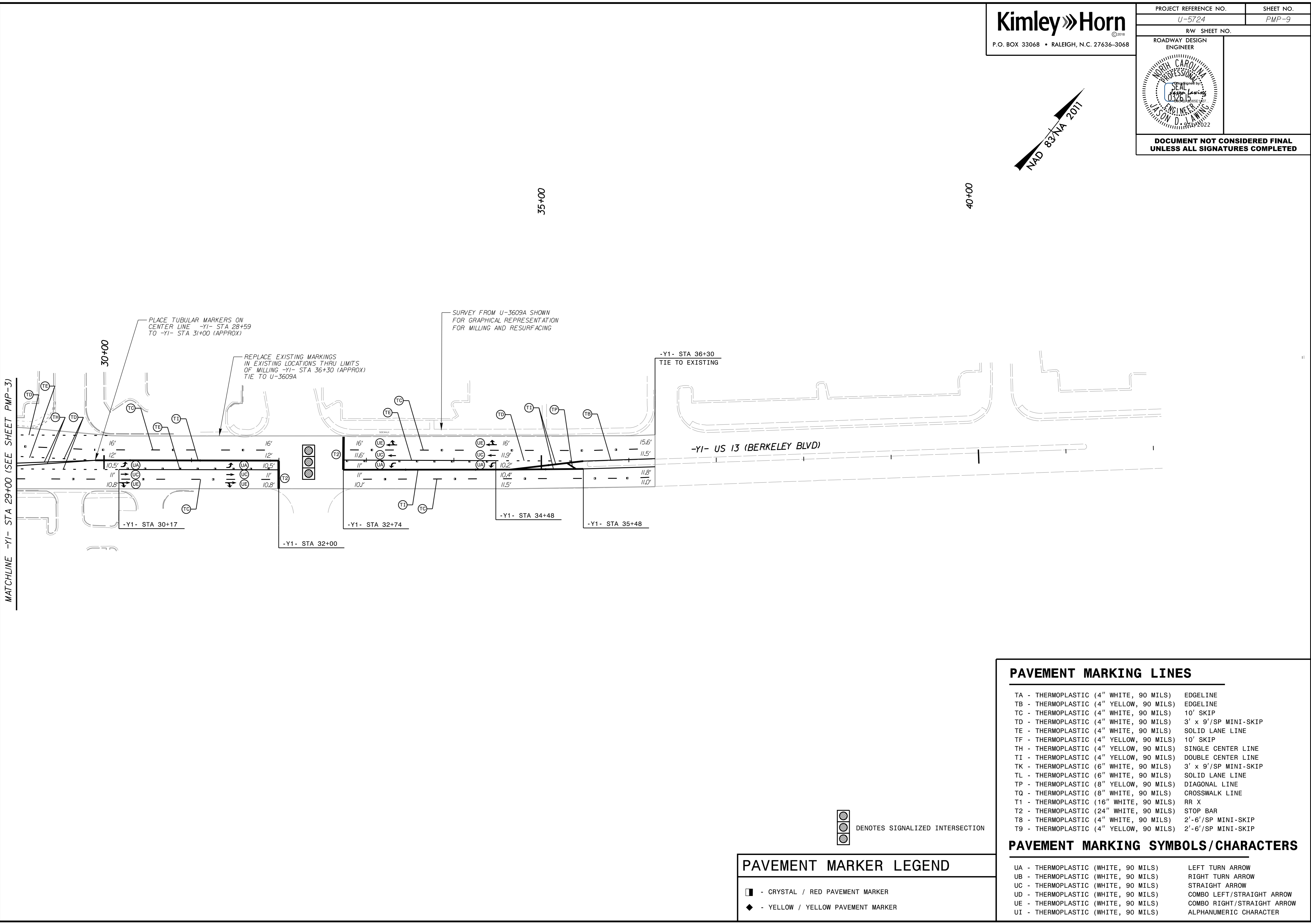

PAVEMENT MARKER LEGEND

- - CRYSTAL / RED PAVEMENT MARKER
- ◆ - YELLOW / YELLOW PAVEMENT MARKER

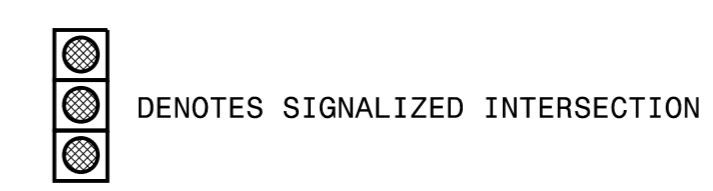

PAVEMENT MARKING LINES

- | | |
|---|----------------------|
| TA - THERMOPLASTIC (4" WHITE, 90 MILS) | EDGE LINE |
| TB - THERMOPLASTIC (4" YELLOW, 90 MILS) | EDGE LINE |
| TC - THERMOPLASTIC (4" WHITE, 90 MILS) | 10' SKIP |
| TD - THERMOPLASTIC (4" WHITE, 90 MILS) | 3' x 9'/SP MINI-SKIP |
| TE - THERMOPLASTIC (4" WHITE, 90 MILS) | SOLID LANE LINE |
| TF - THERMOPLASTIC (4" YELLOW, 90 MILS) | 10' SKIP |
| TH - THERMOPLASTIC (4" YELLOW, 90 MILS) | SINGLE CENTER LINE |
| TI - THERMOPLASTIC (4" YELLOW, 90 MILS) | DOUBLE CENTER LINE |
| TK - THERMOPLASTIC (6" WHITE, 90 MILS) | 3' x 9'/SP MINI-SKIP |
| TL - THERMOPLASTIC (6" WHITE, 90 MILS) | SOLID LANE LINE |
| TP - THERMOPLASTIC (8" YELLOW, 90 MILS) | DIAGONAL LINE |
| TQ - THERMOPLASTIC (8" WHITE, 90 MILS) | CROSSWALK LINE |
| T1 - THERMOPLASTIC (16" WHITE, 90 MILS) | RR X |
| T2 - THERMOPLASTIC (24" WHITE, 90 MILS) | STOP BAR |
| T8 - THERMOPLASTIC (4" WHITE, 90 MILS) | 2'-6'/SP MINI-SKIP |
| T9 - THERMOPLASTIC (4" YELLOW, 90 MILS) | 2'-6'/SP MINI-SKIP |

PAVEMENT MARKING SYMBOLS/CHARACTERS

- | | |
|-------------------------------------|----------------------------|
| UA - THERMOPLASTIC (WHITE, 90 MILS) | LEFT TURN ARROW |
| UB - THERMOPLASTIC (WHITE, 90 MILS) | RIGHT TURN ARROW |
| UC - THERMOPLASTIC (WHITE, 90 MILS) | STRAIGHT ARROW |
| UD - THERMOPLASTIC (WHITE, 90 MILS) | COMBO LEFT/STRAIGHT ARROW |
| UE - THERMOPLASTIC (WHITE, 90 MILS) | COMBO RIGHT/STRAIGHT ARROW |
| UI - THERMOPLASTIC (WHITE, 90 MILS) | ALPHANUMERIC CHARACTER |