

### UTILITIES BY OTHERS

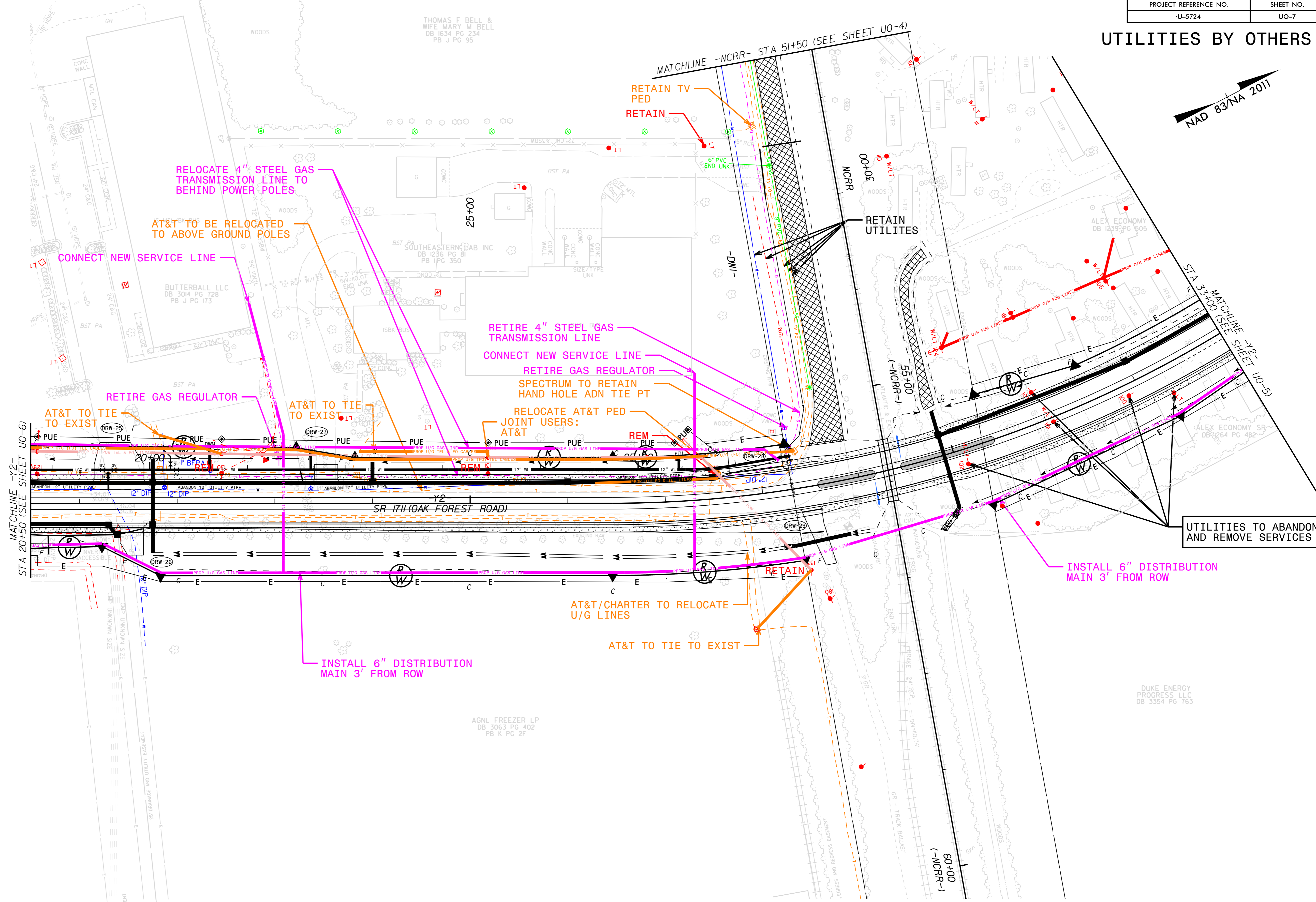
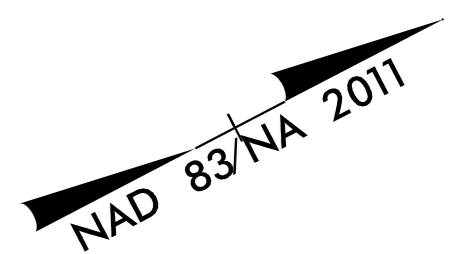

RELOCATE 4" STEEL GAS TRANSMISSION LINE TO BEHIND POWER POLES

AT&T TO BE RELOCATED TO ABOVE GROUND POLES

CONNECT NEW SERVICE LINE

RETIRE GAS REGULATOR

AT&T TO TIE TO EXIST

AT&T TO TIE TO EXIST

RETIRE 4" STEEL GAS TRANSMISSION LINE

CONNECT NEW SERVICE LINE

RETIRE GAS REGULATOR

SPECTRUM TO RETAIN HAND HOLE AND TIE PT

RELOCATE AT&T PED

JOINT USERS: AT&T

AT&T/CHARTER TO RELOCATE U/G LINES

AT&T TO TIE TO EXIST

INSTALL 6" DISTRIBUTION MAIN 3' FROM ROW

RETAIN TV PED

RETAIN

RETAIN UTILITES

UTILITIES TO ABANDON AND REMOVE SERVICES

INSTALL 6" DISTRIBUTION MAIN 3' FROM ROW

LEGEND	
—X—	INSTALL POWER LINE (DEP)
-X-U-G-	INSTALL UNDERGROUND POWER LINE (DEP)
●	INSTALL POWER POLE (DEP)
⊠	INSTALL TRANSFORMER (DEP)

**NOTE:**  
ALL PROPOSED UTILITY WORK SHOWN ON THIS SHEET WILL BE DONE BY OTHERS. NO PAYMENT WILL BE MADE TO THE CONTRACTOR FOR PROPOSED UTILITY WORK SHOWN ON THIS SHEET.



K:\RAL\_Roadway\01036333 - U-5724 (Central Heights)\Utilities\Engineering\UBO\Pro\U-5724\_UBO\_uo07.dgn

8/2/2022