

PROJECT REFERENCE NO. U-5724	SHEET NO. SIGN-3
R/W SHEET NO.	
ROADWAY DESIGN ENGINEER	
DOCUMENT NOT CONSIDERED FINAL UNLESS ALL SIGNATURES COMPLETED	

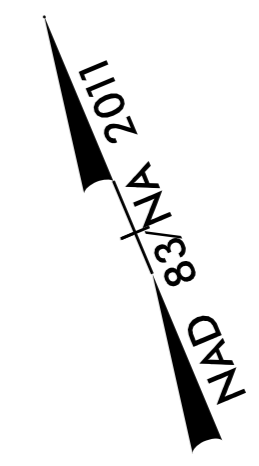

REVISIONS

K:\RAL\_Roadway\01036333 - U-5724 (Central Heights)\Traffic\Signing\CADD\Pavement Marking Plans\U-5724\_sgn-03.dgn

2/20/2020

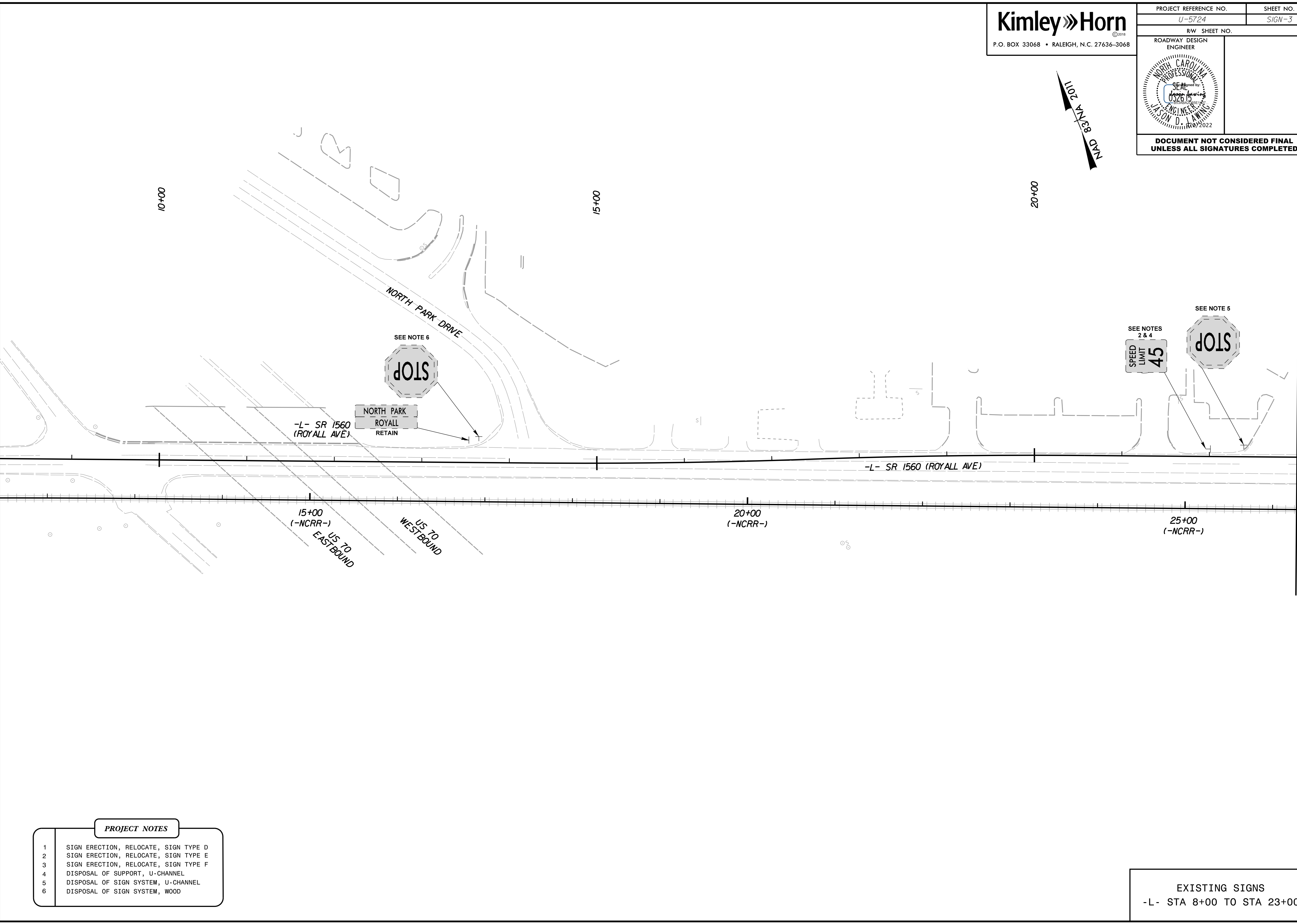

**PROJECT NOTES**

- 1 SIGN ERECTION, RELOCATE, SIGN TYPE D
- 2 SIGN ERECTION, RELOCATE, SIGN TYPE E
- 3 SIGN ERECTION, RELOCATE, SIGN TYPE F
- 4 DISPOSAL OF SUPPORT, U-CHANNEL
- 5 DISPOSAL OF SIGN SYSTEM, U-CHANNEL
- 6 DISPOSAL OF SIGN SYSTEM, WOOD

EXISTING SIGNS  
-L- STA 8+00 TO STA 23+00

MATCHLINE -L- STA 23+00 (SEE SHEET SIGN-4)