

REVISIONS

5/14/1999
 2/19/2020
 K:\RAL_Roadway\01036333 - U-5724 (Central Heights)\Environmental\Design\U-5724_ec_psh_12.dgn

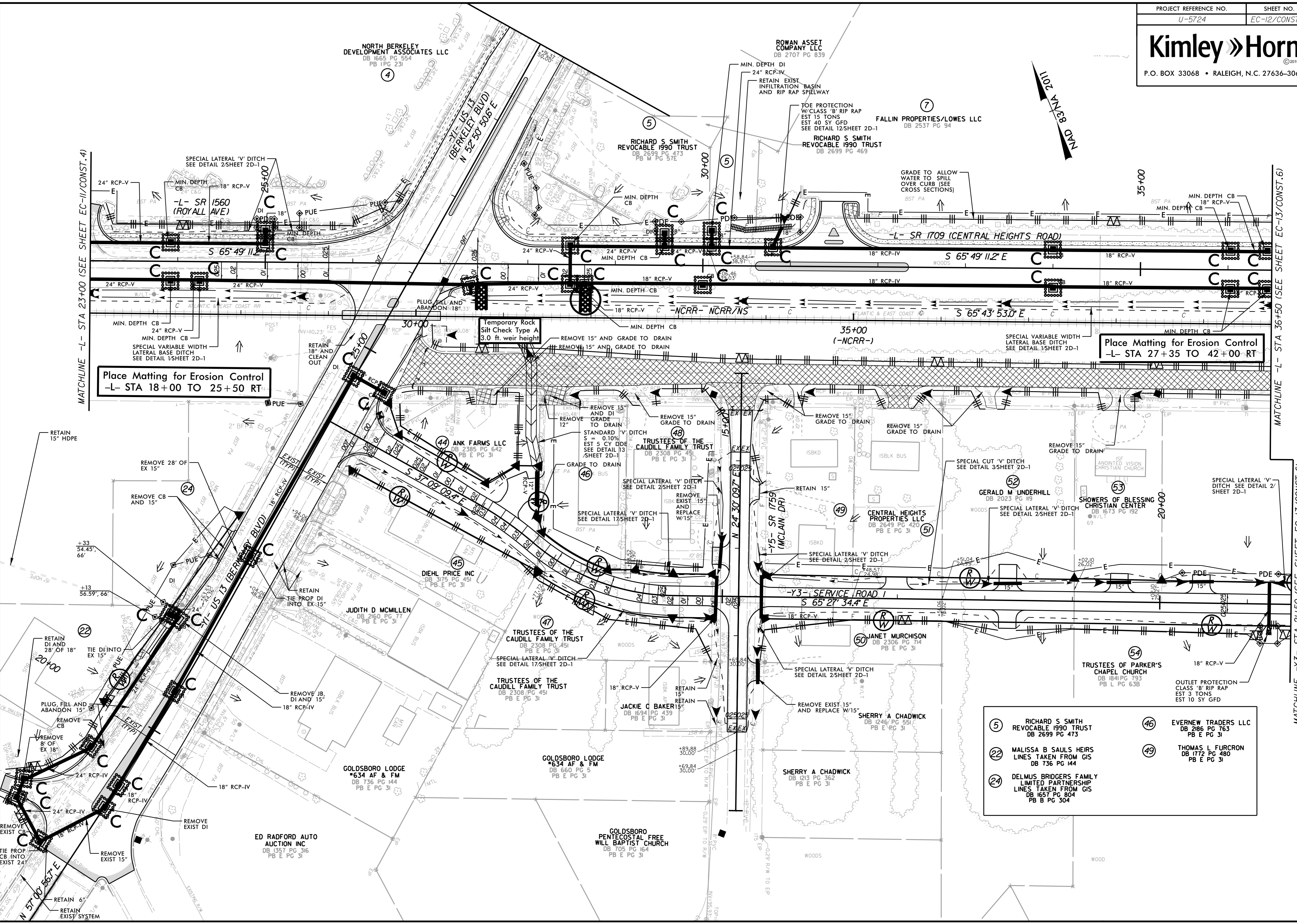

Place Matting for Erosion Control
 -L- STA 18+00 TO 25+50 RT

Place Matting for Erosion Control
 -L- STA 27+35 TO 42+00 RT

- ⑤ RICHARD S SMITH REVOCABLE 1990 TRUST DB 2699 PG 473
- ②② MALISSA B SAULS HEIRS LINES TAKEN FROM GIS DB 736 PG 144
- ②④ DELMUS BRIDGERS FAMILY LIMITED PARTNERSHIP LINES TAKEN FROM GIS DB 1657 PG 804 PB B PG 304
- ④⑥ EVERNEW TRADERS LLC DB 2186 PG 763 PB E PG 31
- ④⑨ THOMAS L FURCRON DB 1772 PG 480 PB E PG 31

MATCHLINE -L- STA 36+50 (SEE SHEET EC-13/CONST.6)

MATCHLINE -Y3- STA 21+50 (SEE SHEET EC-13/CONST.6)