

PIPE INSTALLATION SEQUENCE

STA. 19+94 -Y2-

STAGE I

CULVERT CONSTRUCTION SEQUENCE
STAGE I

1. CLOSE OAK FOREST ROAD TO TRAFFIC PER TRAFFIC CONTROL PLANS. INSTALL SPECIAL STILLING BASIN(S) AND TEMPORARY SILT FENCE.
2. INSTALL TEMPORARY 24" PIPE ON SOUTH SIDE OF EXCAVATED TRENCH AND TEMPORARY DIVERSION DITCHES. CONSTRUCT IMPERVIOUS DIKES, DIVERTING FLOW THROUGH THE TEMPORARY 24" PIPE.
3. REMOVE EXISTING 54" RCP, 36" CMP AND JUNCTION BOX.
4. DEWATER ENTRAPPED AREA AND CONSTRUCT PROPOSED 66" RCP, HEADWALL, CATCH BASINS AND 60" RCP'S TO TIE BACK TO EXISTING OFFSITE SYSTEM. AREA TO BE DEWATERED SHALL BE EQUAL TO ONE DAY'S WORK.
5. COMPLETE INSTALLATION OF REMAINING STORM SYSTEM AND DITCHES SHOWN WITHIN THE AREA.
6. EXCAVATE ANY ACCUMULATED SILT AND DEWATER BEFORE REMOVAL OF IMPERVIOUS DIKES. REMOVE IMPERVIOUS DIKES (DOWNSTREAM DIKES FIRST), DIVERTING FLOW THROUGH PROPOSED CULVERT.
7. REMOVE SPECIAL STILLING BASIN(S), STABILIZE DISTURBED AREA WITH SEED AND MULCH AND COMPLETE ROADWAY.

REVISIONS

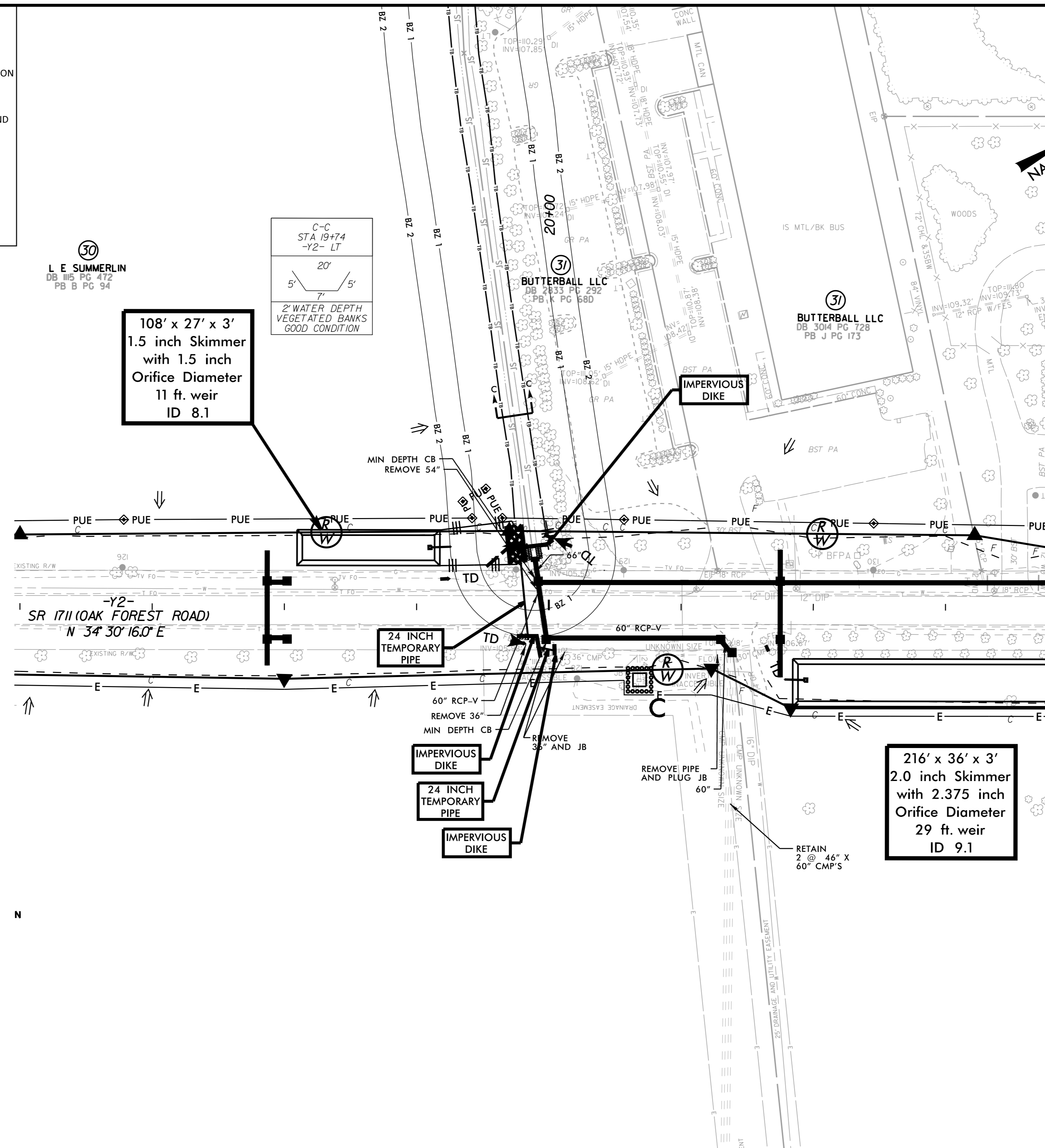

30
 L E SUMMERLIN
 DB 116 PG 472
 PB B PG 94

C-C
 STA 19+74
 -Y2- LT
 20'
 5' 7' 5'
 2' WATER DEPTH
 VEGETATED BANKS
 GOOD CONDITION

108' x 27' x 3'
 1.5 inch Skimmer
 with 1.5 inch
 Orifice Diameter
 11 ft. weir
 ID 8.1

216' x 36' x 3'
 2.0 inch Skimmer
 with 2.375 inch
 Orifice Diameter
 29 ft. weir
 ID 9.1

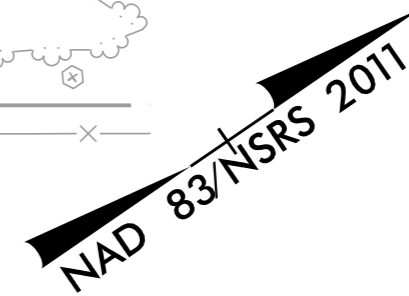

2/19/2020 K:\VAL_Roadway\01036333 - U-5724 (Central Heights)\Environmental\Design\U-5724.ec_pst_8A_pipe_installation.dgn