

PROJECT REFERENCE NO. U-5724	SHEET NO. PMP-9
R/W SHEET NO.	
ROADWAY DESIGN ENGINEER	
DOCUMENT NOT CONSIDERED FINAL UNLESS ALL SIGNATURES COMPLETED	

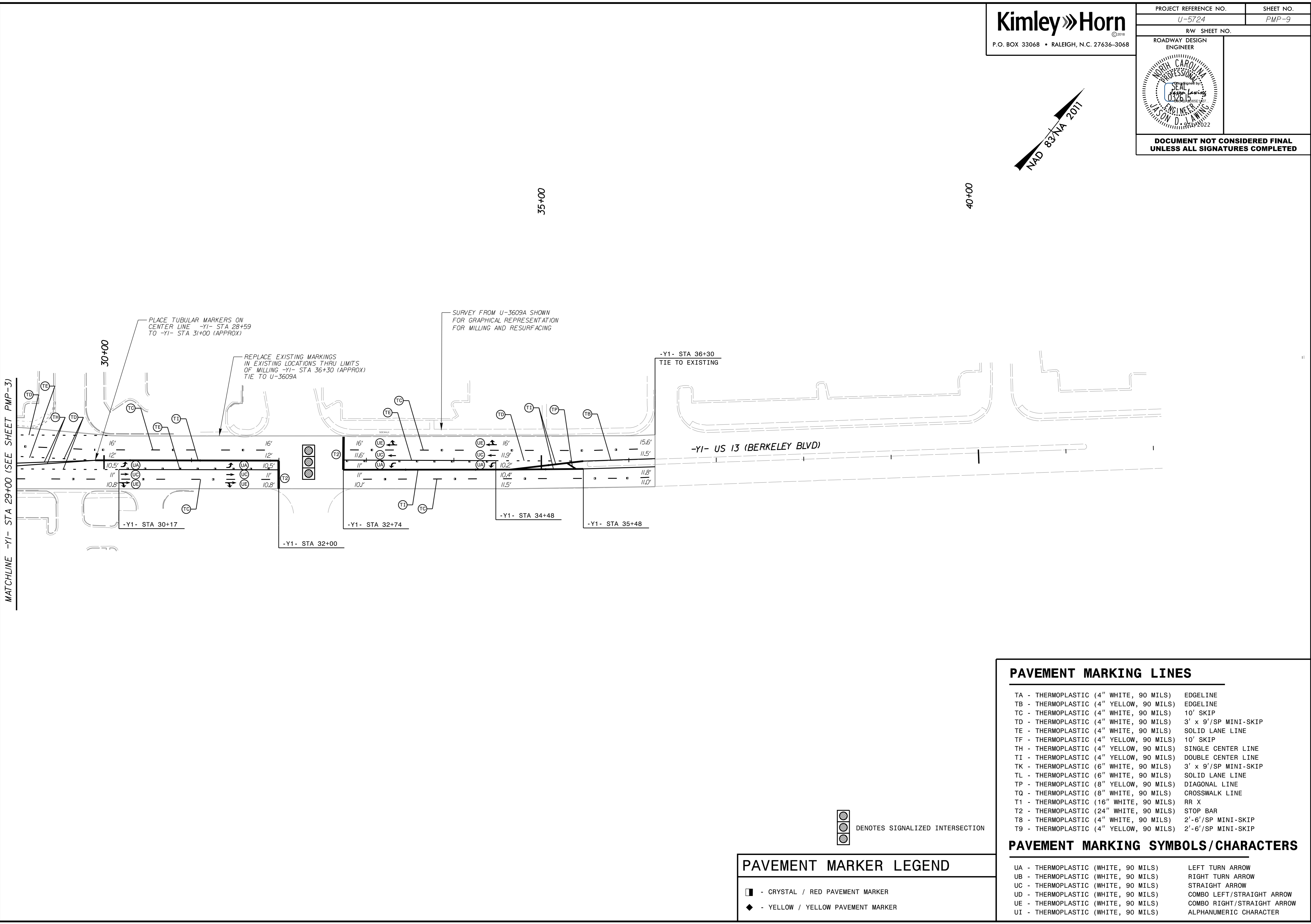

REVISIONS  
 K:\RAL\_Roadway\01036333 - U-5724 (Central Heights)\Traffic\Signing\CADD\Pavement Marking Plans\U-5724-pmp-09.dgn  
 2/24/2020



**PAVEMENT MARKER LEGEND**

- - CRYSTAL / RED PAVEMENT MARKER
- ◆ - YELLOW / YELLOW PAVEMENT MARKER

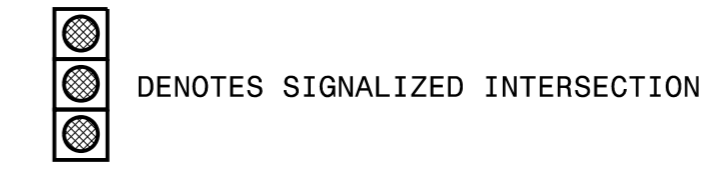

**PAVEMENT MARKING LINES**

- |   |                      |
|---|----------------------|
| TA - THERMOPLASTIC (4" WHITE, 90 MILS)  | EDGE LINE            |
| TB - THERMOPLASTIC (4" YELLOW, 90 MILS) | EDGE LINE            |
| TC - THERMOPLASTIC (4" WHITE, 90 MILS)  | 10' SKIP             |
| TD - THERMOPLASTIC (4" WHITE, 90 MILS)  | 3' x 9'/SP MINI-SKIP |
| TE - THERMOPLASTIC (4" WHITE, 90 MILS)  | SOLID LANE LINE      |
| TF - THERMOPLASTIC (4" YELLOW, 90 MILS) | 10' SKIP             |
| TH - THERMOPLASTIC (4" YELLOW, 90 MILS) | SINGLE CENTER LINE   |
| TI - THERMOPLASTIC (4" YELLOW, 90 MILS) | DOUBLE CENTER LINE   |
| TK - THERMOPLASTIC (6" WHITE, 90 MILS)  | 3' x 9'/SP MINI-SKIP |
| TL - THERMOPLASTIC (6" WHITE, 90 MILS)  | SOLID LANE LINE      |
| TP - THERMOPLASTIC (8" YELLOW, 90 MILS) | DIAGONAL LINE        |
| TQ - THERMOPLASTIC (8" WHITE, 90 MILS)  | CROSSWALK LINE       |
| T1 - THERMOPLASTIC (16" WHITE, 90 MILS) | RR X                 |
| T2 - THERMOPLASTIC (24" WHITE, 90 MILS) | STOP BAR             |
| T8 - THERMOPLASTIC (4" WHITE, 90 MILS)  | 2'-6'/SP MINI-SKIP   |
| T9 - THERMOPLASTIC (4" YELLOW, 90 MILS) | 2'-6'/SP MINI-SKIP   |

**PAVEMENT MARKING SYMBOLS/CHARACTERS**

- |                                     |                            |
|-------------------------------------|----------------------------|
| UA - THERMOPLASTIC (WHITE, 90 MILS) | LEFT TURN ARROW            |
| UB - THERMOPLASTIC (WHITE, 90 MILS) | RIGHT TURN ARROW           |
| UC - THERMOPLASTIC (WHITE, 90 MILS) | STRAIGHT ARROW             |
| UD - THERMOPLASTIC (WHITE, 90 MILS) | COMBO LEFT/STRAIGHT ARROW  |
| UE - THERMOPLASTIC (WHITE, 90 MILS) | COMBO RIGHT/STRAIGHT ARROW |
| UI - THERMOPLASTIC (WHITE, 90 MILS) | ALPHANUMERIC CHARACTER     |