

PROJECT REFERENCE NO. U-5724	SHEET NO. PMP-5
R/W SHEET NO.	
ROADWAY DESIGN ENGINEER	
DOCUMENT NOT CONSIDERED FINAL UNLESS ALL SIGNATURES COMPLETED	

NAD 83/NA 2011

REVISIONS

K:\RAL_Roadway\01036333 - U-5724 (Central Heights)TrafficSigning\CADD\Pavement Marking Plans\U-5724-pmp-05.dgn

2/20/2020

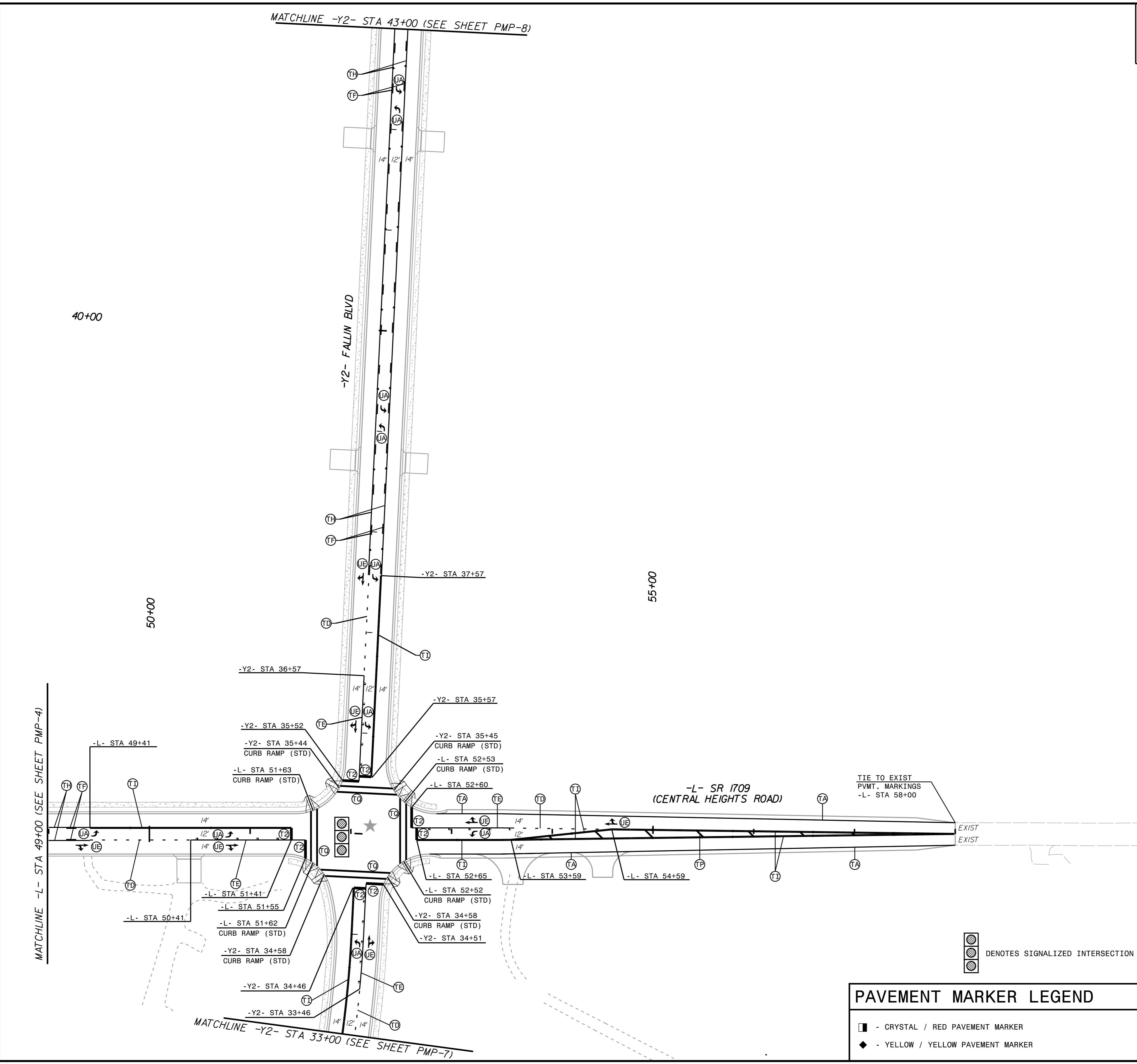

PAVEMENT MARKING LINES	
TA - THERMOPLASTIC (4" WHITE, 90 MILS)	EDGE LINE
TB - THERMOPLASTIC (4" YELLOW, 90 MILS)	EDGE LINE
TC - THERMOPLASTIC (4" WHITE, 90 MILS)	10' SKIP
TD - THERMOPLASTIC (4" WHITE, 90 MILS)	3' x 9'/SP MINI-SKIP
TE - THERMOPLASTIC (4" WHITE, 90 MILS)	SOLID LANE LINE
TF - THERMOPLASTIC (4" YELLOW, 90 MILS)	10' SKIP
TH - THERMOPLASTIC (4" YELLOW, 90 MILS)	SINGLE CENTER LINE
TI - THERMOPLASTIC (4" YELLOW, 90 MILS)	DOUBLE CENTER LINE
TK - THERMOPLASTIC (6" WHITE, 90 MILS)	3' x 9'/SP MINI-SKIP
TL - THERMOPLASTIC (6" WHITE, 90 MILS)	SOLID LANE LINE
TP - THERMOPLASTIC (8" YELLOW, 90 MILS)	DIAGONAL LINE
TQ - THERMOPLASTIC (8" WHITE, 90 MILS)	CROSSWALK LINE
T1 - THERMOPLASTIC (16" WHITE, 90 MILS)	RR X
T2 - THERMOPLASTIC (24" WHITE, 90 MILS)	STOP BAR
T8 - THERMOPLASTIC (4" WHITE, 90 MILS)	2'-6"/SP MINI-SKIP
T9 - THERMOPLASTIC (4" YELLOW, 90 MILS)	2'-6"/SP MINI-SKIP

PAVEMENT MARKING SYMBOLS/CHARACTERS	
UA - THERMOPLASTIC (WHITE, 90 MILS)	LEFT TURN ARROW
UB - THERMOPLASTIC (WHITE, 90 MILS)	RIGHT TURN ARROW
UC - THERMOPLASTIC (WHITE, 90 MILS)	STRAIGHT ARROW
UD - THERMOPLASTIC (WHITE, 90 MILS)	COMBO LEFT/STRAIGHT ARROW
UE - THERMOPLASTIC (WHITE, 90 MILS)	COMBO RIGHT/STRAIGHT ARROW
UI - THERMOPLASTIC (WHITE, 90 MILS)	ALPHANUMERIC CHARACTER

PAVEMENT MARKER LEGEND	
■ - CRYSTAL / RED PAVEMENT MARKER	
◆ - YELLOW / YELLOW PAVEMENT MARKER	

DENOTES SIGNALIZED INTERSECTION