

10/11/2022 K:\RAL_Roadway\010363333 - U-5724 (Central Heights)\Roadway\Proj\U-5724_rdy_pst_10.dgn

REVISIONS

Kimley»Horn
P.O. BOX 33068 • RALEIGH, N.C. 27636-3068

PROJECT REFERENCE NO. U-5724	SHEET NO. 10
RW SHEET NO.	HYDRAULICS ENGINEER
ROADWAY DESIGN ENGINEER	HYDRAULICS ENGINEER
DOCUMENT NOT CONSIDERED FINAL UNLESS ALL SIGNATURES COMPLETED	

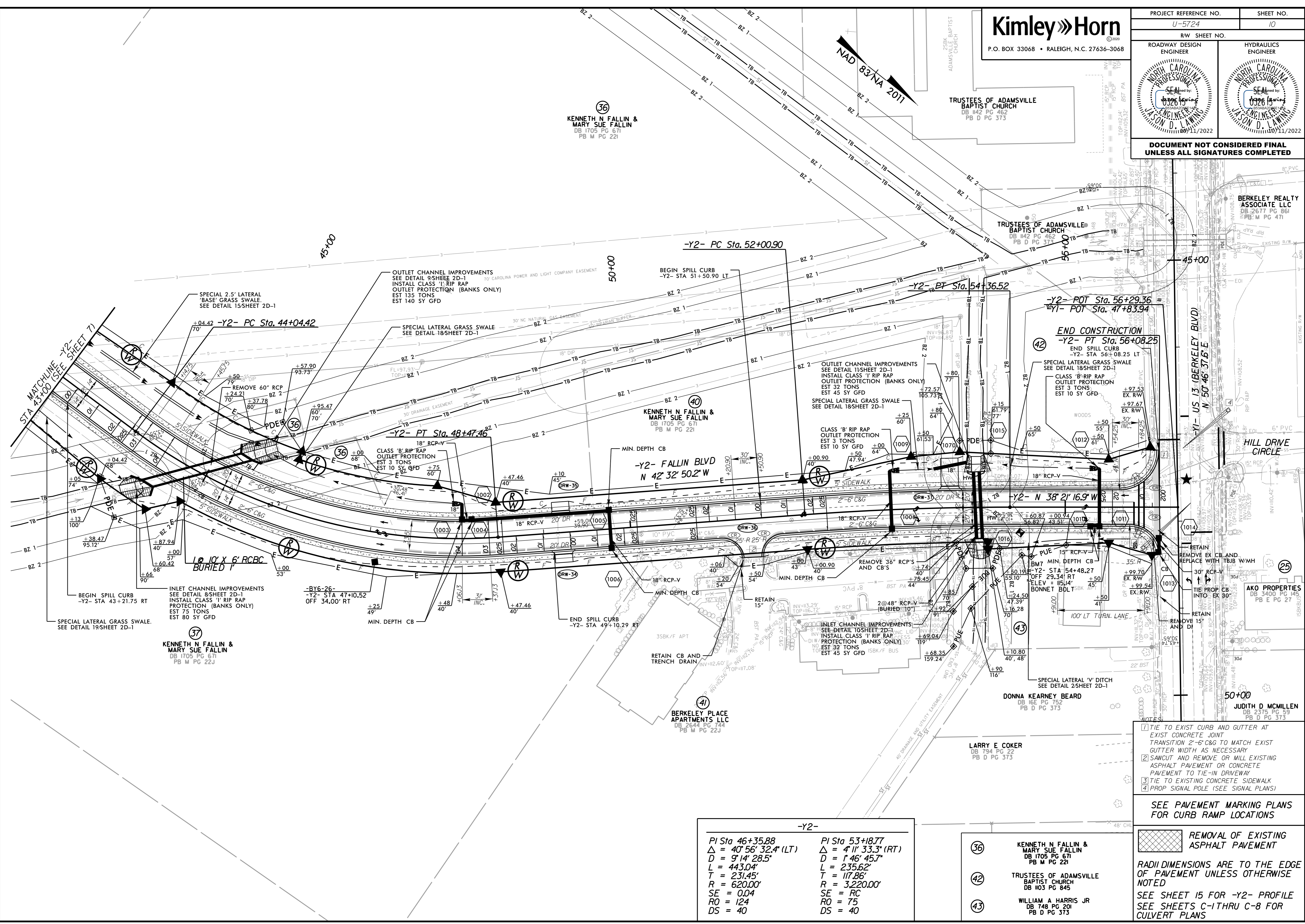

-Y2-	
$PI\ Sta\ 46+35.88$ $\Delta = 40^\circ 56' 32.4\" (LT)$ $D = 9' 14' 28.5\"$ $L = 443.04'$ $T = 231.45'$ $R = 620.00'$ $SE = 0.04$ $RO = 124$ $DS = 40$	$PI\ Sta\ 53+18.77$ $\Delta = 4^\circ 11' 33.3\" (RT)$ $D = 1' 46' 45.7\"$ $L = 235.62'$ $T = 117.86'$ $R = 3,220.00'$ $SE = RC$ $RO = 75$ $DS = 40$

- (36) KENNETH N FALLIN & MARY SUE FALLIN
DB 1705 PG 671
PB M PG 221
- (42) TRUSTEES OF ADAMSVILLE BAPTIST CHURCH
DB 1103 PG 845
- (43) WILLIAM A HARRIS JR
DB 748 PG 201
PB D PG 373

- 1 TIE TO EXIST CURB AND GUTTER AT EXIST CONCRETE JOINT
TRANSITION 2'-6\" C&G TO MATCH EXIST GUTTER WIDTH AS NECESSARY
- 2 SAWCUT AND REMOVE OR MILL EXISTING ASPHALT PAVEMENT OR CONCRETE PAVEMENT TO TIE-IN DRIVEWAY
- 3 TIE TO EXISTING CONCRETE SIDEWALK
- 4 PROP SIGNAL POLE (SEE SIGNAL PLANS)

SEE PAVEMENT MARKING PLANS FOR CURB RAMP LOCATIONS

REMOVAL OF EXISTING ASPHALT PAVEMENT

RADII DIMENSIONS ARE TO THE EDGE OF PAVEMENT UNLESS OTHERWISE NOTED
SEE SHEET 15 FOR -Y2- PROFILE
SEE SHEETS C-1 THRU C-8 FOR CULVERT PLANS