

BENCH MARK: BM*2 - R/R SPIKE SET IN 11" GUM TREE, STATION 14+65.00, 76' LEFT
 N 793495 E 2139827, ELEV. = 201.04', NAVD 1988

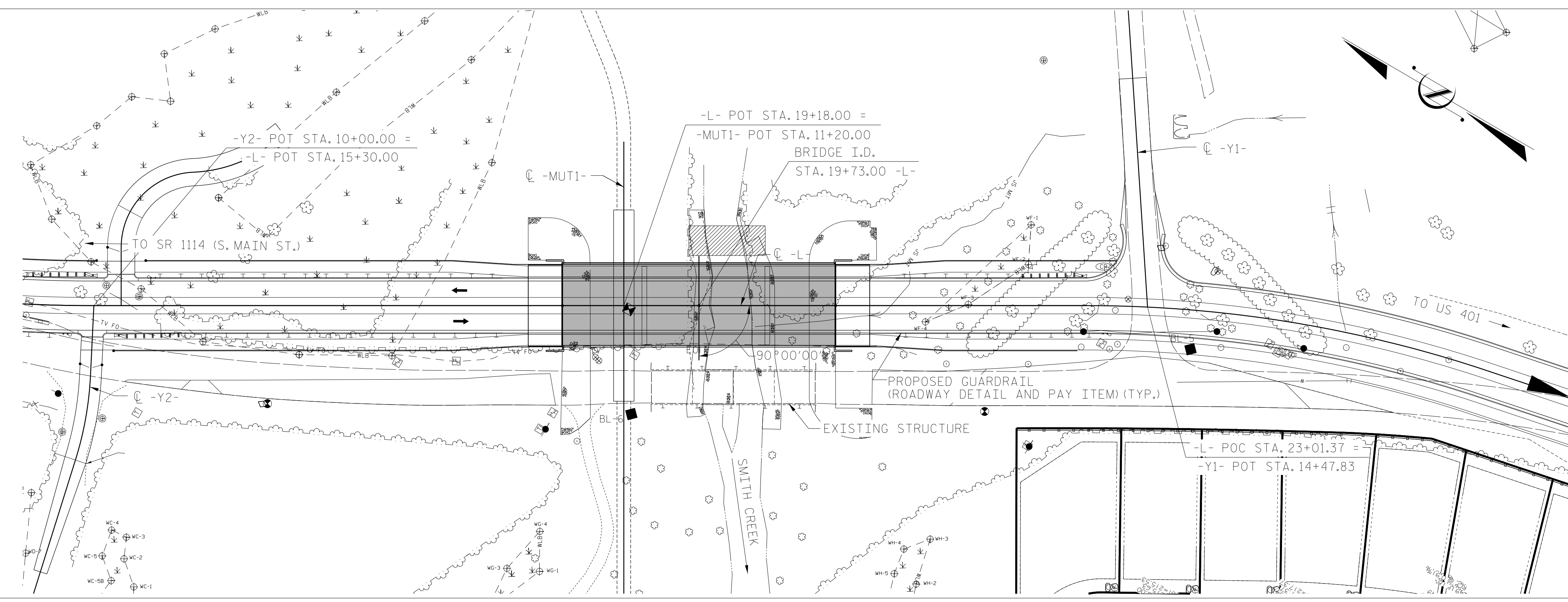

LOCATION SKETCH

FOR UTILITY INFORMATION, SEE UTILITY PLANS AND SPECIAL PROVISIONS

GENERAL NOTES:

ASSUMED LIVE LOAD = HL-93 OR ALTERNATE LOADING.
 THIS BRIDGE HAS BEEN DESIGNED IN ACCORDANCE WITH THE REQUIREMENTS OF THE AASHTO LRFD BRIDGE DESIGN SPECIFICATIONS.
 THIS BRIDGE IS LOCATED IN SEISMIC ZONE 1.
 FOR OTHER DESIGN DATA AND GENERAL NOTES, SEE SHEET SN.
 FOR SUBMITTAL OF WORKING DRAWINGS, SEE SPECIAL PROVISIONS.
 FOR FALSEWORK AND FORMWORK, SEE SPECIAL PROVISIONS.
 FOR CRANE SAFETY, SEE SPECIAL PROVISIONS.
 FOR GROUT FOR STRUCTURES, SEE SPECIAL PROVISIONS.
 THE CONTRACTOR SHALL PROVIDE INDEPENDANT ASSURANCE SAMPLES OF REINFORCING STEEL AS FOLLOWS: FOR PROJECTS REQUIRING UP TO 400 TONS OF REINFORCING STEEL, ONE 30 INCH SAMPLE OF EACH SIZE BAR USED, AND FOR PROJECTS REQUIRING OVER 400 TONS OF REINFORCING STEEL, TWO 30 INCH SAMPLES OF EACH SIZE BAR USED. THE SAMPLE BARS SHOULD COME FROM STEEL ACTUALLY USED IN THE PROJECT AND THE SAMPLE BARS SHOULD BE REPLACED BY SPLICED BARS AS SPECIFIED IN THE SAMPLE BAR REPLACEMENT CHART. PAYMENT FOR THE SAMPLE BARS AND REPLACEMENT REINFORCING STEEL SHALL BE CONSIDERED INCIDENTAL TO VARIOUS PAY ITEMS.
 REMOVABLE FORMS MAY BE USED IN LIEU OF METAL STAY-IN-PLACE FORMS IN ACCORDANCE WITH ARTICLE 420-3 OF THE STANDARD SPECIFICATIONS.

AT THE CONTRACTOR'S OPTION, AND UPON REMOVAL OF THE CAUSEWAY, THE CLASS II RIP RAP USED IN THE CAUSEWAY MAY BE PLACED AS RIP RAP SLOPE PROTECTION. SEE SPECIAL PROVISIONS FOR CONSTRUCTION, MAINTENANCE AND REMOVAL OF TEMPORARY ACCESS AT STATION 19+73.00 -L-.

NEEDLE BEAMS WILL NOT BE ALLOWED UNLESS OTHERWISE CALLED FOR ON THE PLANS OR APPROVED BY THE ENGINEER.

THE CLASS AA CONCRETE IN THE BRIDGE DECK SHALL CONTAIN FLY ASH OR GROUND GRANULATED BLAST FURNACE SLAG AT THE SUBSTITUTION RATE SPECIFIED IN ARTICLE 1024-1 AND IN ACCORDANCE WITH ARTICLES 1024-5 AND 1024-6 OF THE STANDARD SPECIFICATIONS. NO PAYMENT WILL BE MADE FOR THIS SUBSTITUTION AS IT IS CONSIDERED INCIDENTAL TO THE COST OF THE REINFORCED CONCRETE DECK SLAB.

THE MATERIAL SHOWN IN THE CROSS-HATCHED AREA SHALL BE EXCAVATED FOR A DISTANCE OF 94 FT RIGHT OF CENTERLINE ROADWAY AS DIRECTED BY THE ENGINEER. THIS WORK WILL BE PAID FOR AT THE CONTRACT LUMP SUM PRICE FOR UNCLASSIFIED STRUCTURE EXCAVATION. SEE SECTION 412 OF THE STANDARD SPECIFICATIONS.

THE EXISTING STRUCTURE CONSISTING OF STEEL GIRDERS, 4 SPANS, 121 FT LONG; 24 FT WIDE REINFORCED CONCRETE DECK; ON CAST-IN-PLACE CONCRETE END BENTS AND INTERIOR BENTS SHALL BE COMPLETELY REMOVED. ALL ABANDONED REMNANT TIMBER PILES IN THE STREAM NEAR THE SOUTH BANK SHALL BE REMOVED OR CUT OFF 1 FT BELOW THE MUDLINE. THE EXISTING BRIDGE IS PRESENTLY NOT POSTED FOR LOAD LIMIT. SHOULD THE STRUCTURAL INTEGRITY OF THE BRIDGE DETERIORATE DURING CONSTRUCTION OF THE PROPOSED BRIDGE, A LOAD LIMIT MAY BE POSTED AND MAY BE REDUCED AS FOUND NECESSARY DURING THE LIFE OF THE PROJECT.

INASMUCH AS THE PAINT SYSTEM ON THE EXISTING STRUCTURAL STEEL CONTAINS LEAD, THE CONTRACTOR'S ATTENTION IS DIRECTED TO ARTICLE 107-1 OF THE STANDARD SPECIFICATIONS. ANY COSTS RESULTING FROM COMPLIANCE WITH APPLICABLE STATE OR FEDERAL REGULATIONS PERTAINING TO HANDLING OF MATERIALS CONTAINING LEAD BASED PAINT SHALL BE INCLUDED IN THE BID PRICE FOR REMOVAL OF EXISTING STRUCTURE AT STATION 19+73.00 -L-.

FOR EROSION CONTROL MEASURES, SEE EROSION CONTROL PLANS.

FOR ASBESTOS ASSESSMENT FOR BRIDGE DEMOLITION AND RENOVATION ACTIVITIES, SEE SPECIAL PROVISIONS.

TOTAL BILL OF MATERIAL

	CONSTRUCTION, MAINTENANCE, & REMOVAL OF TEMP ACCESS AT STA 19+73.00 -L-	REMOVAL OF EXISTING STRUCTURE	ASBESTOS ASSESSMENT	4'-0" DIA. DRILLED PIERS IN SOIL	4'-0" DIA. DRILLED PIERS NOT IN SOIL	PDA TESTING	SID INSPECTIONS	SPT TESTING	CSL TESTING	UNCLASSIFIED STRUCTURE EXCAVATION	REINFORCED CONCRETE DECK SLAB	GROOVING BRIDGE FLOORS	CLASS A CONCRETE	BRIDGE APPROACH SLABS
	LUMP SUM	LUMP SUM	LUMP SUM	CY	CY	EA	EA	EA	EA	LUMP SUM	SF	SF	CY	LUMP SUM
SUPERSTRUCTURE											12,016	9,116		LUMP SUM
END BENT 1													45.9	
BENT 1				144.0	21.0								47.9	
BENT 2				99.0	33.0								48.3	
END BENT 2													45.9	
TOTAL	LUMP SUM	LUMP SUM	LUMP SUM	243.0	54.0	1	1	1	1	LUMP SUM	12,016	9,116	188.0	LUMP SUM

	REINFORCING STEEL	SPIRAL COLUMN REINFORCING STEEL	54" PRESTRESSED CONCRETE GIRDERS	PILE DRIVING EQUIPMENT SETUP FOR HP 12X53	HP 12X53 STEEL PILES	STEEL PILE POINTS	TWO BAR METAL RAIL	VERTICAL CONCRETE BARRIER RAIL	1'-0" X 2'-6" CONCRETE PARAPET	RIP RAP CLASS II (2'-0" THICK)	GEOTEXTILE FOR DRAINAGE	ELASTOMERIC BEARINGS
	LBS	LBS	NO. LIN FT	EA	NO. LIN FT	EA	LIN FT	LIN FT	LIN FT	TON	SY	LUMP SUM
SUPERSTRUCTURE			18 1,185				381.67	496.67	396.67			LUMP SUM
END BENT 1	7,273			10	10	400				418	465	
BENT 1	21,390	3,722										
BENT 2	18,600	3,098										
END BENT 2	7,273			10	10	300				446	495	
TOTAL	54,536	6,820	18 1,185	20	20	700	381.67	496.67	396.67	864	960	LUMP SUM

SAMPLE BAR REPLACEMENT

SIZE	LENGTH
#3	6'-2"
#4	7'-4"
#5	8'-6"
#6	9'-8"
#7	10'-10"
#8	12'-0"
#9	13'-2"
#10	14'-6"
#11	15'-10"

PROJECT NO. B-5318
 WAKE COUNTY
 STATION: 19+73.00 -L-
 SHEET 3 OF 3

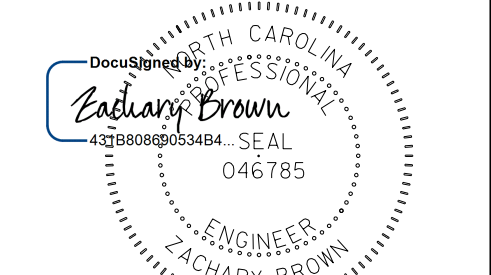
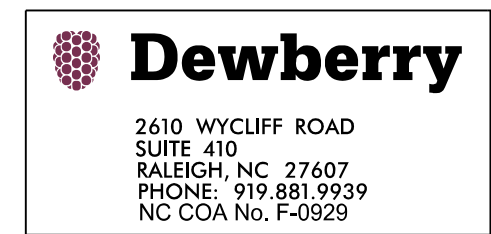

STATE OF NORTH CAROLINA
 DEPARTMENT OF TRANSPORTATION
 RALEIGH
 GENERAL DRAWING
 FOR BRIDGE ON SR 2044
 OVER SMITH CREEK
 BETWEEN SR 1114 AND US 401

DRAWN BY: E. JONES DATE: JUNE 21
 CHECKED BY: P. O'NEILL DATE: JUNE 21
 DESIGN ENGINEER OF RECORD: Z. BROWN DATE: JUNE 21

NO.	REVISIONS			SHEET NO.
	BY:	DATE:	NO.	
1			3	5-4
2			4	TOTAL SHEETS 41