

09/06/19

STATE	STATE PROJECT REFERENCE NO.	SHEET NO.	TOTAL SHEETS
N.C.	B-5318	RW01	

TIP PROJECT: B-5318

STATE OF NORTH CAROLINA
 DIVISION OF HIGHWAYS

SURVEY CONTROL, EXISTING CENTERLINES,
 RIGHT OF WAY, EASEMENTS AND PROPERTY TIES

WAKE COUNTY

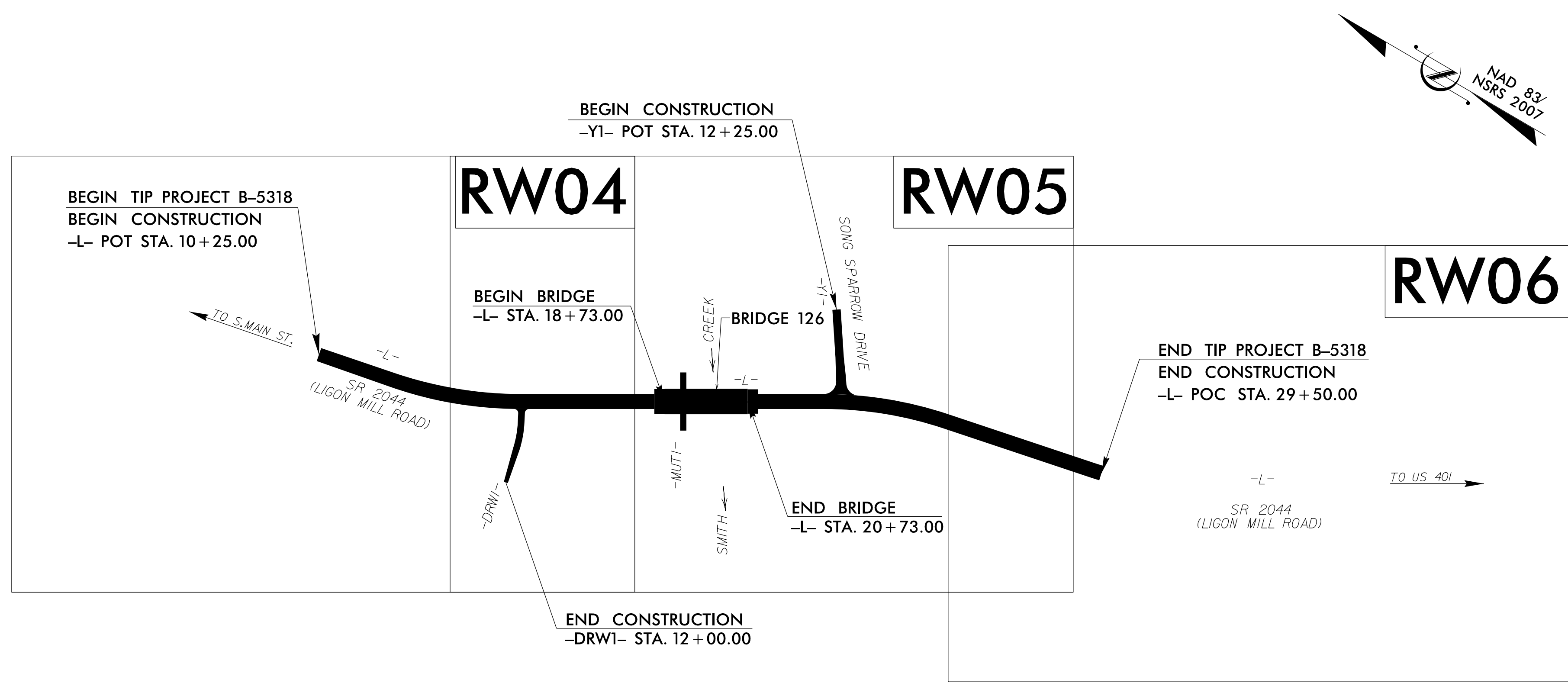

\$\$\$\$\$ SYSTEM \$\$\$\$\$\$
\$\$\$\$\$ DDN \$\$\$\$\$\$
\$\$\$\$\$ USERNAME \$\$\$\$\$\$

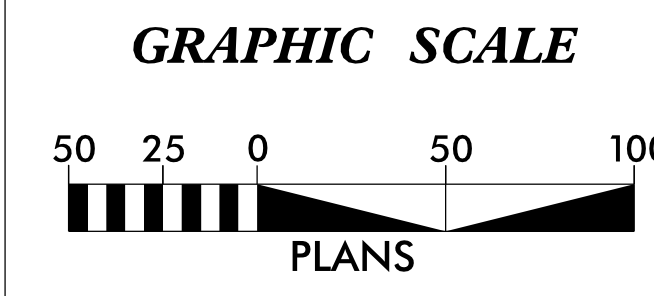

DATUM DESCRIPTION

THE LOCALIZED COORDINATE SYSTEM DEVELOPED FOR THIS PROJECT IS BASED ON THE STATE PLANE COORDINATES ESTABLISHED BY NCDOT FOR MONUMENT "B-5318-1" WITH NAD 83/NSRS 2007 STATE PLANE GRID COORDINATES OF NORTHING: 794,379.776(ft) EASTING: 2,139,517.414(ft) ELEVATION: 244.537(ft)

THE AVERAGE COMBINED GRID FACTOR USED ON THIS PROJECT (GROUND TO GRID) IS: 0.99993371

THE N.C. LAMBERT GRID BEARING AND LOCALIZED HORIZONTAL GROUND DISTANCE FROM "B-5318-1" TO -L- STATION 10+25.00 IS S 27-50'07.0" W 75.56(ft)

ALL LINEAR DIMENSIONS ARE LOCALIZED HORIZONTAL DISTANCES VERTICAL DATUM USED IS NAVD 88

Prepared in the Office of:

WETHERILL ENGINEERING
 1223 Jones Franklin Rd.
 Raleigh, N.C. 27606
 License No. F-0377
 Bus: 919 851 8077
 Fax: 919 851 8107

TRANSPORTATION PLANNING/DESIGN - BRIDGE/STRUCTURE DESIGN
 CIVIL/SITE DESIGN - SURVEYING - CONSTRUCTION OBSERVATION

2018 STANDARD SPECIFICATIONS

RIGHT OF WAY DATE: JUNE 21, 2019
LETTING DATE: NOVEMBER 16, 2021

PROFESSIONAL LAND SURVEYOR

DocuSigned by:
 Anthony K. Alford
 22BA982F5B44E

4/9/2021

SIGNATURE: _____ Date: _____

