

SECTION A-A

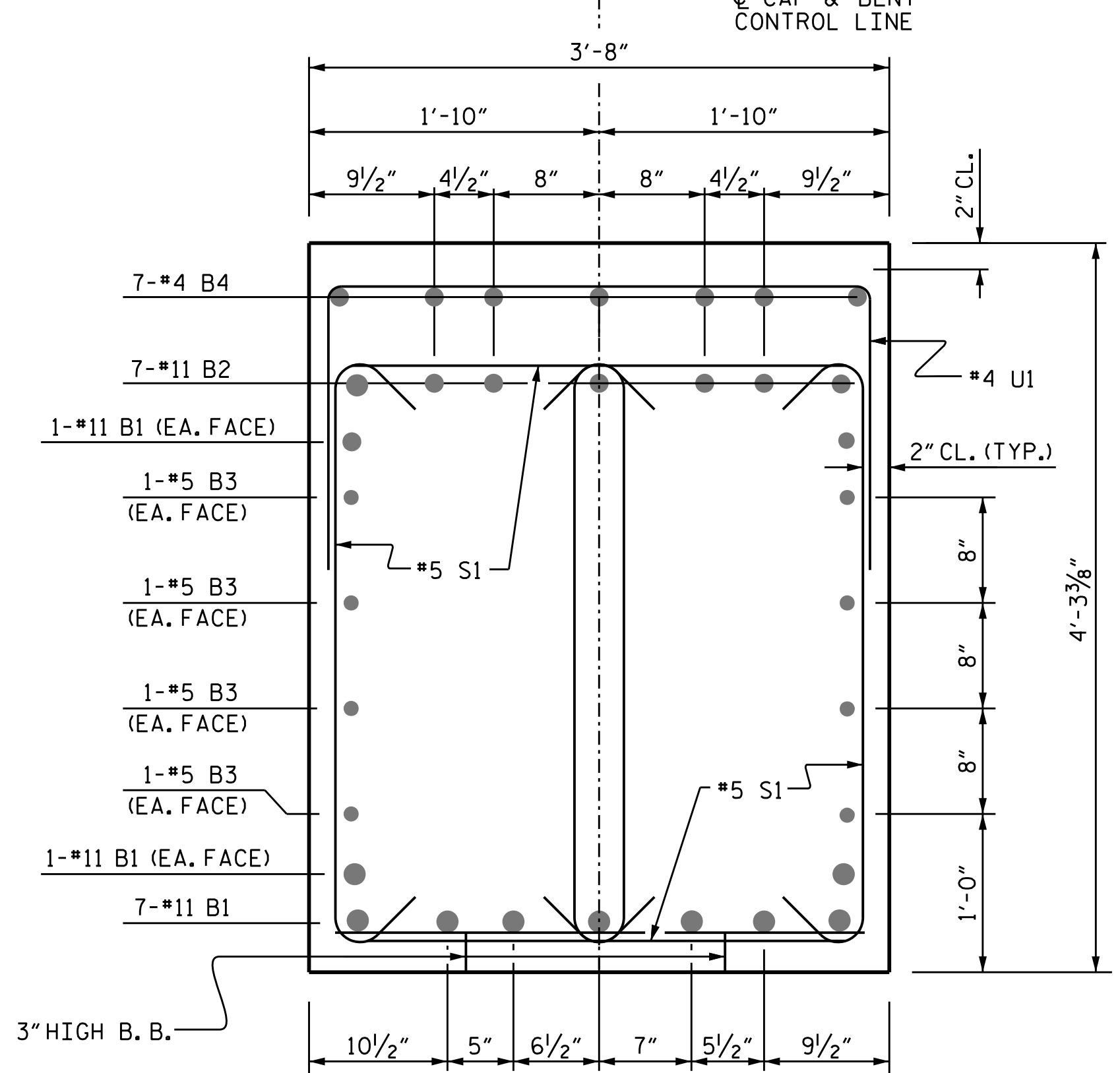

SECTION B-B

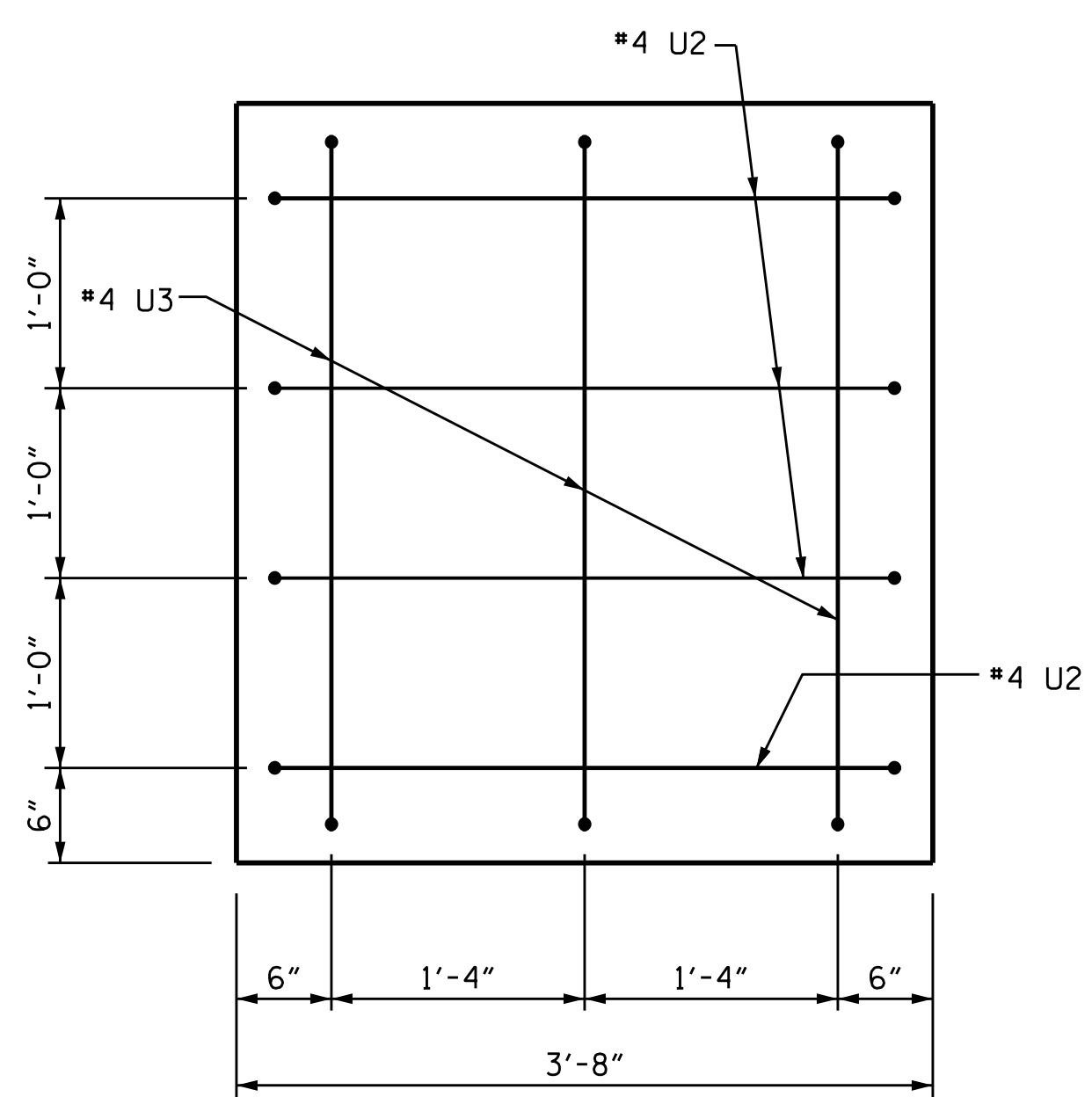

SECTION X-X  
(TYPICAL BOTH ENDS)

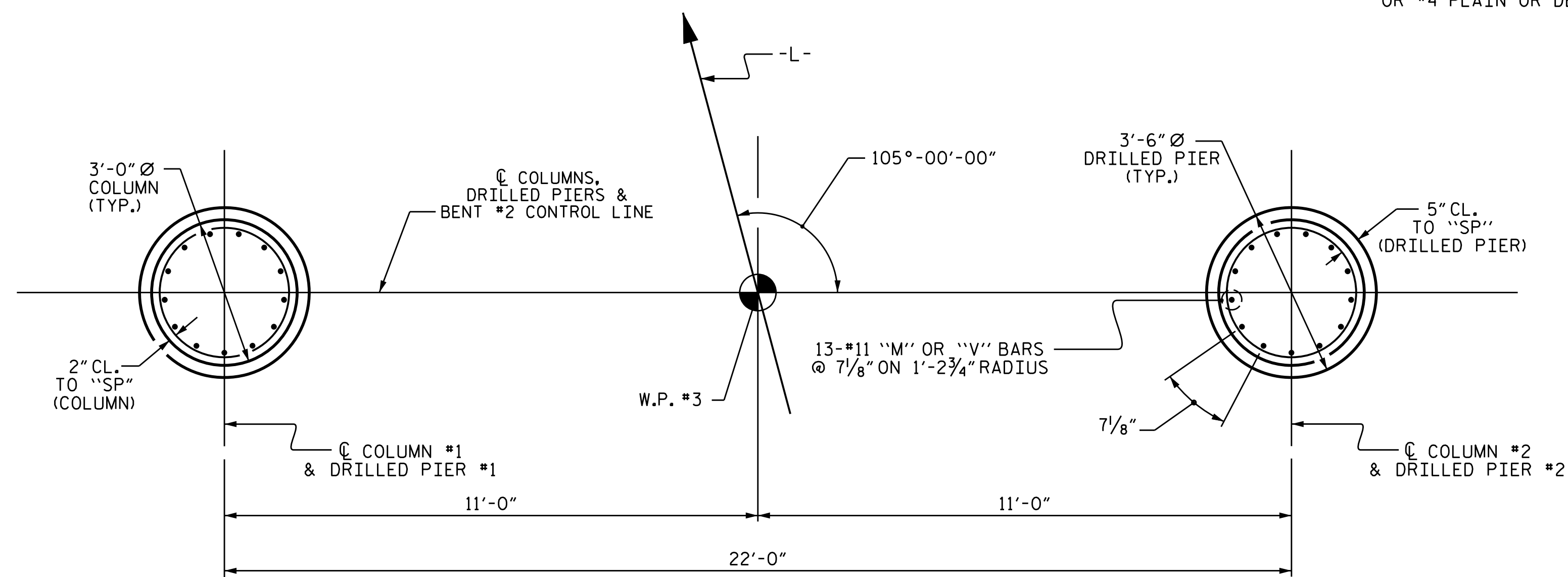

PLAN OF COLUMNS AND DRILLED PIERS

(DIMENSIONS AND REINFORCING STEEL ARE TYPICAL FOR EACH COLUMN AND DRILLED PIER)

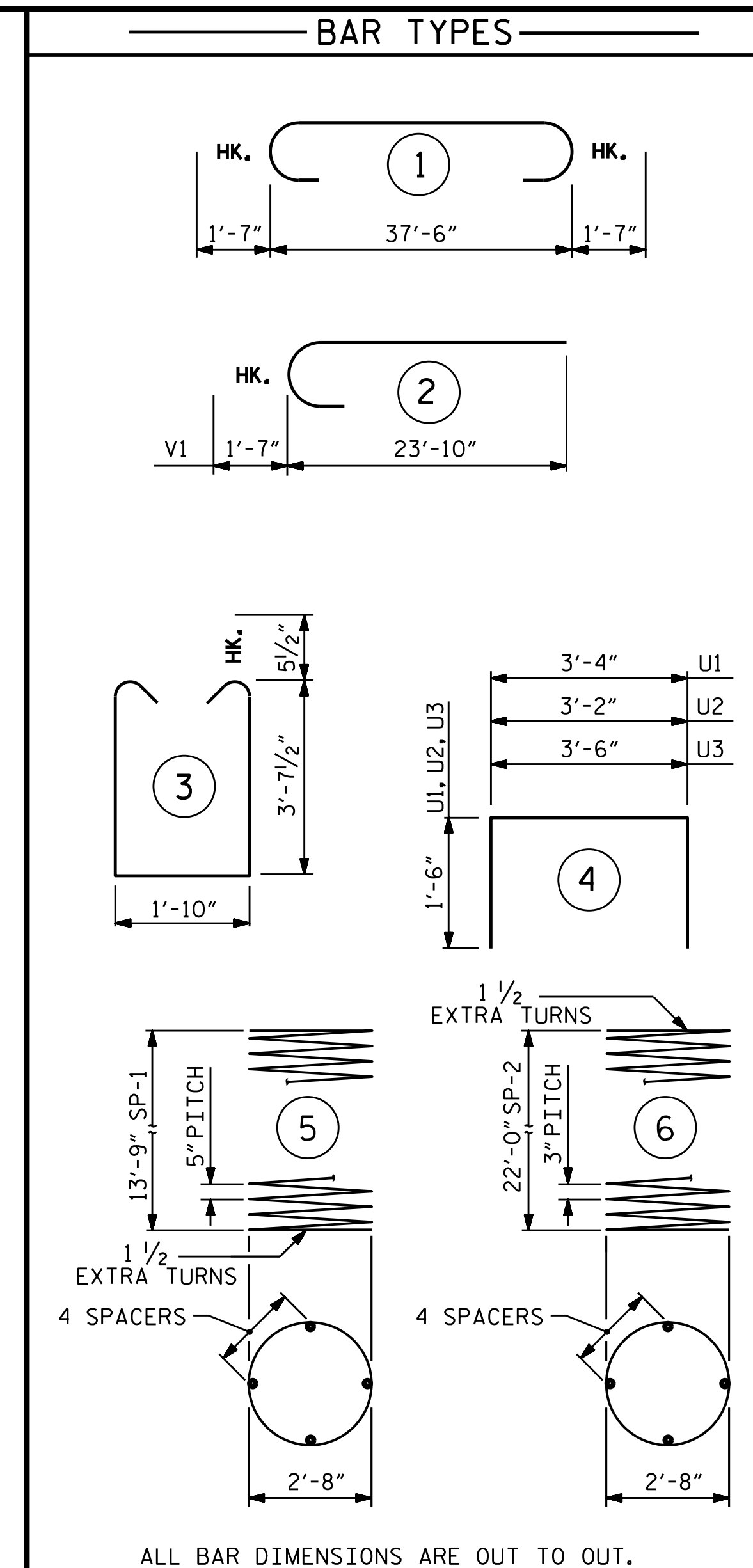

ALL BAR DIMENSIONS ARE OUT TO OUT.  
 \*\*\* THE SP-1 SPIRAL REINFORCING STEEL SHALL BE W31 OR D-31 COLD DRAWN WIRE OR #5 PLAIN OR DEFORMED BAR.  
 \*\* THE SP-2 SPIRAL REINFORCING STEEL SHALL BE W20 OR D-20 COLD DRAWN WIRE OR #4 PLAIN OR DEFORMED BAR.

BILL OF MATERIAL					
BENT 2					
BAR	NO.	SIZE	TYPE	LENGTH	WEIGHT
B1	11	#11	STR	37'-8"	2,201
B2	7	#11	1	40'-8"	1,512
B3	8	#5	STR	37'-8"	314
B4	7	#4	STR	15'-8"	73
M1	26	#11	STR	22'-4"	3,085
S1	96	#5	3	10'-0"	1001
U1	43	#4	4	6'-4"	182
U2	8	#4	4	6'-2"	33
U3	6	#4	4	6'-6"	26
V1	26	#11	2	25'-5"	3,511

REINFORCING STEEL \_\_\_\_\_ 11,938 LBS.

SPIRAL COLUMN REINFORCING STEEL					
SP	NO.	SIZE	TYPE	LENGTH	WEIGHT
SP-1	2	***	5	285'-0"	595
SP-2	2	**	6	739'-0"	987

TOTAL SPIRAL COLUMN REINFORCING STEEL \_\_\_\_\_ 1,582 LBS.

CLASS A CONCRETE BREAKDOWN

POUR 2 (COLUMNS)	11.4 CU.YDS.
POUR 3 (CAP)	21.3 CU.YDS.

TOTAL CLASS A CONCRETE 32.7 CU.YDS.

3'-6" Ø DRILLED PIERS

DRILLED PIER CONCRETE POUR 1 (DRILLED PIERS)	10.2 CU.YDS.
--	--------------

PROJECT NO. B-5670  
 NASH COUNTY  
 STATION: 16+98.00 -L-

SHEET 2 OF 2



STATE OF NORTH CAROLINA  
 DEPARTMENT OF TRANSPORTATION  
 RALEIGH  
 SUBSTRUCTURE  
 BENT #2

DRAWN BY: M.M. AHMED DATE: 06/22  
 CHECKED BY: S. WANCE DATE: 06/22  
 DESIGN ENGINEER OF RECORD: M.M. AHMED DATE: 07/2020

DOCUMENT NOT CONSIDERED  
 FINAL UNLESS ALL  
 SIGNATURES COMPLETED

REVISIONS						SHEET NO.
NO.	BY:	DATE:	NO.	BY:	DATE:	S-32
1			3			TOTAL SHEETS
2			4			40