

SECTION A-A

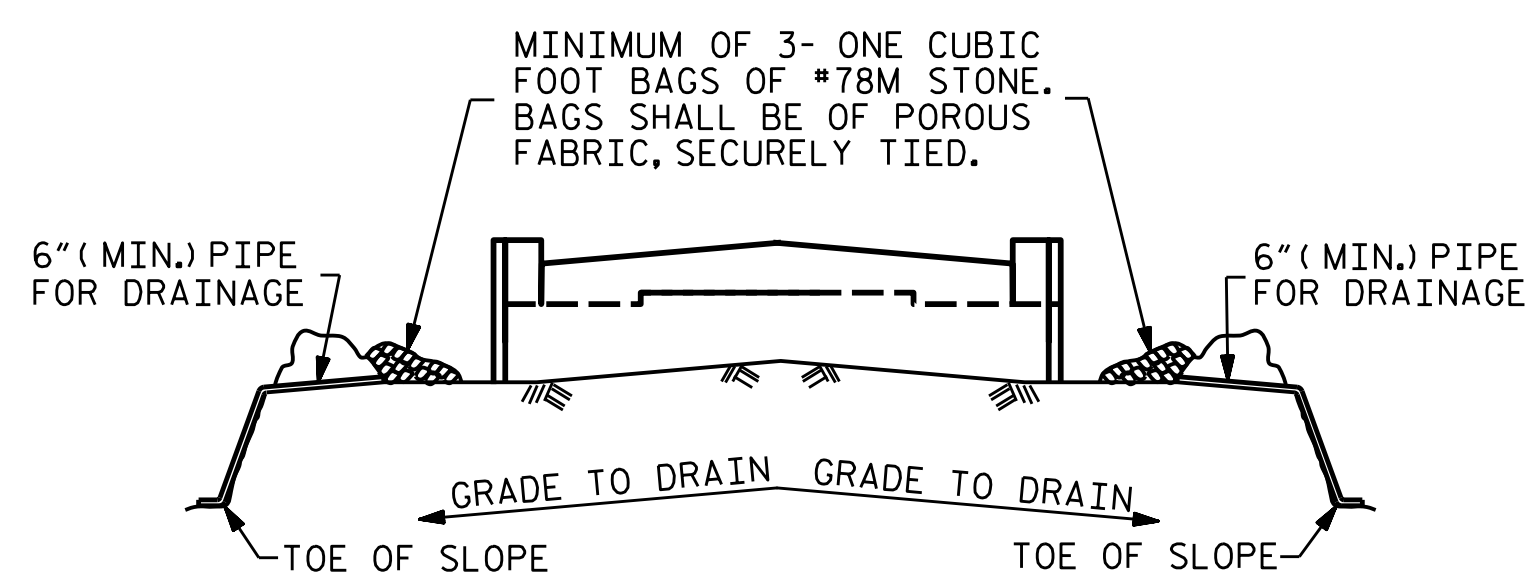

BAGGED STONE AND PIPE SHALL BE PLACED IMMEDIATELY AFTER COMPLETION OF END BENT EXCAVATION. PIPE MAY BE EITHER CONCRETE, CORRUGATED STEEL, CORRUGATED ALUMINUM ALLOY, OR CORRUGATED PLASTIC. PERFORATED PIPE WILL NOT BE ALLOWED.

BAGGED STONE SHALL REMAIN IN PLACE UNTIL THE ENGINEER DIRECTS THAT IT BE REMOVED. THE CONTRACTOR SHALL REMOVE AND DISPOSE OF SILT ACCUMULATIONS AT BAGGED STONE WHEN SO DIRECTED BY THE ENGINEER. BAGS SHALL BE REMOVED AND REPLACED WHENEVER THE ENGINEER DETERMINES THAT THEY HAVE DETERIORATED AND LOST THEIR EFFECTIVENESS.

NO SEPARATE PAYMENT WILL BE MADE FOR THIS WORK AND THE ENTIRE COST OF THIS WORK SHALL BE INCLUDED IN THE UNIT CONTRACT PRICE BID FOR THE SEVERAL PAY ITEMS.

**TEMPORARY DRAINAGE AT END BENT**

DRAWN BY : M.M. AHMED DATE : 05/22  
 CHECKED BY : S. WANCE DATE : 06/22  
 DESIGN ENGINEER OF RECORD: M.M. AHMED DATE : 07/2020

9/20/2022  
 R:\Structures\Plans\0BD\401.B5670.SMU.Eb1.S03.630029.dgn  
 oabr.ohd

BAR TYPES

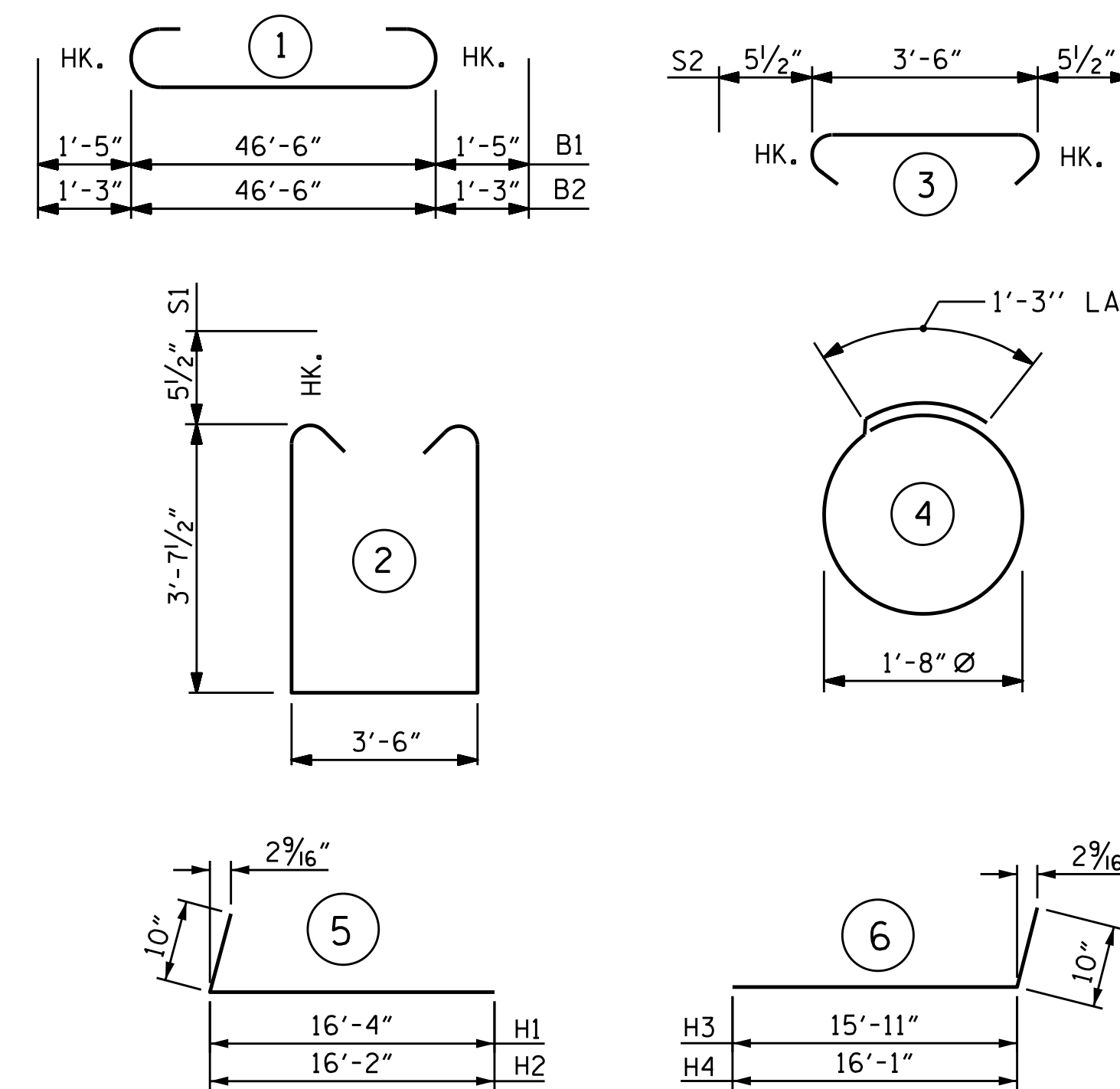

ALL BAR DIMENSIONS ARE OUT TO OUT.

BILL OF MATERIAL

INTEGRAL END BENT #1

BAR	NO.	SIZE	TYPE	LENGTH	WEIGHT
B1	4	#10	1	49'-4"	849
B2	5	#9	1	49'-0"	833
B3	10	#5	STR	46'-6"	485
B4	8	#4	STR	24'-7"	131
B5	12	#4	STR	3'-6"	28
H1	8	#5	5	17'-2"	143
H2	8	#5	5	17'-0"	142
H3	8	#5	6	16'-9"	140
H4	8	#5	6	16'-11"	141
S1	56	#5	2	11'-8"	681
S2	56	#5	3	4'-5"	258
S3	28	#4	4	6'-6"	122
V1	78	#4	STR	5'-7"	291
V2	60	#4	STR	9'-4"	374

REINFORCING STEEL = 4618 LBS

CLASS A CONCRETE  
 POUR #1 (CAP, CONCRETE COLLARS & LOWER PART OF WINGS) 32.4 C.Y.

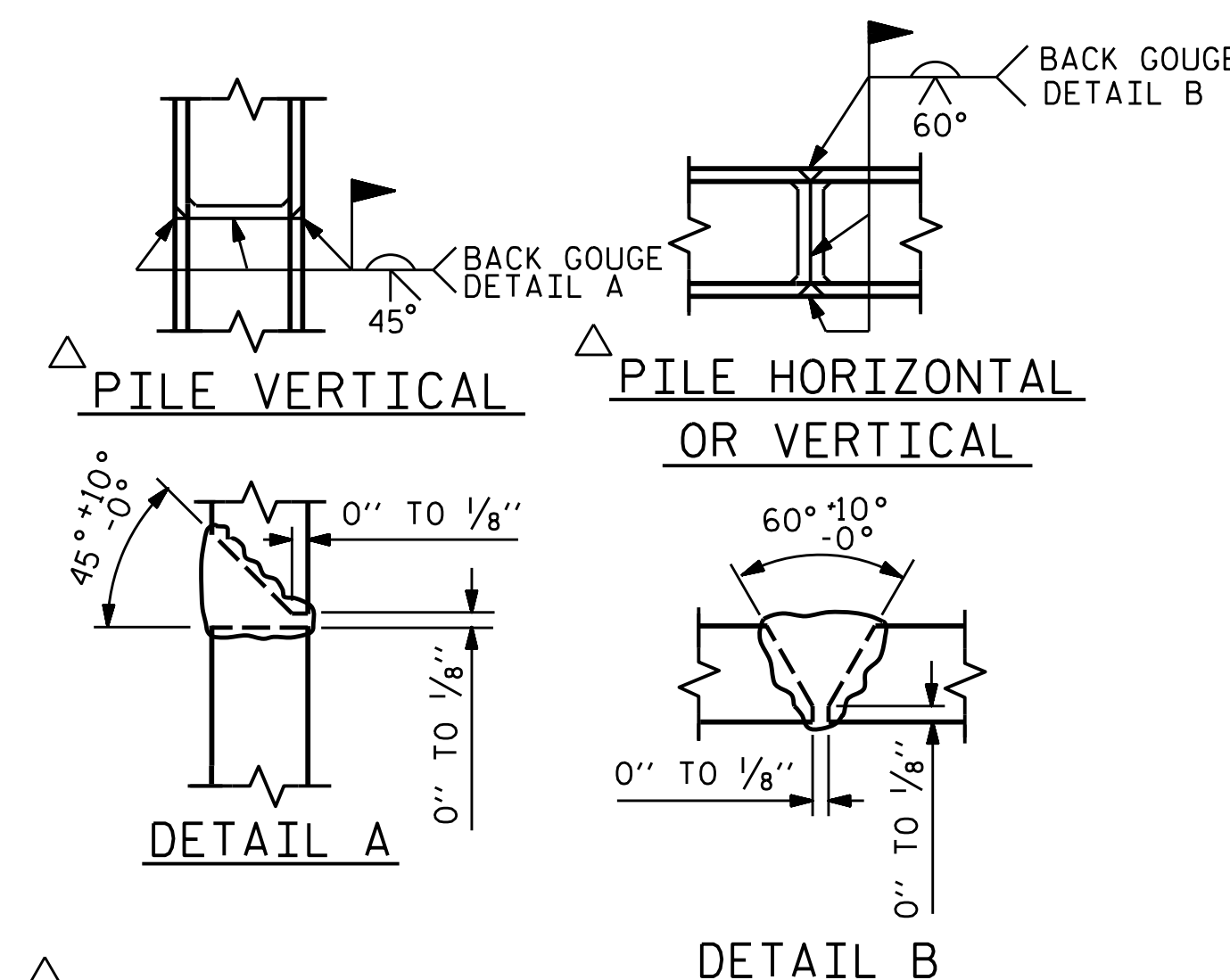

POSITION OF PILE DURING WELDING.  
**PILE SPLICE DETAILS**

PROJECT NO. B-5670  
 NASH COUNTY  
 STATION: 16+98.00 -L-

SHEET 3 OF 3



STATE OF NORTH CAROLINA  
 DEPARTMENT OF TRANSPORTATION  
 RALEIGH

SUBSTRUCTURE  
 INTEGRAL  
 END BENT 1

DOCUMENT NOT CONSIDERED  
 FINAL UNLESS ALL  
 SIGNATURES COMPLETED

REVISIONS						SHEET NO.
NO.	BY:	DATE:	NO.	BY:	DATE:	S-28
1			3			TOTAL SHEETS 40
2			4			