

TYPICAL SECTION AT INTEGRAL END BENT

SHOWING ABUTMENT WALL AT FILL FACE OF END BENTS. WINGS NOT SHOWN FOR CLARITY.

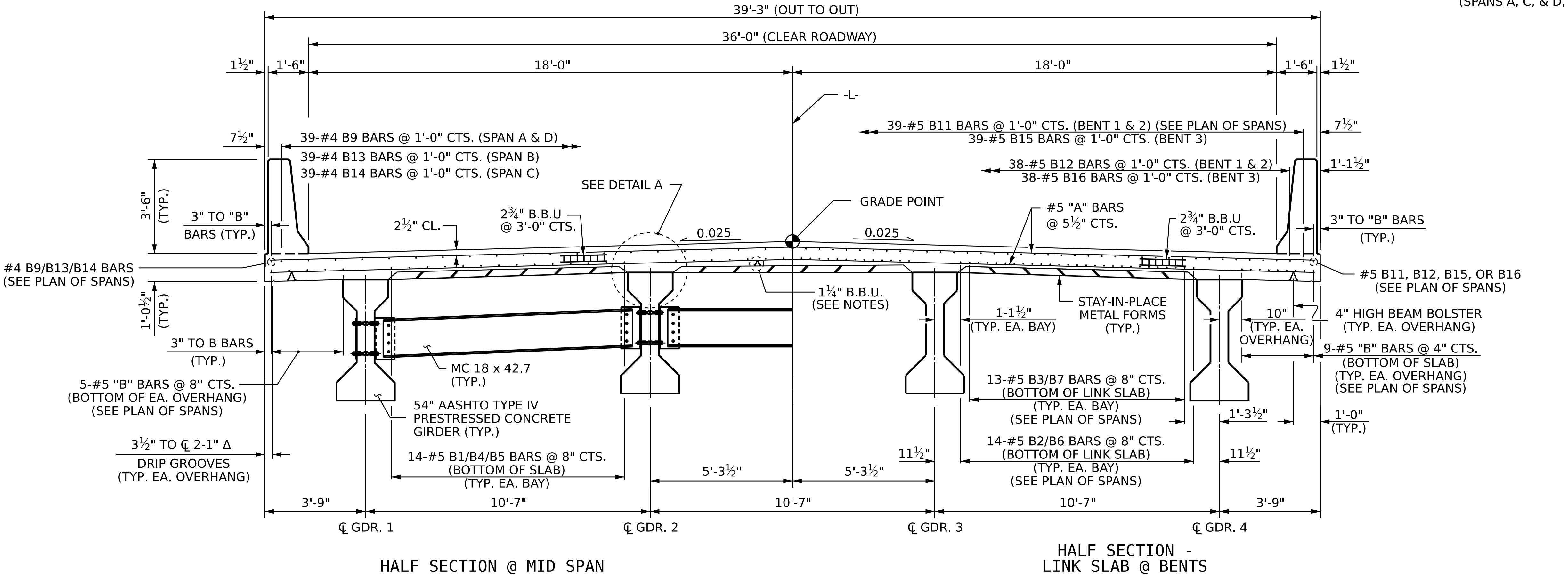

TYPICAL SECTION

2 SPAN CONTINUOUS FOR LIVELOAD WITH COMPOSITE DECK

NOTES

- PROVIDE 1 1/4" HIGH BEAM BOLSTERS UPPER AT 4'-0" CTS. ATOP THE METAL STAY-IN-PLACE FORMS TO SUPPORT THE BOTTOM MAT OF 'A' BARS.
- LONGITUDINAL STEEL MAY BE SHIFTED SLIGHTLY, AS NECESSARY, TO AVOID INTERFERENCE WITH STIRRUPS IN PRESTRESSED CONCRETE GIRDERS.
- PREVIOUSLY CAST CONCRETE IN A CONTINUOUS UNIT SHALL HAVE ATTAINED A MINIMUM COMPRESSIVE STRENGTH OF 3,000 PSI BEFORE ADDITIONAL CONCRETE IS CAST IN THE UNIT.
- FOR INTERMEDIATE STEEL DIAPHRAGMS DETAILS, SEE "INTERMEDIATE STEEL DIAPHRAGMS FOR TYPE IV PRESTRESSED CONCRETE GIRDERS SHEET."
- METAL STAY-IN-PLACE FORMS SHALL NOT BE WELDED TO THE SUPPORT ANGLES WITHIN THE LINK SLAB AREAS. SEE "PLAN OF SPANS" SHEETS FOR LOCATION.

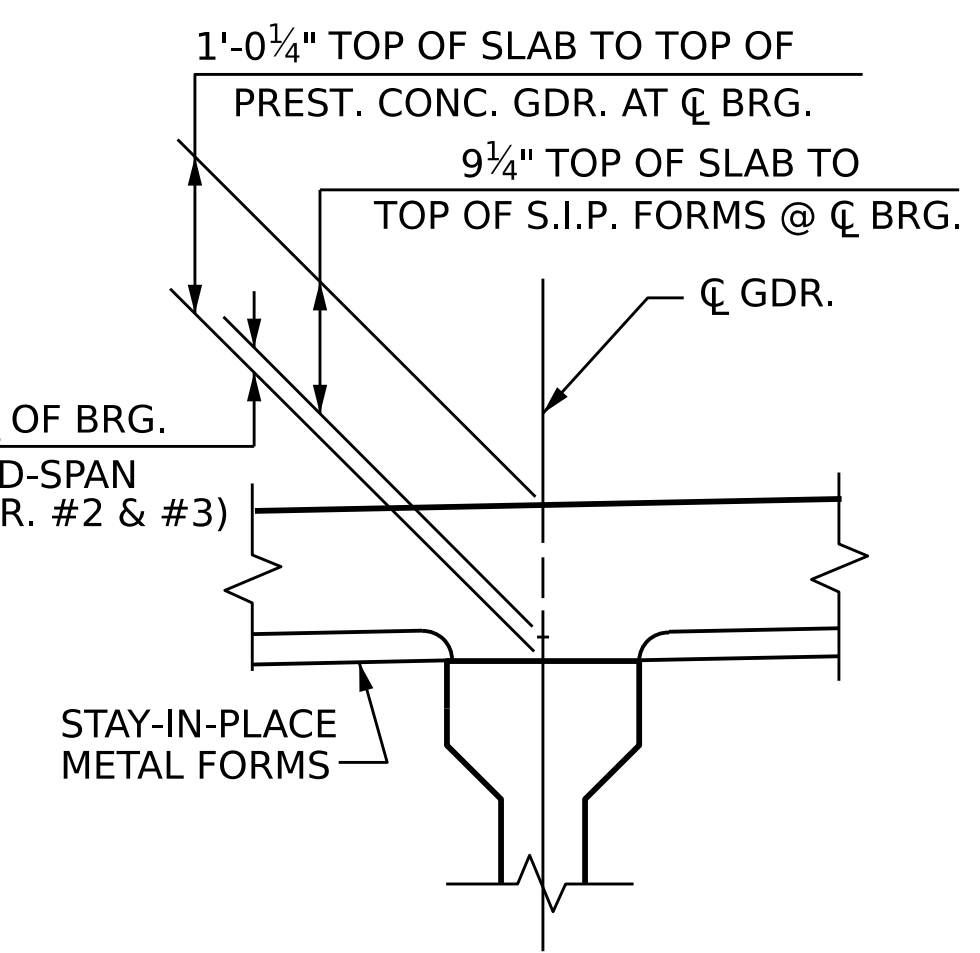

DETAIL "A"

*BASED ON PREDICTED FINAL CAMBER AND THEORETICAL GRADE LINE ELEVATIONS.

PROJECT NO. **B-5670**
NASH COUNTY
 STATION: **16+98.00 -L-**

SHEET 1 OF 2

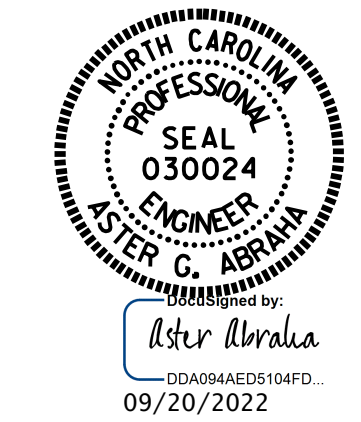

STATE OF NORTH CAROLINA
 DEPARTMENT OF TRANSPORTATION
 RALEIGH

**SUPERSTRUCTURE
 TYPICAL SECTION**

DRAWN BY: G. AYES DATE: 12/2021
 CHECKED BY: M. M. AHMED DATE: 3/2022
 DESIGN ENGINEER OF RECORD: M. M. AHMED DATE: 4/2020

DOCUMENT NOT CONSIDERED FINAL UNLESS ALL SIGNATURES COMPLETED

REVISIONS		SHEET NO.	
NO.	BY:	DATE:	NO.
1			3
2			4
			S-6
			TOTAL SHEETS 40