

UTILITIES BY OTHERS

NOTE:
 ALL PROPOSED UTILITY WORK SHOWN ON THIS SHEET WILL BE DONE BY OTHERS. NO PAYMENT WILL BE MADE TO THE CONTRACTOR FOR PROPOSED UTILITY WORK SHOWN ON THIS SHEET.

8/17/99
 02-JUN-2022 10:39
 N:\2018\251610134523 B-5670 Utilities\250_002_B-5670_ut_r.dwg04_U002_psh.dgn
 \$\$\$SUSSEKNAME\$\$\$

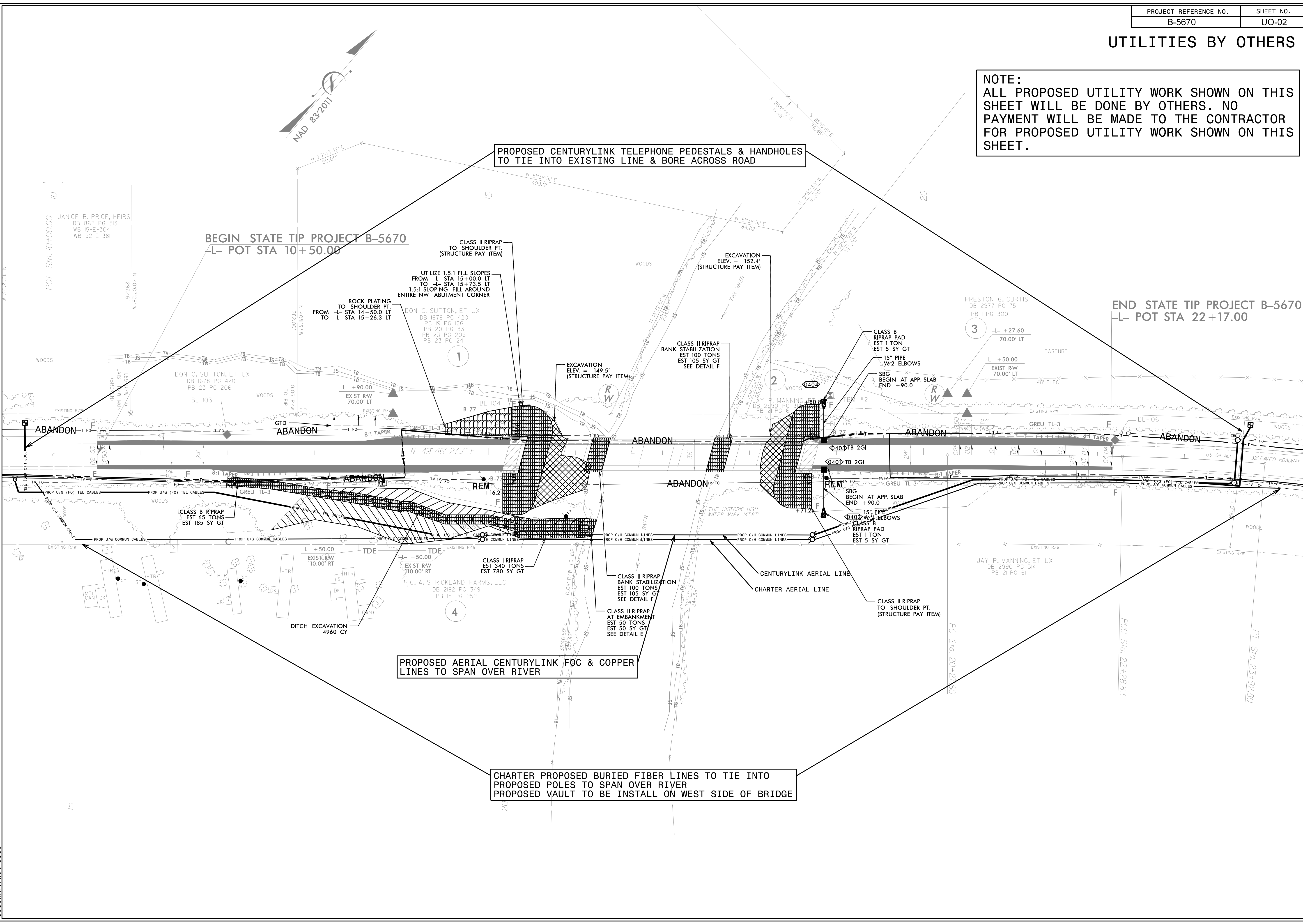

PROPOSED CENTURYLINK TELEPHONE PEDESTALS & HANDHOLES TO TIE INTO EXISTING LINE & BORE ACROSS ROAD

BEGIN STATE TIP PROJECT B-5670
 -L- POT STA 10+50.00

END STATE TIP PROJECT B-5670
 -L- POT STA 22+17.00

PROPOSED AERIAL CENTURYLINK FOC & COPPER LINES TO SPAN OVER RIVER

CHARTER PROPOSED BURIED FIBER LINES TO TIE INTO PROPOSED POLES TO SPAN OVER RIVER
 PROPOSED VAULT TO BE INSTALL ON WEST SIDE OF BRIDGE

CLASS II RIPRAP TO SHOULDER PT. (STRUCTURE PAY ITEM)
 UTILIZE 1.5:1 FILL SLOPES FROM -L- STA 15+00.0 LT TO -L- STA 15+73.5 LT 1.5:1 SLOPING FILL AROUND ENTIRE NW ABUTMENT CORNER
 ROCK PLATING TO SHOULDER PT. FROM -L- STA 14+50.0 LT TO -L- STA 15+26.3 LT
 DON C. SUTTON, ET UX
 DB 1678 PG 420
 PB 19 PG 126
 PB 20 PG 83
 PB 23 PG 206
 PB 23 PG 241

EXCAVATION ELEV. = 152.4' (STRUCTURE PAY ITEM)

CLASS II RIPRAP BANK STABILIZATION EST 100 TONS EST 105 SY GT SEE DETAIL F

EXCAVATION ELEV. = 149.5' (STRUCTURE PAY ITEM)

CLASS B RIPRAP PAD EST 1 TON EST 5 SY GT
 15" PIPE W/2 ELBOWS
 SBG BEGIN AT APP. SLAB END +90.0

CLASS B RIPRAP EST 65 TONS EST 185 SY GT

CLASS I RIPRAP EST 340 TONS EST 780 SY GT
 C. A. STRICKLAND FARMS, LLC
 DB 2192 PG 349
 PB 15 PG 252

CLASS II RIPRAP BANK STABILIZATION EST 100 TONS EST 105 SY GT SEE DETAIL F
 CLASS II RIPRAP AT EMBANKMENT EST 50 TONS EST 50 SY GT SEE DETAIL E

CLASS II RIPRAP TO SHOULDER PT. (STRUCTURE PAY ITEM)

DITCH EXCAVATION 4960 CY

CENTURYLINK AERIAL LINE
 CHARTER AERIAL LINE

JAY P. MANNING, ET UX
 DB 2990 PG 314
 PB 21 PG 61

