

STATE OF NORTH CAROLINA  
DIVISION OF HIGHWAYS

**TRANSPORTATION MANAGEMENT PLAN**

**NASH COUNTY**

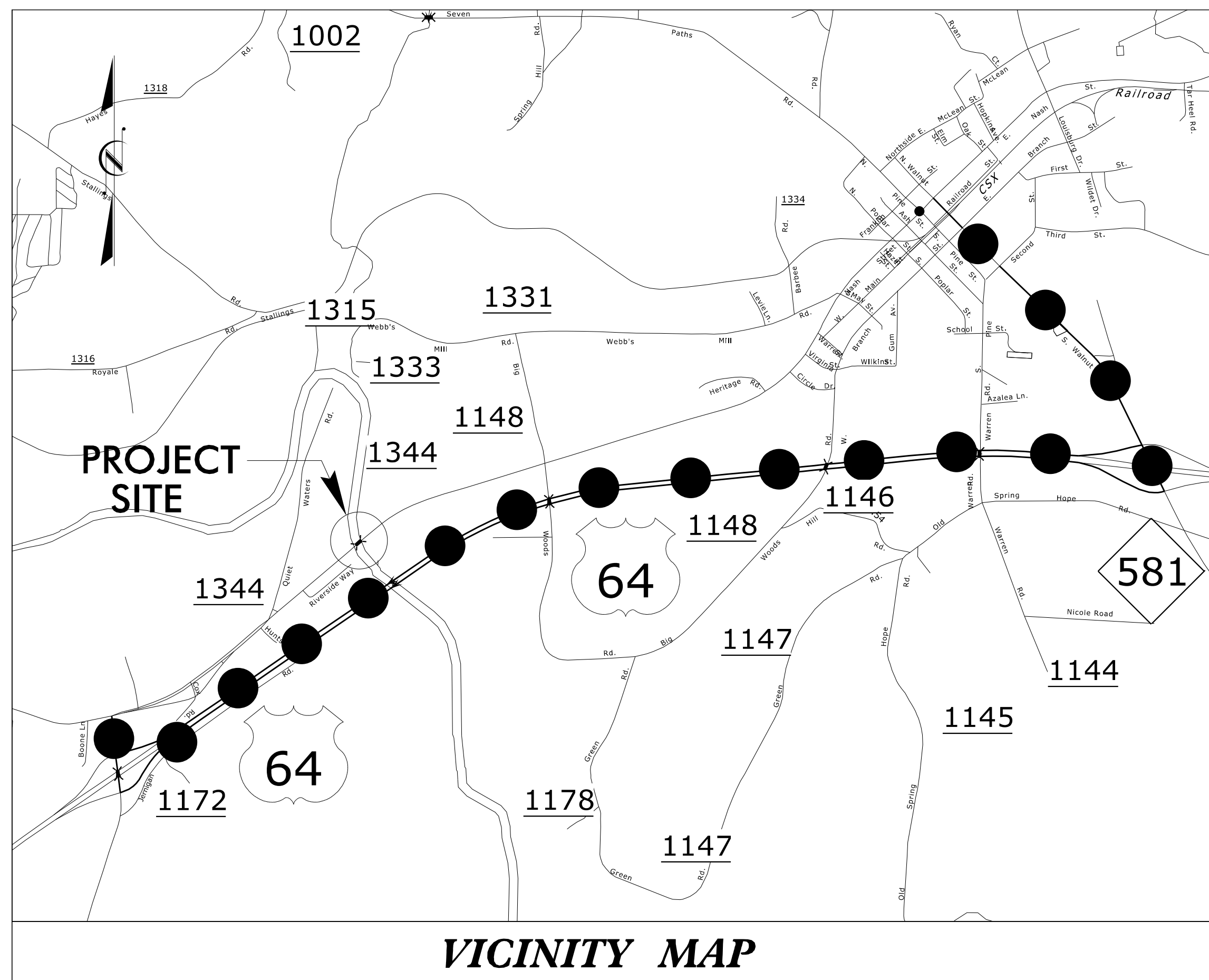
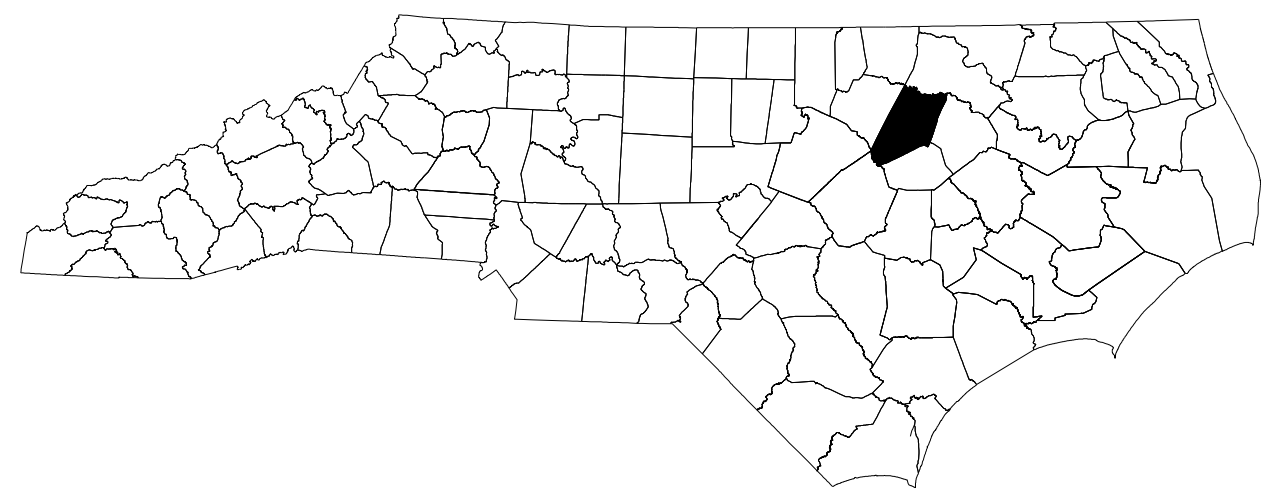

**VICINITY MAP**

**LOCATION: BRIDGE NO. 29 OVER  
TAR RIVER ON US 64 ALT**



<b>INDEX OF SHEETS</b>	
SHEET NO.	TITLE
TMP-1	TITLE SHEET, VICINITY MAP, AND INDEX OF SHEETS
TMP-1A	LIST OF APPLICABLE ROADWAY STANDARD DRAWINGS AND LEGEND
TMP-1B	TRANSPORTATION OPERATIONS PLAN: (MANAGEMENT STRATEGIES, GENERAL NOTES, LOCAL NOTES, AND TEMPORARY TRAFFIC CONTROL PHASING)
TMP-2	NO SHEET
TMP-3	OFFSITE DETOUR
TMP-4	OFFSITE DETOUR - INSET A

SHEET NO.  
TMP-1

7/1/2022 Ms\2018\251801945\23 B-5670\TrafficControl\TCP\B5670\_TC\_TMP\_01.dgn User:bryan.hough

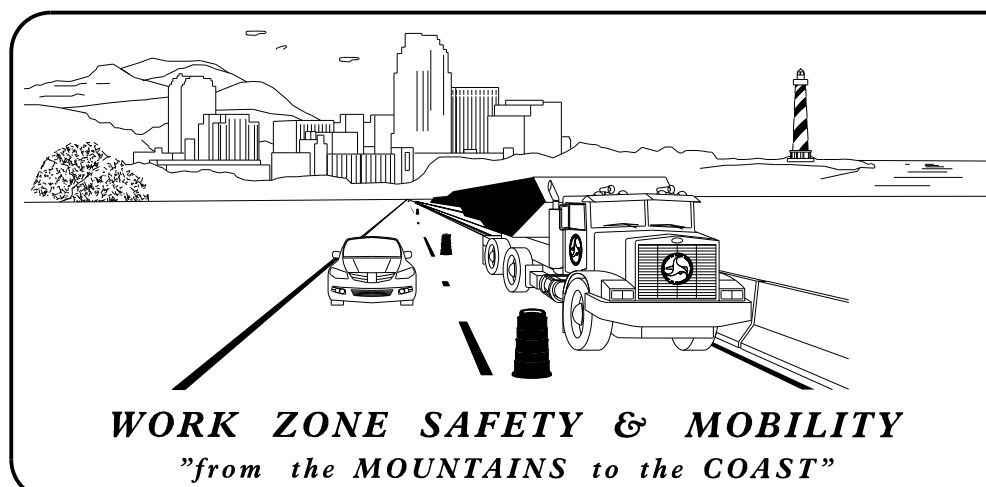

**N.C.D.O.T. WORK ZONE TRAFFIC CONTROL**  
1561 MAIL SERVICE CENTER (MSC) RALEIGH, NC 27699-1561  
750 N. GREENFIELD PARKWAY, GARNER, NC 27529 (DELIVERY)  
PHONE: (919) 773-2800 FAX: (919) 771-2745

J.E. HUMMER, PHD, PE STATE TRAFFIC MANAGEMENT ENGINEER  
D. A. PARKER, P.E. TRAFFIC CONTROL PROJECT ENGINEER  
SPENCER JENNINGS TRAFFIC CONTROL PROJECT DESIGN ENGINEER  
WILLIAM DEBREW TRAFFIC CONTROL DESIGN ENGINEER

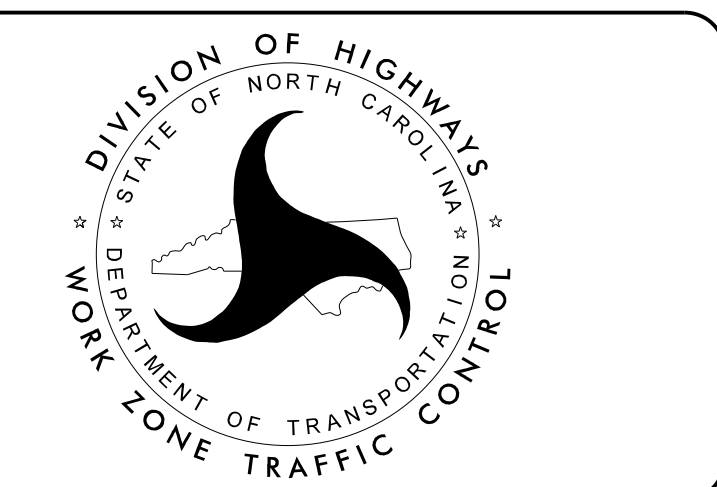

**KCI** ASSOCIATES OF N.C.  
CIVIL ENGINEERS  
ENVIRONMENTAL - CEI  
LAND SURVEYING  
SUBSURFACE UTILITY ENGINEERING  
4505 FALLS OF NEUSE ROAD  
SUITE 400  
RALEIGH, NORTH CAROLINA 27609  
(919) 783-9214  
WWW.KCI.COM

**DOCUMENT NOT CONSIDERED FINAL  
UNLESS ALL SIGNATURES COMPLETED**

APPROVED: 8/16/2022  
DATE: \_\_\_\_\_

SEAL

**TIP PROJECT: B-5670**