

09/06/99

15-FEB-2022 13:49
Z:\CAD\2016\160136C_NCDOT_B5670_ROW Staking_Nash\SURVEY\DGN\WORK\RW series\b5670.ls_rwl.dgn
F:\poythress AT JKA-021

TIP PROJECT: B-5670

STATE OF NORTH CAROLINA
DIVISION OF HIGHWAYS

SURVEY CONTROL, EXISTING CENTERLINES,
RIGHT OF WAY, EASEMENTS AND PROPERTY TIES

NASH COUNTY

STATE	STATE PROJECT REFERENCE NO.	SHEET NO.	TOTAL SHEETS
N.C.	B-5670	RW01	07

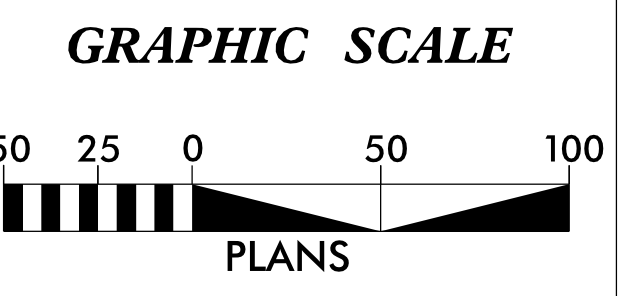
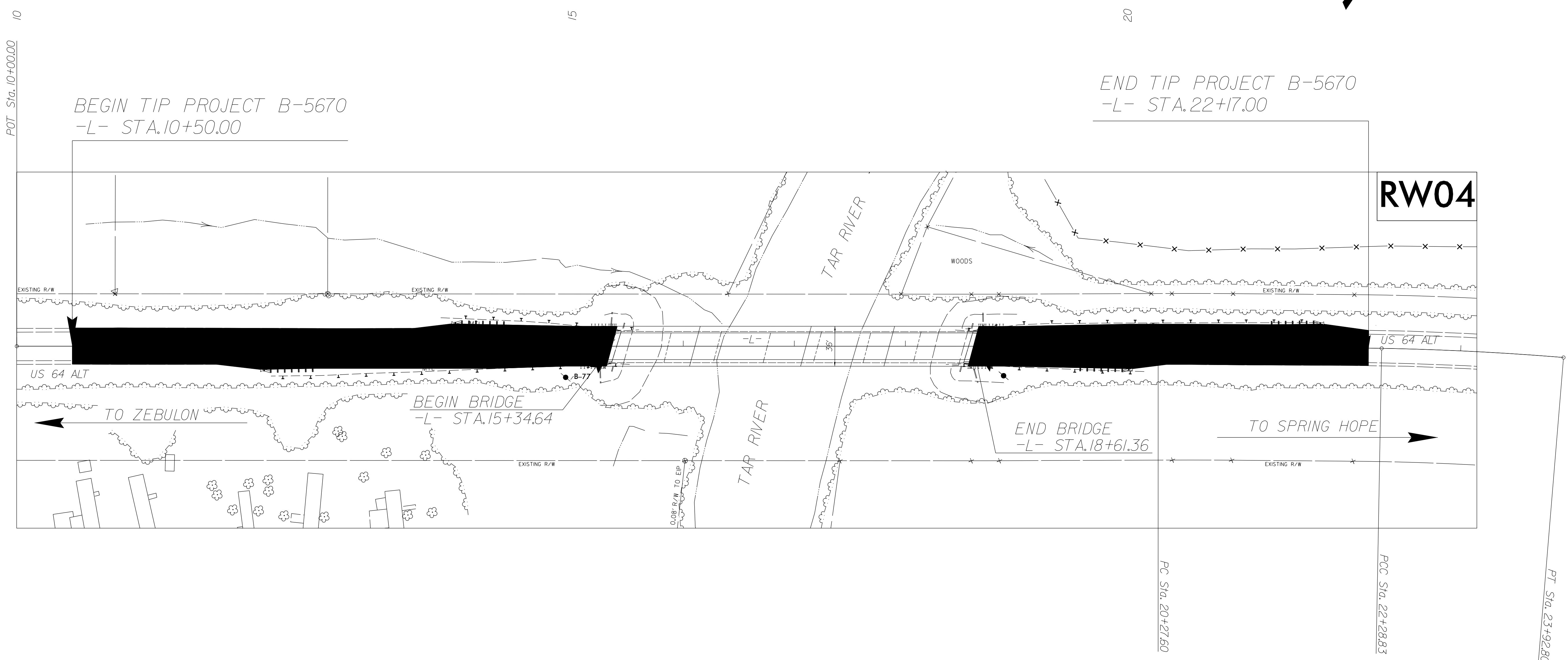
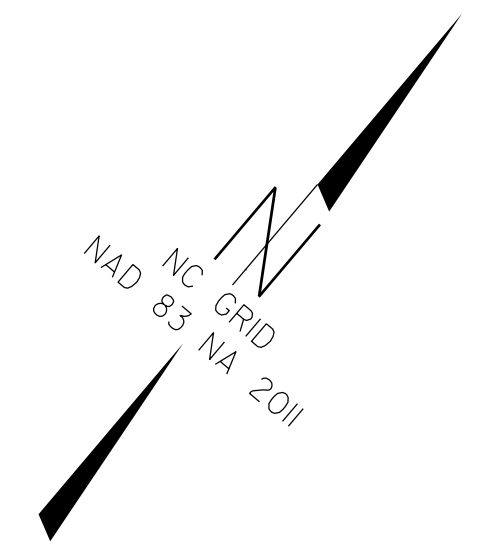

DATUM DESCRIPTION

THE LOCALIZED COORDINATE SYSTEM DEVELOPED FOR THIS PROJECT IS BASED ON THE STATE PLANE COORDINATES ESTABLISHED BY NCGS FOR MONUMENT NCDOT GPS-2 (B-5670-2) WITH NAD 83/NSRS 2011 STATE PLANE GRID COORDINATES OF NORTHING: 792469.420 EASTING: 2250692.145 ELEVATION: 237.181'

THE AVERAGE COMBINED GRID FACTOR USED ON THIS PROJECT (GROUND TO GRID) IS: 0.99993510

THE N.C. LAMBERT GRID BEARING AND LOCALIZED HORIZONTAL GROUND DISTANCE FROM "GPS-2 (B5670-2)" TO -L- STATION 10+00.00 IS N 46-49°10.54' E 841.32'

ALL LINEAR DIMENSIONS ARE LOCALIZED HORIZONTAL DISTANCES VERTICAL DATUM USED IS NAVD 88

Prepared in the Office of:

JoynerKeeny, PLLC
1051 N. Winstead Avenue
Rocky Mount, NC 27804
252-977-3124
North Carolina Firm Number P-0551

2018 STANDARD SPECIFICATIONS

RIGHT OF WAY DATE:
12/15/2021

LETTING DATE:
1/11/2022

PROFESSIONAL LAND SURVEYOR

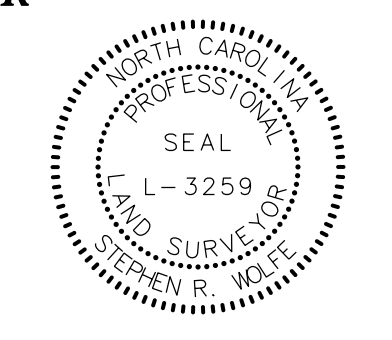

DocuSigned by:
Stephen Wolfe
30B6875F3940446...

16 February 2022
Date:

