

-LRPA-

Pls Sta 11+20.02 θs = 3° 33' 22.6" Ls = 180.00' LT = 120.02' ST = 60.02'	PI Sta 14+47.21 Δ = 20° 53' 00.0" (RT) D = 3° 57' 05.2" L = 528.50' T = 267.21' R = 1,450.00' SE = 0.08 RO = 240'	Pls Sta 17+68.52 θs = 3° 33' 22.6" Ls = 180.00' LT = 120.02' ST = 60.02'
--------------------------------------------------------------------------------------	----------------------------------------------------------------------------------------------------------------------------------------	--------------------------------------------------------------------------------------

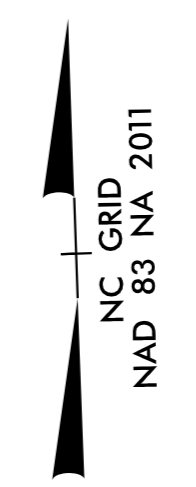

Kimley Horn

200 S. TRYON ST. • CHARLOTTE, NC 28202

RIGHT-OF-WAY REV.
CONST. REV.

PROJECT REFERENCE NO. 1-5973	SHEET NO. 5
RW SHEET NO.	
ROADWAY ENGINEER	HYDRAULICS ENGINEER
2/24/2022	2/24/2022

DOCUMENT NOT CONSIDERED FINAL
UNLESS ALL SIGNATURES COMPLETED

REVISIONS

K:\CHL_PR\01036453 - 1-5973 (1-485 Brookshire) Roadway\Pro\N-5973_roy_psh_5.dgn

2/23/2022

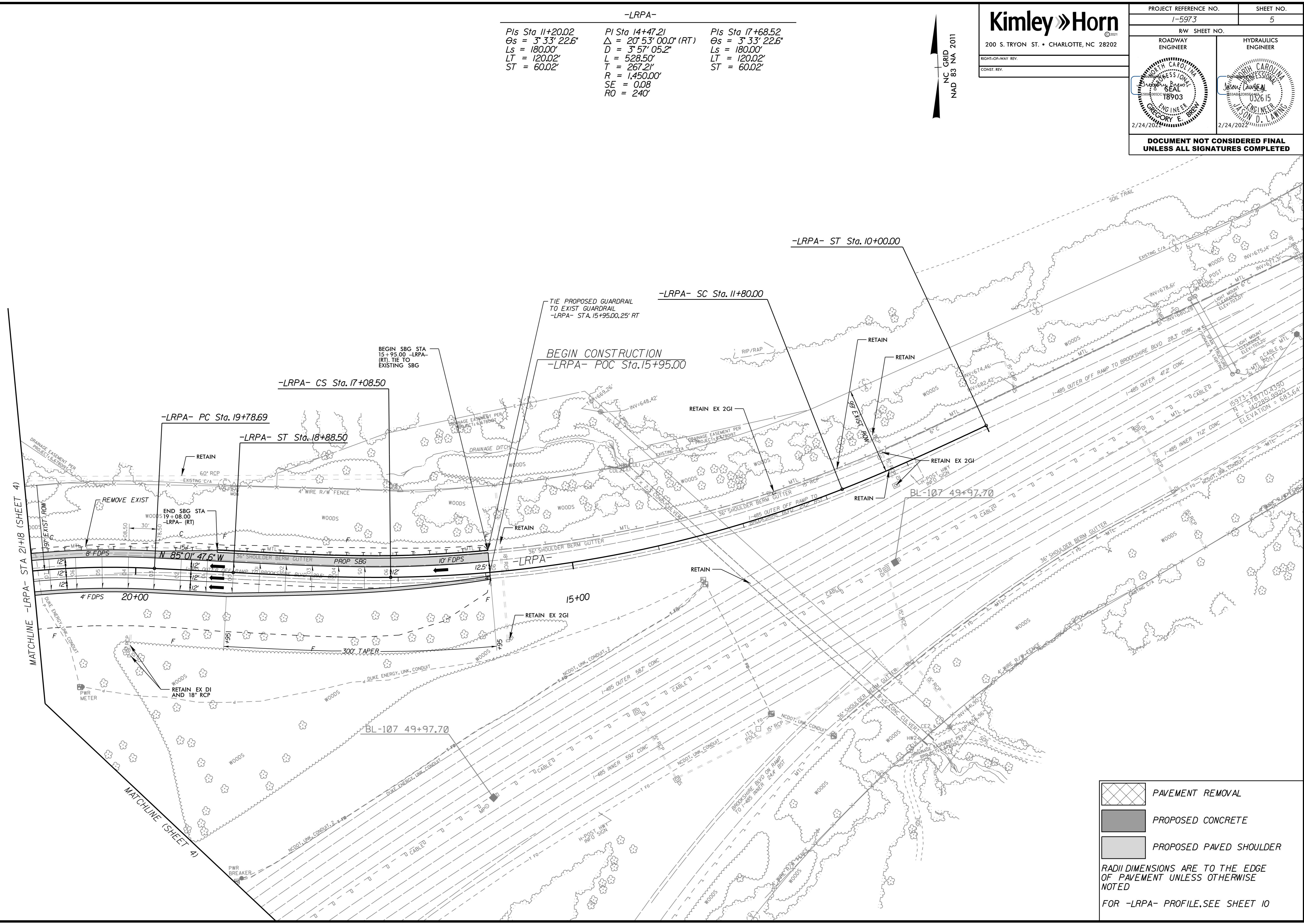

	PAVEMENT REMOVAL
	PROPOSED CONCRETE
	PROPOSED PAVED SHOULDER

RADI DIMENSIONS ARE TO THE EDGE OF PAVEMENT UNLESS OTHERWISE NOTED

FOR -LRPA- PROFILE, SEE SHEET 10