

Section A-A  
Sta 14+50 -L-

Section B-B  
Sta 16+00 -L-

Section C-C  
Sta 17+00 -L-

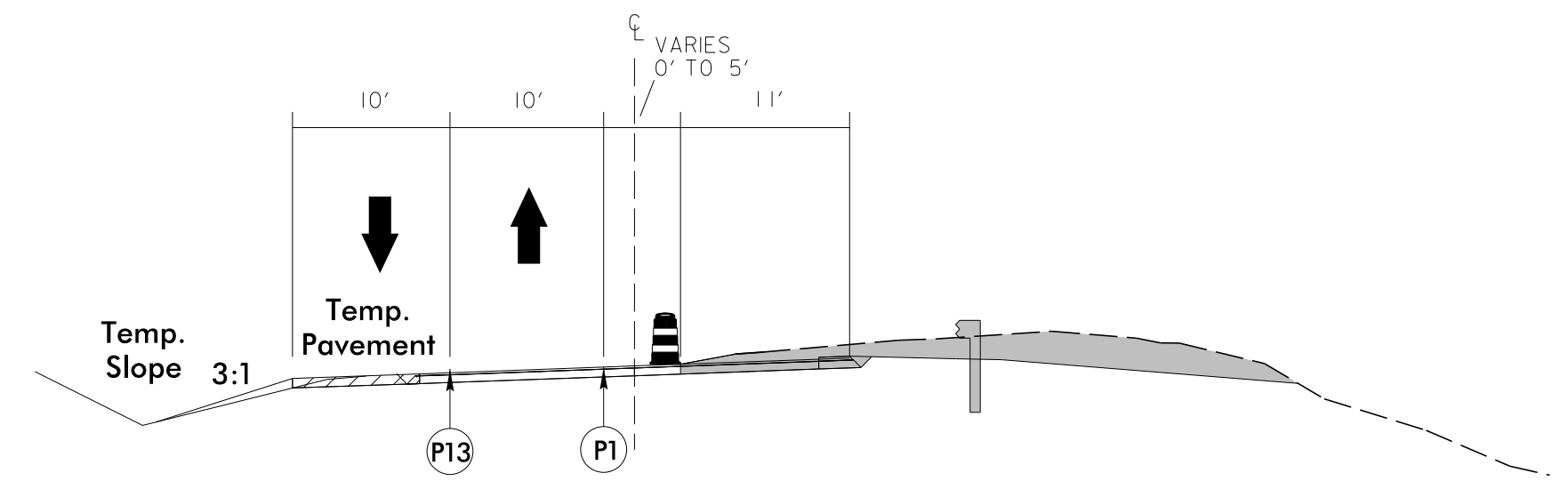
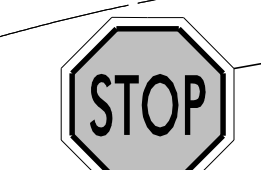
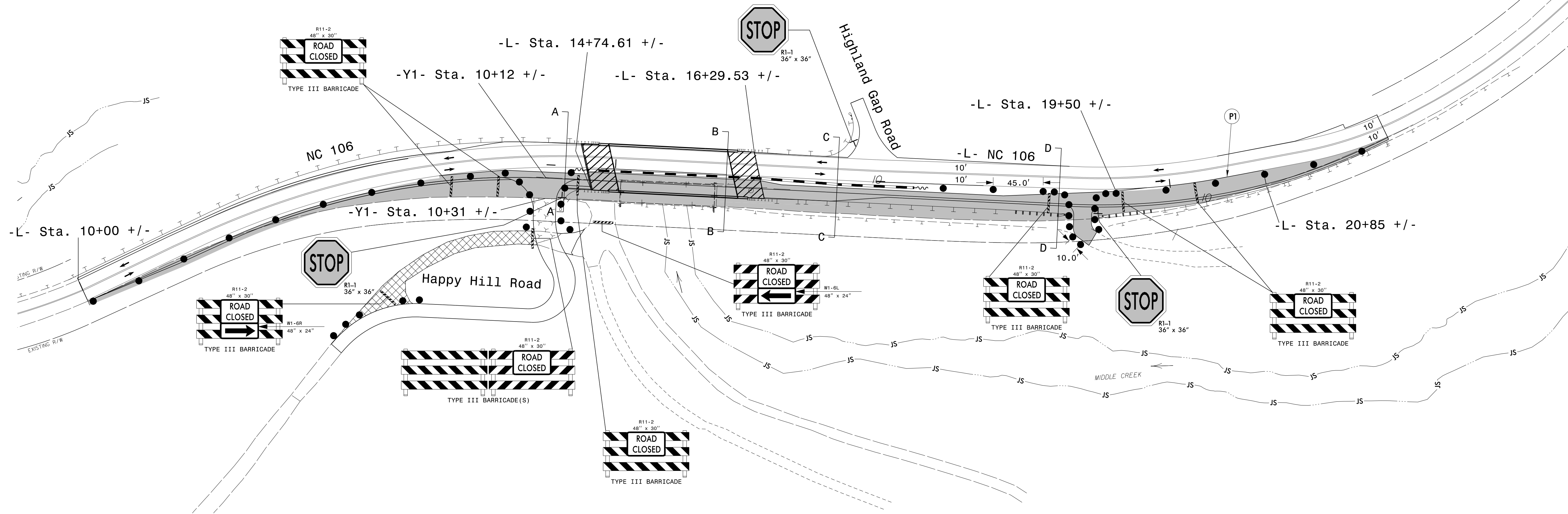

Section D-D  
Sta 19+00 -L-

NOTES:  
 1) SEE TMP-4 FOR INFORMATION ABOUT PORTABLE SIGNAL.  
 2) SEE RSD 1101.06, SHEET 1 OF 1 FOR PLACEMENT OF ADVANCED WARNING SIGNS FOR BLASTING ZONE. USE PORTABLE SIGNAL IN ALL RED TO STOP TRAFFIC FOR A MAXIMUM OF 20 MINUTES AT A TIME DURING PERMITTED HOURS FOR STOPPING TRAFFIC.

12/20/2021  
R:\BR0029\TrafficControl\TC\BR0029\_TC\_TCP2.dgn  
User:White

PLANS PREPARED BY:  
  
**DRMP**  
 ENGINEERS - PLANNERS - SCIENTISTS  
 DRMP, Inc.  
 8000 Regency Parkway, Suite 110  
 Cary, NC 27513  
 NC License No. 22213 (9/19) 650-1038

APPROVED:   
 DATE: 3/14/2022  
 SEAL

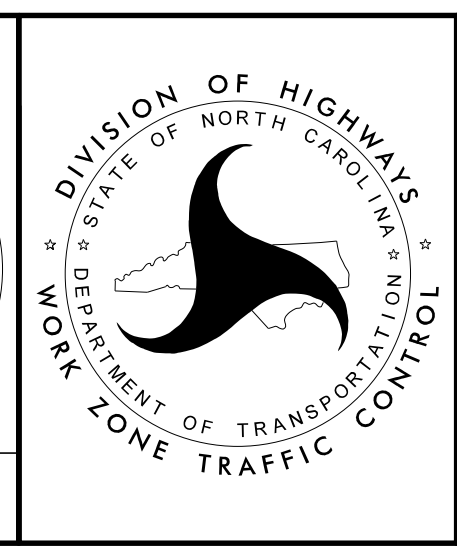

TEMPORARY TRAFFIC CONTROL  
PHASE 2