

NOTE:
THE ESTIMATED QUANTITY OF DUCTILE IRON WATER PIPE FITTINGS ON THIS PLAN SHEET IS 2,130 POUNDS. THE ACTUAL QUANTITY AND TYPE OF FITTINGS WILL VARY BASED ON FIELD CONDITIONS.

HINDE ENGINEERING
License No. C-2639
401 Harrison Oaks Blvd., Suite 220 Cary, NC 27513

DOCUMENT NOT CONSIDERED FINAL UNLESS ALL SIGNATURES COMPLETED

PROJECT REFERENCE NO. Y-4810K	SHEET NO. UC-9
DESIGNED BY: JKC	
DRAWN BY: JNA	
CHECKED BY: JKC	
APPROVED BY: CLS	
REVISED:	
NORTH CAROLINA DEPARTMENT OF TRANSPORTATION UTILITIES ENGINEERING SEC. PHONE: (919) 707-6690 FAX: (919) 250-4151	
UTILITY CONSTRUCTION PLANS ONLY	

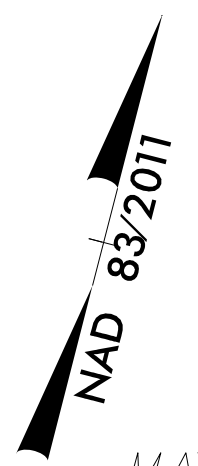

MATCHLINE SEE SHEET UC-17
-Y10A- STA 13+05.00

UTILITY CONSTRUCTION

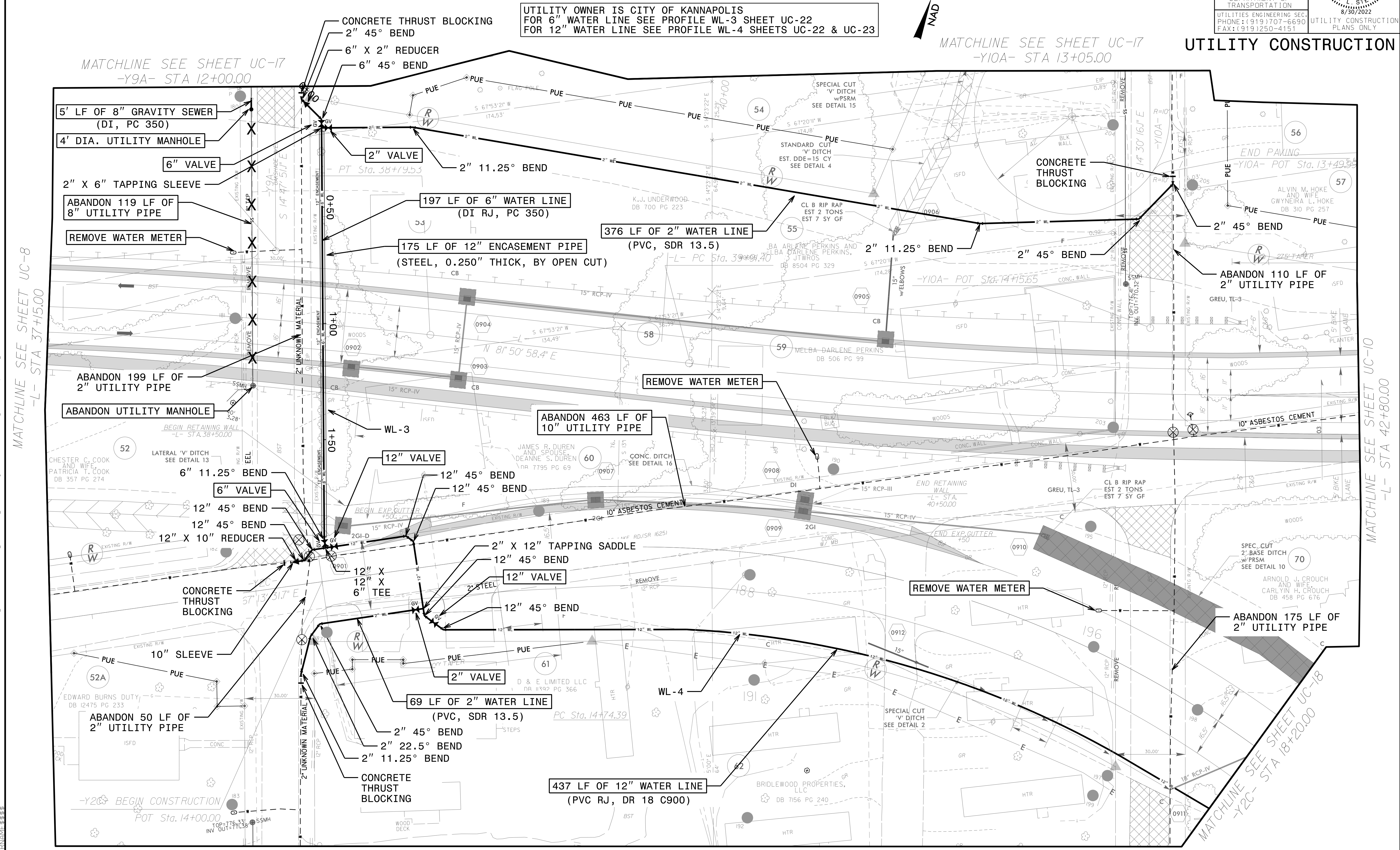

MATCHLINE SEE SHEET UC-8
-L- STA 37+15.00

MATCHLINE SEE SHEET UC-10
-L- STA 42+80.00

MATCHLINE SEE SHEET UC-18
-Y2C- STA 18+20.00

20-AUG-2022 12:53
 S:\5\PROJECTS\2017\A2017401.000\NCDOT_Y-4810K\Design\Utilities\Engineering\UC-Proj\Y4810K-ut-rdy9_UC09_psh.dgn
 338381171