

PROJECT REFERENCE NO.	SHEET NO.
Y-4810K	EC-24/CONST.08
RW SHEET NO.	
ROADWAY DESIGN ENGINEER	HYDRAULICS ENGINEER

FINAL GRADING
EROSION CONTROL FOR
CONSTRUCTION SHEET 08

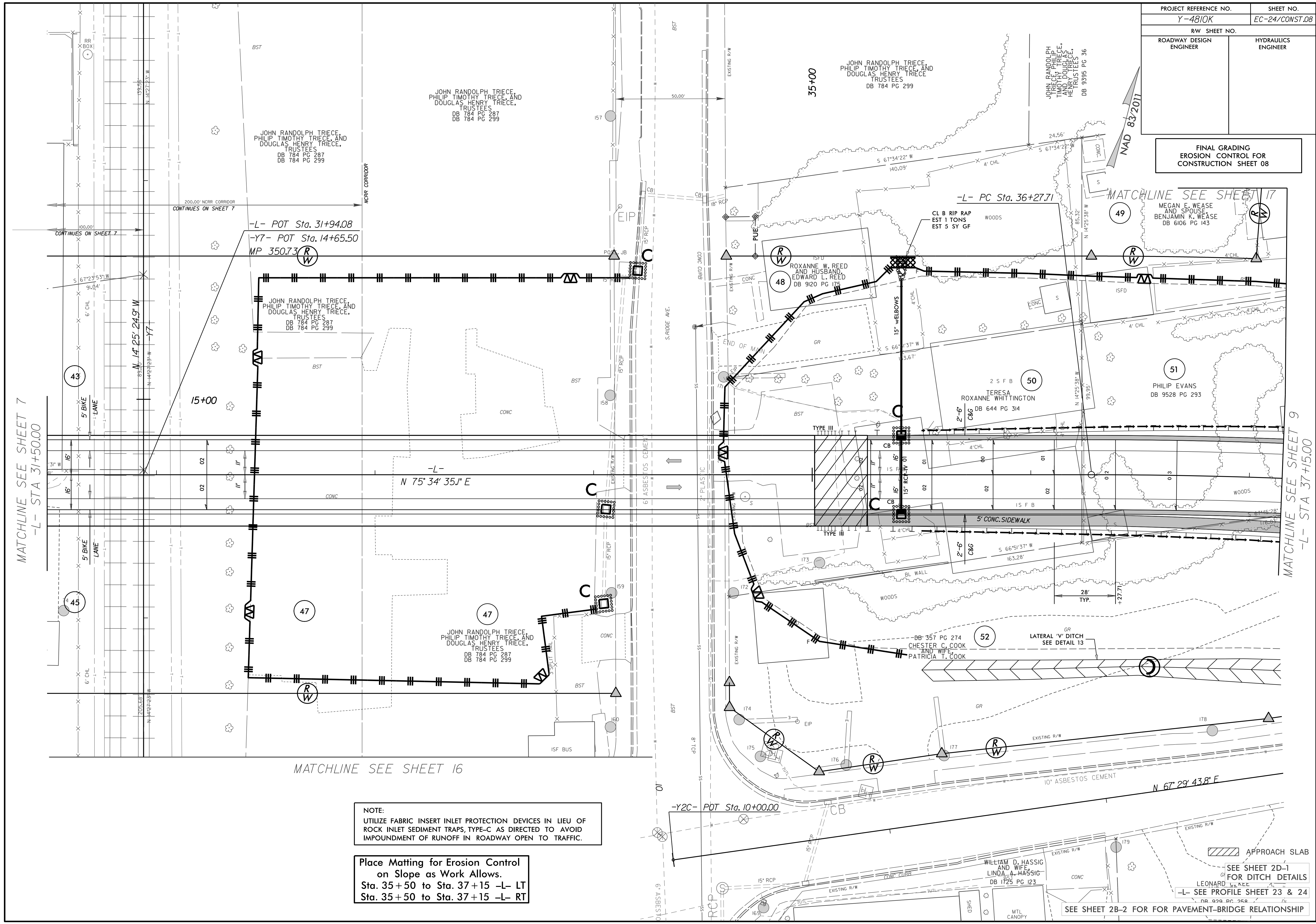

MATCHLINE SEE SHEET 7
-L- STA 31+50.00

MATCHLINE SEE SHEET 9
-L- STA 37+15.00

MATCHLINE SEE SHEET 16

NOTE:
UTILIZE FABRIC INSERT INLET PROTECTION DEVICES IN LIEU OF
ROCK INLET SEDIMENT TRAPS, TYPE-C AS DIRECTED TO AVOID
IMPOUNDMENT OF RUNOFF IN ROADWAY OPEN TO TRAFFIC.

Place Matting for Erosion Control
on Slope as Work Allows.
Sta. 35+50 to Sta. 37+15 -L- LT
Sta. 35+50 to Sta. 37+15 -L- RT

SEE SHEET 2D-1
FOR DITCH DETAILS
LEONARD, W. REE
-L- SEE PROFILE SHEET 23 & 24
DB 929 PG 258

SEE SHEET 2B-2 FOR FOR PAVEMENT-BRIDGE RELATIONSHIP