

USE RSD 1101.03,
SHEET 2 OF 9 FOR
ADVANCE SIGNING

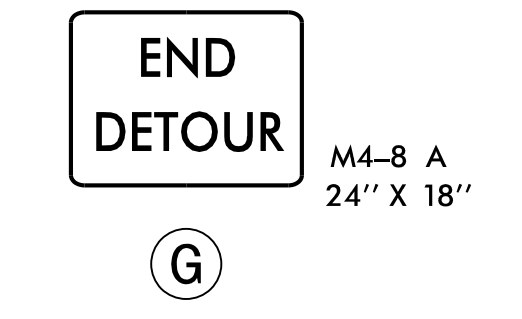

* DURING CLOSURE:
- SET SIGNALS TO FLASHING MODE
- DRUM-OFF LEFT-TURN LANE

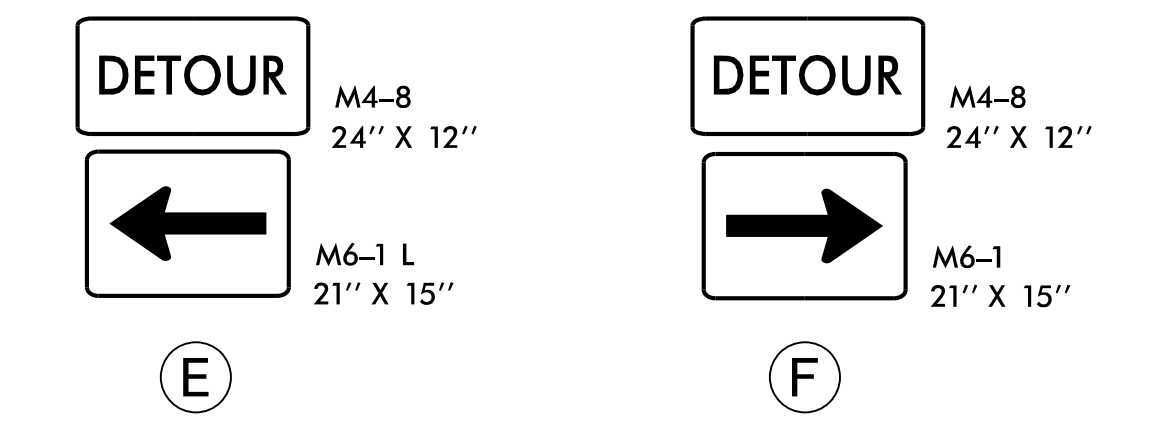
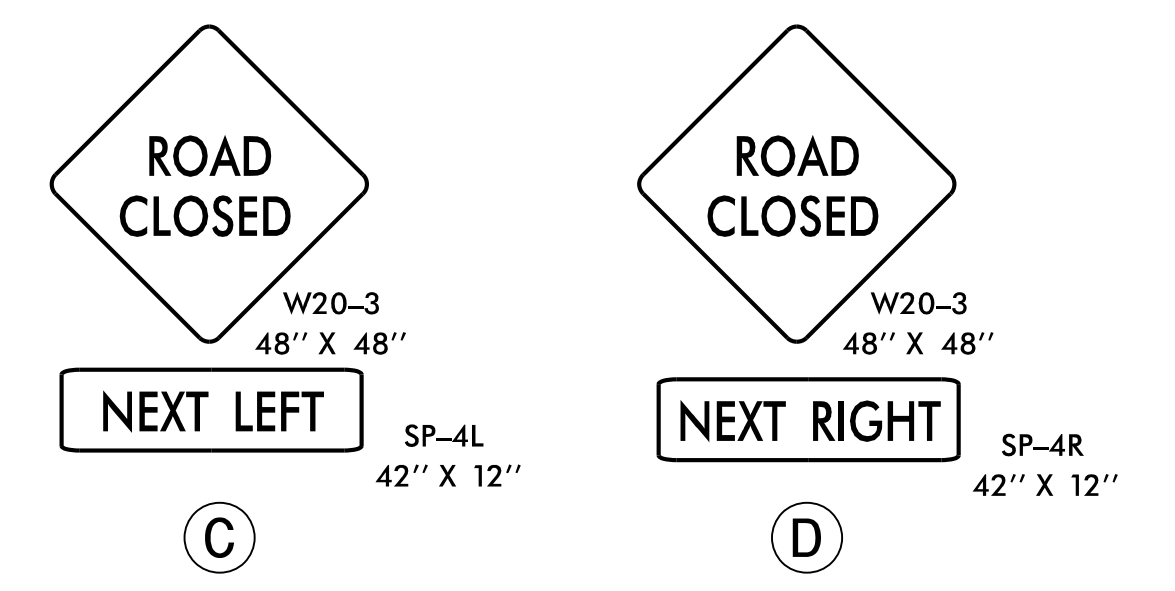
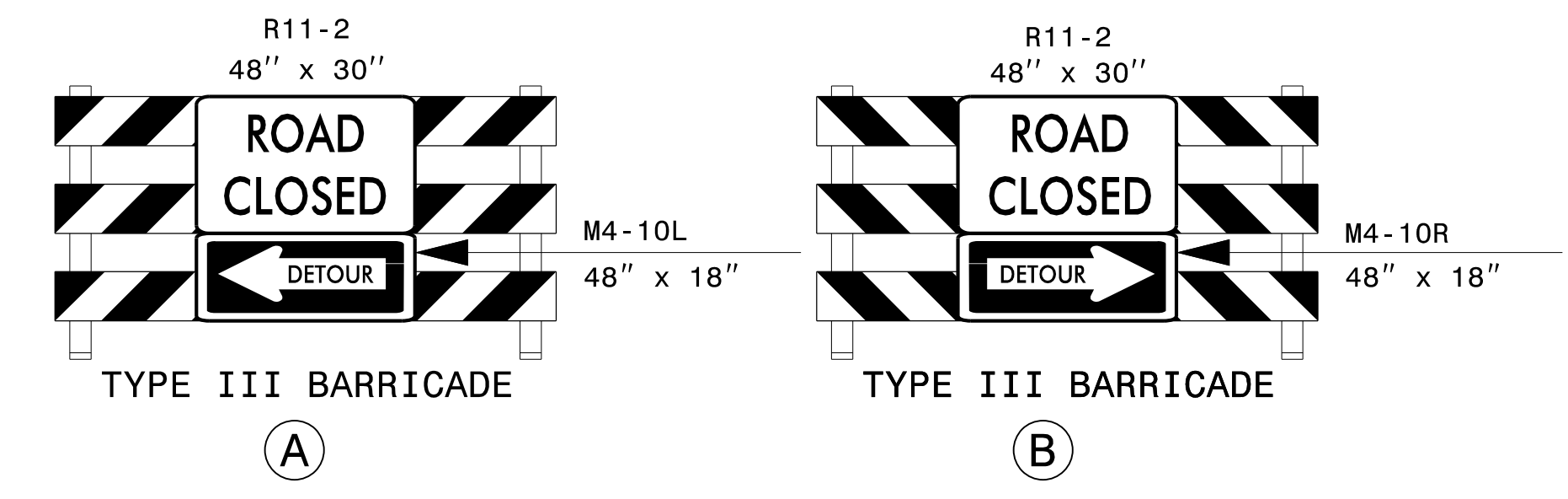
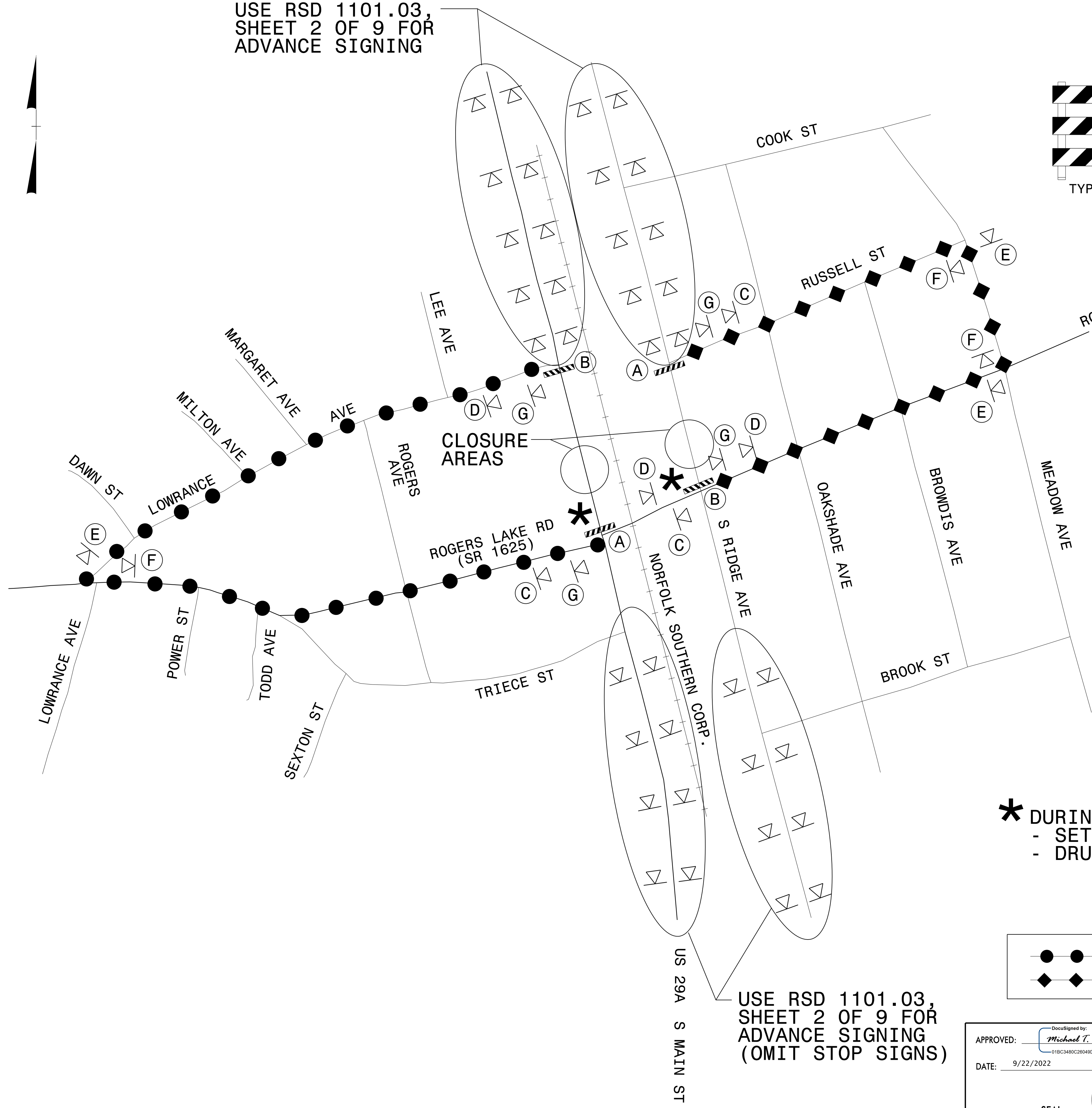
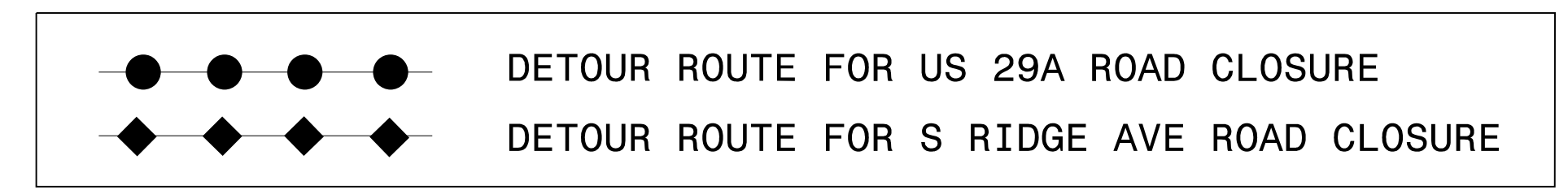

USE RSD 1101.03,
SHEET 2 OF 9 FOR
ADVANCE SIGNING
(OMIT STOP SIGNS)

APPROVED: *Michael T. Rzepka*
DATE: 9/22/2022
SEAL

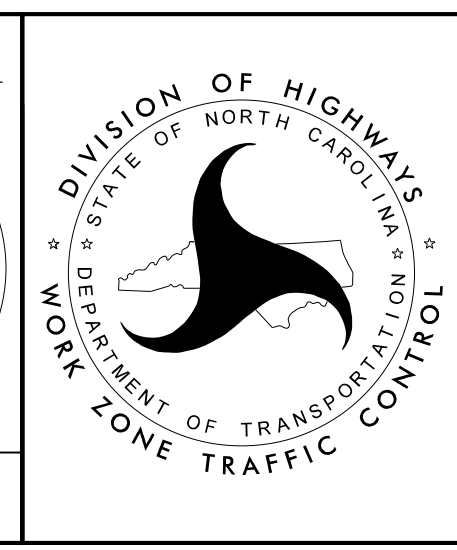

DETAIL FOR
US 29A (S. MAIN ST.)
AND
S. RIDGE AVE.
OVERNIGHT
ROAD CLOSURES