

REVISIONS

NOTES:

1. IF FURTHER INFORMATION REGARDING PROJECT CONTROL IS NEEDED, PLEASE CONTACT THE LOCATION AND SURVEYS UNIT.
2. PROJECT CONTROL WAS ESTABLISHED USING GNSS, THE GLOBAL NAVIGATION SATELLITE SYSTEM.
3. THESE RIGHT OF WAY MAPS MAY BE COMPILED OF WORK FROM SEVERAL DIFFERENT SOURCES AND/OR SURVEYORS.
4. NEW RIGHT OF WAY AND EASEMENTS SUBJECT TO CHANGE. PLEASE REFER TO DEED FOR FINAL DETERMINATION.
5. ALL MONUMENTS WERE SET ACCORDING TO NCDOT SPECIFICATIONS EXCEPT WHERE NOTED.

I, Timothy Rudolph, a Professional Land Surveyor in the state of North Carolina hereby certify to the best of my knowledge and belief that the following work item(s) (R/W Staking) performed under my responsible charge meet NCDOT Survey Standards as directed in the NCDOT Location & Surveys guidelines and procedures.

I further certify that the right of way and permanent easement points shown herein and outlined in the tables shown hereon (localized coordinates, station/offset) have been checked and are accurate representations of the right of way and permanent easement points depicted on the corresponding highway plans. I also certify that the right of way and permanent easement points shown herein have been field monumented under my supervision from existing survey control provided by others; that the depicted property data shown herein were surveyed by others; and these monuments denote the right of way and easement boundaries at the time of staking which may be subject to change due to right of way revisions (See deeds for final determination).

Witness my original signature, registration number and seal this 12th day of July, 2019.

TIMOTHY A. RUDOLPH
Professional Land Surveyor

PLS#
L-2666

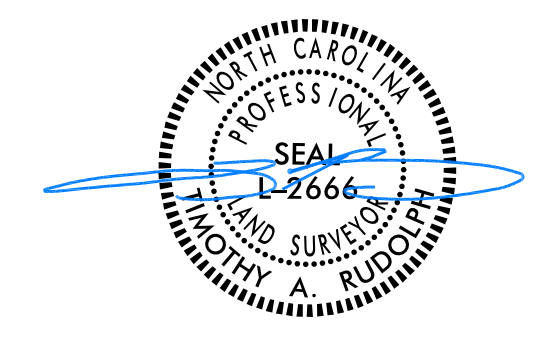

6/2/19
P:\11\2019\0744 Survey\RW Sheets\New Folder\Y4810K-1s-rw13.dgn