

09/05/19

TIP PROJECT: Y4810K

STATE OF NORTH CAROLINA
DIVISION OF HIGHWAYS

SURVEY CONTROL, EXISTING CENTERLINES,
RIGHT OF WAY, EASEMENTS AND PROPERTY TIES

CABARRUS COUNTY

STATE	STATE PROJECT REFERENCE NO.	SHEET NO.	TOTAL SHEETS
N.C.	Y4810K	RW01	27

----- CITY OF KANNAPOLIS CITY LIMITS

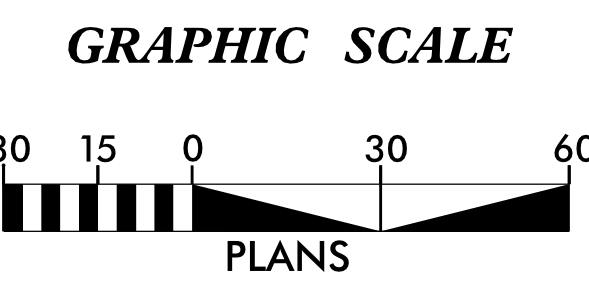
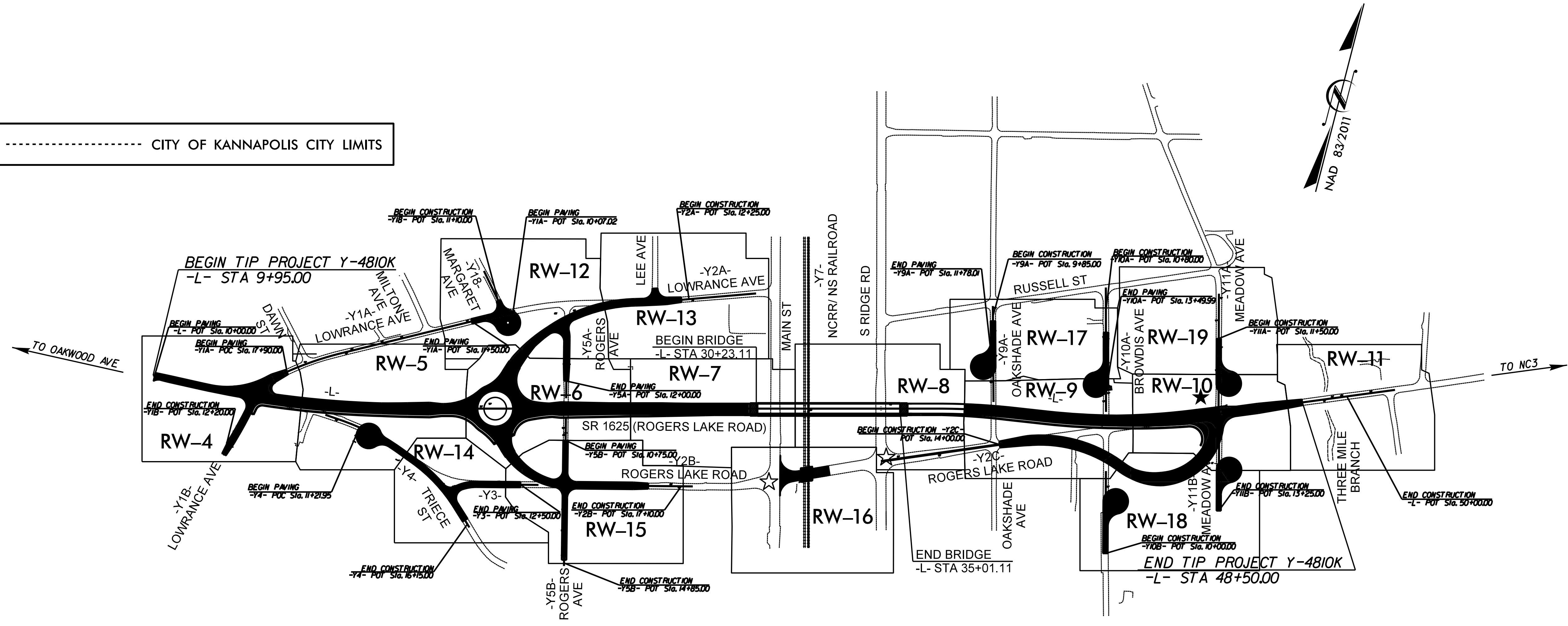

DATUM DESCRIPTION

THE LOCALIZED COORDINATE SYSTEM DEVELOPED FOR THIS PROJECT IS BASED ON THE STATE PLANE COORDINATES ESTABLISHED BY NCGS FOR MONUMENT "Y48105-2" WITH NAD 83/NA 2011 STATE PLANE GRID COORDINATES OF NORTHING: 632818.333(ft) EASTING: 1516238.160(ft) ELEVATION: 778.41(ft)

THE AVERAGE COMBINED GRID FACTOR USED ON THIS PROJECT (GROUND TO GRID) IS: 0.999849000004

THE N.C. LAMBERT GRID BEARING AND LOCALIZED HORIZONTAL GROUND DISTANCE FROM "Y4810K-2" TO -L- STATION 9+95.00 IS S 63°09'04.7" W 2150.589(ft)

ALL LINEAR DIMENSIONS ARE LOCALIZED HORIZONTAL DISTANCES VERTICAL DATUM USED IS NAVD 88

Prepared in the Office of:



Dewberry Engineers Inc.
8900 Harris Corners Pkwy - Suite 220
Charlotte, NC 28269
Phone: 704.509.9918
Fax: 704.509.9937
www.dewberry.com
NCBELS #F-0929

2018 STANDARD SPECIFICATIONS

RIGHT OF WAY DATE:
MAY 25, 2018

LETTING DATE:
JUNE 16, 2020

PROFESSIONAL LAND SURVEYOR



SIGNATURE: [Signature] 07-12-19 Date:

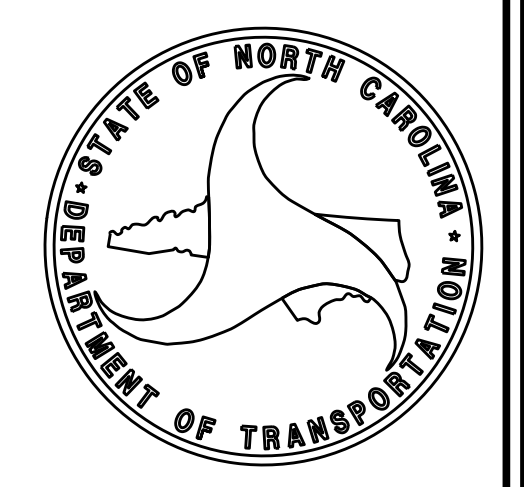

\$\$\$\$\$ SYSTEM \$\$\$\$\$\$
\$\$\$\$\$ DDN \$\$\$\$\$\$
\$\$\$\$\$ USERNAME \$\$\$\$\$\$