

5/14/99

PROJECT REFERENCE NO. <b>Y-4810K</b>	SHEET NO. <b>38</b>
ROADWAY DESIGN ENGINEER SEAL 27391 MOTT MACDONALD 1 & E, LLC LICENSE NO. F-0669	HYDRAULICS ENGINEER SEAL 26971 MOTT MACDONALD 1 & E, LLC LICENSE NO. C-890

**DOCUMENT NOT CONSIDERED FINAL  
UNLESS ALL SIGNATURES COMPLETED**

Prepared in the Office of: **M**  
MOTT MACDONALD 7621 Purfoy Road, Suite 115  
Fuquay-Varina, NC 27526  
www.mottmac.com/north-america

# -Y5A-

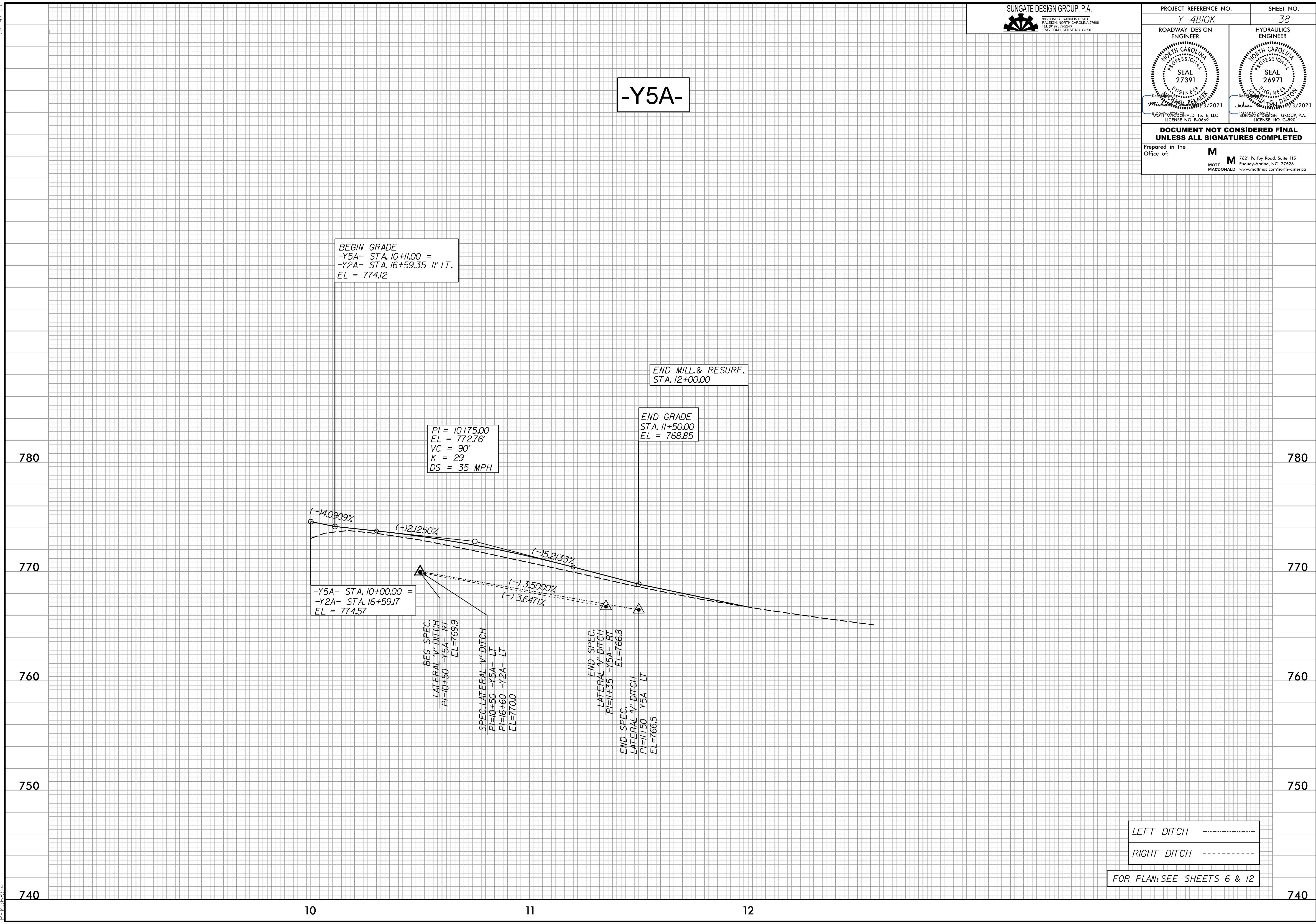

BEGIN GRADE  
-Y5A- STA. 10+11.00 =  
-Y2A- STA. 16+59.35 11' LT.  
EL = 774.12

PI = 10+75.00  
EL = 772.76'  
VC = 90'  
K = 29  
DS = 35 MPH

END MILL & RESURF.  
STA. 12+00.00

END GRADE  
STA. 11+50.00  
EL = 768.85

(-) 4.0909%

(-) 2.250%

(-) 5.233%

(-) 3.5000%

(-) 3.6471%

-Y5A- STA. 10+00.00 =  
-Y2A- STA. 16+59.17  
EL = 774.57

BEG. SPEC.  
LATERAL V' DITCH  
PI=10+50 -Y5A- RT  
EL=769.9

SPEC. LATERAL V' DITCH  
PI=10+50 -Y5A- LT  
PI=16+60 -Y2A- LT  
EL=770.0

END SPEC.  
LATERAL V' DITCH  
PI=11+55 -Y5A- RT  
EL=766.8

END SPEC.  
LATERAL V' DITCH  
PI=11+50 -Y5A- LT  
EL=766.5

LEFT DITCH -----  
RIGHT DITCH -----

FOR PLAN: SEE SHEETS 6 & 12

4:34:57 PM  
4:\Y5A\ad\p\Proj\Y4810K\_rdy.pfl.psh.dgn  
PK:568874