

5/14/99

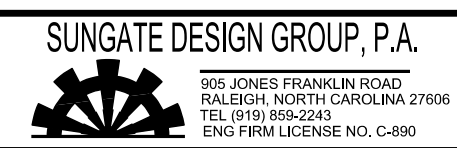

PROJECT REFERENCE NO. Y-4810K	SHEET NO. 24
ROADWAY DESIGN ENGINEER SEAL 27391	HYDRAULICS ENGINEER SEAL 26971
<i>MOTT MACDONALD</i> 3/2021	<i>Joselyn Dalton</i> 3/2021

DOCUMENT NOT CONSIDERED FINAL UNLESS ALL SIGNATURES COMPLETED

Prepared in the Office of: **M**
MOTT MACDONALD 7621 Purfoy Road, Suite 115
 Fuquay-Varina, NC 27526
 www.mottmac.com/north-america

-L-

PI = 34+15.00
 EL = 831.95'
 VC = 1,130'
 K = 84
 DS = 50 MPH

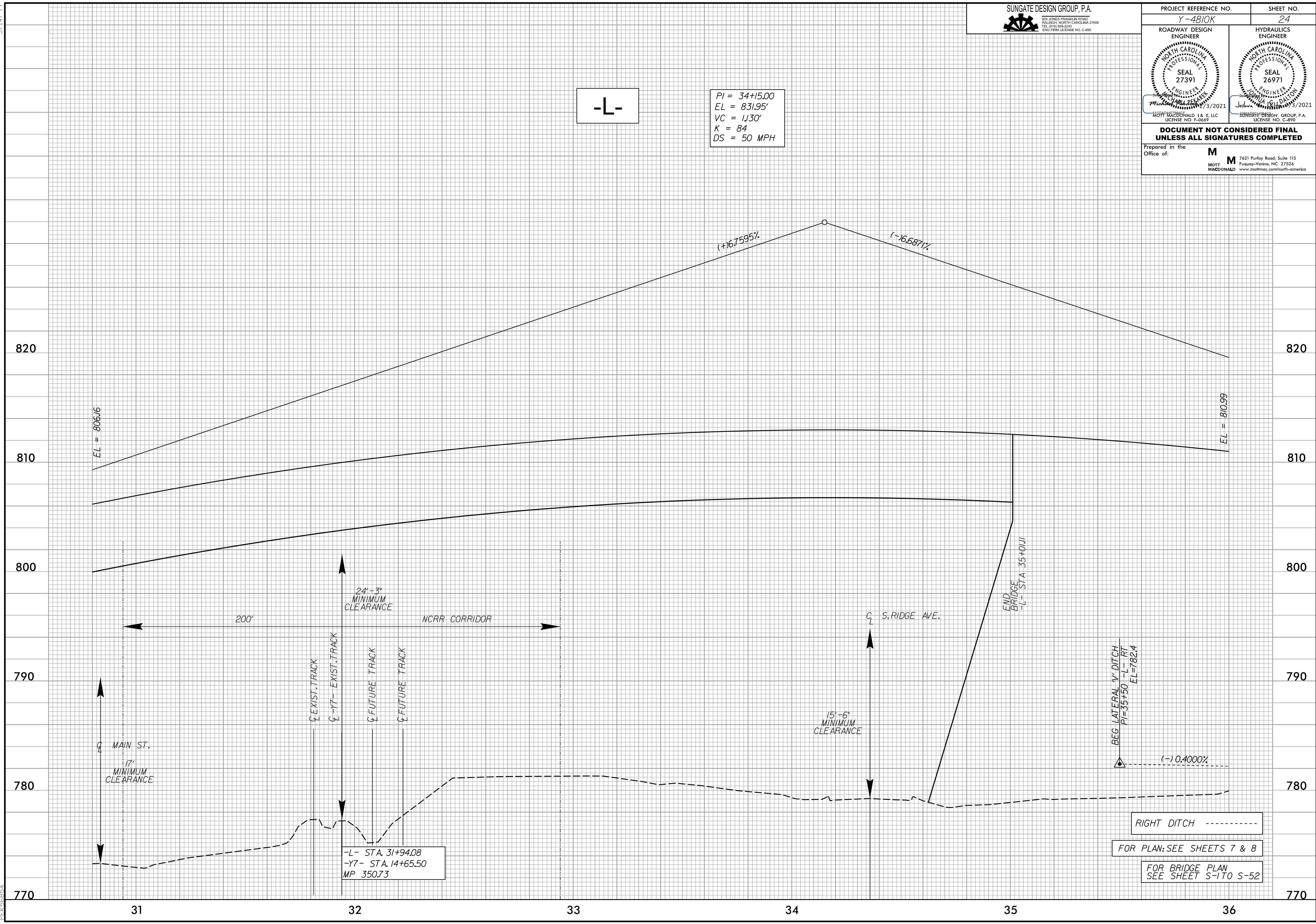

-L- STA. 31+94.08
 -Y7- STA. 14+65.50
 MP 350.73

RIGHT DITCH -----
 FOR PLAN: SEE SHEETS 7 & 8
 FOR BRIDGE PLAN SEE SHEET S-1 TO S-52

4:34:53 PM
 C:\Users\pml\OneDrive\Projects\Y4810K\rdj.pfl.psh.dgn
 PEK368874