

5/14/99

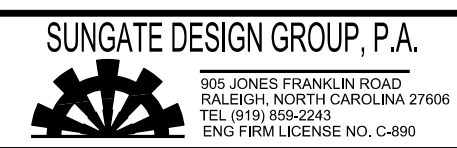

|  |   |
|--|---|
| PROJECT REFERENCE NO.<br><b>Y-4810K</b>                                  | SHEET NO.<br><b>21</b>  |
| ROADWAY DESIGN<br>ENGINEER<br><b>W. J. PEASE</b><br>SEAL 27391<br>3/2021 | HYDRAULICS<br>ENGINEER<br><b>J. S. DALTON</b><br>SEAL 26971<br>3/2021 |

BM2  
ELEV = 765.43  
N 63/15 E 15/52/5  
L STATION 18+40.00 240' RIGHT  
PUNCH HOLE IN CENTER OF  
PAINTED BOLT AND NUT

-L-

PI = 15+50.00  
EL = 767.87'  
VC = 270'  
K = 98  
DS = 50 MPH

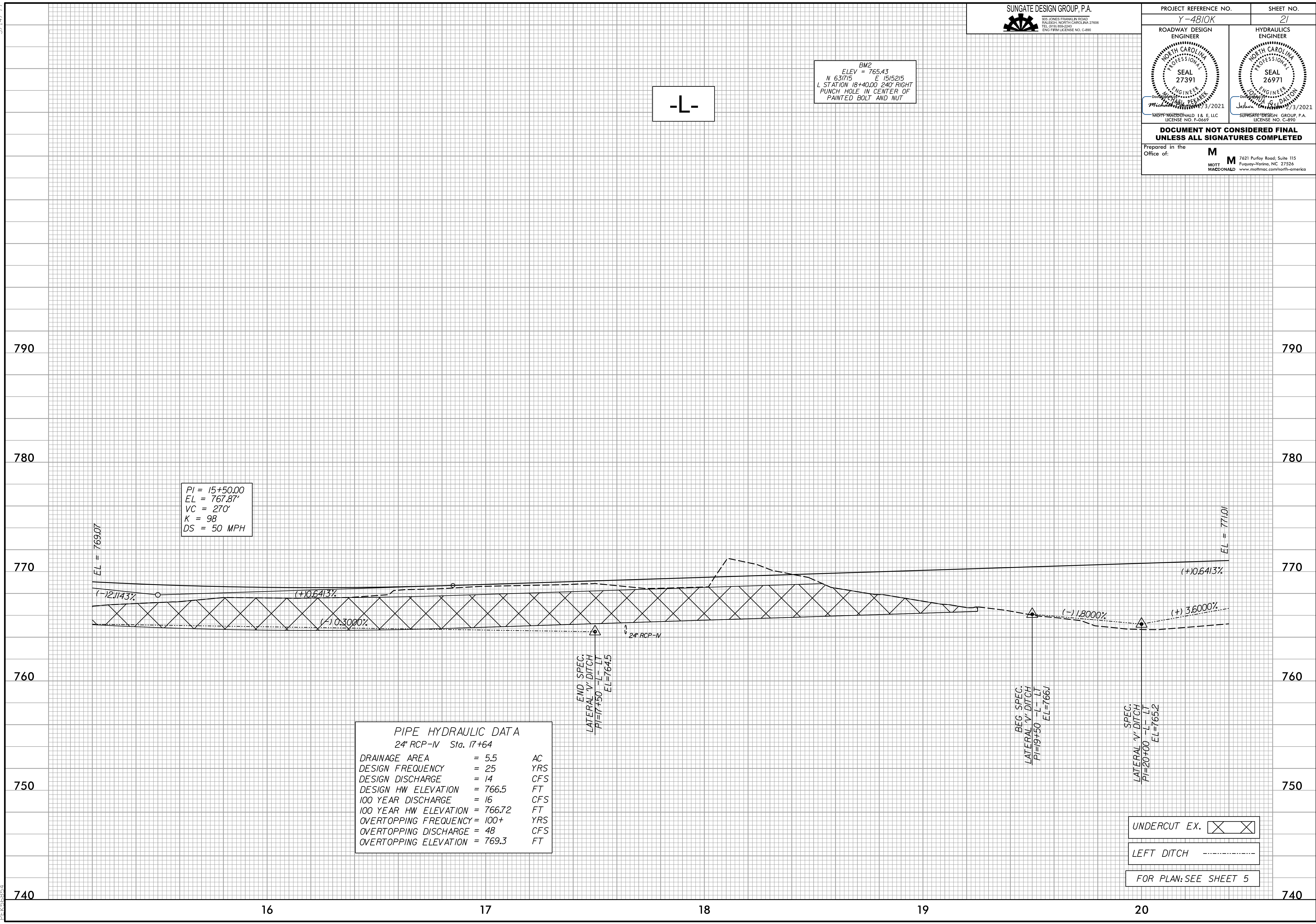

**PIPE HYDRAULIC DATA**  
24" RCP-N Sta. 17+64

|                       |          |     |
|-----------------------|----------|-----|
| DRAINAGE AREA         | = 5.5    | AC  |
| DESIGN FREQUENCY      | = 25     | YRS |
| DESIGN DISCHARGE      | = 14     | CFS |
| DESIGN HW ELEVATION   | = 766.5  | FT  |
| 100 YEAR DISCHARGE    | = 16     | CFS |
| 100 YEAR HW ELEVATION | = 766.72 | FT  |
| OVERTOPPING FREQUENCY | = 100+   | YRS |
| OVERTOPPING DISCHARGE | = 48     | CFS |
| OVERTOPPING ELEVATION | = 769.3  | FT  |

END. SPEC.  
LATERAL V. DITCH  
PI=17+50 -L- LT  
EL=764.5

BEG. SPEC.  
LATERAL V. DITCH  
PI=19+50 -L- LT  
EL=766.1

SPEC.  
LATERAL V. DITCH  
PI=20+00 -L- LT  
EL=765.2

UNDERCUT EX.

LEFT DITCH

FOR PLAN: SEE SHEET 5

4:34:51 PM  
4:\Projects\Y4810K\rdj.pfl.psh.dgn  
PEK 5/14/99