

5/14/2011

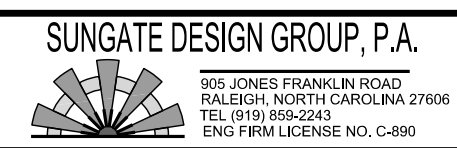

PROJECT REFERENCE NO. Y-4810K		SHEET NO. 18	
RW SHEET NO.			
ROADWAY DESIGN ENGINEER		HYDRAULICS ENGINEER	
<p>DOCUMENT NOT CONSIDERED FINAL UNLESS ALL SIGNATURES COMPLETED</p> <p>Prepared in the Office of: MOTT MACDONALD</p> <p>M 7621 Purfoy Road, Suite 115 Fuquay-Varina, NC 27526 www.mottmac.com/north-carolina</p>			

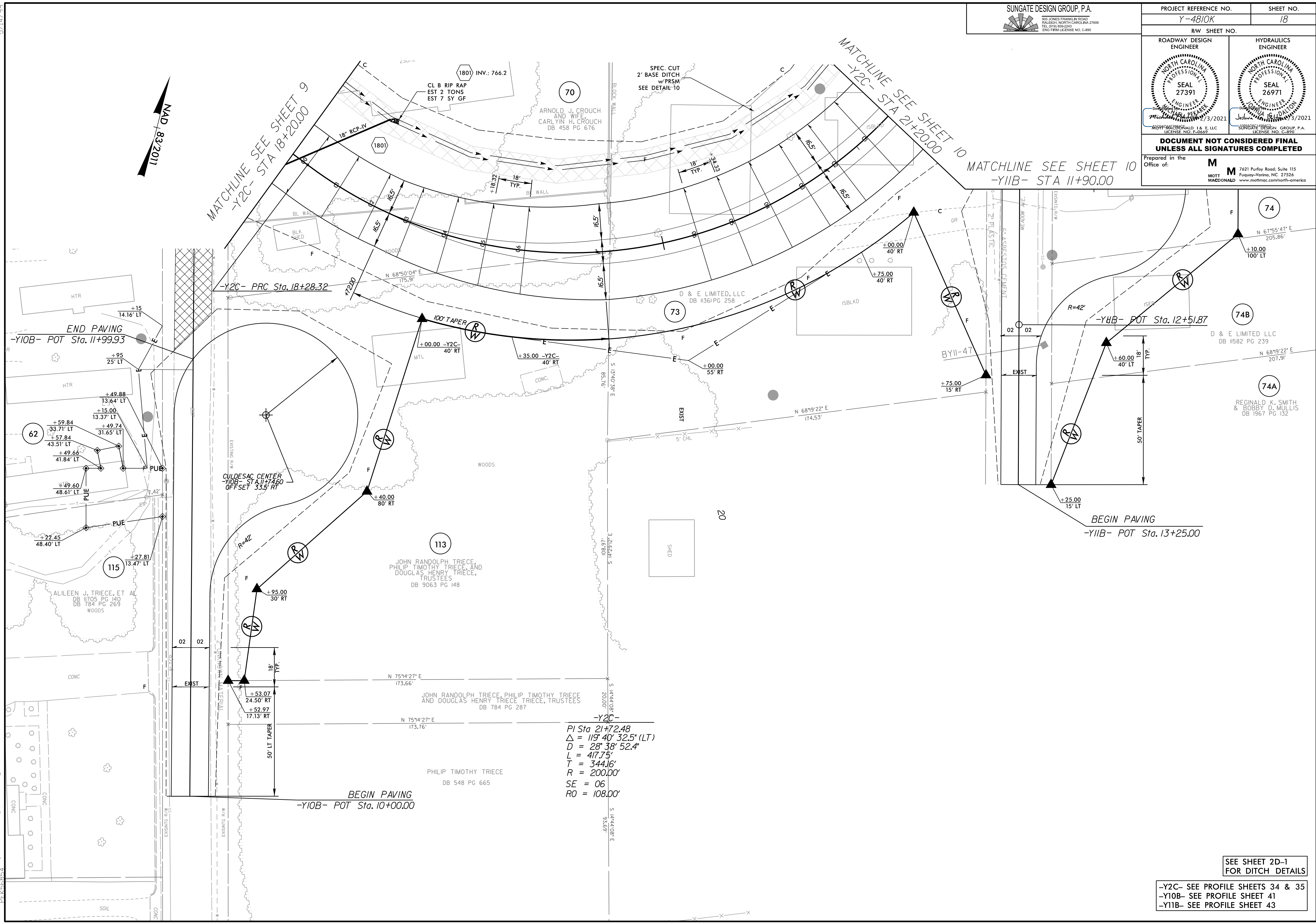

-Y2C-
 PI Sta 21+72.48
 $\Delta = 119' 40' 32.5''$ (LT)
 $D = 28' 38' 52.4''$
 $L = 417.75'$
 $T = 344.16'$
 $R = 200.00'$
 $SE = 06$
 $RO = 108.00'$

SEE SHEET 2D-1
FOR DITCH DETAILS

-Y2C- SEE PROFILE SHEETS 34 & 35
 -Y10B- SEE PROFILE SHEET 41
 -Y11B- SEE PROFILE SHEET 43

R:\P\433523_P\Proj\Y4810K_rdy_psh_18.dgn
 4/3/2011 10:54 AM
 5/14/2011