



STATE OF NORTH CAROLINA
DEPARTMENT OF TRANSPORTATION

ROY COOPER
GOVERNOR

J. ERIC BOYETTE
SECRETARY

November 09, 2022

Addendum No. 2

RE: Contract # C204554

WBS # 46032.3.2

FEDERAL-AID NO. BRZ-2044(4)

Wake County (B-5318)

BRIDGE #126 OVER SMITH'S CREEK ON SR-2044 (LIGON MILL RD) IN WAKE FOREST

November 15, 2022 Letting

To Whom It May Concern:

Reference is made to the plans and proposal form furnished to you on this project.

The following revisions have been made to the Structures plans.

Sheet No.	Revision
S-4	Revised TOTAL BILL OF MATERIAL to reflect addition of quantity shown below

Please void the above listed Sheet in your plans and staple the revised Sheet thereto.

The following revisions have been made to the proposal.

Page No.	Revision
Proposal Cover	Note added that reads "Includes Addendum No. 2 Dated 11-09-2022".
New Page UC-12	New Page UC-12 added to Unit Project Special Provision entitled "UTILITY CONSTRUCTION".

Staple New Page UC-12 after existing Page UC-11 in your proposal.

On the item sheets the following pay item revisions have been made:

<u>Item</u>	<u>Description</u>	<u>Old Quantity</u>	<u>New Quantity</u>
0129-6029000000-E-SP	SAFETY FENCE	1,120 LF	1,950 LF
0173-8391000000-N-450	STEEL PILE POINTS	NEW ITEM	20 EA

The Contractor's bid must include these pay item revisions.

The electronic bidding file has been updated to reflect these revisions. Please download the Addendum File and follow the instructions for applying the addendum. Bid Express will not accept your bid unless the addendum has been applied.

The contract will be prepared accordingly.

Sincerely,

DocuSigned by:

F81B6038A47A442...
 Ronald E. Davenport, Jr., PE
 State Contract Officer

RED/jjr
 Attachments

cc: Mr. Boyd Tharrington, PE
 Mr. Brandon H. Jones, PE
 Mr. Ken Kennedy, PE
 Mr. Jon Weathersbee, PE
 Mr. Mike Gwyn
 Project File (2)

Mr. Forrest Dungan, PE
 Ms. Jaci Kincaid
 Ms. Penny Higgins
 Ms. Lori Strickland

STATE OF NORTH CAROLINA
DEPARTMENT OF TRANSPORTATION
RALEIGH, N.C.

PROPOSAL

INCLUDES ADDENDUM No.2 DATED 11-09-2022

DATE AND TIME OF BID OPENING: **Nov 15, 2022 AT 02:00 PM**

CONTRACT ID C204554
WBS 46032.3.2

FEDERAL-AID NO. BRZ-2044(4)
COUNTY WAKE
T.I.P NO. B-5318
MILES 0.365
ROUTE NO. SR-2204
LOCATION BRIDGE #126 OVER SMITH'S CREEK ON SR-2044 (LIGON MILL RD) IN WAKE FOREST.

TYPE OF WORK GRADING, DRAINAGE, PAVING, AND STRUCTURE.

NOTICE:

ALL BIDDERS SHALL COMPLY WITH ALL APPLICABLE LAWS REGULATING THE PRACTICE OF GENERAL CONTRACTING AS CONTAINED IN CHAPTER 87 OF THE GENERAL STATUTES OF NORTH CAROLINA WHICH REQUIRES THE BIDDER TO BE LICENSED BY THE N.C. LICENSING BOARD FOR CONTRACTORS WHEN BIDDING ON ANY NON-FEDERAL AID PROJECT WHERE THE BID IS \$30,000 OR MORE, EXCEPT FOR CERTAIN SPECIALTY WORK AS DETERMINED BY THE LICENSING BOARD. BIDDERS SHALL ALSO COMPLY WITH ALL OTHER APPLICABLE LAWS REGULATING THE PRACTICES OF ELECTRICAL, PLUMBING, HEATING AND AIR CONDITIONING AND REFRIGERATION CONTRACTING AS CONTAINED IN CHAPTER 87 OF THE GENERAL STATUTES OF NORTH CAROLINA. NOTWITHSTANDING THESE LIMITATIONS ON BIDDING, THE BIDDER WHO IS AWARDED ANY FEDERAL - AID FUNDED PROJECT SHALL COMPLY WITH CHAPTER 87 OF THE GENERAL STATUTES OF NORTH CAROLINA FOR LICENSING REQUIREMENTS WITHIN 60 CALENDAR DAYS OF BID OPENING.

BIDS WILL BE RECEIVED AS SHOWN BELOW:

THIS IS A ROADWAY & STRUCTURE PROPOSAL

5% BID BOND OR BID DEPOSIT REQUIRED

Project: B-5318

UC-12

County: Wake

Page 10-63, Sub-article 1036-4 Steel Pipe

(B) Encasement Pipe

Add the following after 1036-4 (B)

Encasement pipe minimum wall thickness shall be as shown in Table 1036-1 below.

TABLE 1036-1 ENCASEMENT PIPE SIZE AND MINIMUM WALL THICKNESSES	
Encasement Pipe Size, Outside Diameter (inches)	Minimum Wall Thickness (inches)
4-12	0.188
12-24	0.250
30	0.312
36	0.375
48	0.500

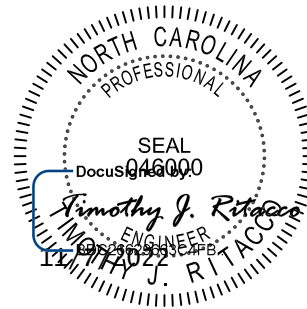

County: WAKE

Line #	Item Number	Sec #	Description	Quantity	Unit Cost	Amount
ROADWAY ITEMS						
0001	0000100000-N	800	MOBILIZATION	Lump Sum	L.S.	
0002	0000400000-N	801	CONSTRUCTION SURVEYING	Lump Sum	L.S.	
0003	0028000000-N	SP	TYPE I STANDARD APPROACH FILL STATION ***** (19+73.00 -L-)	Lump Sum	L.S.	
0004	0043000000-N	226	GRADING	Lump Sum	L.S.	
0005	0050000000-E	226	SUPPLEMENTARY CLEARING & GRUBBING	1 ACR		
0006	0057000000-E	226	UNDERCUT EXCAVATION	1,500 CY		
0007	0134000000-E	240	DRAINAGE DITCH EXCAVATION	250 CY		
0008	0195000000-E	265	SELECT GRANULAR MATERIAL	1,400 CY		
0009	0196000000-E	270	GEOTEXTILE FOR SOIL STABILIZATION	1,700 SY		
0010	0199000000-E	SP	TEMPORARY SHORING	4,930 SF		
0011	0318000000-E	300	FOUNDATION CONDITIONING MATERIAL, MINOR STRUCTURES	365 TON		
0012	0320000000-E	300	FOUNDATION CONDITIONING GEOTEXTILE	1,145 SY		
0013	0335300000-E	305	18" DRAINAGE PIPE	17 LF		
0014	0366000000-E	310	15" RC PIPE CULVERTS, CLASS III	564 LF		
0015	0372000000-E	310	18" RC PIPE CULVERTS, CLASS III	395 LF		
0016	0378000000-E	310	24" RC PIPE CULVERTS, CLASS III	288 LF		
0017	0448200000-E	310	15" RC PIPE CULVERTS, CLASS IV	80 LF		

County: WAKE

Line #	Item Number	Sec #	Description	Quantity	Unit Cost	Amount
0018	0448300000-E	310	18" RC PIPE CULVERTS, CLASS IV	40 LF		
0019	0582000000-E	310	15" CS PIPE CULVERTS, 0.064" THICK	76 LF		
0020	0588000000-E	310	18" CS PIPE CULVERTS, 0.064" THICK	56 LF		
0021	0594000000-E	310	24" CS PIPE CULVERTS, 0.064" THICK	48 LF		
0022	0636000000-E	310	*** CS PIPE ELBOWS, ***** THICK (15", 0.064")	2 EA		
0023	0636000000-E	310	*** CS PIPE ELBOWS, ***** THICK (18", 0.064")	4 EA		
0024	0636000000-E	310	*** CS PIPE ELBOWS, ***** THICK (24", 0.064")	2 EA		
0025	0995000000-E	340	PIPE REMOVAL	347 LF		
0026	1099500000-E	505	SHALLOW UNDERCUT	100 CY		
0027	1099700000-E	505	CLASS IV SUBGRADE STABILIZATION	200 TON		
0028	1121000000-E	520	AGGREGATE BASE COURSE	235 TON		
0029	1220000000-E	545	INCIDENTAL STONE BASE	50 TON		
0030	1330000000-E	607	INCIDENTAL MILLING	90 SY		
0031	1491000000-E	610	ASPHALT CONC BASE COURSE, TYPE B25.0C	2,000 TON		
0032	1503000000-E	610	ASPHALT CONC INTERMEDIATE COURSE, TYPE I19.0C	1,600 TON		
0033	1523000000-E	610	ASPHALT CONC SURFACE COURSE, TYPE S9.5C	1,320 TON		
0034	1575000000-E	620	ASPHALT BINDER FOR PLANT MIX	245 TON		

County: WAKE

Line #	Item Number	Sec #	Description	Quantity	Unit Cost	Amount
0035	2000000000-N	806	RIGHT-OF-WAY MARKERS	20 EA		
0036	2022000000-E	815	SUBDRAIN EXCAVATION	112 CY		
0037	2026000000-E	815	GEOTEXTILE FOR SUBSURFACE DRAINS	500 SY		
0038	2036000000-E	815	SUBDRAIN COARSE AGGREGATE	84 CY		
0039	2044000000-E	815	6" PERFORATED SUBDRAIN PIPE	500 LF		
0040	2070000000-N	815	SUBDRAIN PIPE OUTLET	1 EA		
0041	2077000000-E	815	6" OUTLET PIPE	6 LF		
0042	2286000000-N	840	MASONRY DRAINAGE STRUCTURES	15 EA		
0043	2308000000-E	840	MASONRY DRAINAGE STRUCTURES	3.6 LF		
0044	2374000000-N	840	FRAME WITH GRATE & HOOD, STD 840.03, TYPE ** (E)	1 EA		
0045	2374000000-N	840	FRAME WITH GRATE & HOOD, STD 840.03, TYPE ** (F)	5 EA		
0046	2374000000-N	840	FRAME WITH GRATE & HOOD, STD 840.03, TYPE ** (G)	9 EA		
0047	2549000000-E	846	2'-6" CONCRETE CURB & GUTTER	3,140 LF		
0048	2591000000-E	848	4" CONCRETE SIDEWALK	1,770 SY		
0049	2605000000-N	848	CONCRETE CURB RAMPS	1 EA		
0050	2612000000-E	848	6" CONCRETE DRIVEWAY	30 SY		

County: WAKE

Line #	Item Number	Sec #	Description	Quantity	Unit Cost	Amount
0051	2738000000-E	SP	GENERIC PAVING ITEM 4" JOINTED CONCRETE WITH WIRE MESH (4 X 4, W3 X W3)	240 SY		
0052	2738000000-E	SP	GENERIC PAVING ITEM 6" JOINTED CONCRETE WITH WIRE MESH (4 X 4, W3 X W3)	130 SY		
0053	3030000000-E	862	STEEL BEAM GUARDRAIL	1,000 LF		
0054	3150000000-N	862	ADDITIONAL GUARDRAIL POSTS	5 EA		
0055	3180000000-N	SP	GUARDRAIL ANCHOR UNITS, TYPE ***** (III)	4 EA		
0056	3210000000-N	862	GUARDRAIL END UNITS, TYPE CAT-1	4 EA		
0057	3287000000-N	SP	GUARDRAIL END UNITS, TYPE TL-3	4 EA		
0058	3420000000-E	SP	GENERIC GUARDRAIL ITEM WOOD RUB RAIL	1,020 LF		
0059	3575000000-E	SP	GENERIC FENCING ITEM BIKE AND PEDESTRIAN SAFETY RAIL	1,260 LF		
0060	3578000000-N	SP	GENERIC FENCING ITEM 16' STEEL PIPE GATE	1 EA		
0061	3578000000-N	SP	GENERIC FENCING ITEM 24' STEEL PIPE GATE	1 EA		
0062	3628000000-E	876	RIP RAP, CLASS I	330 TON		
0063	3635000000-E	876	RIP RAP, CLASS II	510 TON		
0064	3649000000-E	876	RIP RAP, CLASS B	270 TON		
0065	3656000000-E	876	GEOTEXTILE FOR DRAINAGE	1,890 SY		
0066	4072000000-E	903	SUPPORTS, 3-LB STEEL U-CHANNEL	86 LF		
0067	4102000000-N	904	SIGN ERECTION, TYPE E	6 EA		

County: WAKE

Line #	Item Number	Sec #	Description	Quantity	Unit Cost	Amount
0068	4155000000-N	907	DISPOSAL OF SIGN SYSTEM, U-CHANNEL	9 EA		
0069	4400000000-E	1110	WORK ZONE SIGNS (STATIONARY)	912 SF		
0070	4405000000-E	1110	WORK ZONE SIGNS (PORTABLE)	96 SF		
0071	4410000000-E	1110	WORK ZONE SIGNS (BARRICADE MOUNTED)	143 SF		
0072	4422000000-N	1120	PORTABLE CHANGEABLE MESSAGE SIGN (SHORT TERM)	56 DAY		
0073	4430000000-N	1130	DRUMS	131 EA		
0074	4435000000-N	1135	CONES	50 EA		
0075	4445000000-E	1145	BARRICADES (TYPE III)	160 LF		
0076	4447000000-E	SP	PEDESTRIAN CHANNELIZING DEVICES	4 LF		
0077	4455000000-N	1150	FLAGGER	48 DAY		
0078	4465000000-N	1160	TEMPORARY CRASH CUSHIONS	4 EA		
0079	4470000000-N	1160	REMOVE & RESET TEMPORARY CRASH CUSHION	5 EA		
0080	4485000000-E	1170	PORTABLE CONCRETE BARRIER	1,339 LF		
0081	4490000000-E	1170	PORTABLE CONCRETE BARRIER (ANCHORED)	680 LF		
0082	4500000000-E	1170	REMOVE AND RESET PORTABLE CONCRETE BARRIER	1,177 LF		
0083	4507000000-E	1170	WATER FILLED BARRIER	130 LF		
0084	4650000000-N	1251	TEMPORARY RAISED PAVEMENT MARKERS	157 EA		

County: WAKE

Line #	Item Number	Sec #	Description	Quantity	Unit Cost	Amount
0085	4685000000-E	1205	THERMOPLASTIC PAVEMENT MARKING LINES (4", 90 MILS)	5,747 LF		
0086	4695000000-E	1205	THERMOPLASTIC PAVEMENT MARKING LINES (8", 90 MILS)	380 LF		
0087	4709000000-E	1205	THERMOPLASTIC PAVEMENT MARKING LINES (24", 90 MILS)	17 LF		
0088	4725000000-E	1205	THERMOPLASTIC PAVEMENT MARKING SYMBOL (90 MILS)	8 EA		
0089	4770000000-E	1205	COLD APPLIED PLASTIC PAVEMENT MARKING LINES, TYPE ** (4") (II)	626 LF		
0090	4770000000-E	1205	COLD APPLIED PLASTIC PAVEMENT MARKING LINES, TYPE ** (4") (IV)	500 LF		
0091	4805000000-N	1205	COLD APPLIED PLASTIC PAVEMENT MARKING SYMBOL, TYPE ** (I)	2 EA		
0092	4810000000-E	1205	PAINT PAVEMENT MARKING LINES (4")	11,678 LF		
0093	4845000000-N	1205	PAINT PAVEMENT MARKING SYMBOL	2 EA		
0094	4900000000-N	1251	PERMANENT RAISED PAVEMENT MARKERS	66 EA		
0095	5326200000-E	1510	12" WATER LINE	1,140 LF		
0096	5329000000-E	1510	DUCTILE IRON WATER PIPE FITTINGS	2,800 LB		
0097	5540000000-E	1515	6" VALVE	1 EA		
0098	5558000000-E	1515	12" VALVE	3 EA		
0099	5600000000-E	1515	*** BLOW OFF (12")	1 EA		
0100	5666000000-N	1515	FIRE HYDRANT	1 EA		
0101	5673000000-E	1515	FIRE HYDRANT LEG	30 LF		

County: WAKE

Line #	Item Number	Sec #	Description	Quantity	Unit Cost	Amount
0102	5691700000-E	1520	18" SANITARY GRAVITY SEWER	525 LF		
0103	5692000000-E	1520	30" SANITARY GRAVITY SEWER	220 LF		
0104	5776000000-E	1525	5' DIA UTILITY MANHOLE	2 EA		
0105	5777000000-E	1525	6' DIA UTILITY MANHOLE	2 EA		
0106	5782000000-E	1525	UTILITY MANHOLE WALL 5' DIA	6 LF		
0107	5783000000-E	1525	UTILITY MANHOLE WALL 6' DIA	10 LF		
0108	5804000000-E	1530	ABANDON 12" UTILITY PIPE	650 LF		
0109	5811000000-E	1530	ABANDON 18" UTILITY PIPE	230 LF		
0110	5814000000-E	1530	ABANDON 30" UTILITY PIPE	235 LF		
0111	5815500000-N	1530	REMOVE FIRE HYDRANT	1 EA		
0112	5816000000-N	1530	ABANDON UTILITY MANHOLE	2 EA		
0113	5828000000-N	1530	REMOVE UTILITY MANHOLE	2 EA		
0114	5835000000-E	1540	*** ENCASEMENT PIPE (48")	175 LF		
0115	5836000000-E	1540	24" ENCASEMENT PIPE	170 LF		
0116	5836400000-E	1540	36" ENCASEMENT PIPE	178 LF		
0117	5872500000-E	1550	BORE AND JACK OF *** (24")	170 LF		
0118	5872500000-E	1550	BORE AND JACK OF *** (36")	63 LF		

County: WAKE

Line #	Item Number	Sec #	Description	Quantity	Unit Cost	Amount
0119	5872500000-E	1550	BORE AND JACK OF *** (48")	65 LF		
0120	5912000000-N	SP	GENERIC UTILITY ITEM TEMPORARY BYPASS PUMPING	Lump Sum	L.S.	
0121	6000000000-E	1605	TEMPORARY SILT FENCE	8,145 LF		
0122	6006000000-E	1610	STONE FOR EROSION CONTROL, CLASS A	105 TON		
0123	6009000000-E	1610	STONE FOR EROSION CONTROL, CLASS B	420 TON		
0124	6012000000-E	1610	SEDIMENT CONTROL STONE	395 TON		
0125	6015000000-E	1615	TEMPORARY MULCHING	1.5 ACR		
0126	6018000000-E	1620	SEED FOR TEMPORARY SEEDING	100 LB		
0127	6021000000-E	1620	FERTILIZER FOR TEMPORARY SEEDING	0.5 TON		
0128	6024000000-E	1622	TEMPORARY SLOPE DRAINS	330 LF		
0129	6029000000-E	SP	SAFETY FENCE	1,950 LF		
0130	6030000000-E	1630	SILT EXCAVATION	550 CY		
0131	6036000000-E	1631	MATTING FOR EROSION CONTROL	11,200 SY		
0132	6037000000-E	SP	COIR FIBER MAT	100 SY		
0133	6042000000-E	1632	1/4" HARDWARE CLOTH	1,210 LF		
0134	6048000000-E	SP	FLOATING TURBIDITY CURTAIN	175 SY		
0135	6070000000-N	1639	SPECIAL STILLING BASINS	1 EA		

County: WAKE

Line #	Item Number	Sec #	Description	Quantity	Unit Cost	Amount
0136	6071030000-E	1640	COIR FIBER BAFFLE	110 LF		
0137	6084000000-E	1660	SEEDING & MULCHING	3 ACR		
0138	6087000000-E	1660	MOWING	3 ACR		
0139	6090000000-E	1661	SEED FOR REPAIR SEEDING	50 LB		
0140	6093000000-E	1661	FERTILIZER FOR REPAIR SEEDING	0.25 TON		
0141	6096000000-E	1662	SEED FOR SUPPLEMENTAL SEEDING	75 LB		
0142	6108000000-E	1665	FERTILIZER TOPDRESSING	2.3 TON		
0143	6111000000-E	SP	IMPERVIOUS DIKE	375 LF		
0144	6114500000-N	1667	SPECIALIZED HAND MOWING	10 MHR		
0145	6117000000-N	SP	RESPONSE FOR EROSION CONTROL	25 EA		
0146	6117500000-N	SP	CONCRETE WASHOUT STRUCTURE	2 EA		
0147	6123000000-E	1670	REFORESTATION	0.1 ACR		
STRUCTURE ITEMS						
0148	8017000000-N	SP	CONSTRUCTION, MAINTENANCE, & REMOVAL OF TEMP ACCESS AT STA ***** (19+73.00 -L-)	Lump Sum	L.S.	
0149	8035000000-N	402	REMOVAL OF EXISTING STRUCTURE AT STATION ***** (19+73.00 -L-)	Lump Sum	L.S.	
0150	8065000000-N	SP	ASBESTOS ASSESSMENT	Lump Sum	L.S.	
0151	8105560000-E	411	4'-0" DIA DRILLED PIERS IN SOIL	243 LF		

County: WAKE

Line #	Item Number	Sec #	Description	Quantity	Unit Cost	Amount
0152	8105660000-E	411	4'-0" DIA DRILLED PIERS NOT IN SOIL	54 LF		
0153	8112730000-N	450	PDA TESTING	1 EA		
0154	8113000000-N	411	SID INSPECTIONS	1 EA		
0155	8114000000-N	411	SPT TESTING	1 EA		
0156	8115000000-N	411	CSL TESTING	1 EA		
0157	8121000000-N	412	UNCLASSIFIED STRUCTURE EXCAVATION AT STATION ***** (19+73.00 -L-)	Lump Sum	L.S.	
0158	8147000000-E	420	REINFORCED CONCRETE DECK SLAB	12,016 SF		
0159	8161000000-E	420	GROOVING BRIDGE FLOORS	9,116 SF		
0160	8182000000-E	420	CLASS A CONCRETE (BRIDGE)	188 CY		
0161	8210000000-N	422	BRIDGE APPROACH SLABS, STATION ***** (19+73.00 -L-)	Lump Sum	L.S.	
0162	8217000000-E	425	REINFORCING STEEL (BRIDGE)	54,536 LB		
0163	8238000000-E	425	SPIRAL COLUMN REINFORCING STEEL (BRIDGE)	6,820 LB		
0164	8265000000-E	430	54" PRESTRESSED CONCRETE GIRDERS	1,185 LF		
0165	8328200000-E	450	PILE DRIVING EQUIPMENT SETUP FOR *** STEEL PILES (HP 12 X 53)	20 EA		
0166	8364000000-E	450	HP 12 X 53 STEEL PILES	700 LF		
0167	8475000000-E	460	TWO BAR METAL RAIL	381.67 LF		
0168	8505000000-E	460	VERTICAL CONCRETE BARRIER RAIL	496.67 LF		

County: WAKE

Line #	Item Number	Sec #	Description	Quantity	Unit Cost	Amount
0169	8517000000-E	460	1'-** X ***** CONCRETE PARAPET (1'-0" X 2'-6")	396.67 LF		
0170	8608000000-E	876	RIP RAP CLASS II (2'-0" THICK)	864 TON		
0171	8622000000-E	876	GEOTEXTILE FOR DRAINAGE	960 SY		
0172	8657000000-N	430	ELASTOMERIC BEARINGS	Lump Sum	L.S.	
0173	8391000000-N	450	STEEL PILE POINTS	20 EA		

1010/Nov09/Q176168.26/D765895980000/E173

Total Amount Of Bid For Entire Project :

BENCH MARK: BM*2 - R/R SPIKE SET IN 11" GUM TREE, STATION 14+65.00, 76' LEFT
 N 793495 E 2139827, ELEV. = 201.04', NAVD 1988

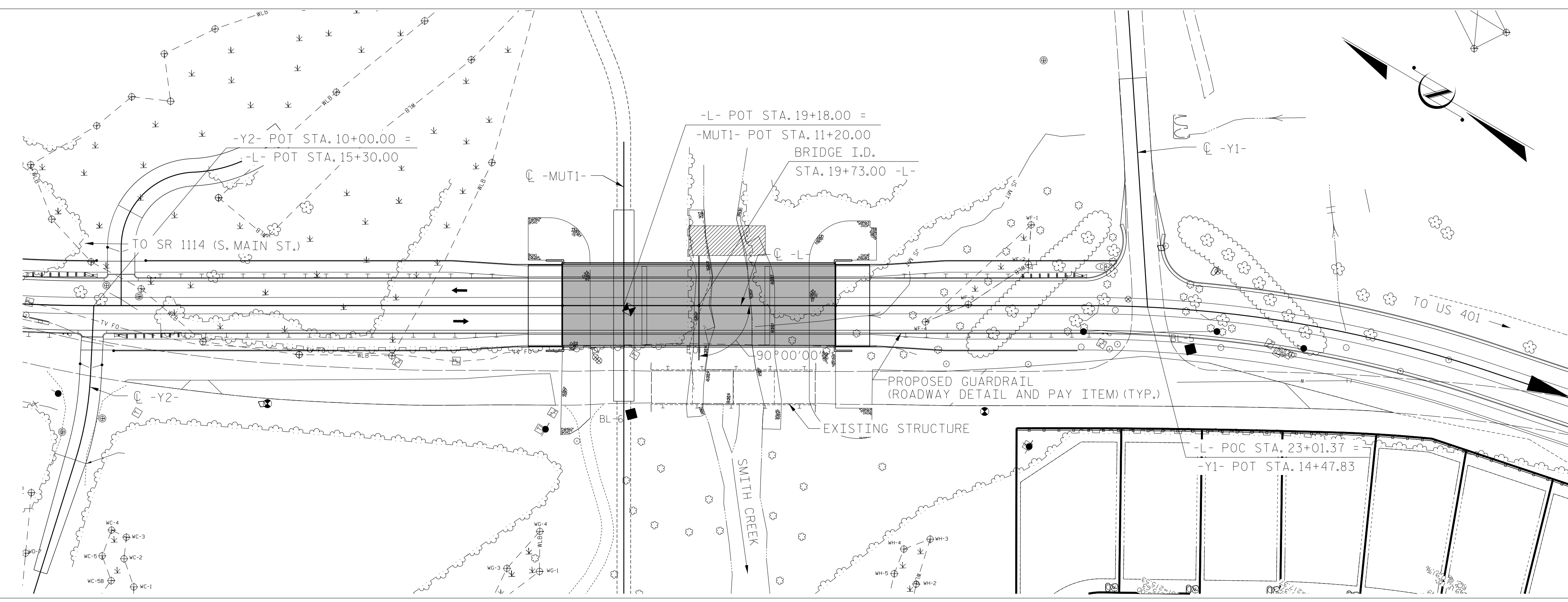

LOCATION SKETCH

FOR UTILITY INFORMATION, SEE UTILITY PLANS AND SPECIAL PROVISIONS

GENERAL NOTES:

ASSUMED LIVE LOAD = HL-93 OR ALTERNATE LOADING.
 THIS BRIDGE HAS BEEN DESIGNED IN ACCORDANCE WITH THE REQUIREMENTS OF THE AASHTO LRFD BRIDGE DESIGN SPECIFICATIONS.
 THIS BRIDGE IS LOCATED IN SEISMIC ZONE 1.
 FOR OTHER DESIGN DATA AND GENERAL NOTES, SEE SHEET SN.
 FOR SUBMITTAL OF WORKING DRAWINGS, SEE SPECIAL PROVISIONS.
 FOR FALSEWORK AND FORMWORK, SEE SPECIAL PROVISIONS.
 FOR CRANE SAFETY, SEE SPECIAL PROVISIONS.
 FOR GROUT FOR STRUCTURES, SEE SPECIAL PROVISIONS.
 THE CONTRACTOR SHALL PROVIDE INDEPENDANT ASSURANCE SAMPLES OF REINFORCING STEEL AS FOLLOWS: FOR PROJECTS REQUIRING UP TO 400 TONS OF REINFORCING STEEL, ONE 30 INCH SAMPLE OF EACH SIZE BAR USED, AND FOR PROJECTS REQUIRING OVER 400 TONS OF REINFORCING STEEL, TWO 30 INCH SAMPLES OF EACH SIZE BAR USED. THE SAMPLE BARS SHOULD COME FROM STEEL ACTUALLY USED IN THE PROJECT AND THE SAMPLE BARS SHOULD BE REPLACED BY SPLICED BARS AS SPECIFIED IN THE SAMPLE BAR REPLACEMENT CHART. PAYMENT FOR THE SAMPLE BARS AND REPLACEMENT REINFORCING STEEL SHALL BE CONSIDERED INCIDENTAL TO VARIOUS PAY ITEMS.
 REMOVABLE FORMS MAY BE USED IN LIEU OF METAL STAY-IN-PLACE FORMS IN ACCORDANCE WITH ARTICLE 420-3 OF THE STANDARD SPECIFICATIONS.
 AT THE CONTRACTOR'S OPTION, AND UPON REMOVAL OF THE CAUSEWAY, THE CLASS II RIP RAP USED IN THE CAUSEWAY MAY BE PLACED AS RIP RAP SLOPE PROTECTION. SEE SPECIAL PROVISIONS FOR CONSTRUCTION, MAINTENANCE AND REMOVAL OF TEMPORARY ACCESS AT STATION 19+73.00 -L-.
 NEEDLE BEAMS WILL NOT BE ALLOWED UNLESS OTHERWISE CALLED FOR ON THE PLANS OR APPROVED BY THE ENGINEER.
 THE CLASS AA CONCRETE IN THE BRIDGE DECK SHALL CONTAIN FLY ASH OR GROUND GRANULATED BLAST FURNACE SLAG AT THE SUBSTITUTION RATE SPECIFIED IN ARTICLE 1024-1 AND IN ACCORDANCE WITH ARTICLES 1024-5 AND 1024-6 OF THE STANDARD SPECIFICATIONS. NO PAYMENT WILL BE MADE FOR THIS SUBSTITUTION AS IT IS CONSIDERED INCIDENTAL TO THE COST OF THE REINFORCED CONCRETE DECK SLAB.

THE MATERIAL SHOWN IN THE CROSS-HATCHED AREA SHALL BE EXCAVATED FOR A DISTANCE OF 94 FT RIGHT OF CENTERLINE ROADWAY AS DIRECTED BY THE ENGINEER. THIS WORK WILL BE PAID FOR AT THE CONTRACT LUMP SUM PRICE FOR UNCLASSIFIED STRUCTURE EXCAVATION. SEE SECTION 412 OF THE STANDARD SPECIFICATIONS.

THE EXISTING STRUCTURE CONSISTING OF STEEL GIRDERS, 4 SPANS, 121 FT LONG; 24 FT WIDE REINFORCED CONCRETE DECK; ON CAST-IN-PLACE CONCRETE END BENTS AND INTERIOR BENTS SHALL BE COMPLETELY REMOVED. ALL ABANDONED REMNANT TIMBER PILES IN THE STREAM NEAR THE SOUTH BANK SHALL BE REMOVED OR CUT OFF 1 FT BELOW THE MUDLINE. THE EXISTING BRIDGE IS PRESENTLY NOT POSTED FOR LOAD LIMIT. SHOULD THE STRUCTURAL INTEGRITY OF THE BRIDGE DETERIORATE DURING CONSTRUCTION OF THE PROPOSED BRIDGE, A LOAD LIMIT MAY BE POSTED AND MAY BE REDUCED AS FOUND NECESSARY DURING THE LIFE OF THE PROJECT.

INASMUCH AS THE PAINT SYSTEM ON THE EXISTING STRUCTURAL STEEL CONTAINS LEAD, THE CONTRACTOR'S ATTENTION IS DIRECTED TO ARTICLE 107-1 OF THE STANDARD SPECIFICATIONS. ANY COSTS RESULTING FROM COMPLIANCE WITH APPLICABLE STATE OR FEDERAL REGULATIONS PERTAINING TO HANDLING OF MATERIALS CONTAINING LEAD BASED PAINT SHALL BE INCLUDED IN THE BID PRICE FOR REMOVAL OF EXISTING STRUCTURE AT STATION 19+73.00 -L-.

FOR EROSION CONTROL MEASURES, SEE EROSION CONTROL PLANS.

FOR ASBESTOS ASSESSMENT FOR BRIDGE DEMOLITION AND RENOVATION ACTIVITIES, SEE SPECIAL PROVISIONS.

TOTAL BILL OF MATERIAL

	CONSTRUCTION, MAINTENANCE, & REMOVAL OF TEMP ACCESS AT STA 19+73.00 -L-	REMOVAL OF EXISTING STRUCTURE	ASBESTOS ASSESSMENT	4'-0" DIA. DRILLED PIERS IN SOIL	4'-0" DIA. DRILLED PIERS NOT IN SOIL	PDA TESTING	SID INSPECTIONS	SPT TESTING	CSL TESTING	UNCLASSIFIED STRUCTURE EXCAVATION	REINFORCED CONCRETE DECK SLAB	GROOVING BRIDGE FLOORS	CLASS A CONCRETE	BRIDGE APPROACH SLABS
	LUMP SUM	LUMP SUM	LUMP SUM	CY	CY	EA	EA	EA	EA	LUMP SUM	SF	SF	CY	LUMP SUM
SUPERSTRUCTURE											12,016	9,116		LUMP SUM
END BENT 1													45.9	
BENT 1				144.0	21.0								47.9	
BENT 2				99.0	33.0								48.3	
END BENT 2													45.9	
TOTAL	LUMP SUM	LUMP SUM	LUMP SUM	243.0	54.0	1	1	1	1	LUMP SUM	12,016	9,116	188.0	LUMP SUM

	REINFORCING STEEL	SPIRAL COLUMN REINFORCING STEEL	54" PRESTRESSED CONCRETE GIRDERS	PILE DRIVING EQUIPMENT SETUP FOR HP 12X53	HP 12X53 STEEL PILES	STEEL PILE POINTS	TWO BAR METAL RAIL	VERTICAL CONCRETE BARRIER RAIL	1'-0" X 2'-6" CONCRETE PARAPET	RIP RAP CLASS II (2'-0" THICK)	GEOTEXTILE FOR DRAINAGE	ELASTOMERIC BEARINGS
	LBS	LBS	NO. LIN FT	EA	NO. LIN FT	EA	LIN FT	LIN FT	LIN FT	TON	SY	LUMP SUM
SUPERSTRUCTURE			18 1,185				381.67	496.67	396.67			LUMP SUM
END BENT 1	7,273			10	10	400				418	465	
BENT 1	21,390	3,722										
BENT 2	18,600	3,098										
END BENT 2	7,273			10	10	300				446	495	
TOTAL	54,536	6,820	18 1,185	20	20	700	381.67	496.67	396.67	864	960	LUMP SUM

SAMPLE BAR REPLACEMENT

SIZE	LENGTH
#3	6'-2"
#4	7'-4"
#5	8'-6"
#6	9'-8"
#7	10'-10"
#8	12'-0"
#9	13'-2"
#10	14'-6"
#11	15'-10"

PROJECT NO. B-5318
WAKE COUNTY
 STATION: 19+73.00 -L-
 SHEET 3 OF 3

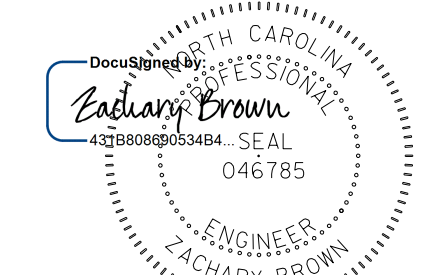
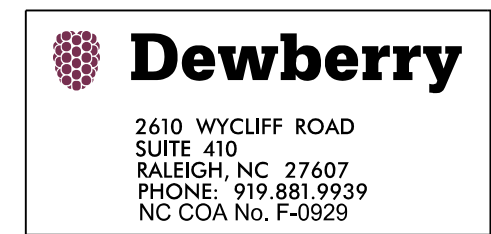

STATE OF NORTH CAROLINA
 DEPARTMENT OF TRANSPORTATION
 RALEIGH
GENERAL DRAWING
 FOR BRIDGE ON SR 2044
 OVER SMITH CREEK
 BETWEEN SR 1114 AND US 401

DRAWN BY: E. JONES DATE: JUNE 21
 CHECKED BY: P. O'NEILL DATE: JUNE 21
 DESIGN ENGINEER OF RECORD: Z. BROWN DATE: JUNE 21

NO.	REVISIONS			SHEET NO.
	BY:	DATE:	NO.	
1			3	5-4
2			4	TOTAL SHEETS 41