

Rutherford County Resurfacing
 WBS 2023CPT.13.06.10811
 Sheet 1

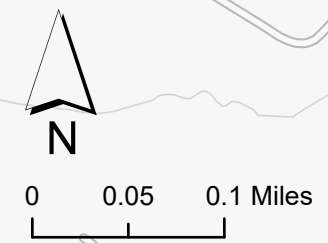

Map	Route	From MP	To MP	Description
1	US 74 EB	5.46	10.99	From US221 to Cleveland County
2	Ramp 3015 (Exit 178 - On Ramp)	0.05	0.29	From US 221 to US 74
3	US 74 ALT - On Ramp	30.16	30.97	From US 74 ALT Pvmt Joint To US 74 East Bound
4	Ramp 3018 (Exit 181 US 74 ALT - Off Ramp)	0	0.6	From US 74 To US 74 ALT Pvmt Joint (Begin Gore)

Esri, HERE, Garmin, SafeGraph, METI/NASA, USGS, EPA, NPS, USDA, Esri Contributor, State of North Carolina DOT, Tennessee STS GIS, © OpenStreetMap contributors, Microsoft, Esri, HERE, Garmin, SafeGraph, GeoTechnologies, Esri Contributor, NASA, USGS, EPA, NPS, US Census Bureau, USDA

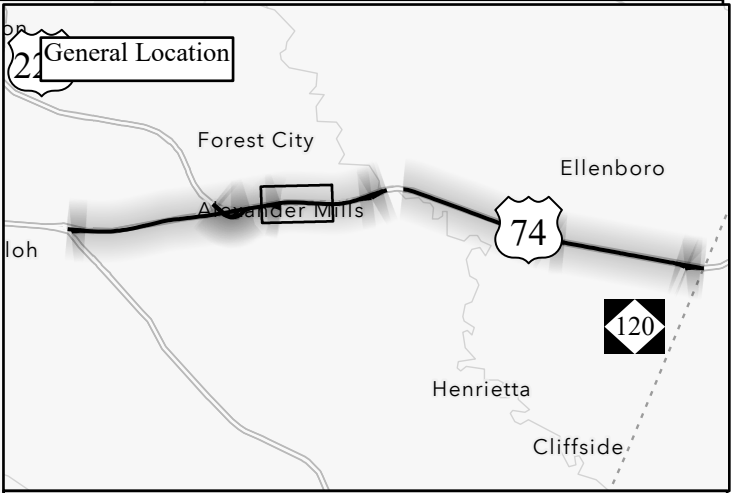
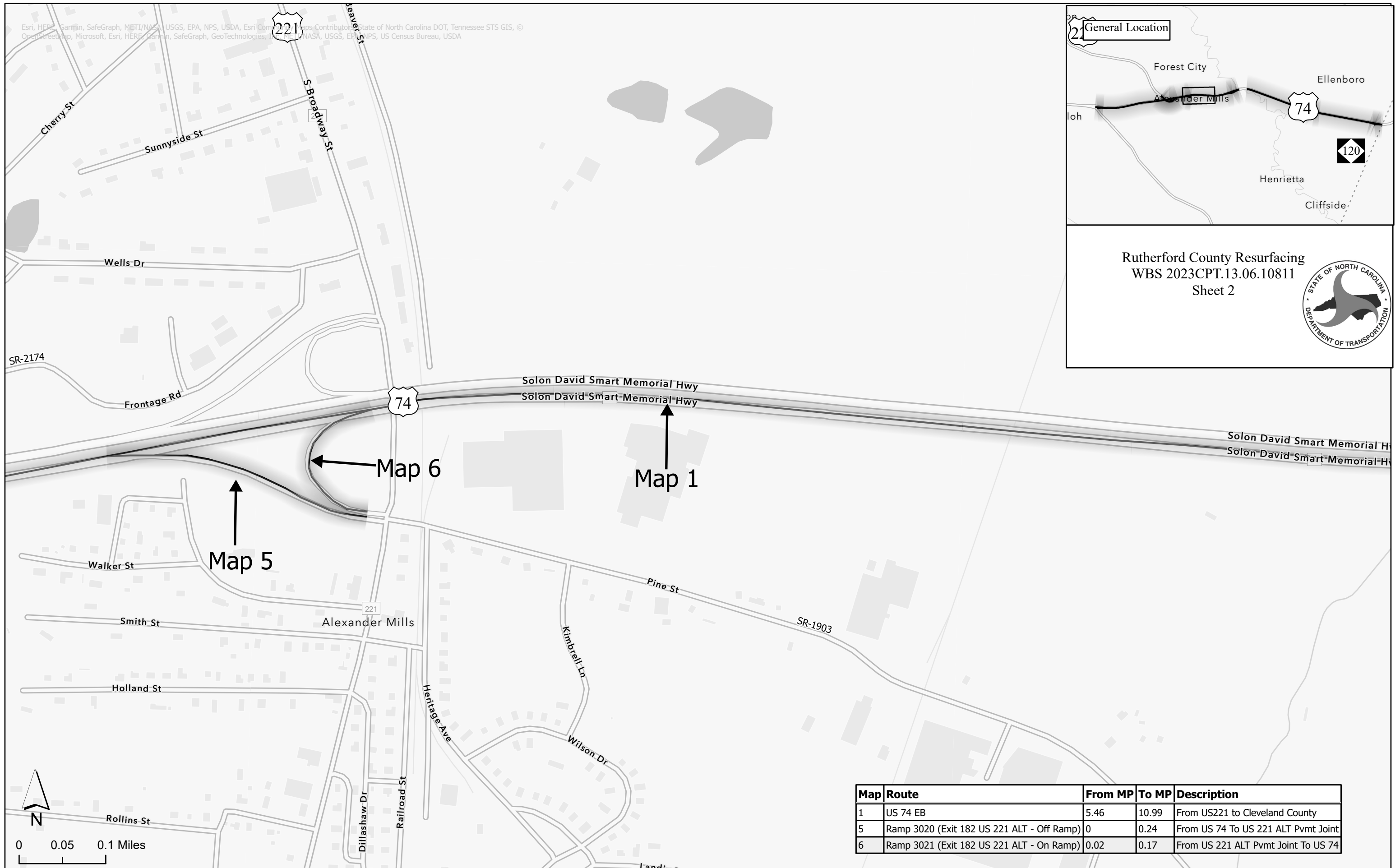

Rutherford County Resurfacing
WBS 2023CPT.13.06.10811
Sheet 2

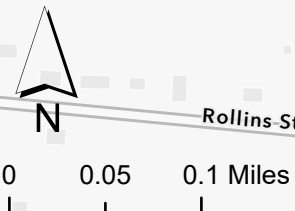
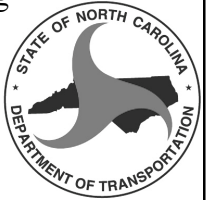

Map	Route	From MP	To MP	Description
1	US 74 EB	5.46	10.99	From US221 to Cleveland County
5	Ramp 3020 (Exit 182 US 221 ALT - Off Ramp)	0	0.24	From US 74 To US 221 ALT Pvmnt Joint
6	Ramp 3021 (Exit 182 US 221 ALT - On Ramp)	0.02	0.17	From US 221 ALT Pvmnt Joint To US 74

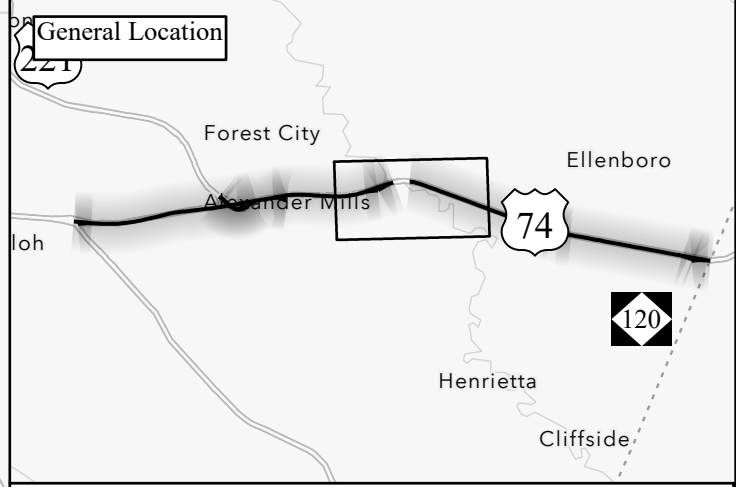

Rutherford County Resurfacing
WBS 2023CPT.13.06.10811
Sheet 3

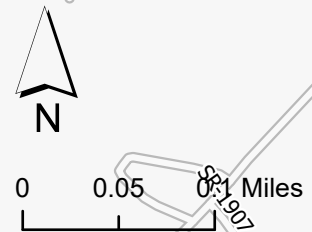
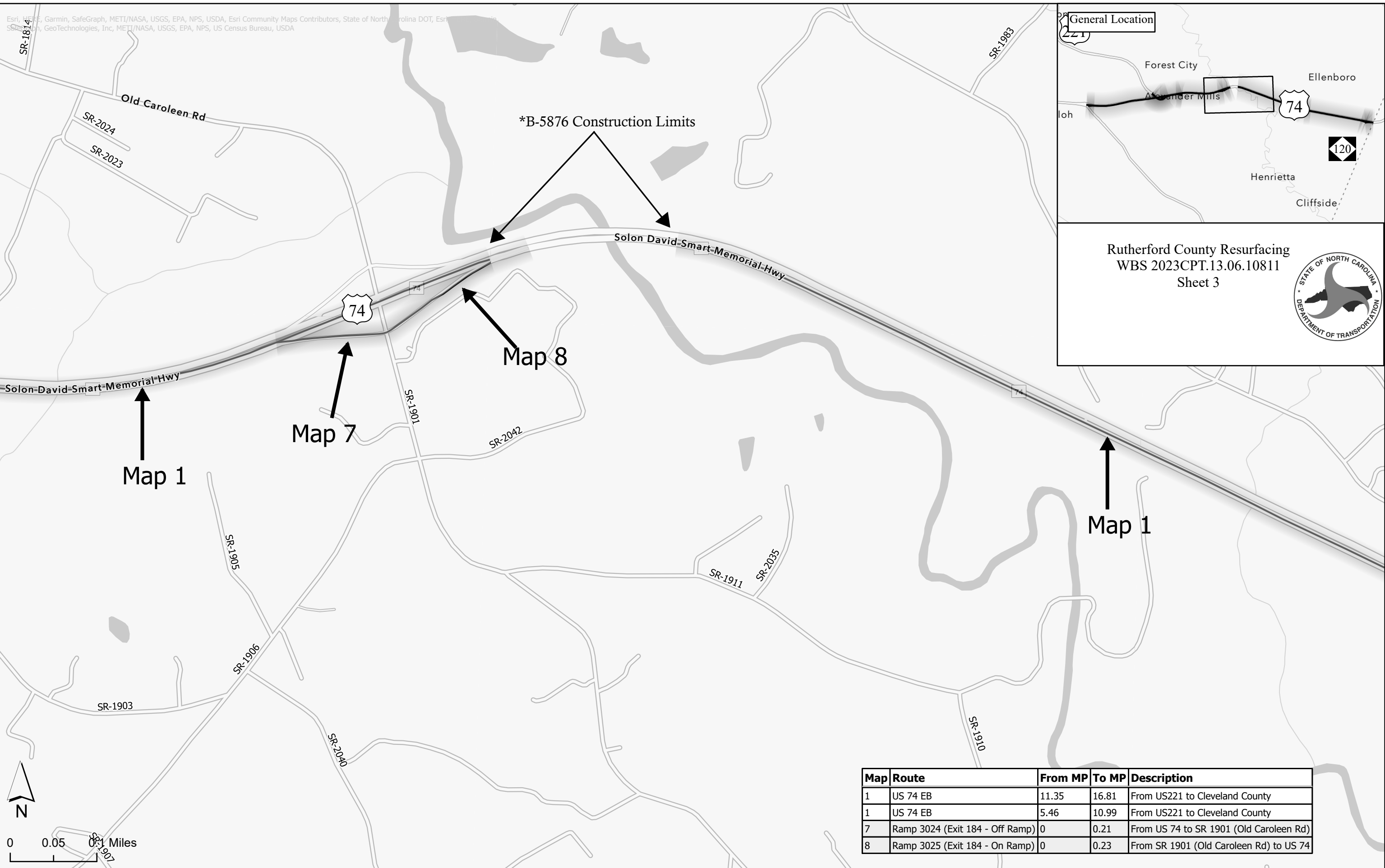

Map	Route	From MP	To MP	Description
1	US 74 EB	11.35	16.81	From US221 to Cleveland County
1	US 74 EB	5.46	10.99	From US221 to Cleveland County
7	Ramp 3024 (Exit 184 - Off Ramp)	0	0.21	From US 74 to SR 1901 (Old Caroleen Rd)
8	Ramp 3025 (Exit 184 - On Ramp)	0	0.23	From SR 1901 (Old Caroleen Rd) to US 74

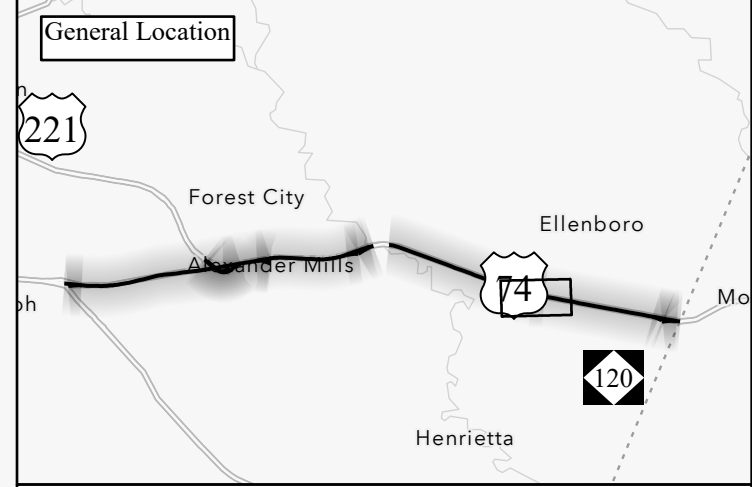
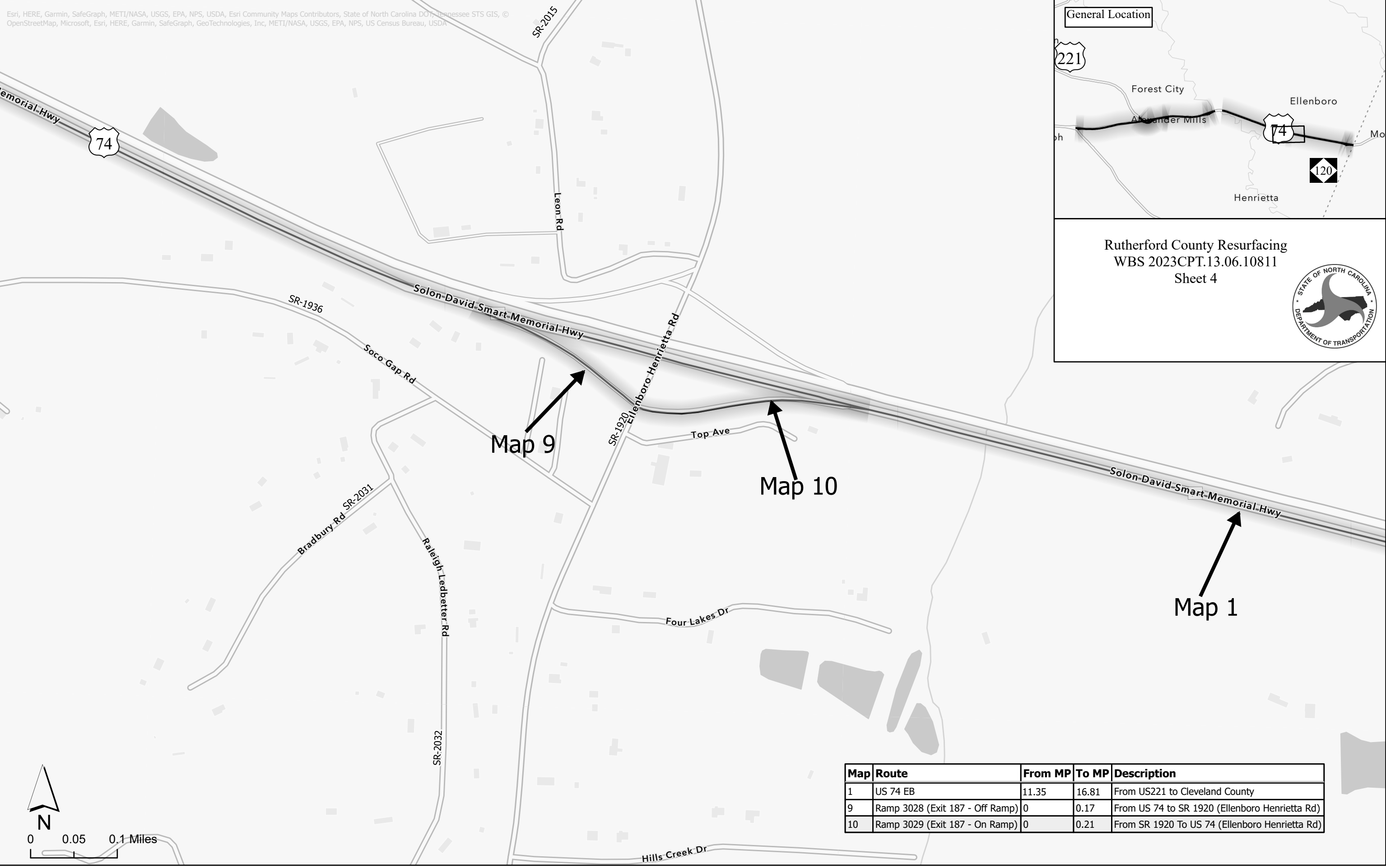

Rutherford County Resurfacing
 WBS 2023CPT.13.06.10811
 Sheet 4

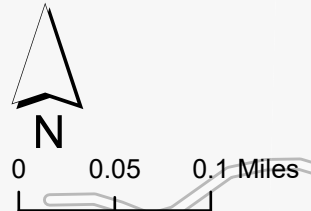

Map	Route	From MP	To MP	Description
1	US 74 EB	11.35	16.81	From US221 to Cleveland County
9	Ramp 3028 (Exit 187 - Off Ramp)	0	0.17	From US 74 to SR 1920 (Ellenboro Henrietta Rd)
10	Ramp 3029 (Exit 187 - On Ramp)	0	0.21	From SR 1920 To US 74 (Ellenboro Henrietta Rd)

Esri, HERE, Garmin, SafeGraph, METI/NASA, USGS, EPA, NPS, USDA, Esri Community Maps Contributors, Buncombe County, NC, State of North Carolina DOT, Tennessee STS GIS, © OpenStreetMap, Microsoft, Esri, HERE, Garmin, SafeGraph, GeoTechnologies, Inc, METI/NASA, USGS, EPA, NPS, US Census Bureau, USDA, Esri Community Maps Contributors, State of North Carolina DOT, Tennessee STS GIS, © OpenStreetMap, Microsoft, Esri, HERE, Garmin, SafeGraph, GeoTechnologies, Inc, METI/NASA, USGS, EPA, NPS, US Census Bureau, USDA

General Location

Rutherford County Resurfacing
WBS 2022CPT.13.06.10811
Sheet 5

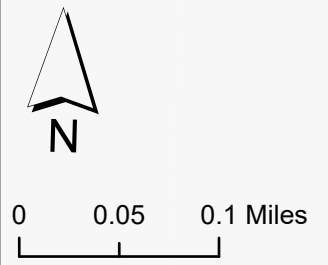
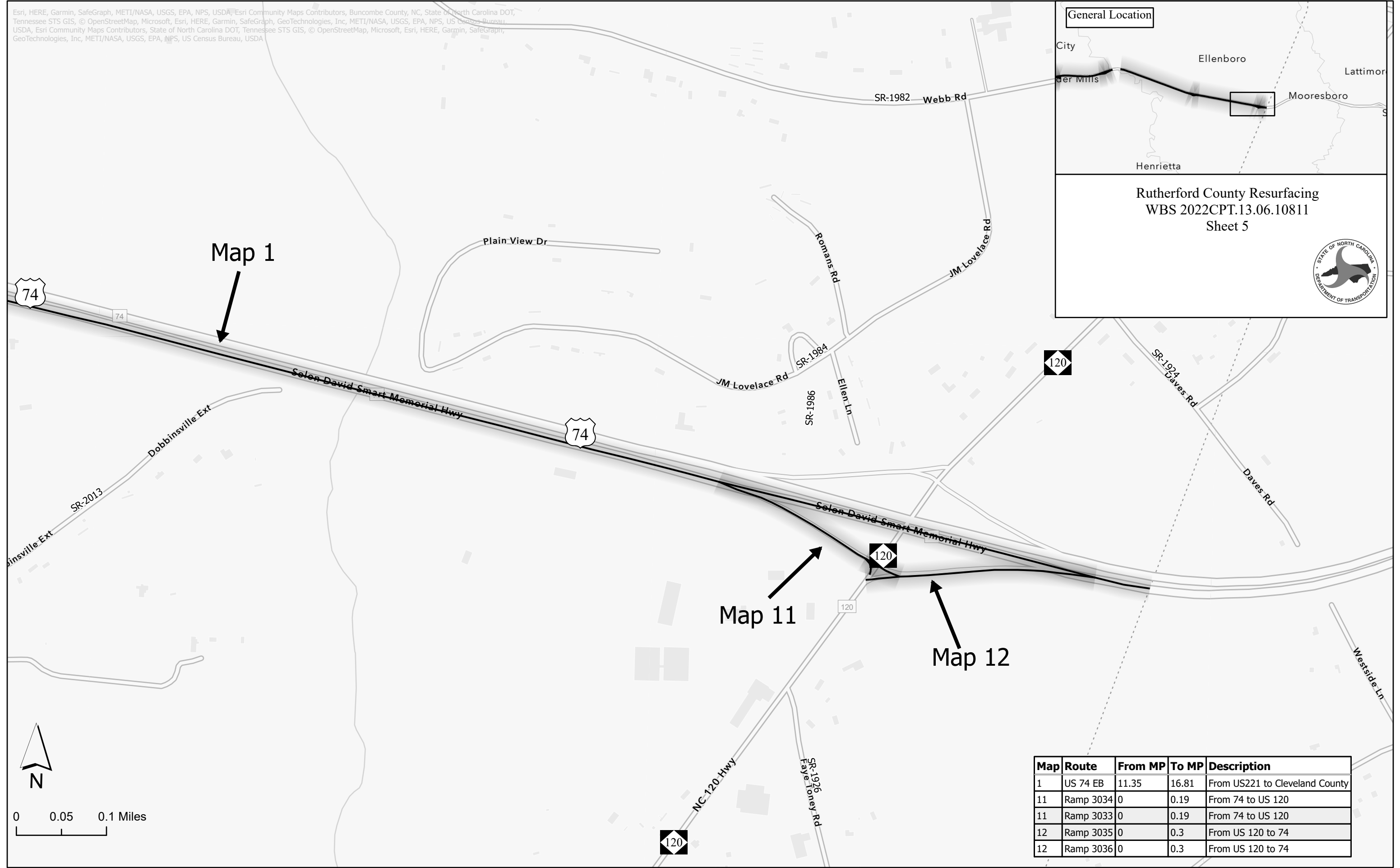

Map	Route	From MP	To MP	Description
1	US 74 EB	11.35	16.81	From US221 to Cleveland County
11	Ramp 3034	0	0.19	From 74 to US 120
11	Ramp 3033	0	0.19	From 74 to US 120
12	Ramp 3035	0	0.3	From US 120 to 74
12	Ramp 3036	0	0.3	From US 120 to 74

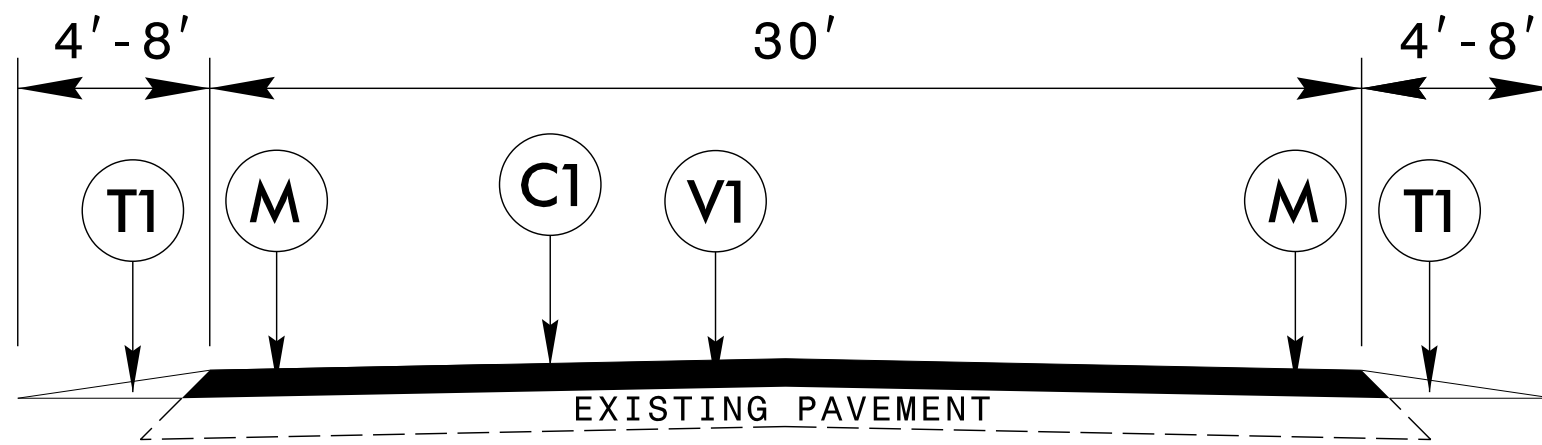

TYPICAL SECTION #1

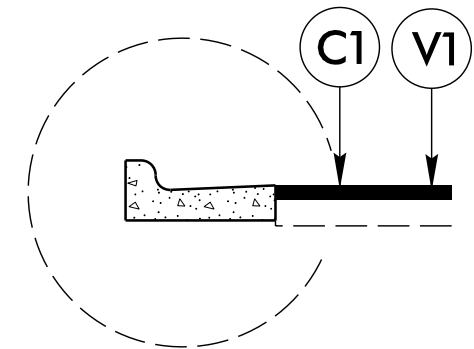

DETAIL A

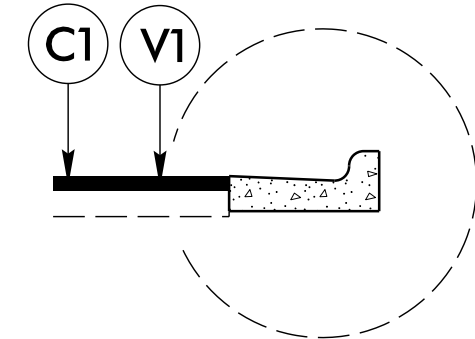

DETAIL B

NOTE: SHOULDER RECONSTRUCTION TO BE DONE AS DIRECTED BY THE ENGINEER.

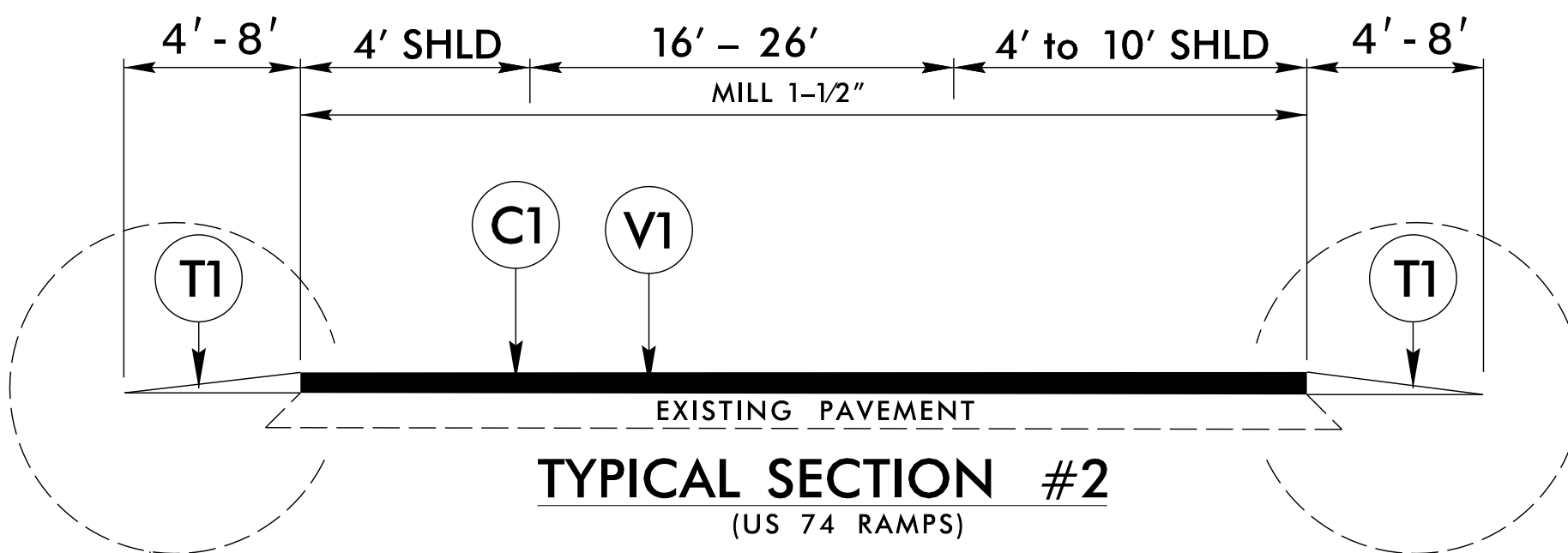

AT VARIOUS LOCATIONS SEE DETAIL A

AT VARIOUS LOCATIONS SEE DETAIL B

PAVEMENT SCHEDULE	
C1	PROP. APPROX. 1-1/2" ASPHALT CONCRETE SURFACE COURSE, TYPE S9.5C, AT AN AVERAGE RATE OF 168 LBS. PER SQ. YD.
T1	SHOULDER RECONSTRUCTION
V1	MILLING ASPHALT PAVEMENT 1-1/2" DEPTH
V2	INCIDENTAL MILLING
M	MILLED RUMBLE STRIPS

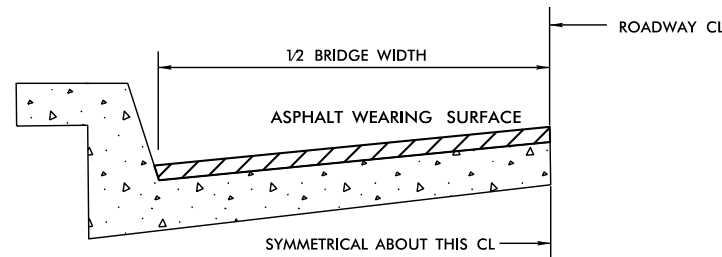

BRIDGE HALF TYPICAL SECTION

FOR BRIDGES WITH FLOOR DRAINS, CARE SHALL BE EXERCISED IN PLACING THE WEARING SURFACE AROUND FLOOR DRAINS SO AS NOT TO HINDER EFFECTIVE DRAINAGE. ALL DRAINS SHALL BE LEFT OPEN.

THE PROPOSED WEARING SURFACE SHALL VARY IN THICKNESS AS NECESSARY TO PROVIDE A SMOOTH RIDING SURFACE. THE MINIMUM THICKNESS SHOULD DEPEND ON PAVEMENT TYPE AS FOLLOWS: S4.75A 1/2", S9.5B 1", S9.5C,D 1.5" - 2". ULTRA-THIN HOT MIX ASPHALT - TYPE A 3/4". ULTRA-THIN HOT MIX ASPHALT - TYPE B 5/8". ULTRA-THIN HOT MIX ASPHALT - TYPE C 1/2". THE MAXIMUM THICKNESS SHOULD DEPEND ON PAVEMENT TYPE AS FOLLOWS: S4.75A 1", S9.5B 1.5", S9.5C,D 2". ULTRA-THIN HOT MIX ASPHALT - TYPE A 3/4", ULTRA-THIN HOT MIX ASPHALT - TYPE B 5/8", ULTRA-THIN HOT MIX ASPHALT - TYPE C 1/2".

NOTES

ALL UNPAVED ROADS TO BE RESURFACED 50' FROM EDGE OF PAVEMENT OF MAIN PROJECT. ALL PAVED S. R. ROADS TO BE RESURFACED TO THE ENDS OF THE RADII, OR AS DIRECTED BY THE ENGINEER.

EDGES, PAVEMENT WIDENING, INTERSECTIONS AND BRIDGE FLARES ARE INCLUDED IN THE TABLE OF QUANTITIES.

SHOULDERS AND DITCHES ARE TO BE CONSTRUCTED BY OTHERS UNLESS OTHERWISE INDICATED.

BRIDGES ARE TO BE RESURFACED AT LOCATIONS AND TO DEPTH AS DIRECTED BY THE ENGINEER.

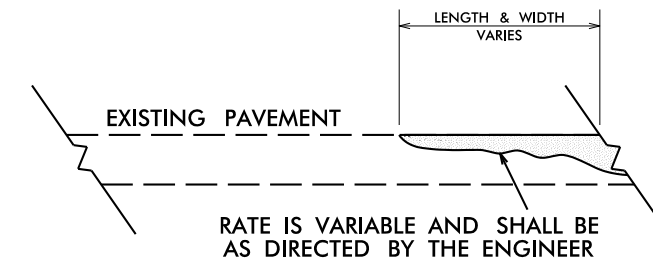
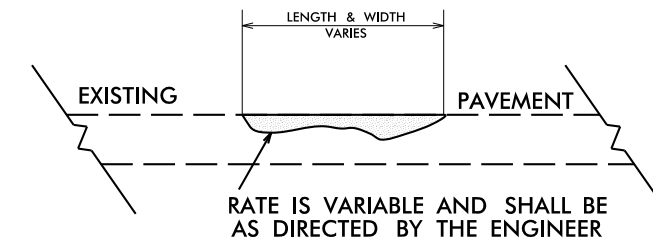

DETAIL SHOWING METHOD OF WEDGING

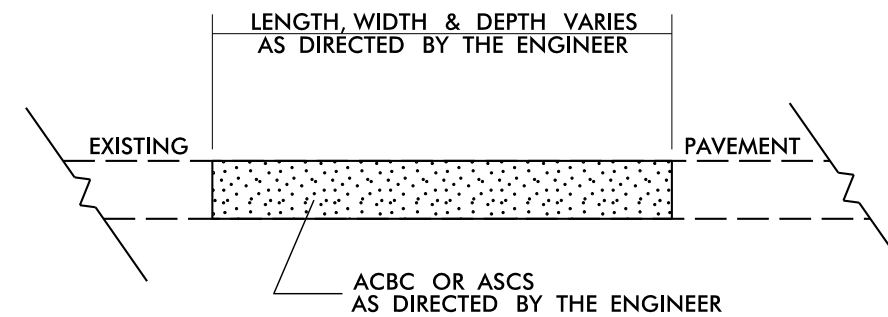

PATCHING EXISTING PAVEMENT

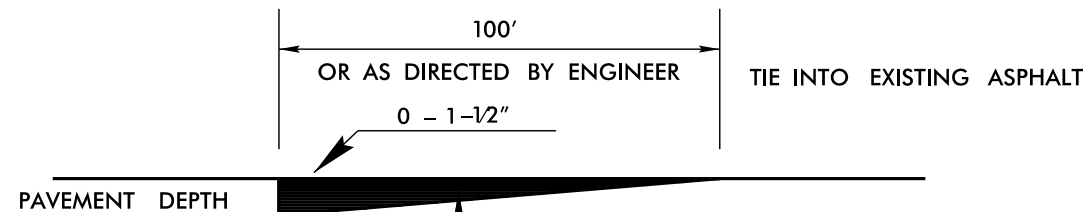

V2

DETAIL TO TIE INTO EXIST PAVEMENT

THE CONTRACTOR'S ATTENTION IS DIRECTED TO THE FACT THAT HE WILL BE REQUIRED TO MILL THE EXISTING ASPHALT PAVEMENT TO ENSURE A PROPER TIE-IN WITH THE EXISTING SURFACE AT THE BEGINNING, END AND Y LINES OF EACH MAP TO BE RESURFACED WITH ASPHALT CONC SURFACE COURSE, TYPE S9.5C. THIS WILL BE PAID FOR AS INCIDENTAL MILLING.

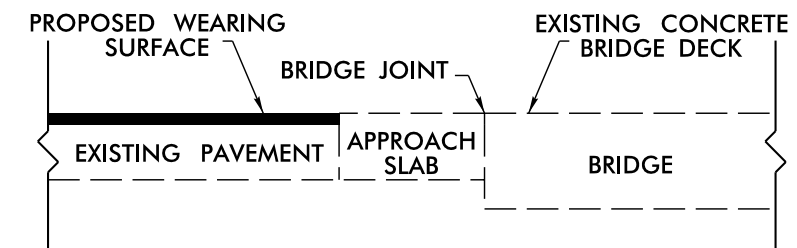

TIE-IN DETAIL AT BRIDGES

TIE PROPOSED WEARING SURFACE TO EXISTING CONC OVERLAY ON BRIDGE DECKS AND APPROACH SLABS.
BRIDGE # 633, 635 AND 83 MAP 1.

6/2/99
 12-JUL-2022 15:19
 S:\DDC\Resurfacing\2023 Resurfacing\District 1\Rutherford CR\Package\2023.DDC.dentyp and details.dgn

- NOTES:
 1) DETAIL DOES NOT APPLY TO OGAFC AND ULTRA-THIN BONDED WEARING COURSE.
 2) BACKFILL SHOULDER WITH APPROVED MATERIAL.
 3) THE SHOULDER WEDGE DEVICE MAY BE DISENGAGED AT PAVED DRIVEWAYS, SIDE STREETS, HIGH SHOULDERS, AND OTHER LOCATIONS NOT FEASIBLE TO CONSTRUCT AS APPROVED BY THE ENGINEER.

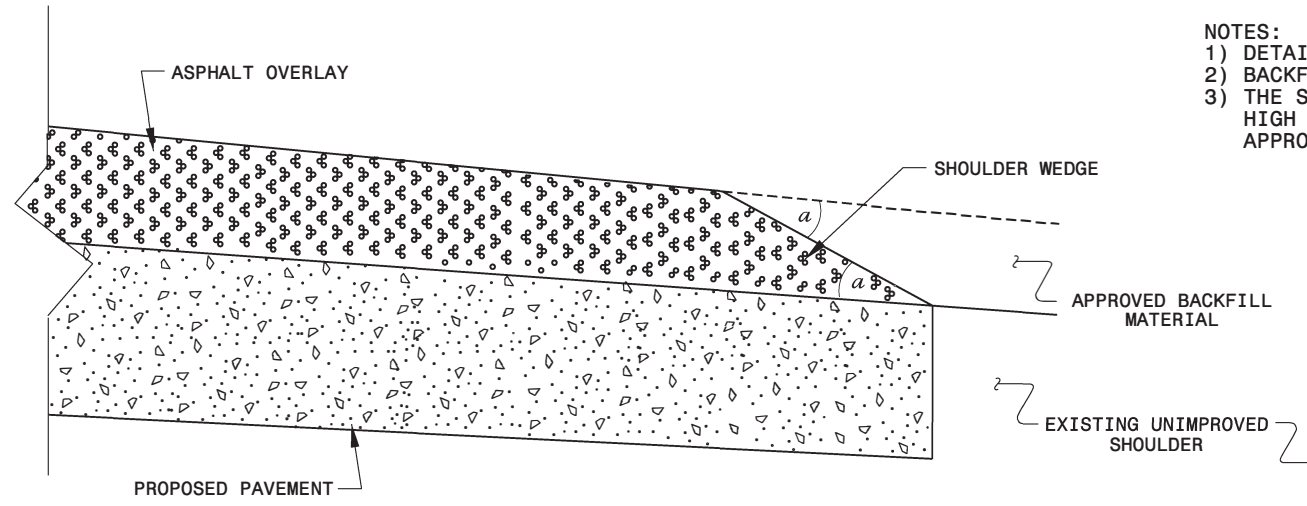

SHOULDER WEDGE DETAIL
 (Resurfacing Projects w/ Widening or with Existing Paved Shoulder having no dropoffs)

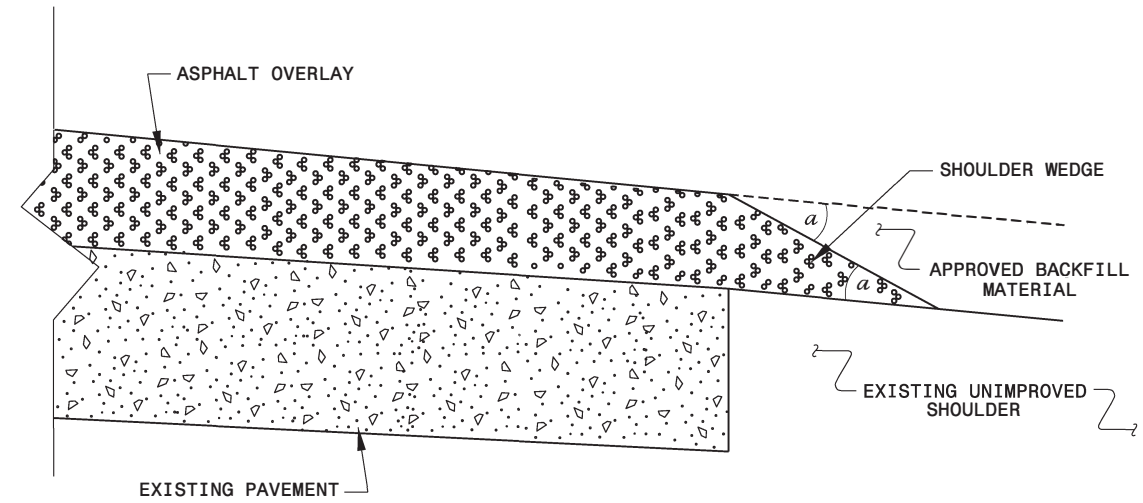

SHOULDER WEDGE DETAIL
 (Resurfacing Projects w/ NO Widening)

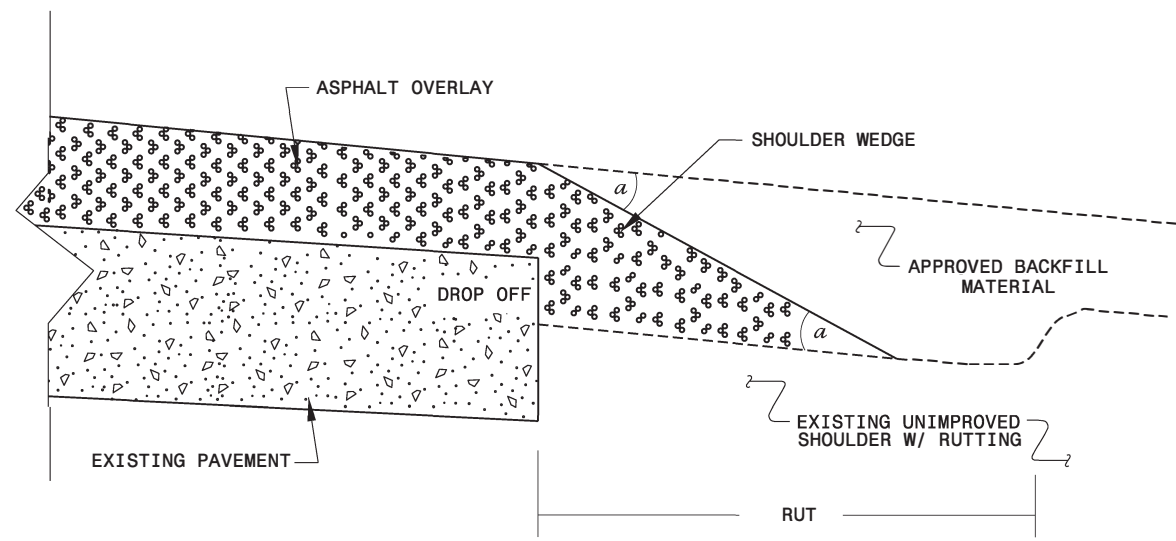

SHOULDER WEDGE DETAIL
 (Resurfacing Adjacent to Rutted Shoulder)

- SHOULDER WEDGE ANGLE = 30°



DOCUMENT NOT CONSIDERED FINAL UNLESS ALL SIGNATURES COMPLETED

CONTRACT STANDARDS AND DEVELOPMENT UNIT	
Office 919-707-6950	FAX 919-250-4119
SHOULDER WEDGE DETAILS	
ORIGINAL BY: T.SPELL	DATE: 7-19-11
MODIFIED BY:	DATE: 2/2/16
CHECKED BY:	DATE:
FILE SPEC: s:\usr\details\stand\shoulderwedge\detail.dgn	

K:\SPH-2008-10RU\S:\Contracts\Resurfacing\Projects\Shoulder\Wedge Details\Revised Shoulder Wedge Detail.dgn

PROJECT NO.	SHEET NO.	TOTAL NO.
2023CPT.13.06.10811	9	

SUMMARY OF QUANTITIES

PROJECT NO	COUNTY	MAP NO	ROUTE	DESCRIPTION	TYP NO	LANES	LANE TYPE	FINAL SURFACE TESTING REQUIRED	WARM MIX ASPHALT REQUIRED	LENGTH	WIDTH	1245000000-E	1260000000-E	1297000000-E	1330000000-E	1523000000-E	1575000000-E	1704000000-E	1840000000-E	4600000000-N	4600000000-N	4600000000-N
										MI	FT	SMI	TON	SY	SY	TON	TON	TON	LF	EA	EA	EA
2023CPT.13.06.10811	Rutherford	1	US 74 EB	FROM US 221 TO CLEVELAND COUNTY (MP 5.46 - MP 10.99) AND (MP 11.35 - MP 16.81)	1	2	2WD	NO	NO	10.99	30	3.00	384	210,584		18,259	1,148	1,085	114,618	4	49	11
2023CPT.13.06.10811	Rutherford	2	RAMP 3015 (EXIT 178 - ON RAMP)	FROM US 221 TO US 74 (MP 0.05 - MP 0.24)	2	1	2WU	NO	NO	0.24	24			3,050		256	15		395			
2023CPT.13.06.10811	Rutherford	3	US 74 ALT - ON RAMP	FROM US 74 ALT PVMT JOINT (BACK OF GORE) TO US 74 EAST BOUND (MP 30.16 - MP 30.97)	2	1	2WU	NO	NO	0.81	32			15,191		1,276	77		345			
2023CPT.13.06.10811	Rutherford	4	RAMP 3018 (EXIT 181 US 74 ALT - OFF RAMP)	FROM US 74 TO US 74 ALT PVMT JOINT (TIP OF GORE) (MP 0.00 - MP 0.60)	2	1	2WU	NO	NO	0.6	24			8,448		710	43		260			
2023CPT.13.06.10811	Rutherford	5	RAMP 3020 (EXIT 182 US 221 ALT - OFF RAMP)	FROM US 74 TO US 221 ALT PVMT JOINT (MP 0.00 - MP 0.24)	2	1	2WU	NO	NO	0.24	24			3,883		322	19		370			
2023CPT.13.06.10811	Rutherford	6	RAMP 3021 (EXIT 182 US 221 ALT - ON RAMP)	FROM US 221 ALT PVMT JOINT TO US 74 (MP 0.02 - MP 0.15)	2	1	2WU	NO	NO	0.15	18			1,630		137	8		200			
2023CPT.13.06.10811	Rutherford	7	RAMP 3024 (EXIT 184 - OFF RAMP)	FROM US 74 TO SR 1901 (OLD CAROLEEN RD) (MP 0.00 - MP 0.21)	2	1	2WU	NO	NO	0.21	24			3,260	440	274	16		120			
2023CPT.13.06.10811	Rutherford	8	RAMP 3025 (EXIT 184 - ON RAMP)	FROM SR 1901 (OLD CAROLEEN RD) TO US 74 (MP 0.00 - MP 0.23)	2	1	2WU	NO	NO	0.23	24			3,570	330	300	18		85			
2023CPT.13.06.10811	Rutherford	9	RAMP 3028 (EXIT 187 - OFF RAMP)	FROM US 74 TO SR 1920 (ELLENBORO HENRIETTA RD) (MP 0.00 - MP 0.17)	2	1	2WU	NO	NO	0.17	25			2,717	350	228	14		300			
2023CPT.13.06.10811	Rutherford	10	RAMP 3029 (EXIT 187 - ON RAMP)	FROM SR 1920 TO US 74 (ELLENBORO HENRIETTA RD) (MP 0.00 - MP 0.21)	2	1	2WU	NO	NO	0.21	24			2,960	470	249	15		310			
2023CPT.13.06.10811	Rutherford	11	RAMP 3034, 3033 (EXIT 189 - OFF RAMP)	FROM US 74 TO US 120 (MP 0.00 - MP 0.19)	2	1	2WU	NO	NO	0.19	25			3,071	384	258	15		410			
2023CPT.13.06.10811	Rutherford	12	RAMP 3035, 3036 (EXIT 189 - ON RAMP)	FROM US 120 TO US 74 (MP 0.00 - MP 0.30)	2	1	2WU	NO	NO	0.3	24			4,035	750	340	20		275			
TOTAL FOR PROJ NO. 2023CPT.13.06.10811										14.34		3.00	384	262,399	2,724	22,609	1,408	1,085	117,688	4	49	11
GRAND TOTAL										14.34		3.00	384	262,399	2,724	22,609	1,408	1,085	117,688	4	49	11

PROJECT NO.	SHEET NO.	TOTAL NO.
2023CPT.13.06.10811	10	

THERMOPLASTIC AND PAINT QUANTITIES

PROJECT NO	COUNTY	MAP NO	ROUTE	DESCRIPTION	TYP NO	LANES	LANE TYPE	LENGTH	WIDTH	4400000000-E	4600000000-N	4688000000-E		4695000000-E		4700000000-E	4704000000-E	4709000000-E	4720000000-E
								MI	FT	SF			THERMOPLASTIC PAVEMENT MARKING LINES (6", 90 MILS) WHITE	THERMOPLASTIC PAVEMENT MARKING LINES (6", 90 MILS) YELLOW	THERMOPLASTIC PAVEMENT MARKING LINES (8", 90 MILS) WHITE	THERMOPLASTIC PAVEMENT MARKING LINES (8", 90 MILS) YELLOW	THERMOPLASTIC PAVEMENT MARKING LINES (12", 90 MILS) WHITE	THERMOPLASTIC PAVEMENT MARKING LINES (16", 90 MILS)	THERMOPLASTIC PAVEMENT MARKING LINES (24", 90 MILS) WHITE
2023CPT.13.06.10811	Rutherford	1	US 74 EB	FROM US 221 TO CLEVELAND COUNTY (MP 5.46 - MP 10.99) AND (MP 11.35 - MP 16.81)	1	2	2WD	10.99	30	590	4	80,646	58,555						4
2023CPT.13.06.10811	Rutherford	2	RAMP 3015 (EXIT 178 - ON RAMP)	FROM US 221 TO US 74 (MP 0.05 - MP 0.24)	2	1	2WU	0.24	24			1,350	900			455			
2023CPT.13.06.10811	Rutherford	3	US 74 ALT - ON RAMP	FROM US 74 ALT PVMT JOINT (BACK OF GORE) TO US 74 EAST BOUND (MP 30.16 - MP 30.97)	2	1	2WU	0.81	32					3,189	7,650	1,102	1,386		
2023CPT.13.06.10811	Rutherford	4	RAMP 3018 (EXIT 181 US 74 ALT - OFF RAMP)	FROM US 74 TO US 74 ALT PVMT JOINT (TIP OF GORE) (MP 0.00 - MP 0.60)	2	1	2WU	0.60	24			3,210	2,900			300			
2023CPT.13.06.10811	Rutherford	5	RAMP 3020 (EXIT 182 US 221 ALT - OFF RAMP)	FROM US 74 TO US 221 ALT PVMT JOINT (MP 0.00 - MP 0.24)	2	1	2WU	0.24	24			1,350	900			840		60	
2023CPT.13.06.10811	Rutherford	6	RAMP 3021 (EXIT 182 US 221 ALT - ON RAMP)	FROM US 221 ALT PVMT JOINT TO US 74 (MP 0.02 - MP 0.15)	2	1	2WU	0.15	18			812	612			240			
2023CPT.13.06.10811	Rutherford	7	RAMP 3024 (EXIT 184 - OFF RAMP)	FROM US 74 TO SR 1901 (OLD CAROLEEN RD) (MP 0.00 - MP 0.21)	2	1	2WU	0.21	24			1,450	970			610		20	
2023CPT.13.06.10811	Rutherford	8	RAMP 3025 (EXIT 184 - ON RAMP)	FROM SR 1901 (OLD CAROLEEN RD) TO US 74 (MP 0.00 - MP 0.23)	2	1	2WU	0.23	24			1,295	1,165			190			
2023CPT.13.06.10811	Rutherford	9	RAMP 3028 (EXIT 187 - OFF RAMP)	FROM US 74 TO SR 1920 (ELLENBORO HENRIETTA RD) (MP 0.00 - MP 0.17)	2	1	2WU	0.17	25			1,090	600			400		40	
2023CPT.13.06.10811	Rutherford	10	RAMP 3029 (EXIT 187 - ON RAMP)	FROM SR 1920 TO US 74 (ELLENBORO HENRIETTA RD) (MP 0.00 - MP 0.21)	2	1	2WU	0.21	24			1,170	780			517			
2023CPT.13.06.10811	Rutherford	11	RAMP 3034, 3033 (EXIT 189 - OFF RAMP)	FROM US 74 TO US 120 (MP 0.00 - MP 0.19)	2	1	2WU	0.19	25			1,240	670			535		60	
2023CPT.13.06.10811	Rutherford	12	RAMP 3035, 3036 (EXIT 189 - ON RAMP)	FROM US 120 TO US 74 (MP 0.00 - MP 0.30)	2	1	2WU	0.30	24			1,560	1,015			490			
TOTAL FOR PROJ NO. 2023CPT.13.06.10811								14.34		590	4	95,173	69,067	3,189	7,650	5,679	1,386	180	4
												164,240		10,839					
GRAND TOTAL								14.34		590	4	95,173	69,067	3,189	7,650	5,679	1,386	180	4
												164,240		10,839					

PROJECT NO.	SHEET NO.	TOTAL NO.
2023CPT.13.06.10811	11	

THERMOPLASTIC AND PAINT QUANTITIES

PROJECT NO	COUNTY	MAP NO	ROUTE	DESCRIPTION	TYP NO	LANES	LANE TYPE	LENGTH	WIDTH	4725000000-E			4810000000-E		4825000000-E	4835000000-E	4840000000-N	4845000000-N			4850000000-E	4905100000-N
										THERMOPLASTIC PAVEMENT MARKING SYMBOL (90 MILS) RT ARROW	THERMOPLASTIC PAVEMENT MARKING SYMBOL (90 MILS) MERGE ARROW	THERMOPLASTIC PAVEMENT MARKING SYMBOL (90 MILS) STR & LT ARROW	PAINT PAVEMENT MARKING LINES (4") WHITE	PAINT PAVEMENT MARKING LINES (4") YELLOW	PAINT PAVEMENT MARKING LINES (12") WHITE	PAINT PAVEMENT MARKING LINES (24") WHITE	PAINT PAVEMENT MARKING CHARACTER ONLY	PAINT PAVEMENT MARKING SYMBOL (RT ARROW)	PAINT PAVEMENT MARKING SYMBOL (MERGE ARROW)	PAINT STR & LT ARROW	REMOVAL OF PAVEMENT MARKING LINES (4")	NON-CAST IRON SNOWPLOWABLE PAVEMENT MARKERS
										EA	EA	EA	LF	LF	LF	LF	EA	EA	EA	EA	LF	EA
2023CPT.13.06.10811	Rutherford	1	US 74 EB	FROM US 221 TO CLEVELAND COUNTY (MP 5.46 - MP 10.99) AND (MP 11.35 - MP 16.81)	1	2	2WD	10.99	30				80,646	58,555				4	2	15		855
2023CPT.13.06.10811	Rutherford	2	RAMP 3015 (EXIT 178 - ON RAMP)	FROM US 221 TO US 74 (MP 0.05 - MP 0.24)	2	1	2WU	0.24	24				1,350	900	455							12
2023CPT.13.06.10811	Rutherford	3	US 74 ALT - ON RAMP	FROM US 74 ALT PVMT JOINT (BACK OF GORE) TO US 74 EAST BOUND (MP 30.16 - MP 30.97)	2	1	2WU	0.81	32			5	3,189	7,650	690				5		190	32
2023CPT.13.06.10811	Rutherford	4	RAMP 3018 (EXIT 181 US 74 ALT - OFF RAMP)	FROM US 74 TO US 74 ALT PVMT JOINT (TIP OF GORE) (MP 0.00 - MP 0.60)	2	1	2WU	0.60	24				3,210	2,900	300							14
2023CPT.13.06.10811	Rutherford	5	RAMP 3020 (EXIT 182 US 221 ALT - OFF RAMP)	FROM US 74 TO US 221 ALT PVMT JOINT (MP 0.00 - MP 0.24)	2	1	2WU	0.24	24		2		1,350	900	840	60			2		1	42
2023CPT.13.06.10811	Rutherford	6	RAMP 3021 (EXIT 182 US 221 ALT - ON RAMP)	FROM US 221 ALT PVMT JOINT TO US 74 (MP 0.02 - MP 0.15)	2	1	2WU	0.15	18				812	612	240							14
2023CPT.13.06.10811	Rutherford	7	RAMP 3024 (EXIT 184 - OFF RAMP)	FROM US 74 TO SR 1901 (OLD CAROLEEN RD) (MP 0.00 - MP 0.21)	2	1	2WU	0.21	24				1,450	970	610	20						30
2023CPT.13.06.10811	Rutherford	8	RAMP 3025 (EXIT 184 - ON RAMP)	FROM SR 1901 (OLD CAROLEEN RD) TO US 74 (MP 0.00 - MP 0.23)	2	1	2WU	0.23	24				1,295	1,165	190							12
2023CPT.13.06.10811	Rutherford	9	RAMP 3028 (EXIT 187 - OFF RAMP)	FROM US 74 TO SR 1920 (ELLENBORO HENRIETTA RD) (MP 0.00 - MP 0.17)	2	1	2WU	0.17	25				1,090	600	400	40						24
2023CPT.13.06.10811	Rutherford	10	RAMP 3029 (EXIT 187 - ON RAMP)	FROM SR 1920 TO US 74 (ELLENBORO HENRIETTA RD) (MP 0.00 - MP 0.21)	2	1	2WU	0.21	24				1,170	780	517							22
2023CPT.13.06.10811	Rutherford	11	RAMP 3034, 3033 (EXIT 189 - OFF RAMP)	FROM US 74 TO US 120 (MP 0.00 - MP 0.19)	2	1	2WU	0.19	25				1,240	670	535	60						26
2023CPT.13.06.10811	Rutherford	12	RAMP 3035, 3036 (EXIT 189 - ON RAMP)	FROM US 120 TO US 74 (MP 0.00 - MP 0.30)	2	1	2WU	0.30	24				1,560	1,015	490							24
TOTAL FOR PROJ NO. 2023CPT.13.06.10811								14.34		4	20	1	98,362	76,717	5,267	180	4	4	20	1	190	1,107
										25			175,079			25						
GRAND TOTAL								14.34		4	20	1	98,362	76,717	5,267	180	4	4	20	1	190	1,107
										25			175,079			25						

SIGNING FOR RESURFACING PROJECTS

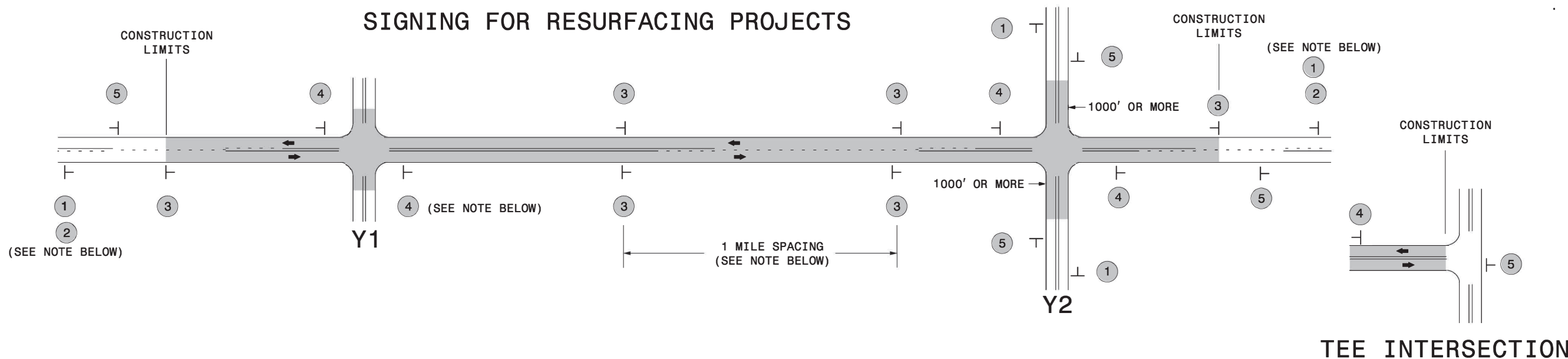

LEGEND	
—	STATIONARY SIGN
←	DIRECTION OF TRAFFIC FLOW

MAINLINE (-L-) SIGNING

-Y- LINE SIGNING

SIGNING NOTES AND PLACEMENT PER DIRECTION	1	2	3	4	5	
						<p>NO REQUIRED STATIONARY SIGNING FOR THE FOLLOWING -Y- LINE CONDITIONS:</p> <ol style="list-style-type: none"> 1) LESS THAN 1000' OF RESURFACING ALONG -Y- LINE 2) SUBDIVISION ROADS 3) DEAD END ROADS <p>WHEN PAVING/CONSTRUCTION ACTIVITIES PROCEED ACROSS AN UNSIGNED -Y- LINE, ADVANCE WARNING PORTABLE SIGNS SHALL BE USED ALONG THE -Y- LINE AS SHOWN BELOW. REMOVE UPON COMPLETION OF WORK.</p> <div style="display: flex; justify-content: space-around;"> <div style="text-align: center;"> <small>W20-1 48" X 48"</small> </div> <div style="text-align: center;"> <small>W20-7 A 48" X 48"</small> </div> </div> <p>PLACED 500' IN ADVANCE OF FLAGGER. PLACED 250' IN ADVANCE OF FLAGGER.</p>
	<p>PLACE 1000' PRIOR TO BEGINNING OF CONSTRUCTION LIMITS. ONLY USED ON -Y- LINES IF RESURFACING LIMITS EXTEND 1000' ALONG -Y- LINE.</p> <p>#2 SIGN ONLY USED WHEN RESURFACING LIMITS ARE 2 OR MORE MILES IN LENGTH. ROUND UP TO NEXT WHOLE NUMBER. (NO FRACTIONAL OR DECIMAL NUMBERS)</p>		<p>- PLACE INITIALLY AT THE CONSTRUCTION LIMITS AND SPACE 1 MILE APART THEREAFTER.</p> <p>- AT TEE INTERSECTIONS INSTALL INITIALLY 0.5 MILE FROM INTERSECTION AND SPACE 1 MILE APART THEREAFTER.</p>			
			<p>- THESE ARE FOR -Y- LINES THAT ARE "THROUGH" ROADWAYS. DEAD END AND SUBDIVISION ROADS ARE NOT "THROUGH" ROADWAYS.</p> <p>- INSTALL 500' +/- FROM EACH -Y- LINE APPROACH AS SHOWN ABOVE.</p> <p>- FOR MULTIPLE -Y- LINES THAT ARE SEPARATED BY 0.25 MILES OR LESS, TREAT AS A SINGLE UNIT AND INSTALL WITHIN 500' OF EACH APPROACH.</p> <p>- A MAXIMUM OF 2 SIGN SETS PER MILE. DO NOT INSTALL WHEN -Y- LINES ARE WITHIN 0.5 MILES FROM "END ROAD WORK" SIGN.</p> <p>- FOR TEE INTERSECTIONS, INSTALL WITHIN 500' +/- OF THE INTERSECTION ALONG -L- LINE.</p>			
			<p>PLACE 500' FOLLOWING THE END OF CONSTRUCTION LIMITS OR AS SHOWN WHEN WORK ENDS AT A 3-WAY TEE INTERSECTION.</p>			

DIVISION OF HIGHWAYS
STATE OF NORTH CAROLINA
DEPARTMENT OF TRANSPORTATION
WORK ZONE TRAFFIC CONTROL

**RESURFACING
ADVANCE WARNING SIGNS
FOR
RURAL AND SUBURBAN
2 LANE ROADWAYS**

URBAN / SUBURBAN WORKZONES

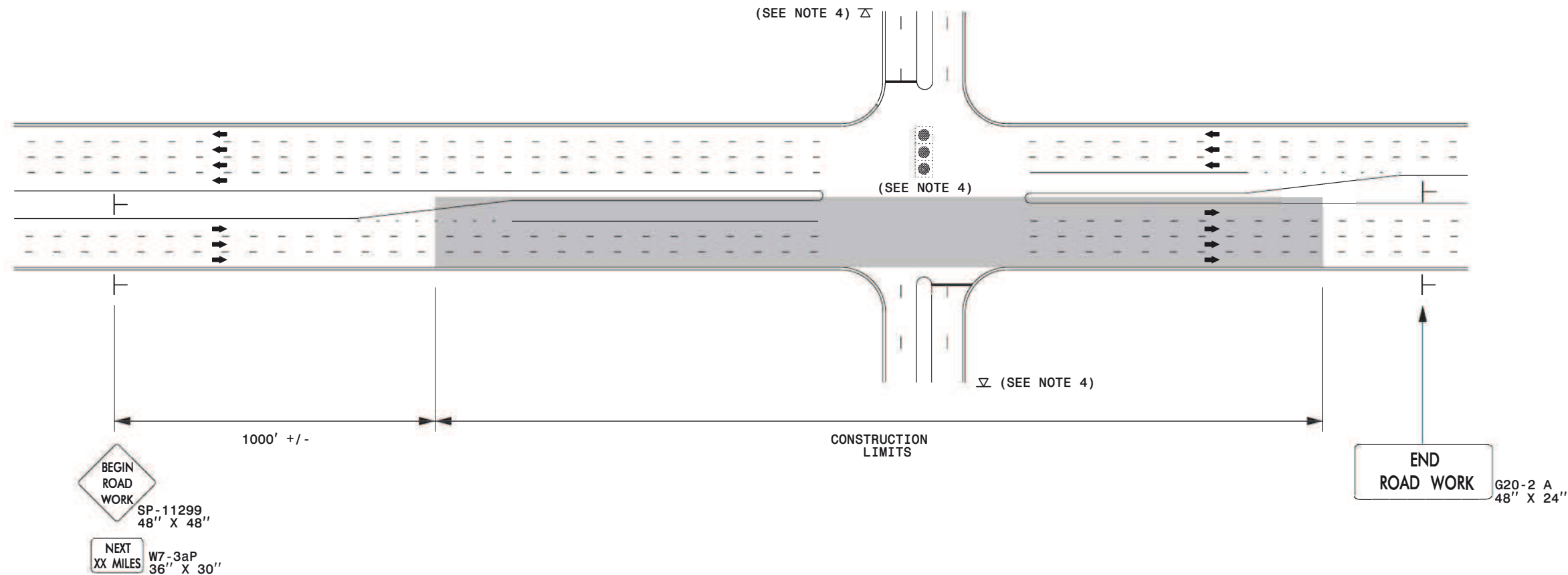

NOTES:

- 1) 48" x 48" SIZED SIGNS (SP- 11299) MAY BE REDUCED TO 36" X 36" ON ROADWAYS WITH SPEED LIMITS OF 40 MPH OR LESS.
- 2) MOUNT SIGNS THAT ARE LARGER THAN 10 SQUARE FEET IN AREA ON TWO OR MORE WOOD OR U-CHANNEL SUPPORTS. PERFORATED SQUARE TUBING SUPPORT SYSTEMS MAY SUPPORT LARGER AREAS ON A SINGLE SUPPORT. FOLLOW MANUFACTURER'S RECOMMENDATIONS. THESE SYSTEMS SHALL BE NCHRP 350 COMPLIANT AND NCDOT APPROVED.
- 3) ADVANCE WARNING SIGNS NOT REQUIRED ON NON-SIGNALIZED SIDE STREETS.
- 4) MAY USE LAW ENFORCEMENT TO CONTROL TRAFFIC AT SIGNALIZED INTERSECTIONS AS DIRECTED BY THE ENGINEER. PROVIDE PORTABLE "ROAD WORK AHEAD" (W20-1) SIGNS 500' IN ADVANCE ALONG BOTH APPROACHES FROM THE SIDE STREETS WHEN PAVING PROCEEDS THROUGH THE INTERSECTION.
- 5) LATERAL CLEARANCE AT ALL SIGN LOCATIONS SHALL BE 2' AS MEASURED FROM THE EDGE OF PAVEMENT OR THE FACE OF THE CURB. WHEN UNABLE TO OBTAIN THE LATERAL CLEARANCE WITHIN THE MEDIAN AREA USE SHOULDER MOUNTS ONLY.
- 6) SIGN MOUNT LOCATIONS SHALL NOT BLOCK SIDEWALKS OR DRIVEWAYS.
- 7) IF STATIONARY GENERAL WARNING SIGNS ARE USED, THEY WILL BE PAID FOR PER SECTION 104 OF THE NCDOT STANDARD SPECIFICATIONS AS EXTRA WORK.
- 8) IF MILLED AREAS ARE NOT PAVED BACK BY THE END OF THE WORK DAY, PORTABLE SIGNS SHALL BE USED TO WARN DRIVERS OF THE PRESENT CONDITIONS. THESE ARE TO INCLUDE, BUT NOT LIMITED TO "ROUGH ROAD" W8-8, "UNEVEN LANES" W8-11, "GROOVED PAVEMENT" W8-15 w/MOTORCYCLE PLAQUE MOUNTED BELOW. THESE ARE TO BE DOUBLE INDICATED ON MULTI-LANE ROADWAYS WITH SPEED LIMITS 45 MPH AND GREATER WHERE LATERAL CLEARANCE CAN BE OBTAINED WITHIN THE MEDIAN AREAS. THESE PORTABLE SIGNS ARE INCIDENTAL TO THE OTHER ITEMS OF WORK INCLUDED IN THE TEMPORARY TRAFFIC CONTROL (LUMP SUM) PAY ITEM.

LEGEND

- ┆ STATIONARY SIGN
- ➔ DIRECTION OF TRAFFIC FLOW

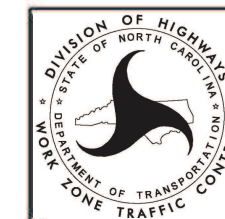

RESURFACING ADVANCE WARNING SIGNS FOR URBAN / SUBURBAN FACILITIES

SIGN NUMBER: 11299

BACKG COLOR: Fluorescent Orange

DESIGN BY: WJ

CHECKED BY:

DATE: Jun 22, 2011

TYPE: B

COPY COLOR: Black

PROJECT ID: ALL

DIV: ALL

QUANTITY: SEE PLANS

SYMBOL	X	Y	WID	HT

SIGN WIDTH: 5'-6"

HEIGHT: 5'-6"

SP 11299

TOTAL AREA: 30.5 Sq.Ft.

BORDER TYPE: INSET

RECESS: 0.59"

WIDTH: 0.75"

RADII: 1.38"

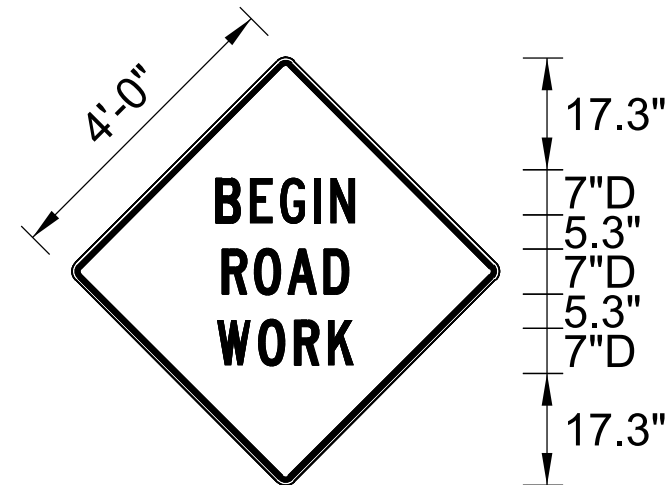

BORDER
R=1.38"
TH=0.75"
IN=0.59"

Spacing Factor is 1 unless specified otherwise

NO. Z BARS: N/A
LENGTH: N/A

MAT'L: 0.125" (3.2 mm) ALUMINUM

USE NOTES: 1,2

- Legend and border shall be direct applied black non-reflective sheeting.
- Background shall be Type VII, VIII, or IX (prismatic) fluorescent orange retroreflective sheeting.

LETTER POSITIONS

Letter spacings are to start of next letter

Series/Size
Text Length

Letter spacings are to start of next letter																	Series/Size Text Length	
		B	E	G	I	N												D 2000 25.2
	20.5	6	5.4	6.3	2.8	4.8	20.5											
		R	O	A	D													D 2000 23.5
	21.4	5.8	5.9	7	4.8	21.4												
		W	O	R	K													D 2000 24.5
	20.9	7.1	6.5	5.9	4.9	20.9												

SIGN NUMBER: SP13106
TYPE: STATIONARY
QUANTITY: SEE PLANS

BACKG COLOR: Fluorescent Orange
COPY COLOR: Black

DESIGN BY: B. RASHID
PROJECT ID:

CHECKED BY: AIA
DIV:

DATE: Apr 26, 2013

SIGN WIDTH: 4'-0"
HEIGHT: 4'-0"
TOTAL AREA: 16.00 Sq.Ft.

SYMBOL	X	Y	WID	HT

BORDER TYPE: INSET
RECESS: 0.75"
WIDTH: 1.25"
RADII: 3"

MAT'L: 0.080" (2.0 mm) ALUMINUM

NO. Z BARS:
LENGTH:

USE NOTES: 1,2

1. Legend and border shall be direct applied black non-reflective sheeting.
2. Background shall be NC GRADE B fluoresent orange retroreflective sheeting.

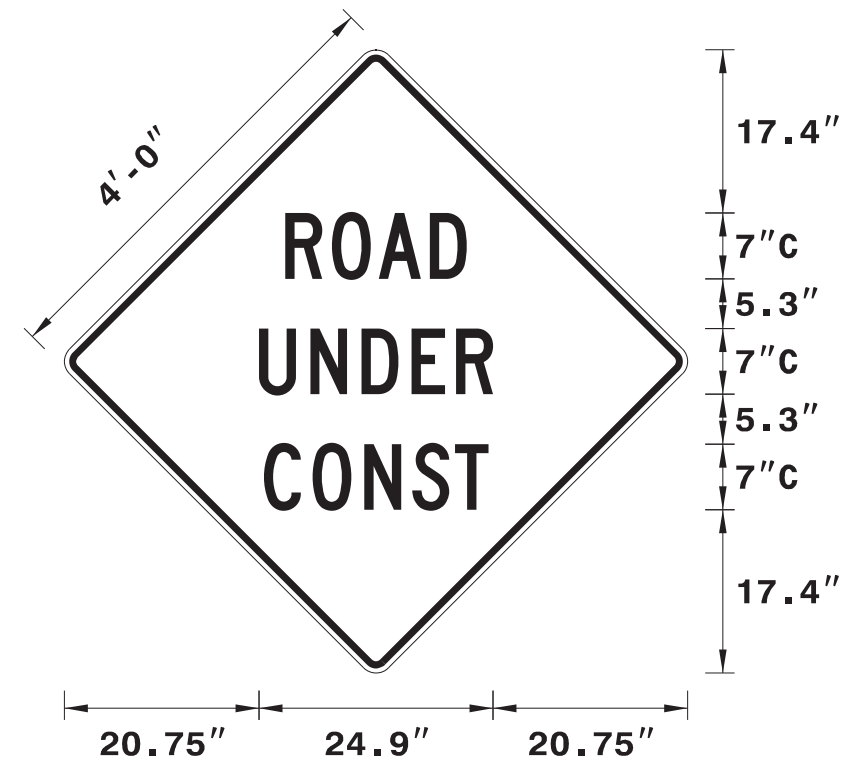

Spacing Factor is 1 unless specified otherwise

LETTER POSITIONS

Letter spacings are to start of next letter																				Series/Size Text Length	
		R	O	A	D																C 2000 19.3
	23.5	5	5	5.5	3.9	23.5															C 2000 24.9
		U	N	D	E	R															C 2000 23.9
	20.7	5.5	5.5	5.3	4.8	3.9	20.7														
		C	O	N	S	T															
	21.2	5.2	5.5	5.1	4.6	3.6	21.2														

SIGN NUMBER: SP13107
 TYPE: STATIONARY
 QUANTITY: SEE PLANS

BACKG COLOR: Fluorescent Orange
 COPY COLOR: Black

DESIGN BY: B. RASHID
 PROJECT ID:

CHECKED BY: AIA
 DIV:

DATE: Apr 26, 2013

SIGN WIDTH: 4'-0"
 HEIGHT: 4'-0"
 TOTAL AREA: 16.00 Sq.Ft.

BORDER TYPE: INSET
 RECESS: 0.75"
 WIDTH: 1.25"
 RADII: 3"

NO. Z BARS:
 LENGTH:

SYMBOL	X	Y	WID	HT

MAT'L: 0.080" (2.0 mm) ALUMINUM

USE NOTES: 1,2

- Legend and border shall be direct applied black non-reflective sheeting.
- Background shall be NC GRADE B fluoesent orange retroreflective sheeting.

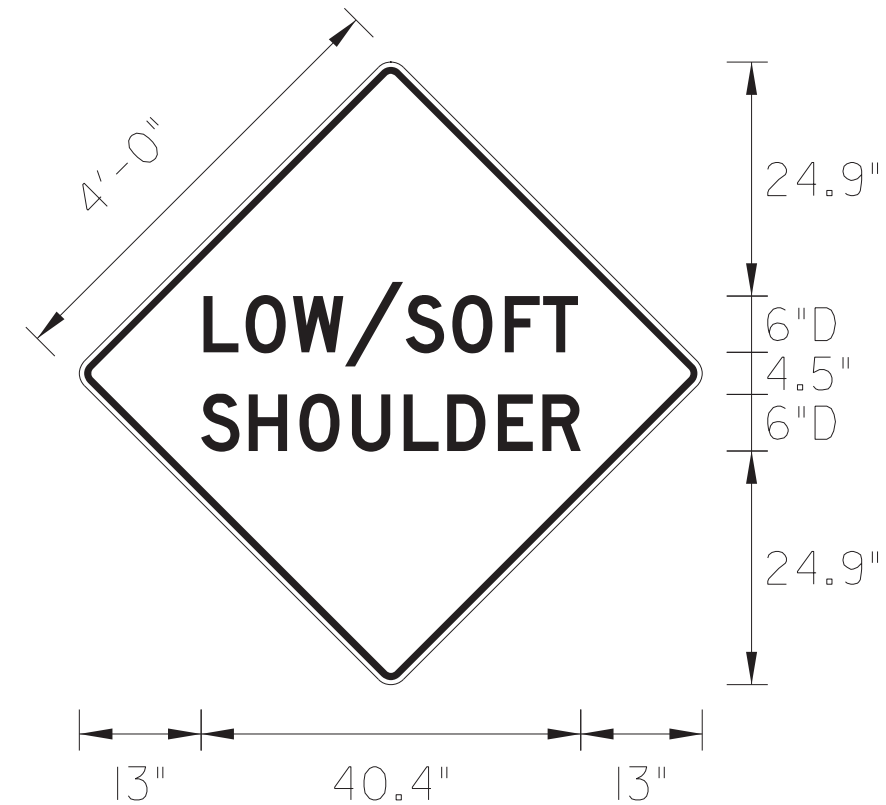

Spacing Factor is 1 unless specified otherwise

LETTER POSITIONS

Letter spacings are to start of next letter											Series/Size	
											Text Length	
	L	O	W	/	S	O	F	T				D 2000
13.2	4.5	5	5.5	6.5	5	5.6	4.1	3.7	13.2			39.9
	S	H	O	U	L	D	E	R				D 2000
13	5.1	5.4	5.6	5.5	4.6	5.4	4.7	4.1	13			40.4

STATE OF NORTH CAROLINA
DEPARTMENT OF TRANSPORTATION

PAVEMENT MARKING PLAN
RUTHERFORD COUNTY

LOCATION: FOREST CITY US-74A EAST TO US-74 EAST

APPROVED: _____

DATE: _____

SEAL

DOCUMENT NOT CONSIDERED FINAL
UNLESS ALL SIGNATURES COMPLETED

ROADWAY STANDARD DRAWING

THE FOLLOWING ROADWAY STANDARDS AS APPEAR IN "ROADWAY STANDARD DRAWINGS" - PROJECT SERVICES UNIT - N.C. DEPARTMENT OF TRANSPORTATION - RALEIGH, N.C., DATED JANUARY 2018 ARE APPLICABLE TO THIS PROJECT AND BY REFERENCE HEREBY ARE CONSIDERED A PART OF THESE PLANS:

STD. NO.	TITLE
1205.01	PAVEMENT MARKINGS - LINE TYPES AND OFFSETS
1205.02	PAVEMENT MARKINGS - TWO-LANE AND MULTILANE ROADWAYS
1205.03	PAVEMENT MARKINGS - EXIT AND ENTRANCE RAMP
1205.08	PAVEMENT MARKINGS - SYMBOLS AND WORD MESSAGES
1205.09	PAVEMENT MARKINGS - PAINTED ISLANDS
1205.13	PAVEMENT MARKINGS - LANE REDUCTIONS
1250.01	RAISED PAVEMENT MARKERS - INSTALLATION SPACING
1251.01	RAISED PAVEMENT MARKERS - PERMANENT AND TEMPORARY
1253.01	RAISED PAVEMENT MARKERS - SNOWPLOWABLE

GENERAL NOTES

THE FOLLOWING GENERAL NOTES APPLY AT ALL TIMES FOR THE DURATION OF THE CONSTRUCTION PROJECT, EXCEPT WHEN OTHERWISE NOTED IN THE PLAN, OR DIRECTED BY THE ENGINEER.

- A) INSTALL PAVEMENT MARKINGS AND PAVEMENT MARKERS ON THE FINAL SURFACE AS FOLLOWS:

ROAD NAME	MARKING	MARKER
US 74A	THERMOPLASTIC	

- B) TIE PROPOSED PAVEMENT MARKING LINES TO EXISTING PAVEMENT MARKING LINES.
C) REMOVE/REPLACE ANY CONFLICTING/DAMAGED PAVEMENT MARKINGS AND MARKERS.
D) UNLESS OTHERWISE SPECIFIED, HEATED-IN-PLACE THERMOPLASTIC MAY BE USED

IN LIEU OF EXTRUDED THERMOPLASTIC FOR STOP BARS, SYMBOLS, CHARACTERS AND DIAGONALS. IF HEATED-IN-PLACE IS USED, IT SHALL BE PAID FOR USING THE EXTRUDED THERMOPLASTIC PAY ITEM.

INDEX

SHEET NO.	DESCRIPTION
PMP-1	PAVEMENT MARKING PLAN TITLE
PMP-2-4	PAVEMENT MARKING DETAIL

PLAN PREPARED BY: N.C.D.O.T. SIGNING AND DELINEATION UNIT

KELVIN JORDAN SIGNING & DELINEATION REGIONAL ENGINEER

ERIC WARD SIGNING & DELINEATION PROJECT DESIGN ENGINEER/TECHNICIAN



TIP NO.	SHEET NO.
2023CPT.13.06.10811	PMP-2
	US-74A
APPROVED: _____	
DATE: _____	
SEAL	
DOCUMENT NOT CONSIDERED FINAL UNLESS ALL SIGNATURES COMPLETED	



\$\$\$SYTIME\$\$\$
 \$\$\$CON\$\$\$
 \$\$\$USHERNAME\$\$\$
 \$\$\$\$\$\$

FOREST CITY
US 74A EAST TO US 74 EAST

TIP NO.	SHEET NO.
2023CPT.13.06.10811	PMP-3
	US-74A
APPROVED:	_____
DATE:	_____
SEAL	
DOCUMENT NOT CONSIDERED FINAL UNLESS ALL SIGNATURES COMPLETED	



11/20/23 11:58 AM
 C:\PROJECTS\2023\13.06.10811\13.06.10811_PMP-3\13.06.10811_PMP-3_SHEET 3.dwg
 PLOT SCALE: 1"=50'
 PLOT AREA: 11.5" x 11.5"

**FOREST CITY
US 74A EAST TO US 74 EAST**

TIP NO.	SHEET NO.
2023CPT.13.06.10811	PMP-4 US-74A
APPROVED: _____	
DATE: _____	
SEAL	
DOCUMENT NOT CONSIDERED FINAL UNLESS ALL SIGNATURES COMPLETED	



MATCHLINE SEE PMP-3

30' 4' ST. GNS

**FOREST CITY
US 74A EAST TO US 74 EAST**