

p:\gfn\p-w\benfley.com\gfn\p-w-01\Documents\Projects\67945\5-Work\King\Task 005 - I-5889B Rehab\Structures\CAD\2.0 100% Plans\403_095_I-5889B_SMU_B3D_016_100344
 7/25/2022 9:14:32 AM pdf_color_gfclt_FS.plt I-5889B.TBI

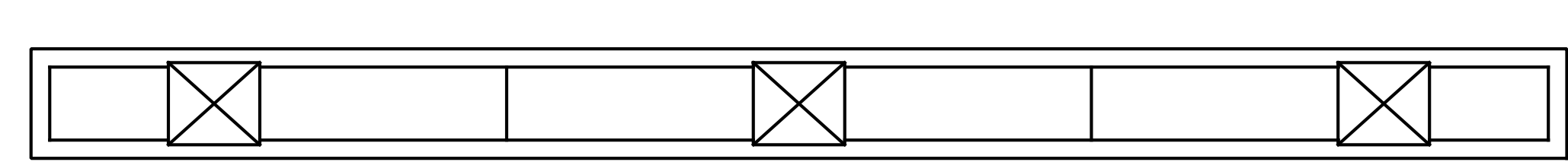

BOTTOM OF CAP

SPAN C
SPAN D

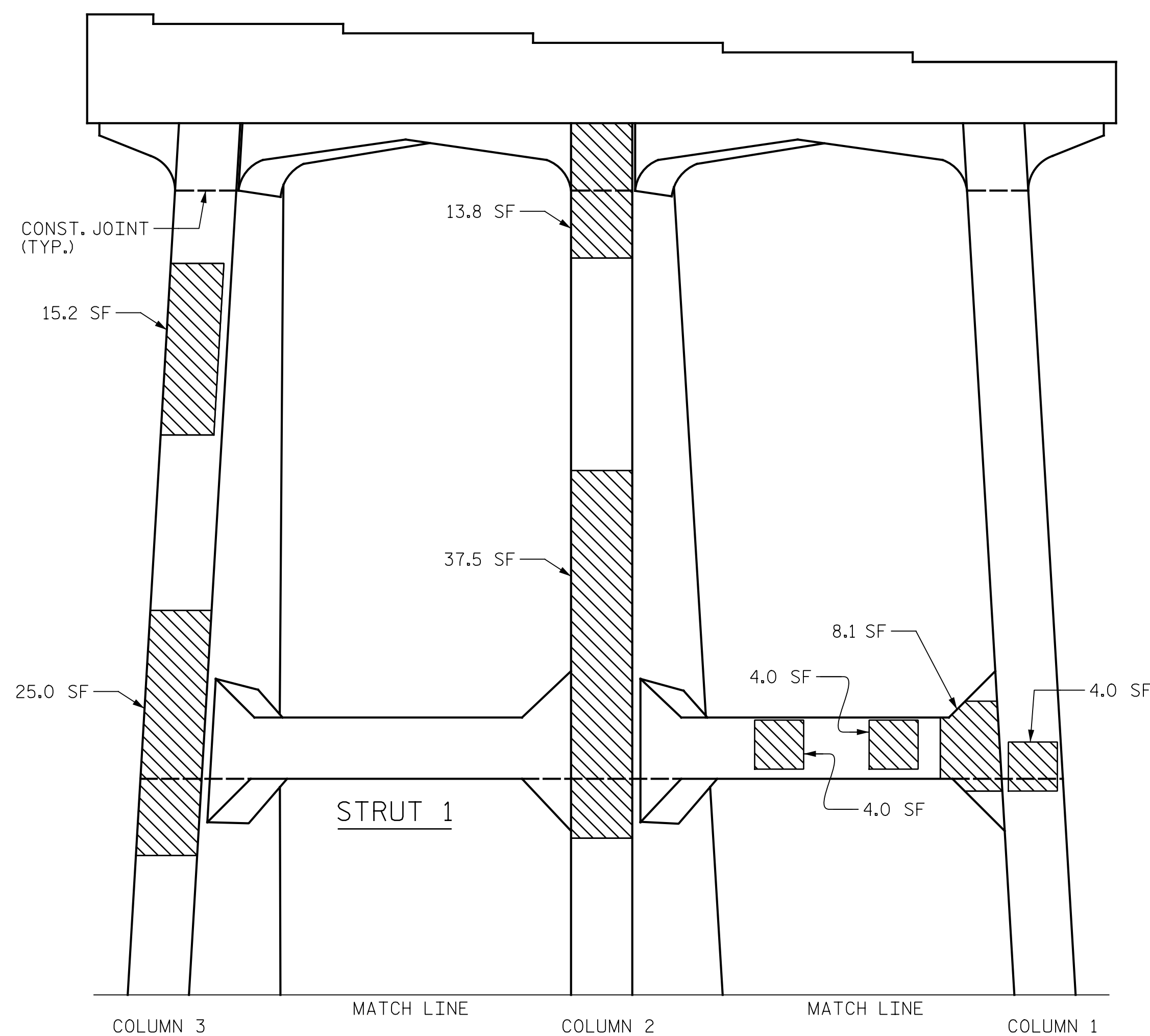

ELEVATION
(SHOWING UPPER PORTION)

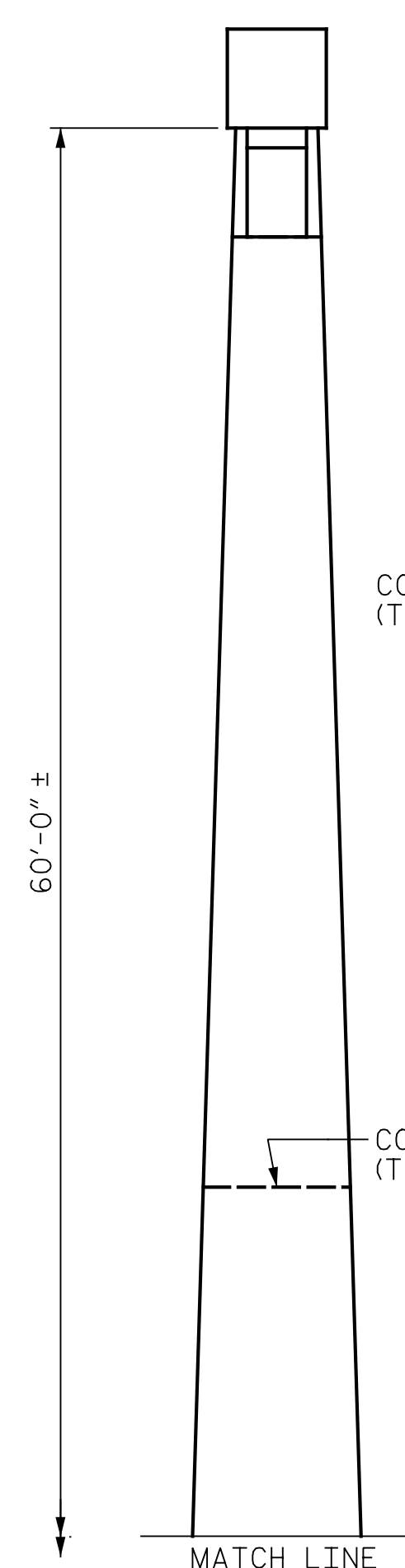

END VIEW
(SHOWING UPPER PORTION)
(COLUMN 1)

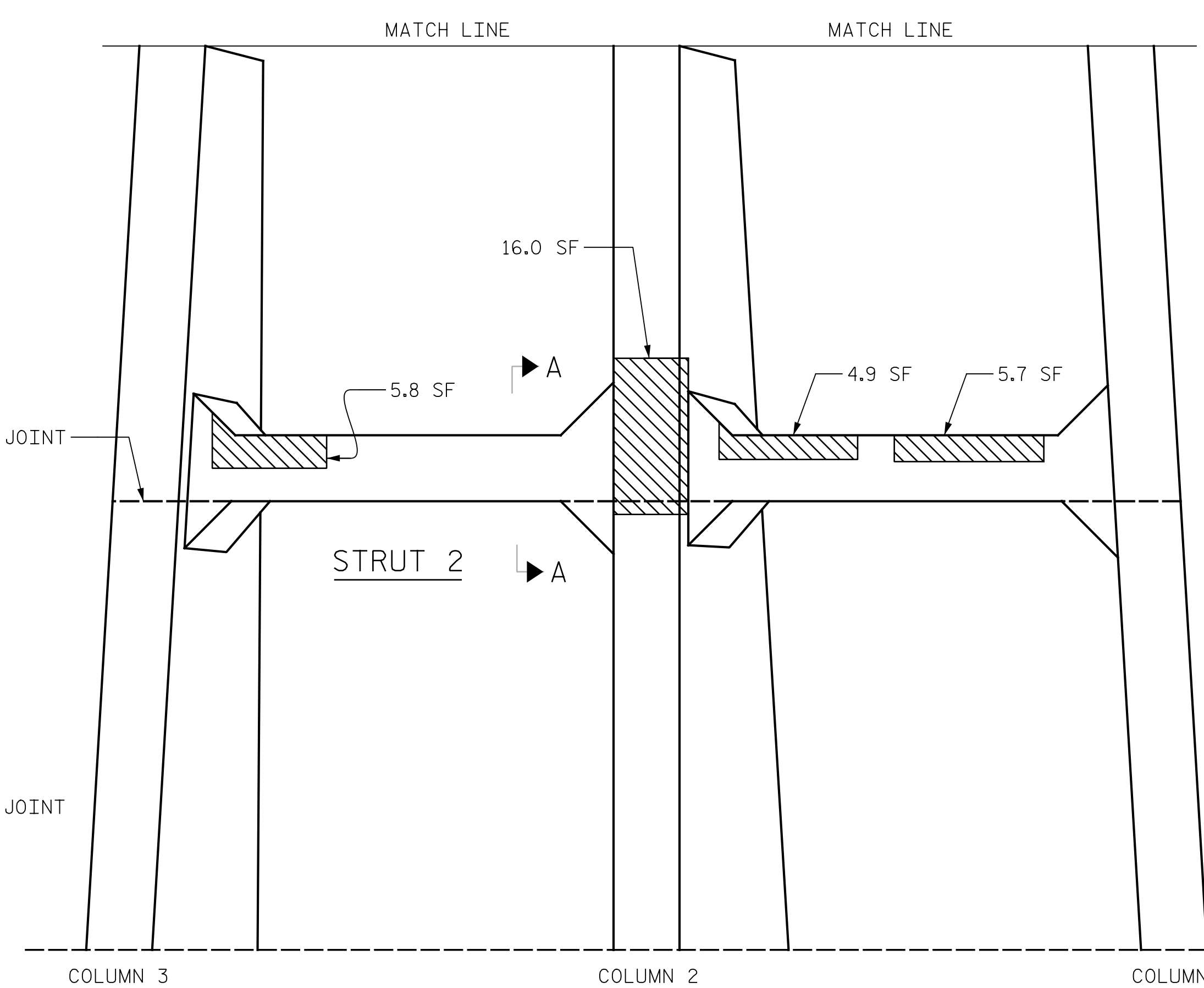

ELEVATION
(SHOWING LOWER PORTION)

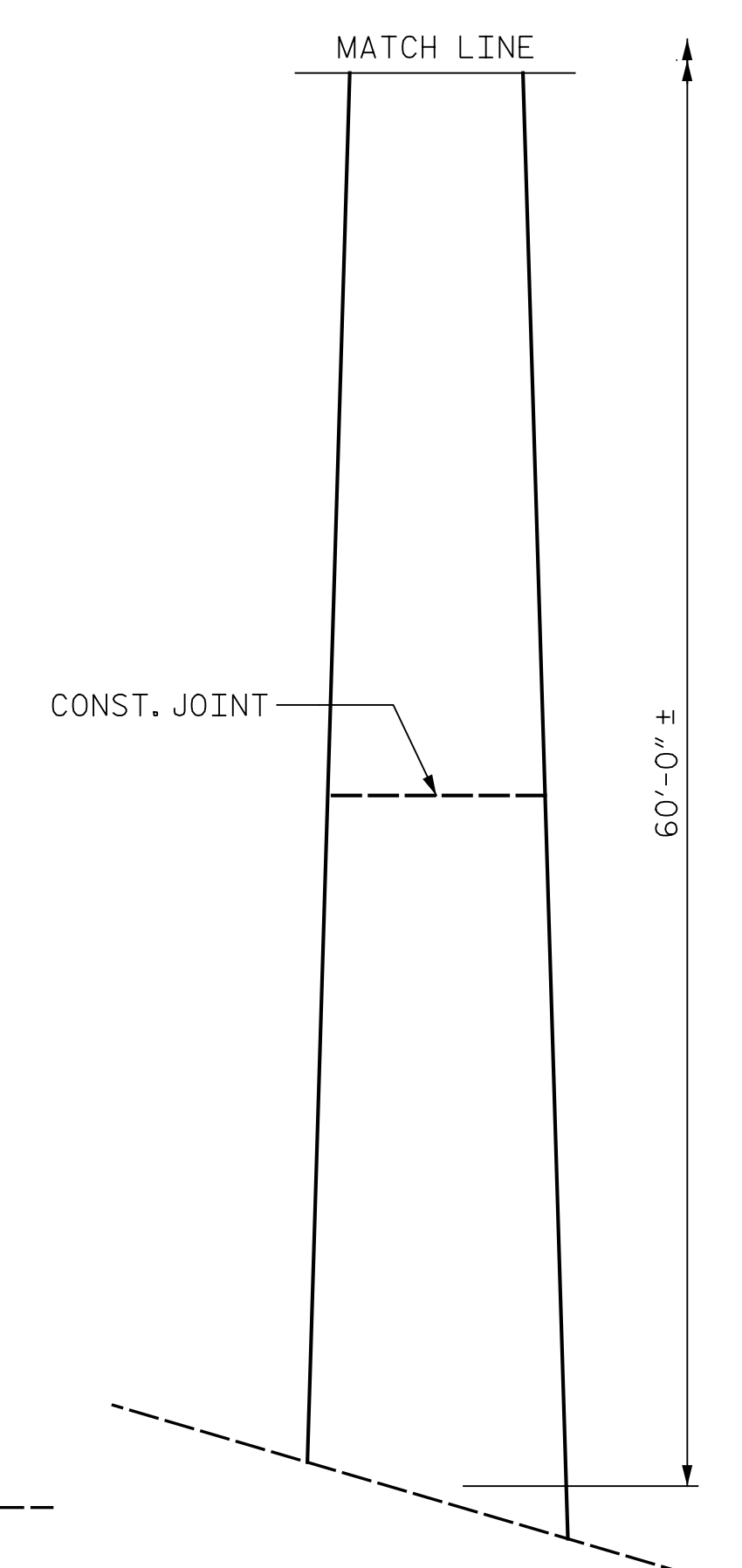

END VIEW
(SHOWING LOWER PORTION)
(COLUMN 1)

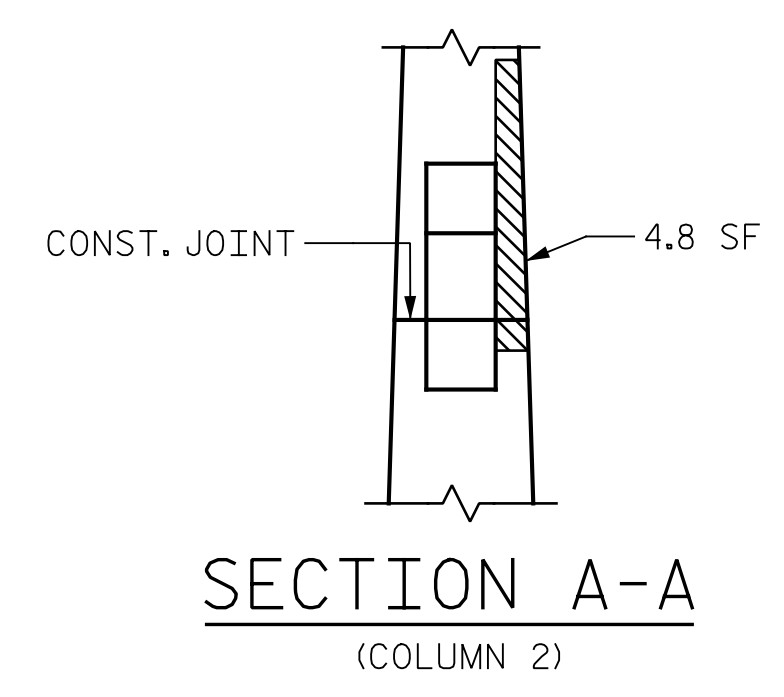

SECTION A-A
(COLUMN 2)

- NOTES:**
 FOR ADDITIONAL NOTES, SEE SHEET 1 OF 2.
- SHOTCRETE REPAIR
 - CONCRETE REPAIR (FORM & POUR)
 - ERI - EPOXY RESIN INJECTION

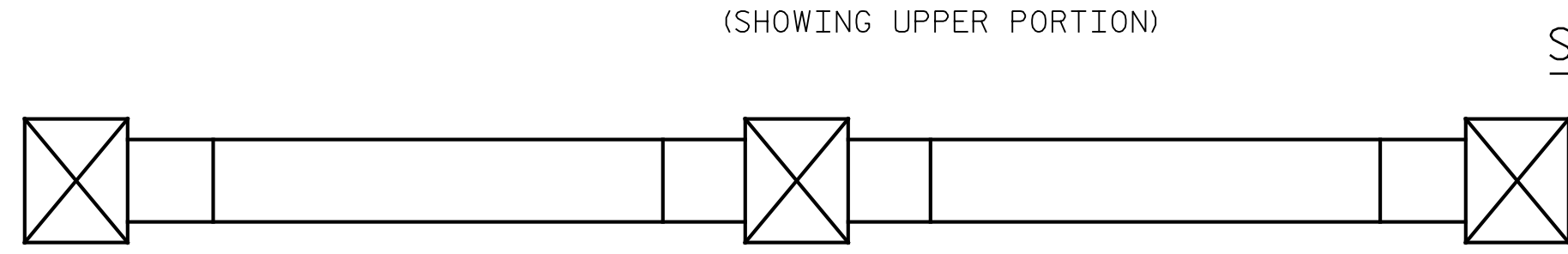

TOP OF STRUT 1

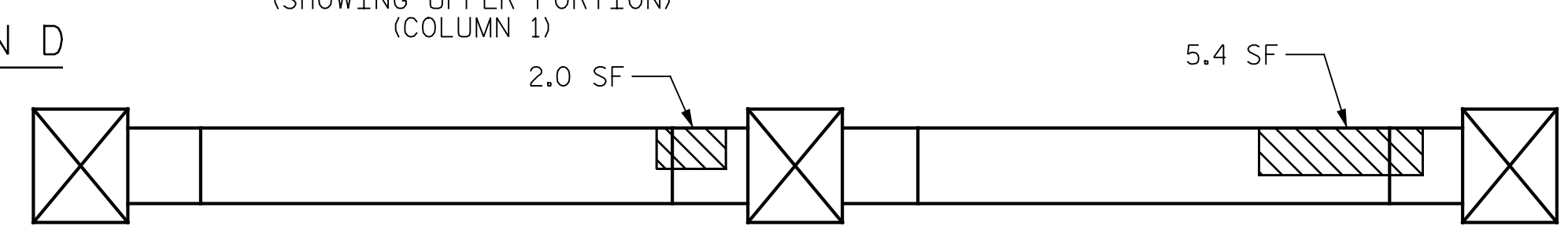

TOP OF STRUT 2

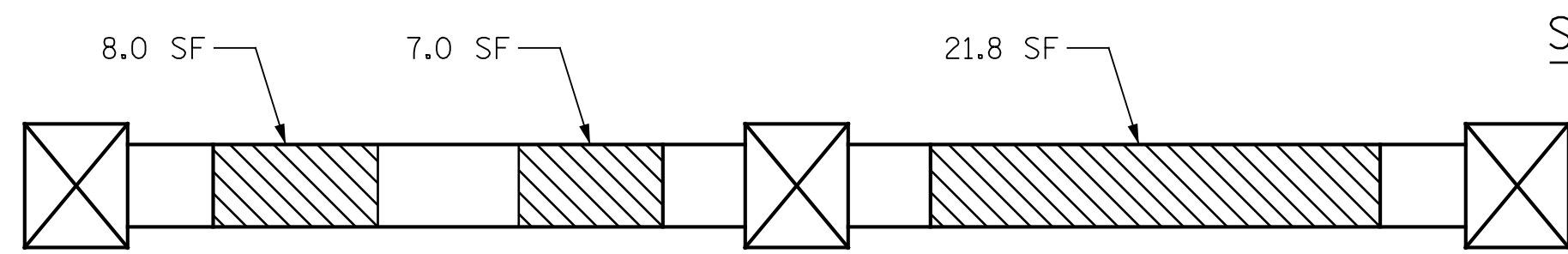

BOTTOM OF STRUT 1

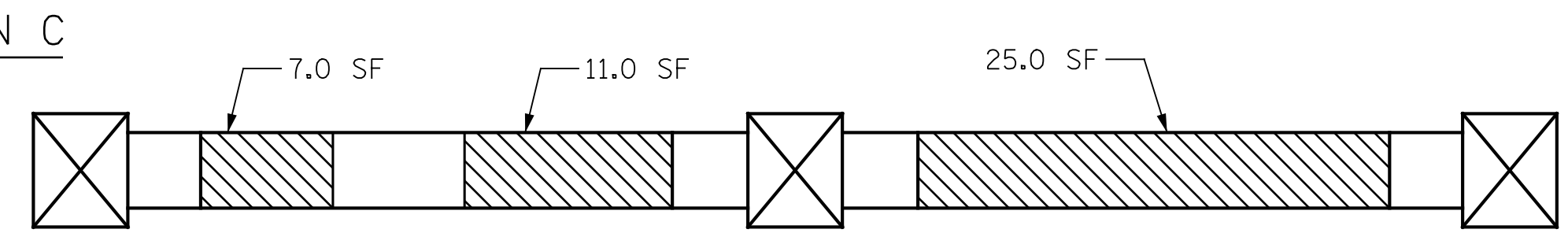

BOTTOM OF STRUT 2

PROJECT NO. I-5889B
BUNCOMBE COUNTY
 BRIDGE NO. 100344

SHEET 2 OF 2

STATE OF NORTH CAROLINA
 DEPARTMENT OF TRANSPORTATION
 RALEIGH

BENT 3
 SPAN D SIDE

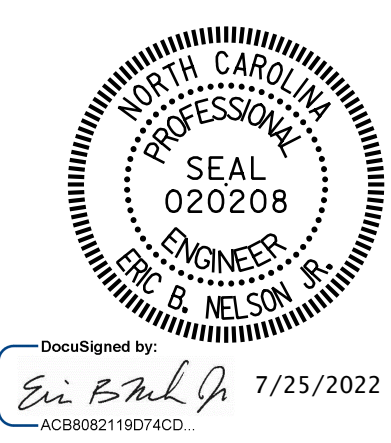

DocuSigned by:
 Eric B. Nelson
 7/25/2022

DRAWN BY: J. MYA DATE: 6/2022
 CHECKED BY: J. YANACCONO DATE: 6/2022



DOCUMENT NOT CONSIDERED
 FINAL UNLESS ALL
 SIGNATURES COMPLETED

REVISIONS						SHEET NO.
NO.	BY:	DATE:	NO.	BY:	DATE:	
1			3			S3-16
2			4			TOTAL SHEETS 129