

p:\gfn\pw-bentley.com\gfn\pw-01\Documents\Projects\67945\5-WorKing\Task 005 - I-5889B Rehab\Structures\CAD\2.0 100% Plans\401_011_I-5889B-SMU_TS01_003_100334.rvt/2/21/2022 3:44:09 PM pdf_color_gfch_FS.plt I-5889B.tbl

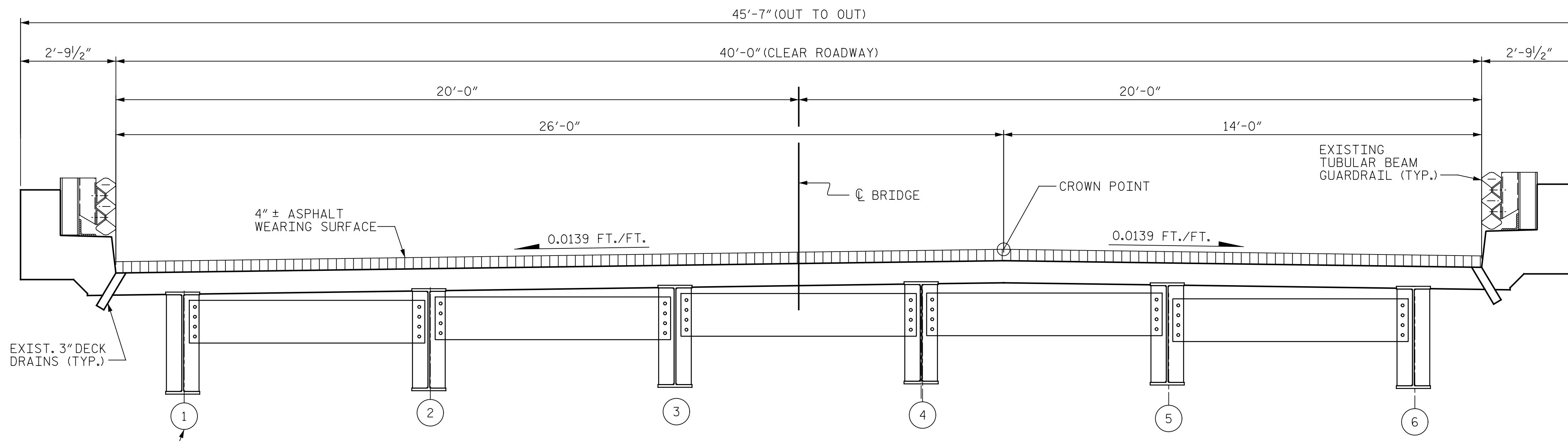

TYPICAL SECTION
(EXISTING)

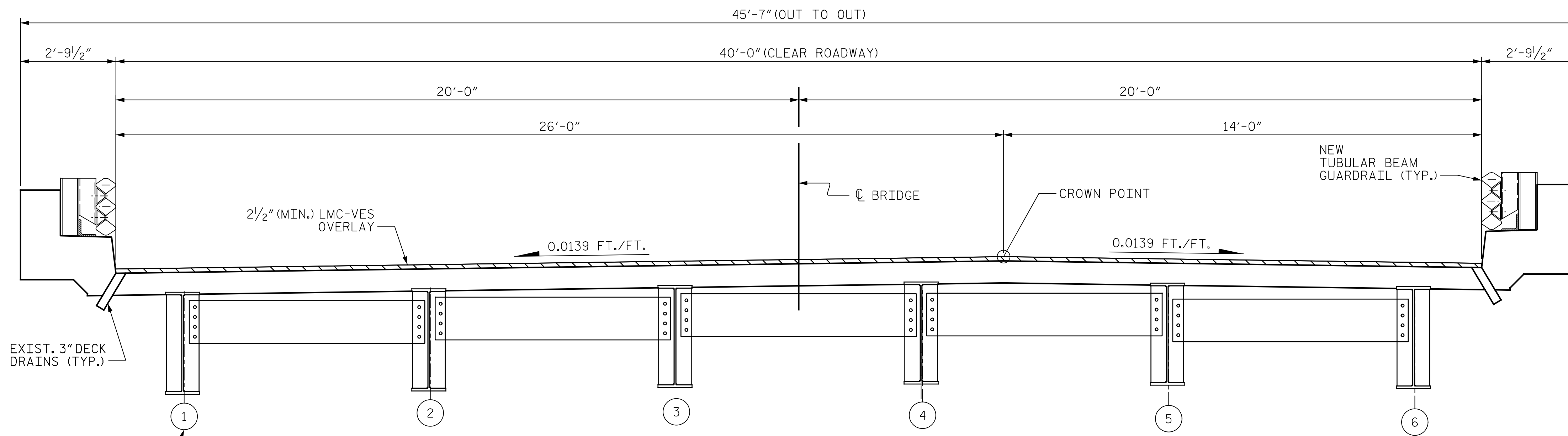

TYPICAL SECTION
(PROPOSED)

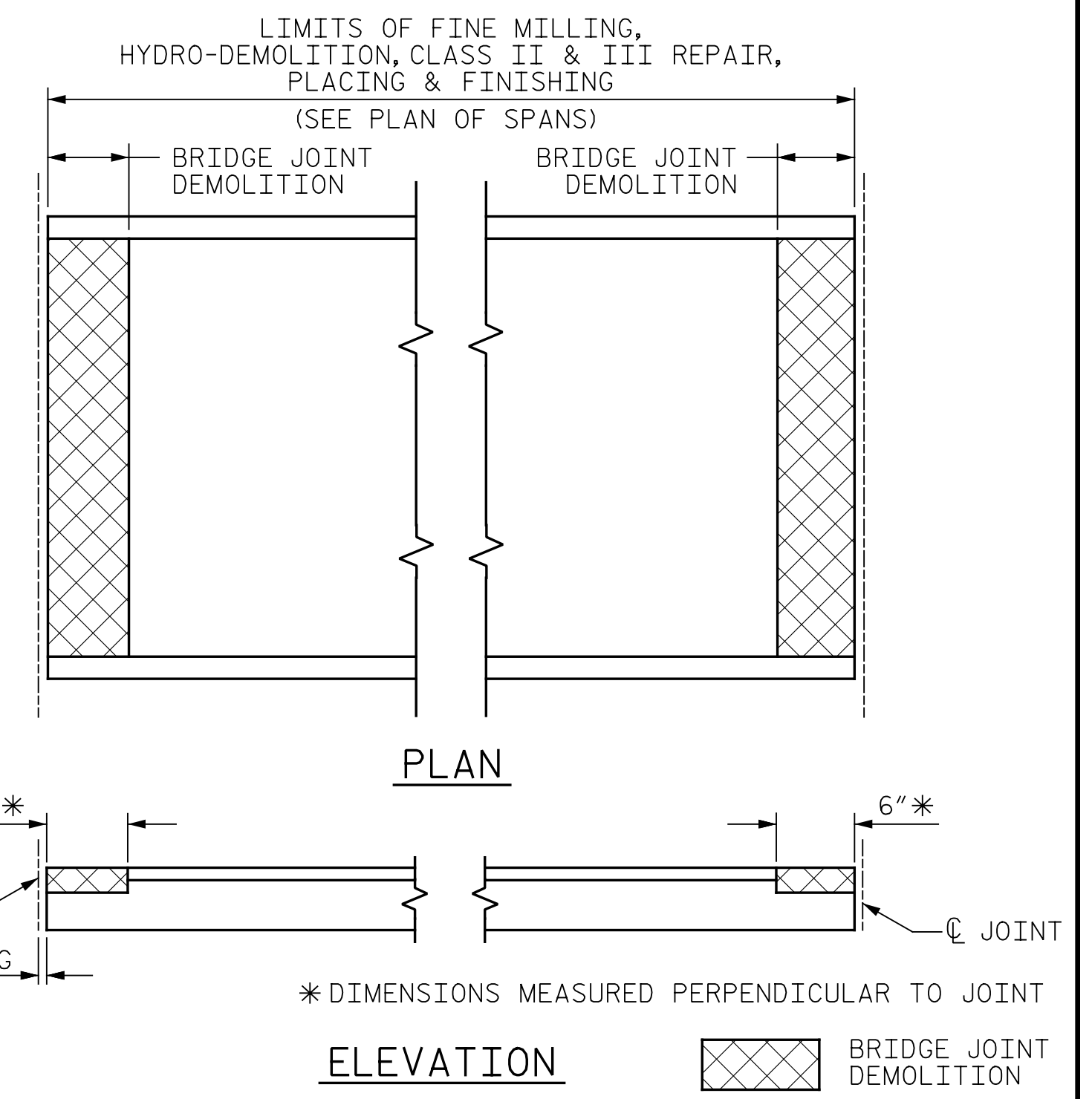

PAY LIMITS FOR OVERLAY BID ITEMS

NOTES:

SEE TRAFFIC MANAGEMENT PLANS FOR LANE WIDTHS, SEQUENCING, AND OTHER TRAFFIC CONTROL MEASURES FOR STAGING OF OVERLAY SURFACE PREPARATION AND LMC PLACEMENT.

WHEN PREPARING THE SURFACE FOR LMC-VES OVERLAY ADJACENT TO A PREVIOUSLY PLACED LMC-VES STAGE, THE PREVIOUSLY PLACED LMC-VES SHALL BE REMOVED FOR A DISTANCE OF 4 INCHES FROM THE LMC-VES EDGE. THE SURFACE OF THE NEW STAGE AREA, ALONG WITH THE 4 INCH OVERLAY AREA, SHALL BE PREPARED AS PER THE OVERLAY SURFACE PREPARATION SPECIAL PROVISIONS. NEW LMC-VES SHALL BE PLACED IN THE 4-INCH OVERLAP, AS PART OF THE NEW LMC-VES STAGE PLACEMENT.

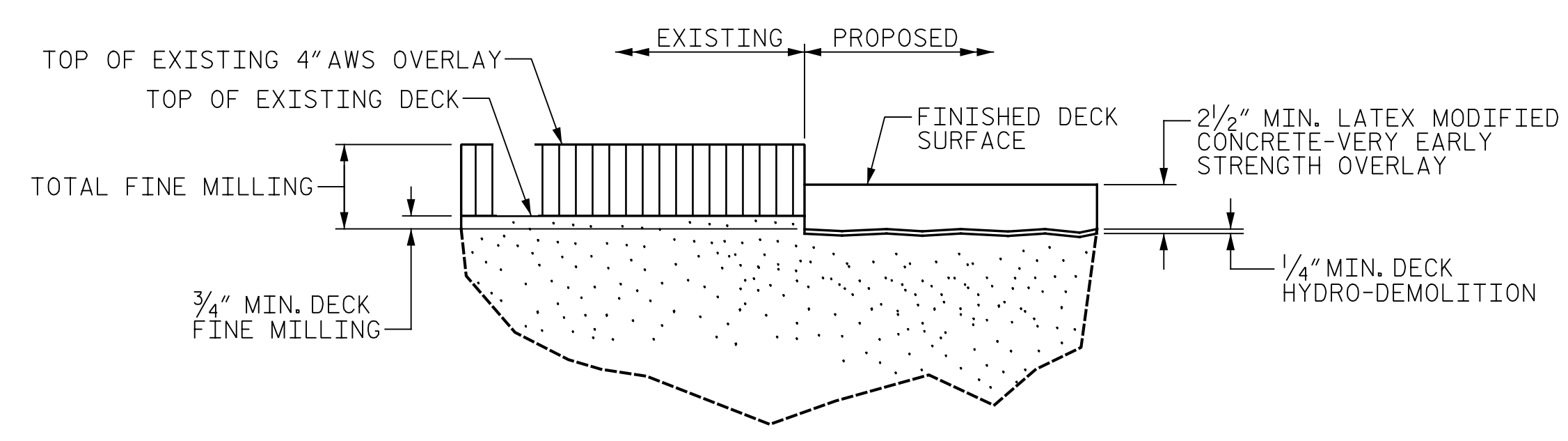

DETAIL FOR LMC-VES OVERLAY

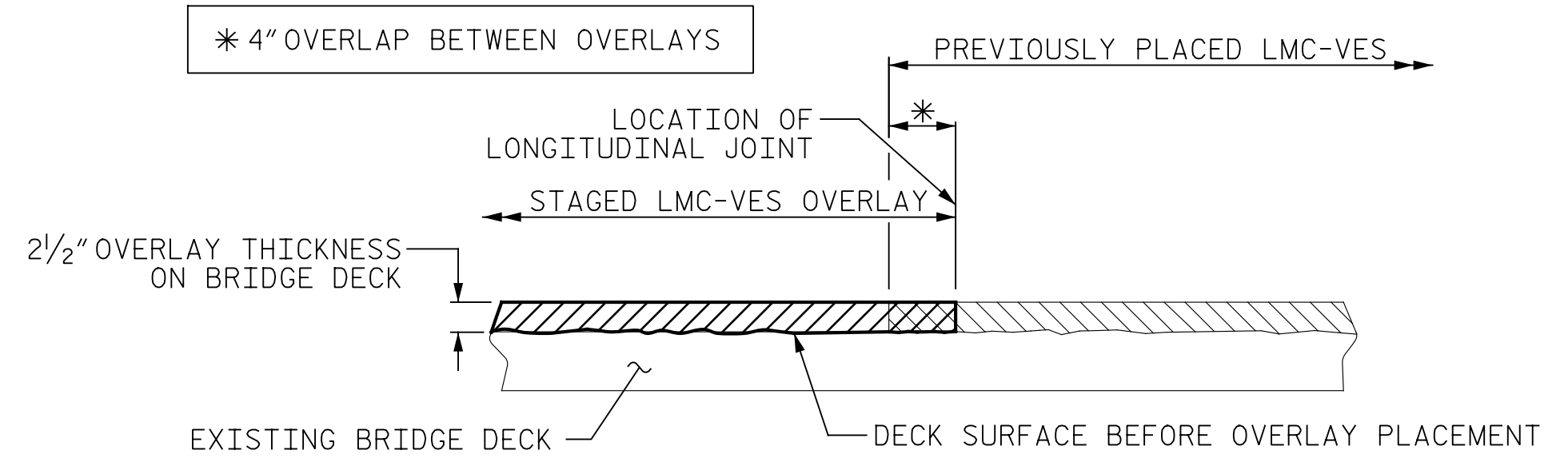

SECTION THRU DECK
STAGED LMC-VES OVERLAY JOINT

PROJECT NO. I-5889B
BUNCOMBE COUNTY
BRIDGE NO. 100334

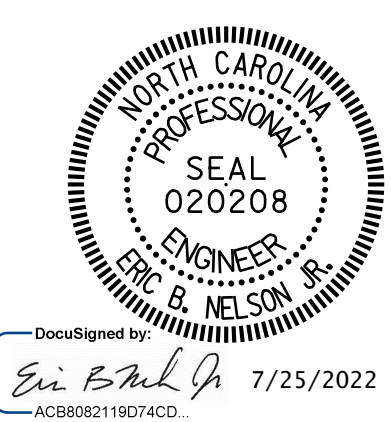

STATE OF NORTH CAROLINA
DEPARTMENT OF TRANSPORTATION
RALEIGH
TYPICAL SECTION AND SURFACE PREPARATION DETAILS

DRAWN BY: J. MYA DATE: 6/2022
CHECKED BY: J. YANACCONE DATE: 6/2022



DOCUMENT NOT CONSIDERED FINAL UNLESS ALL SIGNATURES COMPLETED

REVISIONS						SHEET NO.
NO.	BY:	DATE:	NO.	BY:	DATE:	
1			3			S1-3
2			4			TOTAL SHEETS 133