

**PLAN**

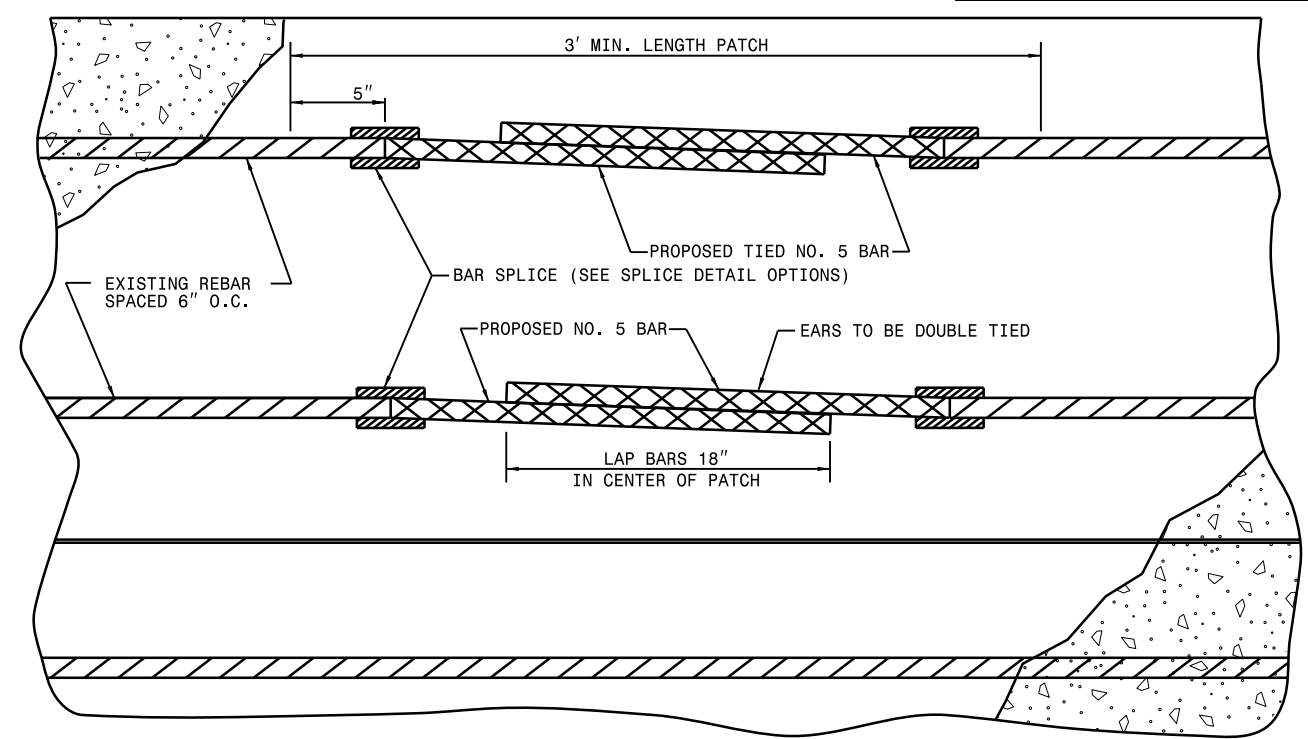

**PLAN**

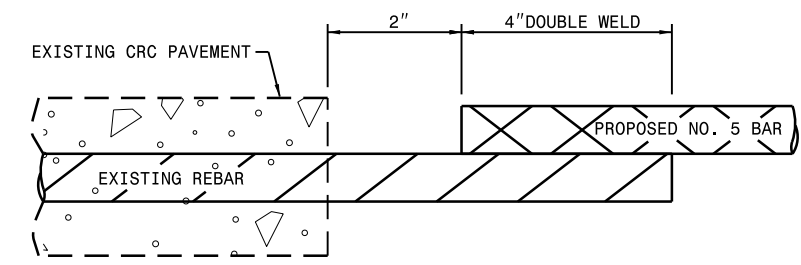

**OPTION 1 - DETAIL OF WELDED SPLICE**

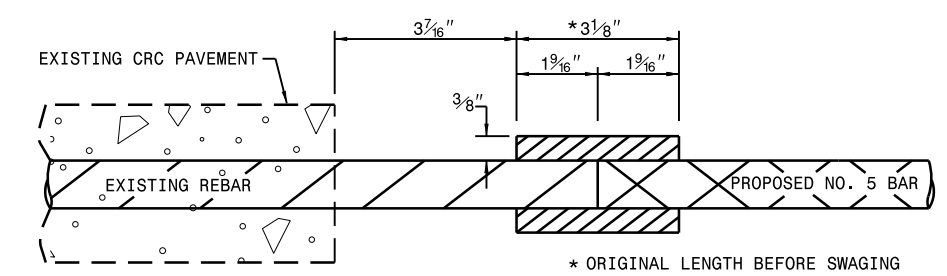

**OPTION 2 - DETAIL OF MECHANICAL SPLICE**

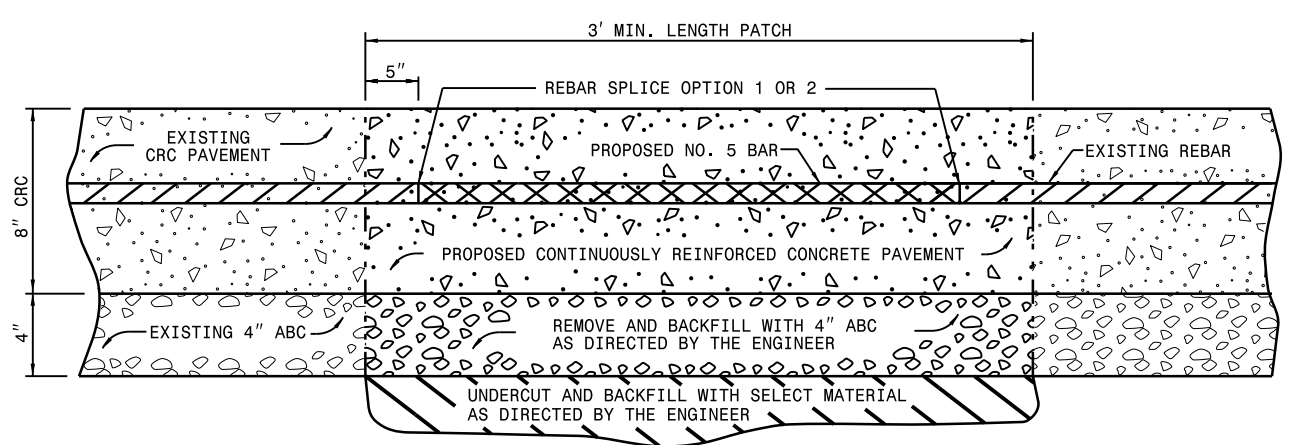

**DETAIL OF CONCRETE PAVEMENT REMOVAL AND REPLACEMENT**

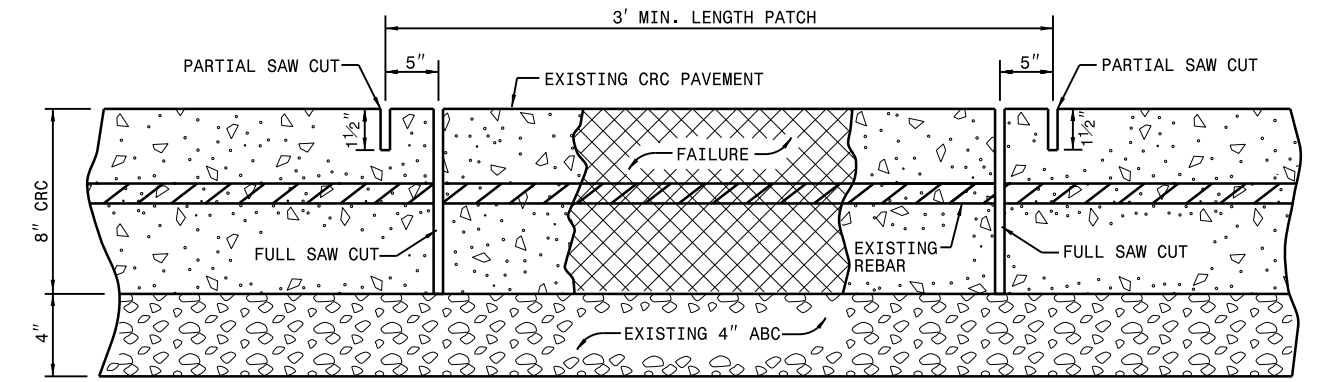

**DETAIL OF SAW CUTS**

PLACE BAR SUPPORTS ON 5' CENTERS FOR PATCHES GREATER THAN 10' IN LENGTH AND AT CENTER OF PATCH FOR REPAIRS LESS THAN 10'. HEIGHT OF SUPPORTS DETERMINED BY THE CONTRACTOR.

<b>CONTRACT STANDARDS AND DEVELOPMENT UNIT</b>	
Office 919-707-6950 FAX 919-250-4119	
<b>DETAIL FOR REPAIR OF CONTINUOUSLY REINFORCED CONCRETE PAVEMENT</b>	
ORIGINAL BY: E.E. WARD	DATE: 4-98
MODIFIED BY: JSH	DATE: 6-13
CHECKED BY:	DATE:
FILE SPEC.: usr/details/stand/crcrepair.dgn	