

MSE ABUTMENT WALL WITH PRECAST PANELS - TYPICAL SECTION

\*SEE ROADWAY PLANS FOR FINISHED GRADE DETAILS.  
 \*\*SEE MSE RETAINING WALLS PROVISION AND MSE WALL NOTES FOR WALL EMBEDMENT REQUIREMENTS.  
 \*\*\*SEE SPECIAL BRIDGE APPROACH FILLS PROVISION AND SHEETS 2G-5 THROUGH 2G-7 OF THE ROADWAY PLANS.

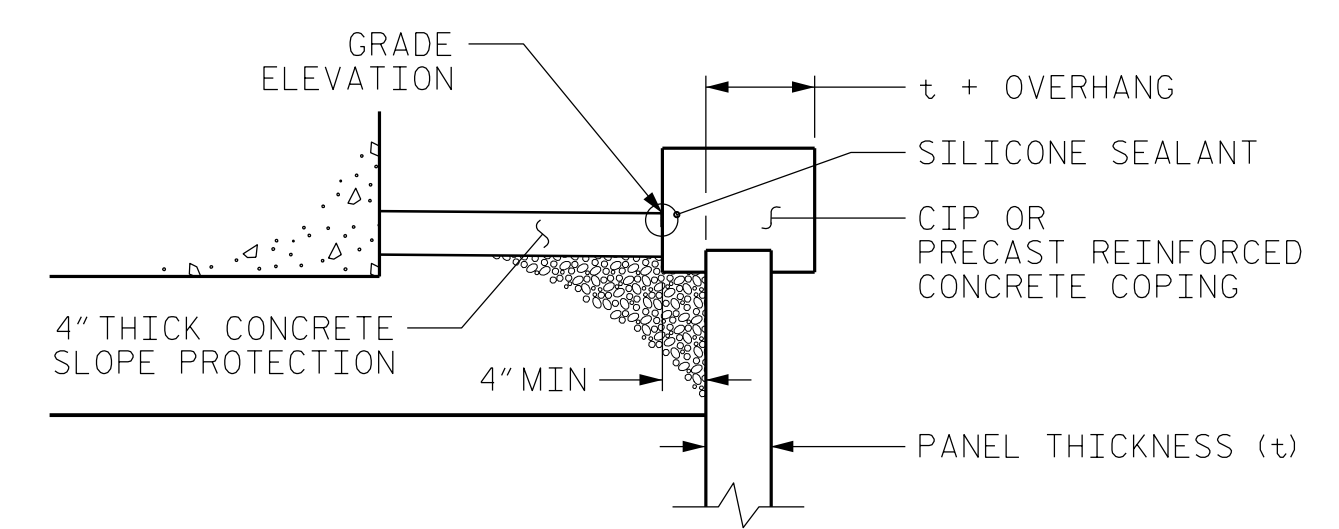
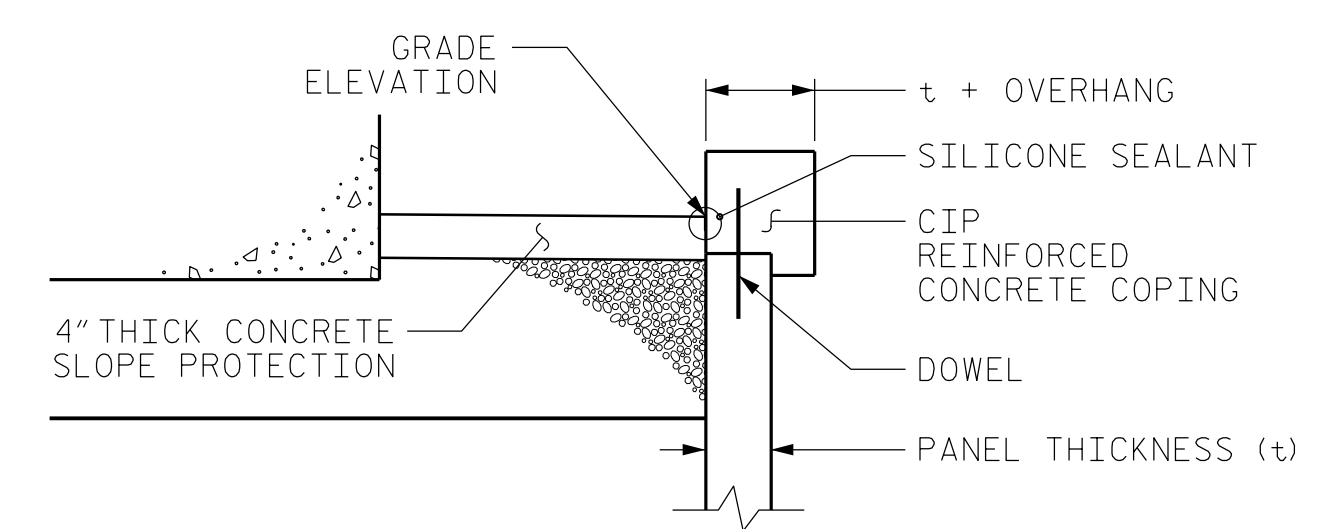

COPING DETAILS

AT THE CONTRACTOR'S OPTION, CONNECT COPING TO PANELS WITH DOWELS OR EXTEND COPING DOWN BACK OF PANELS.

GEOTECHNICAL ENGINEER  
 ENGINEER

DocuSigned by:  
 Matt Alexander 04/19/2022

SEAL 040231  
 NORTH CAROLINA PROFESSIONAL ENGINEERS  
 MATTHEW J. ALEXANDER

DOCUMENT NOT CONSIDERED FINAL UNLESS ALL SIGNATURES COMPLETED

PROJECT NO.: 47533.1.2 (I-5987A)  
 ROBESON COUNTY  
 STATION: VARIES  
 SHEET 7 OF 11 WALL ID NO. W1A, W1B, W2A, W2B, W3A, W3B

PREPARED BY: ALEXANDER, M. J. DATE: 04/2022  
 REVIEWED BY: RIGGS, A. F. DATE: 04/2022

Prepared in the Office of:  
**Terracon**  
 Consulting Engineers and Scientists  
 2401 BRENTWOOD ROAD, SUITE 107  
 RALEIGH, NORTH CAROLINA 27604  
 NC REGISTERED ENGINEERING FIRM: F-0869  
 NC REGISTERED GEOLOGIC FIRM: C-367

NORTH CAROLINA DEPARTMENT OF TRANSPORTATION DIVISION OF HIGHWAYS  
 GEOTECHNICAL ENGINEERING UNIT

MSE ABUTMENT RETAINING WALL TYPICAL SECTION AT ABUTMENT

REVISIONS					
NO.	BY	DATE	NO.	BY	DATE
1			3		
2			4		

SHEET NO. W-7