

INLET ELEVATION
(LOOKING DOWNSTREAM)

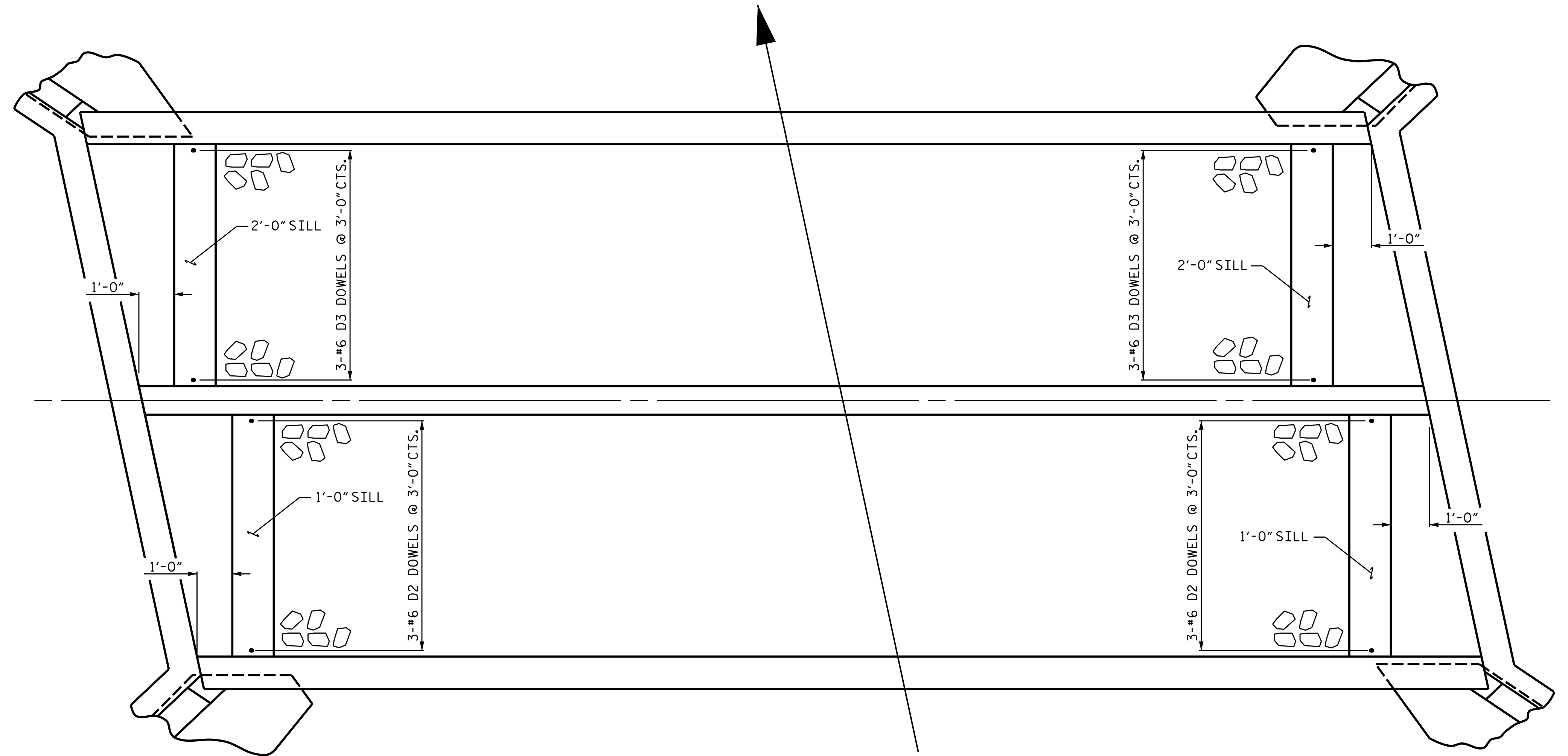

PLAN OF FLOOR SILL LAYOUT

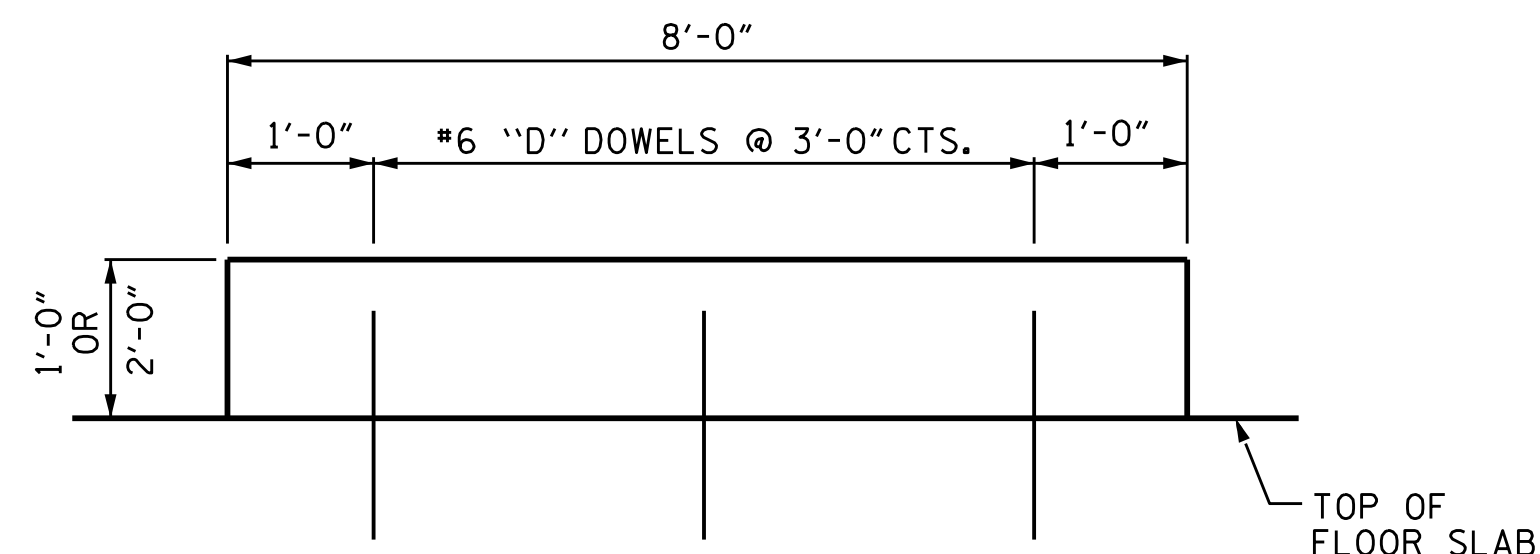

ELEVATION

SILL DETAILS

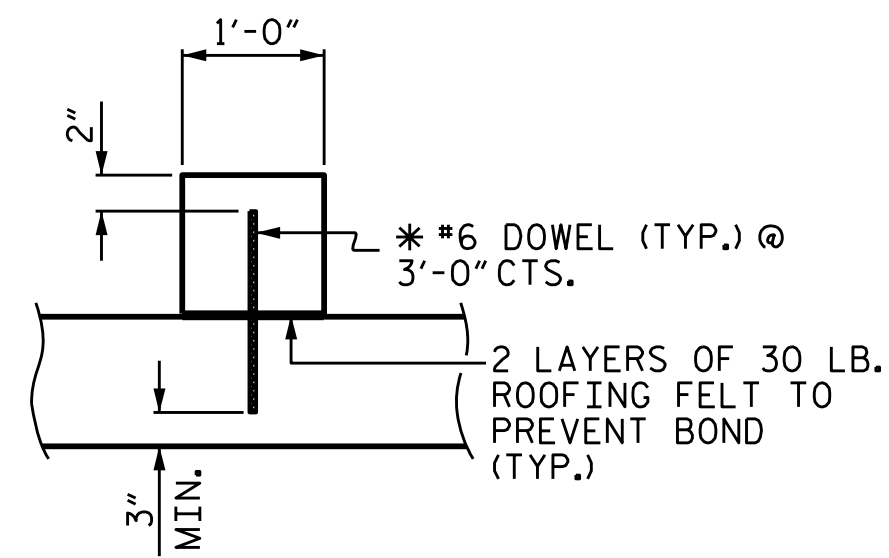

SECTION THROUGH SILL

* DOWELS MAY BE PUSHED INTO GREEN CONCRETE AFTER SLAB HAS BEEN FLOAT FINISHED.

NOTES

MATERIAL EXCAVATED FROM THE EXISTING BED SHALL BE STOCKPILED FOR USE IN THE PROPOSED CULVERT. BED MATERIAL IN THE HIGH FLOW BARREL MAY BE SUPPLEMENTED WITH CLASS B RIP RAP AS NECESSARY. NATIVE MATERIAL SHOULD BE PLACED ON TOP TO PROVIDE A FLAT SURFACE FOR ANIMAL PASSAGE. BED MATERIAL IS SUBJECT TO THE APPROVAL BY THE ENGINEER AND MAY BE SUBJECT TO PERMIT CONDITIONS.

THE ENTIRE COST OF WORK REQUIRED TO PLACE EXCAVATED MATERIAL OR SUPPLEMENTAL MATERIAL AS SHOWN ON THE PLANS SHALL BE INCLUDED IN THE CONTRACT LUMP SUM PRICE BID FOR CULVERT EXCAVATION.

THE ENTIRE COST OF WORK REQUIRED TO CONSTRUCT THE SILLS SHALL BE INCLUDED IN THE VARIOUS PAY ITEMS.

PROJECT NO. I-5987A
ROBESON COUNTY
 STATION: 24+79.00 -Y3-

SHEET 9 OF 10

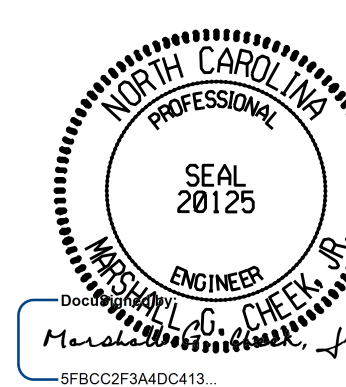

5/10/2022 | 10:06 AM EDT

STATE OF NORTH CAROLINA
 DEPARTMENT OF TRANSPORTATION
 RALEIGH

**DOUBLE 8 FT. X 7 FT.
 CONCRETE BOX CULVERT
 95°-00'-00" SKEW**

DOCUMENT NOT CONSIDERED FINAL
 UNLESS ALL SIGNATURES COMPLETED

TGS ENGINEERS
 706 HILLSBOROUGH STREET
 SUITE 200
 RALEIGH, NC 27603
 PH (919) 773-8887
 CORP. LICENSE NO.: C-0275

REVISIONS						SHEET NO.
NO.	BY:	DATE:	NO.	BY:	DATE:	C14-9
1			3			TOTAL SHEETS
2			4			10

DRAWN BY : STM DATE : 12/21
 CHECKED BY : MGC DATE : 12/21
 DESIGN ENGINEER OF RECORD: STM DATE : 10/21