

CONCRETE DECK POUR DETAIL

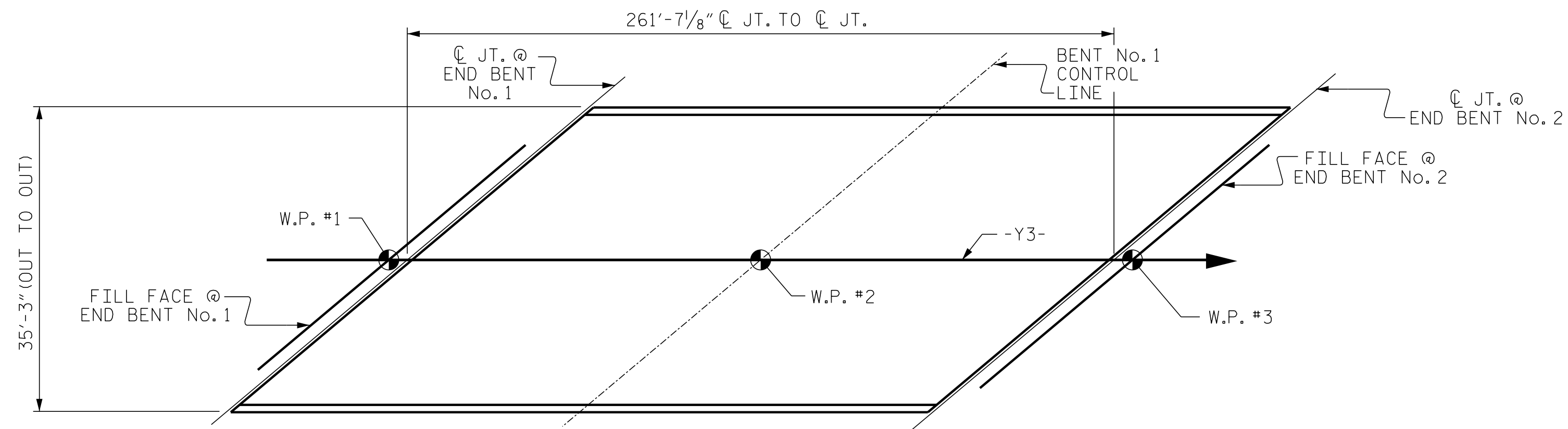

LAYOUT FOR COMPUTING AREA REINFORCED CONCRETE DECK SLAB (SQ. FT. = 9,221)

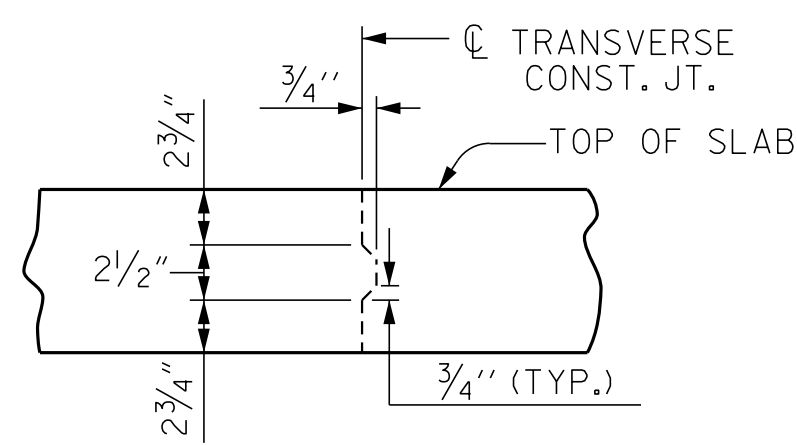

TRANSVERSE CONST. JOINT DETAIL

NOTE: SLAB REINFORCING STEEL SHALL BE CONTINUOUS THRU JOINT

SUPERSTRUCTURE REINFORCING STEEL LENGTHS ARE BASED ON THE FOLLOWING MINIMUM SPLICE LENGTHS

BAR SIZE	SUPERSTRUCTURE EXCEPT APPROACH SLABS, PARAPET, AND BARRIER RAIL		APPROACH SLABS		PARAPET AND BARRIER RAIL
	EPOXY COATED	UNCOATED	EPOXY COATED	UNCOATED	
#4	1'-11"	1'-7"	1'-11"	1'-7"	2'-6"
#5	2'-5"	2'-0"	2'-5"	2'-0"	3'-1"
#6	2'-10"	2'-5"	3'-7"	2'-5"	3'-8"
#7	4'-2"	2'-9"			
#8	4'-9"	3'-2"			

BAR TYPES

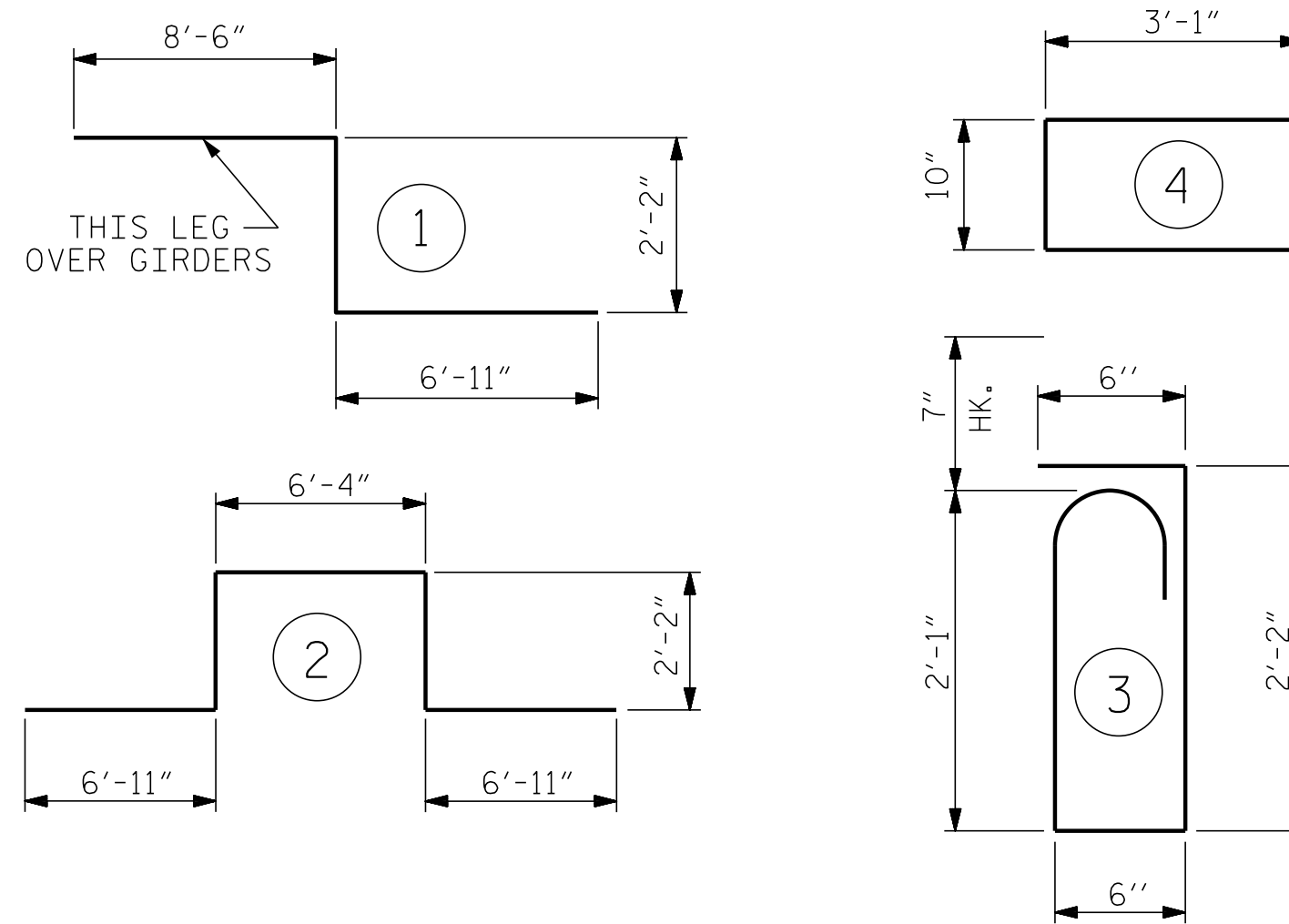

ALL BAR DIMENSIONS ARE OUT TO OUT

SUPERSTRUCTURE BILL OF MATERIAL

	CLASS AA CONCRETE (CU. YDS.)	REINFORCING STEEL (LBS.)	* EPOXY COATED REINFORCING STEEL (LBS.)
TOTALS**	286.7	29,309	28,098

\*\*QUANTITIES FOR BARRIER RAIL ARE NOT INCLUDED

CONCRETE BREAKDOWN

	CLASS AA CONCRETE (CU. YDS.)
POUR #1	258.5
POUR #2	28.2
TOTALS ***	286.7

\*\*\* QUANTITIES FOR BARRIER RAILS ARE NOT INCLUDED

GROOVING BRIDGE FLOORS

APPROACH SLABS	752 SQ.FT.
BRIDGE DECK	7,524 SQ.FT.
TOTAL	8,276 SQ.FT.

BILL OF MATERIAL

BAR	NO.	SIZE	TYPE	LENGTH	WEIGHT
* A1	439	#5	STR	34'-11"	15,988
A2	439	#5	STR	34'-11"	15,988
* A101	8	#5	STR	33'-4"	278
* A102	8	#5	STR	31'-8"	264
* A103	8	#5	STR	30'-0"	250
* A104	8	#5	STR	28'-4"	236
* A105	8	#5	STR	26'-8"	223
* A106	8	#5	STR	25'-0"	209
* A107	8	#5	STR	23'-3"	194
* A108	8	#5	STR	21'-7"	180
* A109	8	#5	STR	19'-7"	166
* A110	8	#5	STR	18'-3"	152
* A111	8	#5	STR	16'-7"	138
* A112	8	#5	STR	14'-11"	124
* A113	8	#5	STR	13'-2"	110
* A114	8	#5	STR	11'-6"	96
* A115	8	#5	STR	9'-10"	82
* A116	8	#5	STR	8'-2"	68
* A117	8	#5	STR	6'-6"	54
* A118	8	#5	STR	4'-9"	40
* A119	8	#5	STR	3'-1"	26

A201	8	#5	STR	33'-4"	278
A202	8	#5	STR	31'-8"	264
A203	8	#5	STR	30'-0"	250
A204	8	#5	STR	28'-4"	236
A205	8	#5	STR	26'-8"	223
A206	8	#5	STR	25'-0"	209
A207	8	#5	STR	23'-3"	194
A208	8	#5	STR	21'-7"	180
A209	8	#5	STR	19'-11"	166
A210	8	#5	STR	18'-3"	152
A211	8	#5	STR	16'-7"	138
A212	8	#5	STR	14'-11"	124
A213	8	#5	STR	13'-2"	110
A214	8	#5	STR	11'-6"	96
A215	8	#5	STR	9'-10"	82
A216	8	#5	STR	8'-2"	68
A217	8	#5	STR	6'-6"	54
A218	8	#5	STR	4'-9"	40
A219	8	#5	STR	3'-1"	26

* B1	144	#4	STR	31'-2"	2,998
* B2	48	#5	STR	44'-3"	2,215
* B3	46	#5	STR	48'-0"	2,303
B4	180	#5	STR	53'-10"	10,107

* G1	2	#5	STR	54'-3"	113
------	---	----	-----	--------	-----

* K1	8	#8	1	17'-7"	376
* K2	12	#8	2	24'-6"	785
K3	24	#6	STR	4'-9"	171
* K4	6	#6	STR	17'-0"	153

* S1	40	#5	3	5'-10"	243
* S2	40	#4	4	7'-0"	187

REINFORCING STEEL LBS. 29,309

\* EPOXY COATED REINFORCING STEEL LBS. 28,098

\* THESE BARS ARE EPOXY COATED.

PROJECT NO. I-5987A  
ROBESON COUNTY  
STATION: 30+04.11 -Y3-

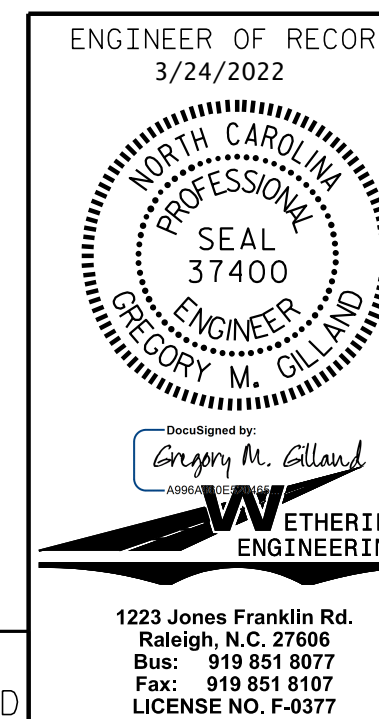

STATE OF NORTH CAROLINA  
DEPARTMENT OF TRANSPORTATION  
RALEIGH

SUPERSTRUCTURE BILL OF MATERIAL

REVISIONS

NO.	BY:	DATE:	NO.	BY:	DATE:
1			3		
2			4		

SHEET NO.

S3-18

TOTAL SHEETS

29

DOCUMENT NOT CONSIDERED FINAL UNLESS ALL SIGNATURES COMPLETED

DRAWN BY: J. PENDERGRAFT/DAH DATE: 11/21  
CHECKED BY: J. DILWORTH DATE: 11/21