

POURING SEQUENCE

POUR ② SHALL NOT BE STARTED UNTIL BOTH ADJACENT ① POURS REACH A MINIMUM OF 3,000 PSI.

③ INDICATES POUR NUMBER AND DIRECTION OF POUR

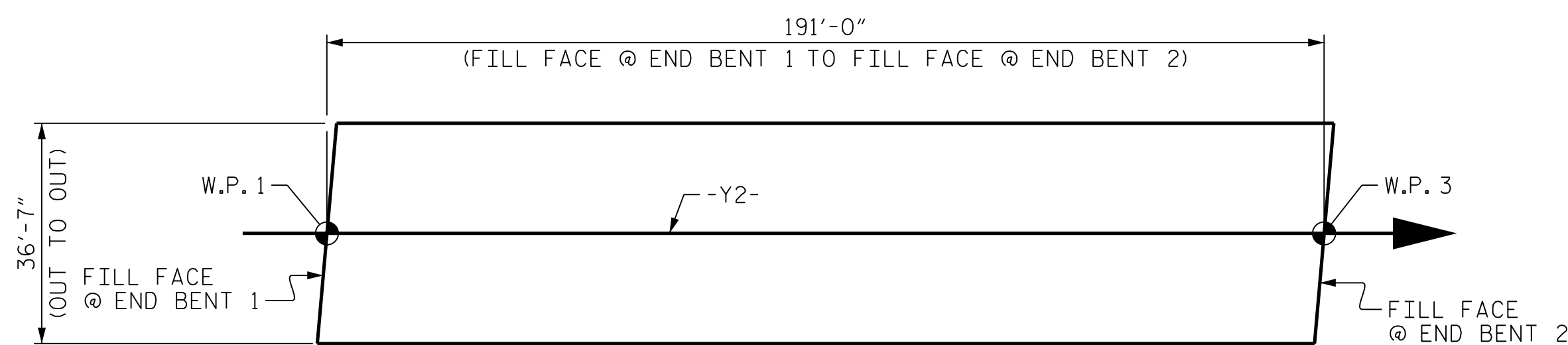

LAYOUT FOR COMPUTING AREA REINFORCED CONCRETE DECK SLAB (SQ. FT. = 6,988)

REINFORCING BAR SCHEDULE

BAR	NO.	SIZE	TYPE	LENGTH	WEIGHT
*A1	372	#5	STR	36'-3"	14,065
A2	372	#5	STR	36'-3"	14,065
*A101	2	#5	STR	32'-0"	67
*A102	2	#5	STR	26'-3"	55
*A103	2	#5	STR	20'-7"	43
*A104	2	#5	STR	14'-10"	31
*A105	2	#5	STR	9'-2"	19
*A106	2	#5	STR	3'-5"	7
A201	2	#5	STR	32'-0"	67
A202	2	#5	STR	26'-3"	55
A203	2	#5	STR	20'-7"	43
A204	2	#5	STR	14'-10"	31
A205	2	#5	STR	9'-2"	19
A206	2	#5	STR	3'-5"	7
B1	230	#5	STR	39'-5"	9,456
*B2	140	#4	STR	39'-4"	3,678
*B3	54	#4	STR	21'-10"	788
*B4	108	#5	STR	18'-10"	2,121
B5	49	#5	STR	48'-6"	2,479
*B6	54	#4	STR	39'-0"	1,407
*B7	81	#4	STR	23'-10"	1,290
K1	10	#4	STR	36'-4"	243
K2	6	#4	STR	7'-3"	29
K3	6	#4	STR	8'-1"	32
K4	12	#4	STR	8'-9"	70
K5	6	#4	STR	7'-9"	31
K6	4	#4	STR	2'-3"	6
K7	4	#4	STR	2'-7"	7
K8	8	#4	STR	3'-0"	16
K9	4	#4	STR	2'-6"	7
*S1	56	#4	1	10'-5"	390
*S2	60	#4	1	11'-10"	474
U1	60	#4	2	11'-4"	454

*EPOXY COATED REINFORCING STEEL

BAR TYPES

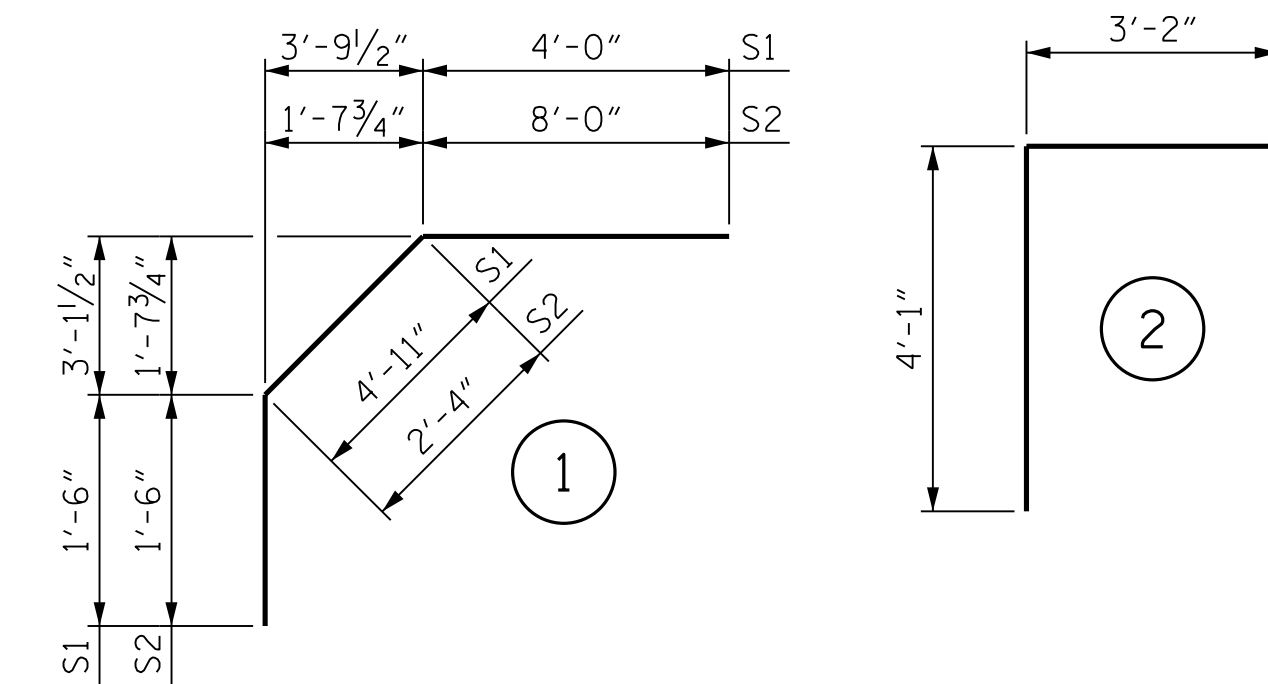

ALL BAR DIMENSIONS ARE OUT TO OUT.

—SUPERSTRUCTURE BILL OF MATERIAL—

	CLASS AA CONCRETE (CU. YDS.)	REINFORCING STEEL (LBS.)	EPOXY COATED REINFORCING STEEL (LBS.)
POUR #1	189.8	-	-
POUR #2	21.4	-	-
POUR #3	54.8	-	-
TOTALS**	266.0	27,117	24,435

*QUANTITIES FOR CONCRETE PARAPET ARE NOT INCLUDED.

GROOVING BRIDGE FLOORS

APPROACH SLABS	889 SQ.FT.
BRIDGE DECK	5,870 SQ.FT.
TOTAL	6,759 SQ.FT.

SUPERSTRUCTURE REINFORCING STEEL LENGTHS ARE BASED ON THE FOLLOWING MINIMUM SPLICE LENGTHS

BAR SIZE	SUPERSTRUCTURE EXCEPT APPROACH SLABS, PARAPETS, AND BARRIER RAILS		APPROACH SLABS		PARAPETS AND BARRIER RAILS
	EPOXY COATED	UNCOATED	EPOXY COATED	UNCOATED	
#4	1'-11"	1'-7"	1'-11"	1'-7"	2'-6"
#5	2'-5"	2'-0"	2'-5"	2'-0"	3'-1"
#6	2'-10"	2'-5"	3'-7"	2'-5"	3'-8"
#7	4'-2"	2'-9"			
#8	4'-9"	3'-2"			

PROJECT NO. I-5987A
ROBESON COUNTY
 STATION: 29+75.79 -Y2-

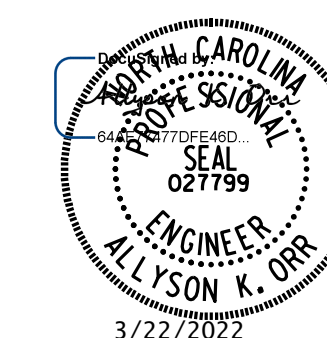

DOCUMENT NOT CONSIDERED FINAL UNLESS ALL SIGNATURES COMPLETED

MI ENGINEERING
 1011 SCHAUB DRIVE, SUITE 100
 RALEIGH, NC 27606
 (919) 851-6606
 FIRM PE NUMBER: P-0671

STATE OF NORTH CAROLINA
 DEPARTMENT OF TRANSPORTATION
 RALEIGH
 STANDARD
 SUPERSTRUCTURE
 BILL OF MATERIAL

REVISIONS						SHEET NO.
NO.	BY:	DATE:	NO.	BY:	DATE:	
1			3			S1-24
2			4			TOTAL SHEETS 36

STD. NO. BOM2

3/22/2022 1:15:33 PM User: blanning
 Filename: N:\NC Bridges\20003 I-5987A\B I-5987A\Structures\401_047_I5987A_SMU_BOM1.T70151.dgn

ASSEMBLED BY: B.E. LANNING	DATE: 02/2021
CHECKED BY: A.K. ORR	DATE: 03/2021
DESIGN ENGINEER OF RECORD: A.K. ORR	DATE: 12/2021
DRAWN BY: EEM 3/95	REV. 5/7/03R RWW/JTE
CHECKED BY: VAP 3/95	REV. 5/1/06RR KMM/GM
	REV. 10/1/11 MAA/GM