

CCTV-4 GPS COORDINATES
 34.76381° N
 78.99704° W

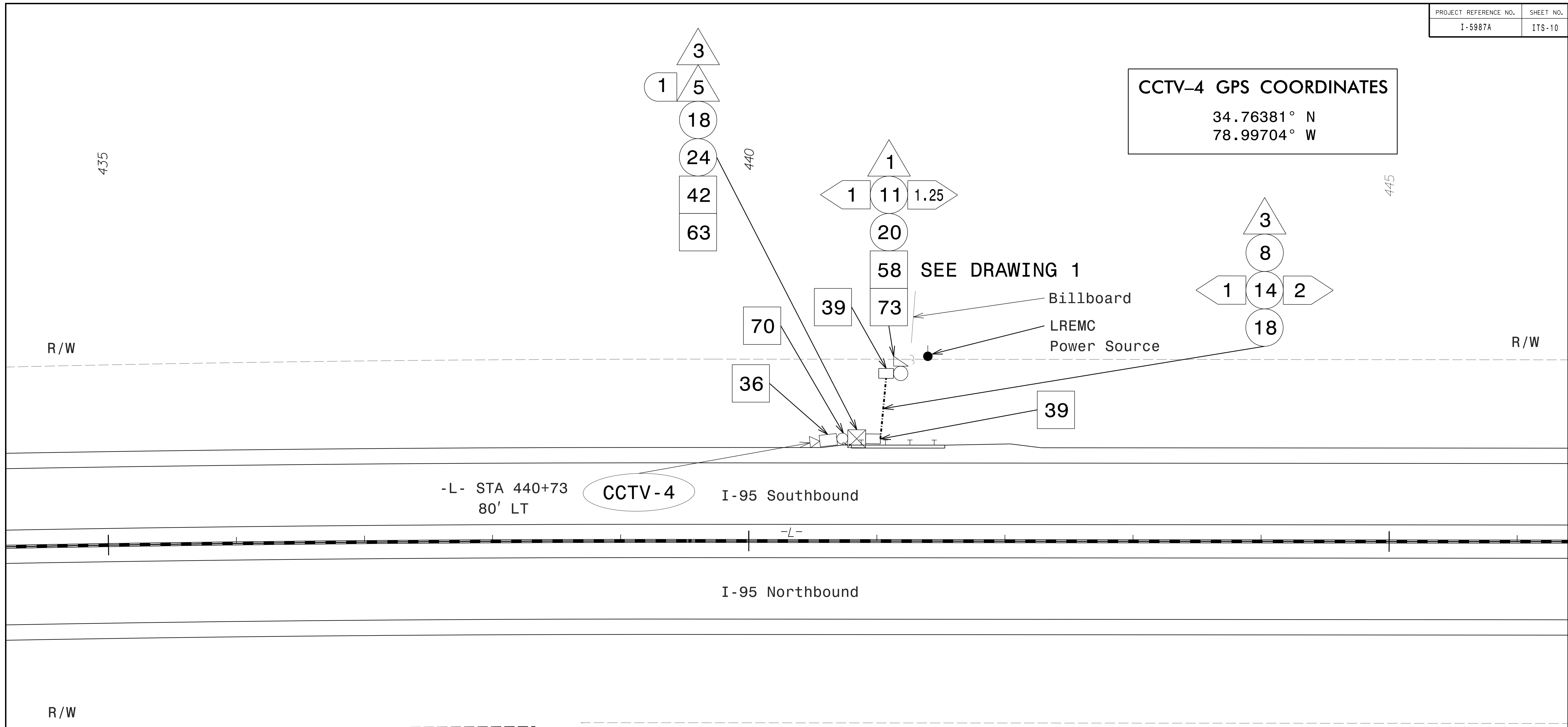

-L- STA 440+73
 80' LT
CCTV-4
 I-95 Southbound

I-95 Northbound

DRAWING #1

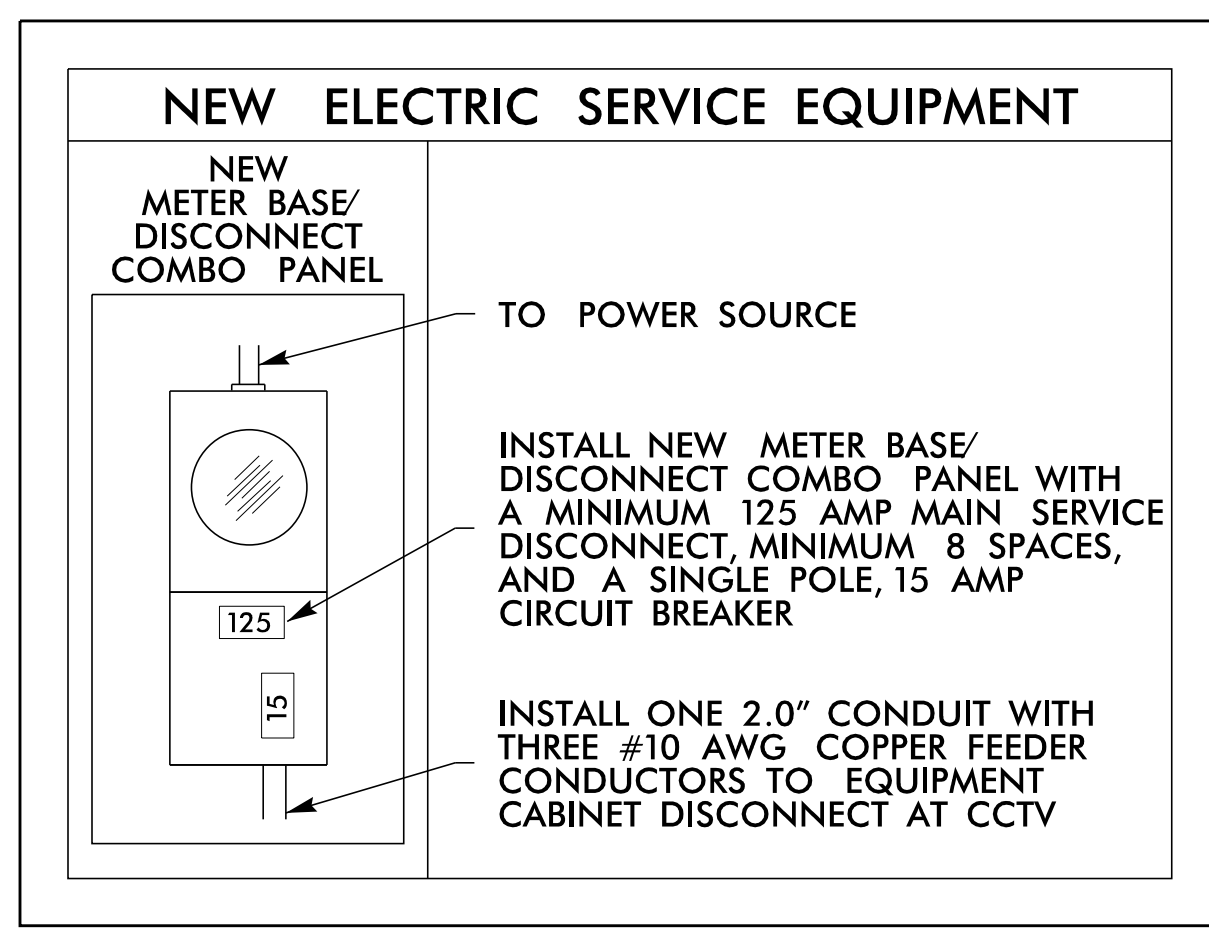

- NOTES:**
- POWER COMPANY CONTACT - LUMBEE RIVER EMC - KEN ROWELL (910) 843-7953
 - REFER TO SHEETS 38-5 THROUGH 38-7 FOR GUARDRAIL INFORMATION.
 - MAINTAIN A MINIMUM OF 6 FEET FROM THE EDGE OF PAVEMENT WHEN TRENCHING PARALLEL TO THE ROADWAY.
 - CONTACT DIVISION 6 TRAFFIC ENGINEER FRANK D. WEST, JR. AT (910) 364-0606 TO CONFIRM THE LOCATION OF THE CCTV/DMS.
 - DO NOT INSTALL CONDUIT OR JUNCTION BOXES UNTIL THE PROPOSED LOCATION OF THE CCTV CAMERA OR DMS HAVE BEEN CONFIRMED BY THE DIVISION TRAFFIC ENGINEER.
 - MOUNT THE CCTV CAMERA 45 FEET ABOVE GRADE.
 - MOUNT THE CCTV CAMERA 5 FEET BELOW THE TOP OF THE POLE.
 - INSTALL CCTV POLE A MINIMUM OF 8 FEET BEHIND GUARDRAIL.

DOCUMENT NOT CONSIDERED FINAL UNLESS ALL SIGNATURES COMPLETED

	I-95 CCTV-4 (Mile-Marker 28)		SEAL
	Division 6 Robeson County Lumberton	PLAN DATE: April 2022 REVIEWED BY: S.G. Haynie	
750 N. Greenfield Pkwy, Garner, NC 27529 RS&H NC FIRM LICENSE No: F-0493 8521 SIX FORKS ROAD, SUITE 400 RALEIGH, NC 27615 (919) 926-4100		SCALE 0 40 1" = 40'	REVISIONS INIT. DATE

1/24/2022 6:41:15 AM Plan_Sheets\I-5987A\ITS_psh_10_LMB08.dgn 3:38:09 PM