

-Y3-
 PI Sta 19+98.48
 $\Delta = 6' 29'' 08.7''$ (LT)
 $D = 1' 41'' 24.5''$
 $L = 383.74'$
 $T = 192.08'$
 $R = 3,390.00'$
 $DS = 60$ mph
 $e = 04$
 $RO = 100'$

FINAL EROSION CONTROL FOR CONSTRUCTION SHEET 38

MARGARET R. RUSS
 DB 1590 PG 860
 DB 2004 PG 434

145

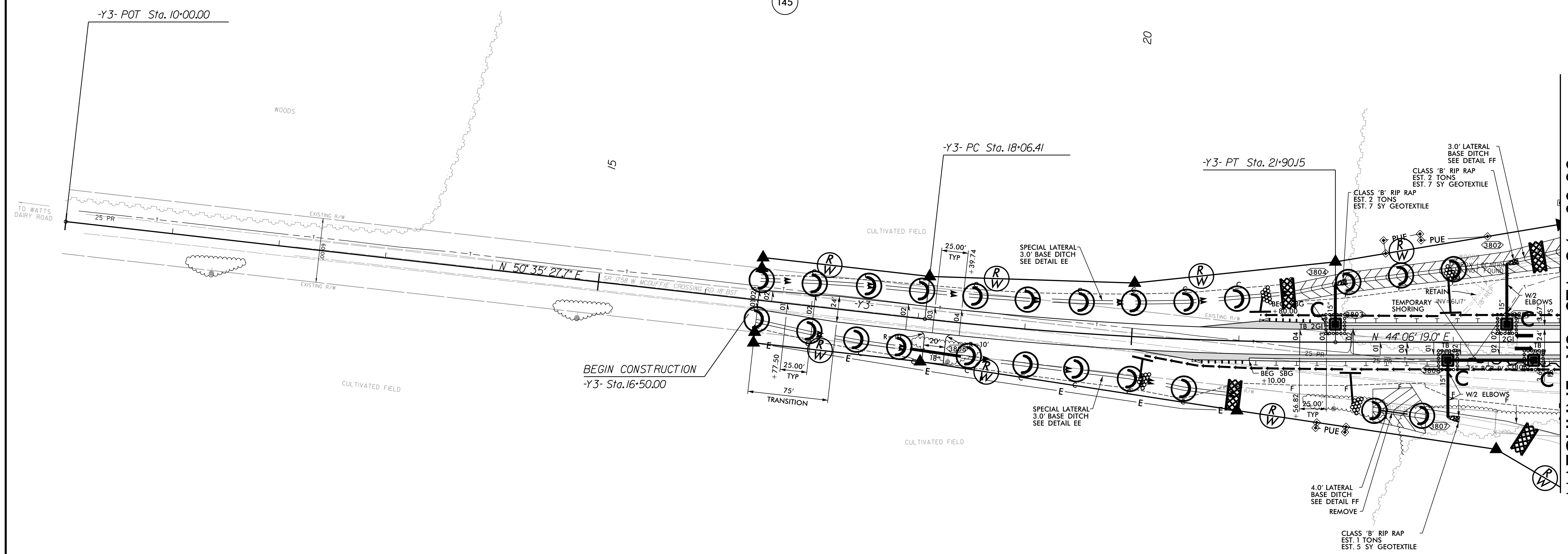

JOSEPH G. RIDDLE
 AND WIFE
 GAIL A. RIDDLE
 DB 1590 PG 865

120

MATCHLINE -Y3- STA 24+00.00 SEE SHEET 30

- NOTE: ALL EROSION CONTROL DEVICES SHOWN ARE LOCATED WITHIN EXISTING RW OR EASEMENT.
- NOTE: CONTRACTOR SHALL PROVIDE GROUND COVER ON EXPOSED SLOPES IN ACCORDANCE WITH THE "SOIL STABILIZATION TIMEFRAMES," SEE EC-3.
- NOTE: CONTRACTOR SHALL PROVIDE INLET PROTECTION FOR PARTIALLY INSTALLED STORM DRAINS. THIS MEASURE SHOULD BE INSTALLED AT THE END OF EACH WORKING DAY.
- NOTE: CONTRACTOR SHALL MAINTAIN ALL DEVICES AS PROJECT IS BROUGHT UP TO GRADE.
- NOTE: INSTALL MATTING FOR EROSION CONTROL IN ALL PROPOSED DITCH LINES EXCEPT WHERE PERMANENT LINERS ARE SPECIFIED ON THE PLANS OR DIRECTED OTHERWISE BY THE ENGINEER.
- NOTE: UTILIZE FABRIC INSERT INLET PROTECTION DEVICES IN LIEU OF ROCK INLET SEDIMENT TRAPS, TYPE C, AS DIRECTED TO AVOID IMPEDIMENT OF RUNOFF IN ROADWAY OPEN TO TRAFFIC.

PROPOSED PAVEMENT REMOVAL FOR -Y3- PROFILE SEE SHEET 89

REVISIONS

4/7/2022 R:\Environmental\Design\15987A_EC_PSH_074.dgn samuel.skalata