

8/17/99

NAD 83/NA 2011

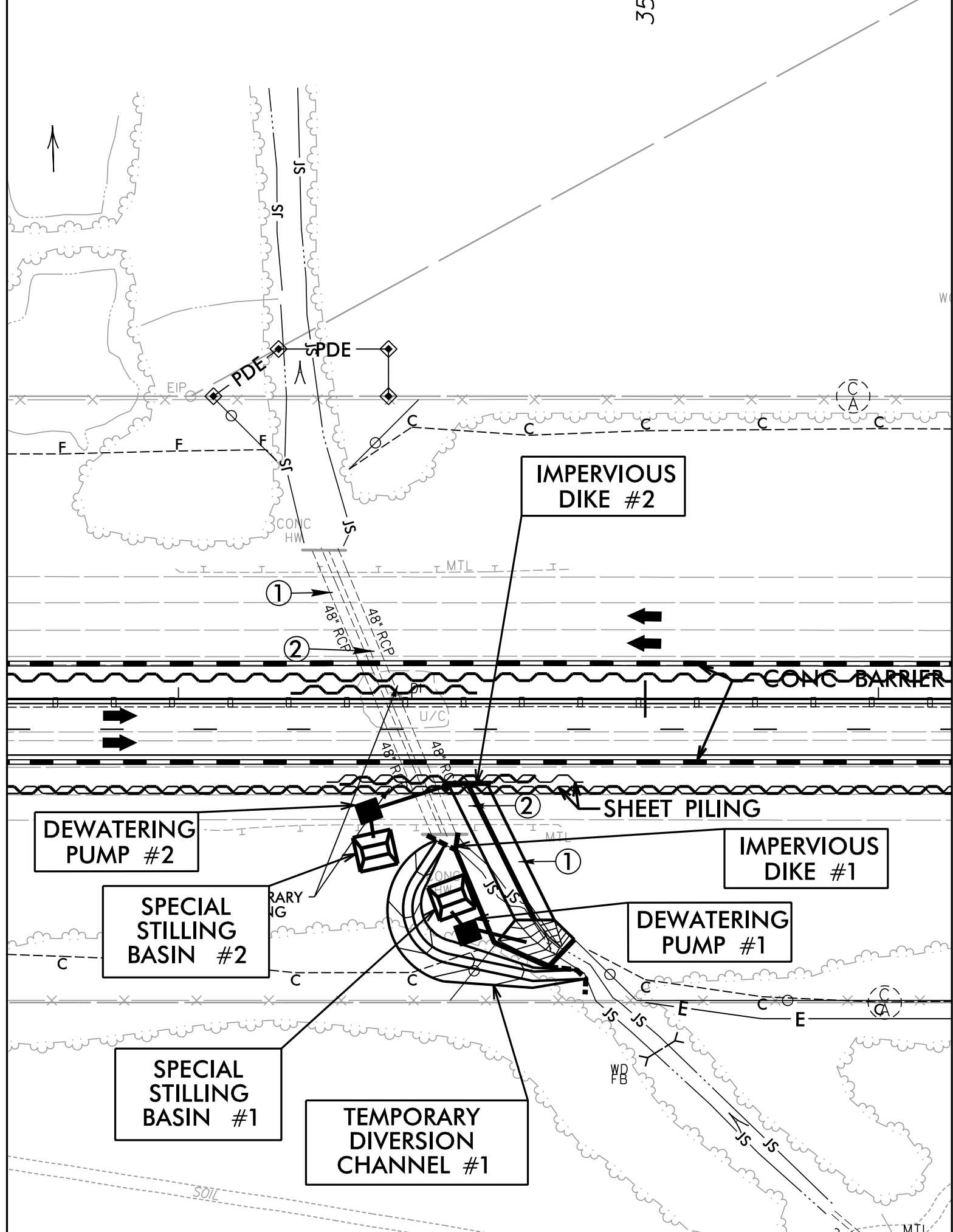

**CONSTRUCTION SEQUENCE
STA. 354+06 -L-
FOR PROPOSED (2) 7' X 7' RCBC**

EXECUTE ALL PHASES OF CONSTRUCTION IN A CONTINUOUS MANNER, AS MUCH AS PERMITTED BY TRAFFIC MANAGEMENT PLAN PHASING.

PHASE I

1. SHIFT NORTHBOUND TRAFFIC ONTO THE TEMPORARY PAVEMENT AS SHOWN IN THE TRAFFIC CONTROL PLANS.
2. INSTALL SHEET PILING AS SHOWN ON THE TRAFFIC CONTROL PLANS.
3. INSTALL SPECIAL STILLING BASIN #1 AND DEWATERING PUMP #1.
4. INSTALL IMPERVIOUS DIKE #1. CONSTRUCT IMPERVIOUS DIKE AT AN ELEVATION TO OVERTOP DURING HIGH STREAM LEVELS.
5. CONSTRUCT TEMPORARY DIVERSION CHANNEL #1 WHILE MAINTAINING FLOW IN THE EXISTING CHANNEL.
6. MODIFY IMPERVIOUS DIKE #1 TO DIVERT FLOW INTO THE TEMPORARY DIVERSION CHANNEL #1 AND BOTH EXISTING 48" PIPES.
7. INSTALL IMPERVIOUS DIKE #2. CONSTRUCT IMPERVIOUS DIKE AT AN ELEVATION TO OVERTOP DURING HIGH STREAM LEVELS.
8. INSTALL SPECIAL STILLING BASIN #2 AND DEWATERING PUMP #2.
9. CONSTRUCT THE SECTION OF THE (2) 7' X 7' RCBC AND HW AS SHOWN. MODIFY INLET CHANNEL AND INSTALL BANK STABILIZATION.
10. BREAK BOTH BARRELS OF THE EXISTING 48" RCP BETWEEN THE SHEET PILING.
11. MODIFY IMPERVIOUS DIKE #3 AS SHOWN IN PHASE II. MODIFY IMPERVIOUS DIKE #2 TO DIVERT FLOW OVER FROM THE NEWLY CONSTRUCTED RCBC BARREL #2 TO THE EXISTING 48" RCP #1 WEST OF THE SHEET PILING.

NAD 83/NA 2011

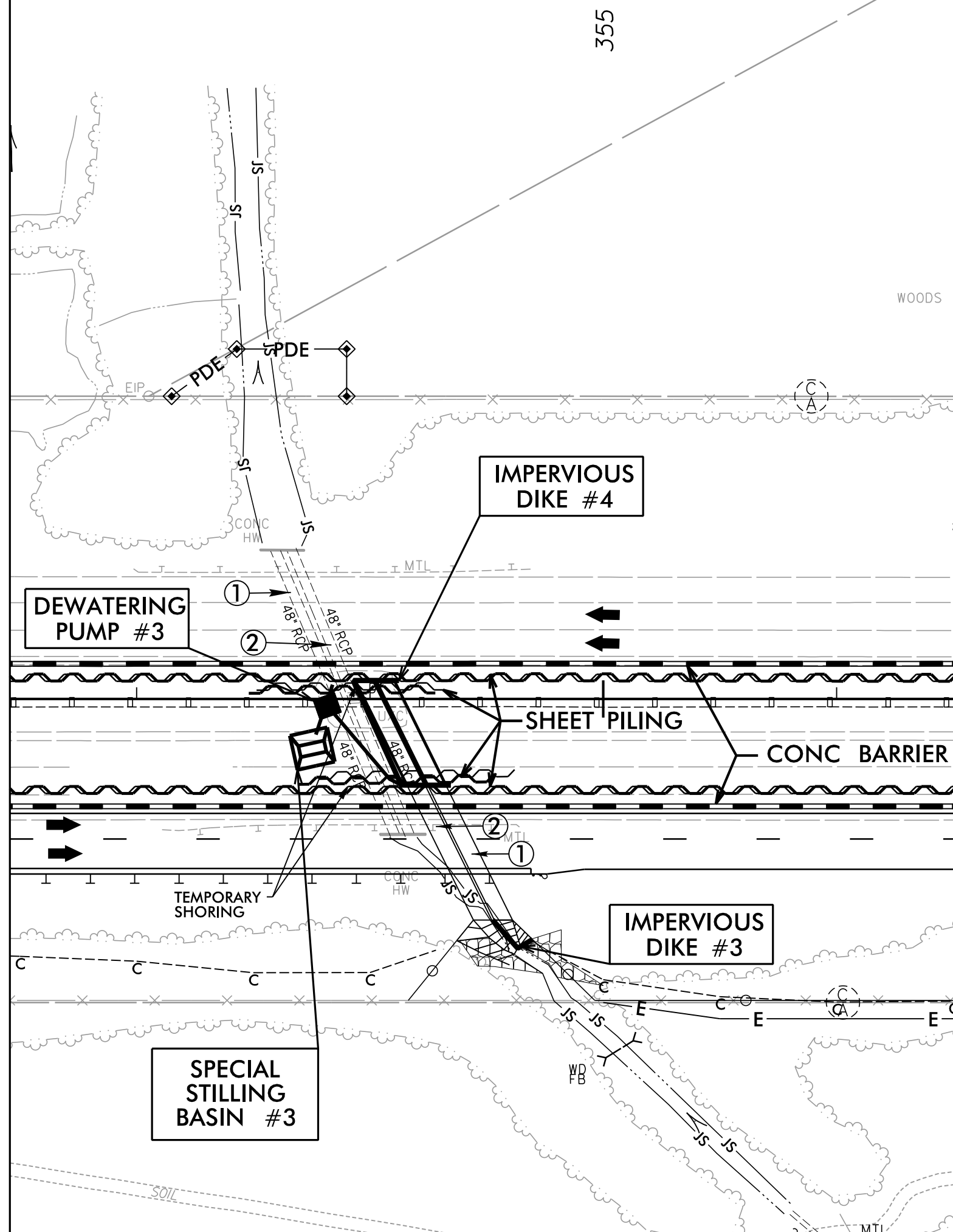

**CONSTRUCTION SEQUENCE
STA. 354+06 -L-
FOR PROPOSED (2) 7' X 7' RCBC**

PHASE II

1. REMOVE THE SECTION OF THE EXISTING 48" RCP #1 AND #2 EAST OF THE SHEET PILING. REMOVE THE HW AT THE INLET. MAINTAIN FLOW THROUGH THE CONSTRUCTION AREA AS THE EXISTING PIPES ARE REMOVED.
2. REMOVE TEMPORARY DIVERSION CHANNEL #1, SPECIAL STILLING BASINS #1 AND #2, AND DEWATERING PUMPS #1 AND #2.
3. CONSTRUCT THE SECTION OF THE NBL AS SHOWN ON THE TRAFFIC CONTROL PLANS AND SHIFT TRAFFIC ONTO THE NORTHBOUND LANES.
4. INSTALL SHEET PILING AS ON THE TRAFFIC CONTROL PLANS, LEAVING ENOUGH SPACE BETWEEN ROWS OF SHEET PILING TO MAINTAIN FLOW AREA OF CULVERT BARRELS.
5. INSTALL IMPERVIOUS DIKE #4, SPECIAL STILLING BASIN #3 AND DEWATERING PUMP #3.
6. CONSTRUCT SECTIONS #1 AND #2 OF THE (2) 7' X 7' RCBC AS SHOWN.
7. DIVERT FLOW THROUGH NEW SECTION OF BARREL #2. REMOVE IMPERVIOUS DIKE #4, SPECIAL STILLING BASIN #3 AND DEWATERING PUMP #3.
8. REMOVE THE SECTION OF THE EXISTING BARRELS #1 AND #2 BETWEEN THE SHEET PILING. MAINTAIN TEMPORARY FLOW THROUGH THE CONSTRUCTION AREA BETWEEN EXISTING BARREL #1 WEST OF THE SHEET PILING AND NEW BARREL #2.
9. CONSTRUCT THE NEWLY WESTERN SECTION OF THE NBL AND SHIFT SB TRAFFIC ON THE WESTERN SECTION OF THE NBL.

NAD 83/NA 2011

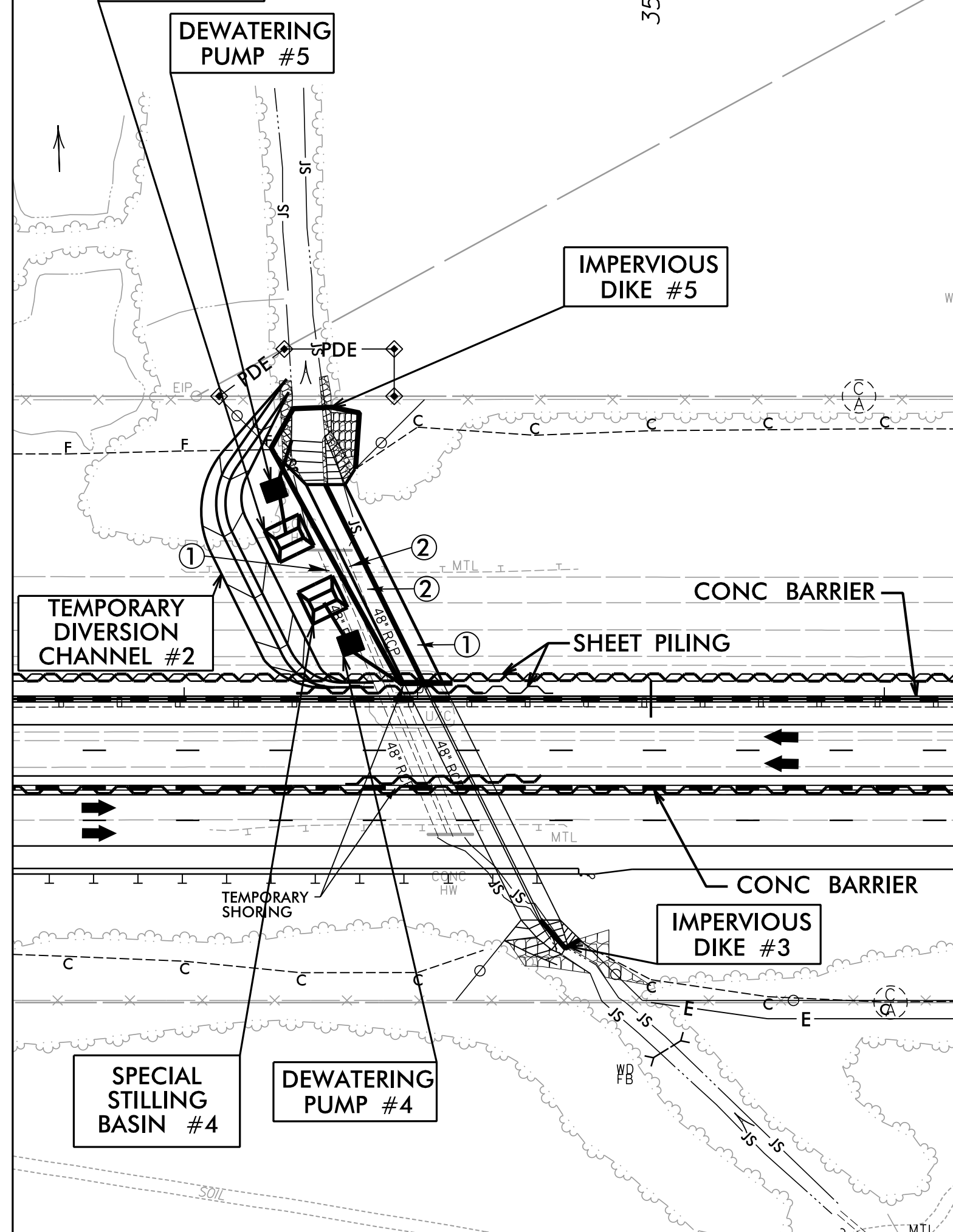

**CONSTRUCTION SEQUENCE
STA. 354+06 -L-
FOR PROPOSED (2) 7' X 7' RCBC**

PHASE III

1. INSTALL TEMPORARY DIVERSION CHANNEL #2 WHILE MAINTAINING FLOW THROUGH THE CONSTRUCTION AREA.
2. DIVERT FLOW FROM RCBC #2 INTO THE TEMPORARY DIVERSION CHANNEL #2.
3. REMOVE THE HW AT THE OUTLET AND THE REMAINING SECTION OF THE EXISTING 48" RCP PIPES.
4. INSTALL IMPERVIOUS DIKE #5. CONSTRUCT IMPERVIOUS DIKE AT AN ELEVATION TO OVERTOP DURING HIGH STREAM LEVELS.
5. INSTALL SPECIAL STILLING BASINS #4 AND #5 AND DEWATERING PUMPS #4 AND #5.
6. CONSTRUCT THE REMAINING SECTION OF THE (2) 7' X 7' RCBC AND HW AS SHOWN. MODIFY OUTLET CHANNEL AND INSTALL BANK STABILIZATION.
7. REMOVE IMPERVIOUS DIKES #3 AND #5 AND DIVERT FLOW INTO THE NEWLY CONSTRUCTED (2) 7' X 7' RCBC.
8. REMOVE THE STILLING BASINS #4 AND #5, DEWATERING PUMPS #4 AND #5, AND TEMPORARY DIVERSION CHANNEL #2. STABILIZE ALL DISTURBED AREA.
9. COMPLETE ROADWAY AND SHIFT SB TRAFFIC ON THE NEWLY BUILT SECTION OF THE SBL.

TEMPORARY DIVERSION CHANNEL

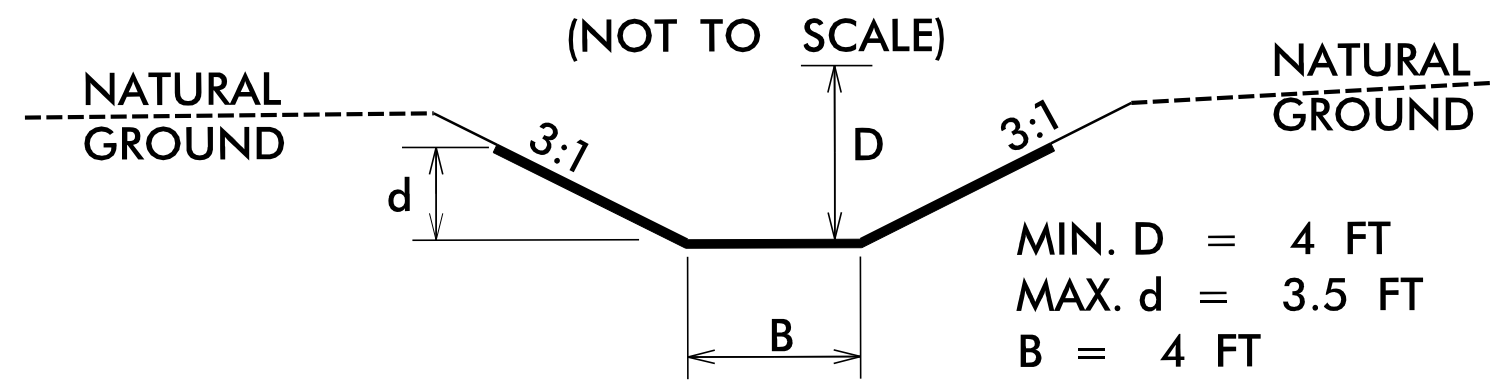

MIN. D = 4 FT
MAX. d = 3.5 FT
B = 4 FT

TYPE OF LINER = GEOTEXTILE FOR SOIL STABILIZATION

PROJECT REFERENCE NO.	SHEET NO.
1-5987A	EC-22A/CONST.22
RW SHEET NO.	

REVISIONS

4/7/2022
 R:\E\2020\Commentary\Design\15987A_EC_PSH_022A.dwg
 samuel.sekula