

**CONSTRUCTION SEQUENCE  
STA. 35+20 -Y1A-  
FOR PROPOSED 42" RCP-IV**

1. INSTALL IMPERVIOUS DIKES #1 AND #2. CONSTRUCT IMPERVIOUS DIKES AT AN ELEVATION TO OVERTOP DURING HIGH STREAM LEVELS.
2. CONSTRUCT TEMPORARY DIVERSION #1. INSTALL SPECIAL STILLING BASIN #1 AND DEWATERING PUMP #1.
3. DIVERT FLOW INTO TEMPORARY DIVERSION #1 AND INSTALL 42" RCP, HW'S AND OUTLET STABILIZATION.
4. REMOVE IMPERVIOUS DIKES #1 AND #2 AND DIVERT FLOW TO 42" RCP. REMOVE TEMPORARY DIVERSION #1, SPECIAL STILLING BASIN #1 AND DEWATERING PUMP #1.
5. CONSTRUCT ROADWAY FOR -Y1A-.

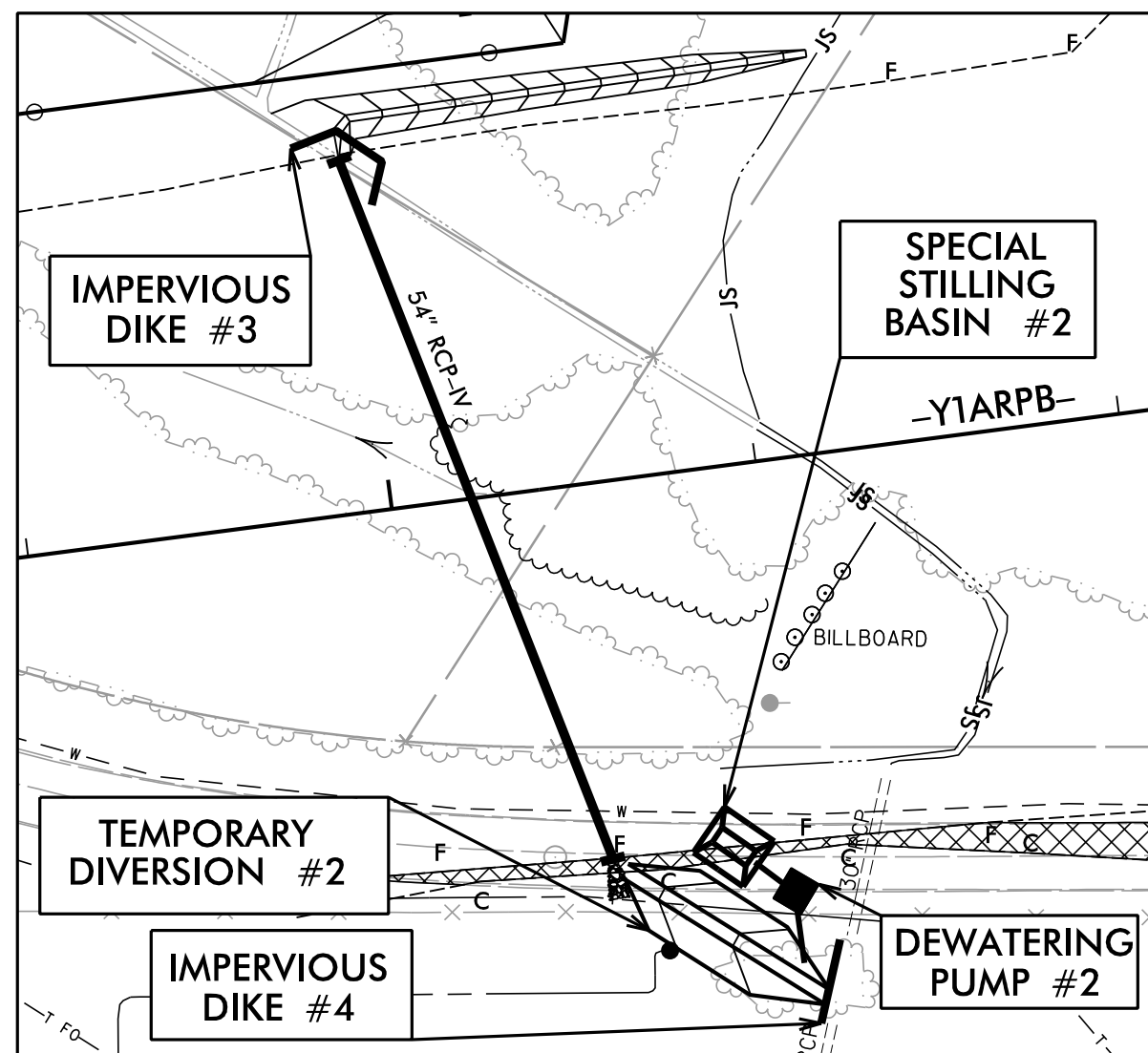

**CONSTRUCTION SEQUENCE  
STA. 25+22 -Y1ARPB-  
FOR PROPOSED 54" RCP-IV**

1. INSTALL IMPERVIOUS DIKES #3 AND #4. CONSTRUCT IMPERVIOUS DIKES AT AN ELEVATION TO OVERTOP DURING HIGH STREAM LEVELS. USE PUMP AROUND OPERATION AT IMPERVIOUS DIKE #3 FOR EXISTING DITCH.
2. CONSTRUCT TEMPORARY DIVERSION #2. INSTALL SPECIAL STILLING BASIN #2 AND DEWATERING PUMP #2.
3. INSTALL 54" RCP, HW'S AND OUTLET STABILIZATION. CONSTRUCT ROADSIDE DITCH.
4. REMOVE IMPERVIOUS DIKES #3 AND #4 AND DIVERT FLOW TO 54" RCP. REMOVE SPECIAL STILLING BASIN #2 AND DEWATERING PUMP #2.
5. CONSTRUCT ROADWAY FOR -Y1ARPB-.

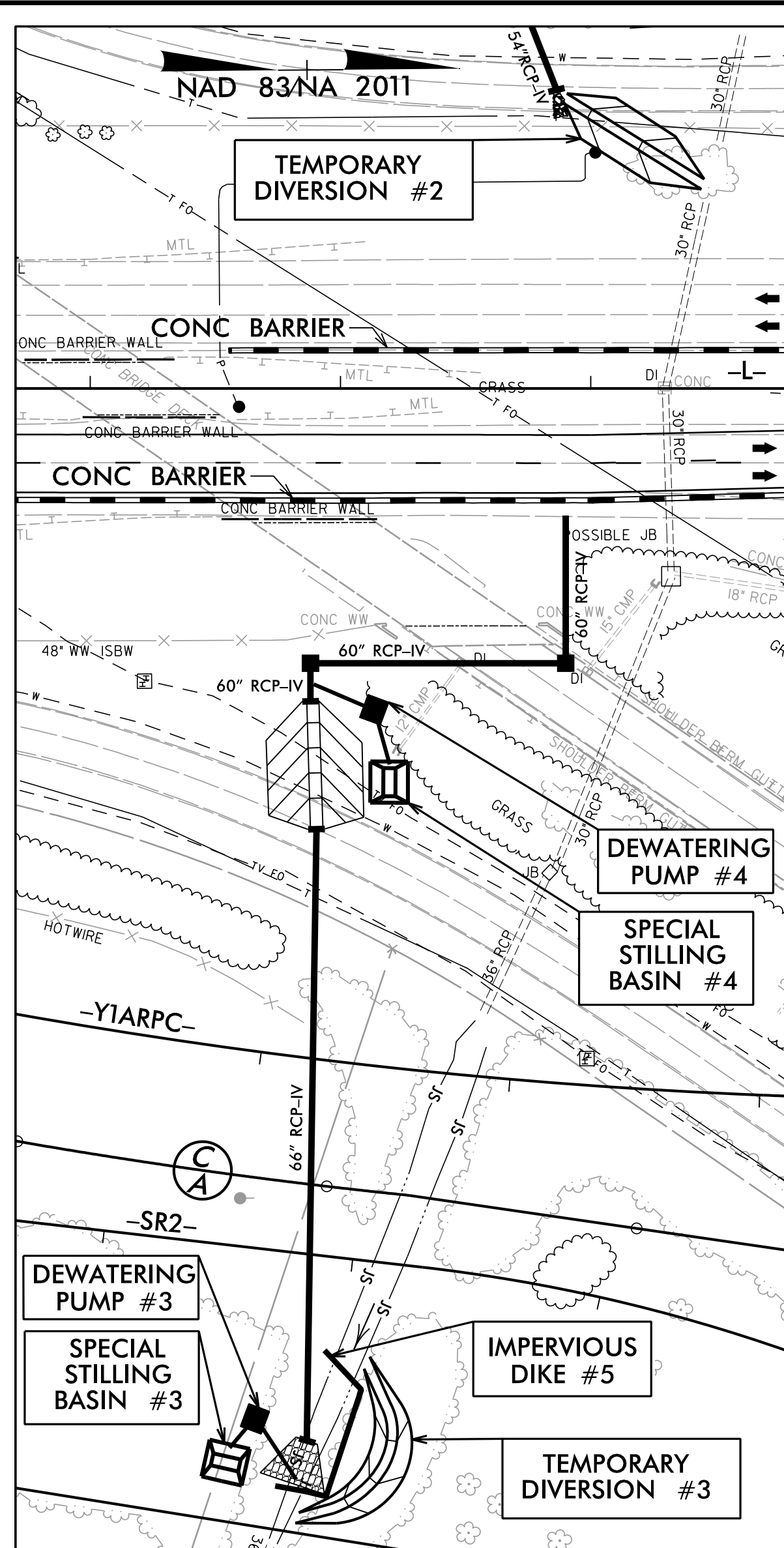

**CONSTRUCTION SEQUENCE  
STA. 282+90 -L-  
FOR PROPOSED 60" RCP-IV  
PHASE I**

1. SHIFT NORTHBOUND TRAFFIC ONTO THE TEMPORARY PAVEMENT AS SHOWN IN THE TRAFFIC CONTROL PLANS.
2. CONSTRUCT TEMPORARY DIVERSION CHANNEL #3 WHILE MAINTAINING FLOW IN THE EXISTING CHANNEL.
3. INSTALL IMPERVIOUS DIKE #5. CONSTRUCT IMPERVIOUS DIKE AT AN ELEVATION TO OVERTOP DURING HIGH STREAM LEVELS.
4. INSTALL SPECIAL STILLING BASIN #3 AND DEWATERING PUMP #3. DIVERT FLOW INTO TEMPORARY DIVERSION.
5. INSTALL SPECIAL STILLING BASIN #4 AND DEWATERING PUMP #4.
6. CONSTRUCT 66" RCP-IV, HW'S AND OUTLET STABILIZATION. CONSTRUCT 60" RCP-IV PIPE NETWORK AS SHOWN.
7. INSTALL TEMPORARY 36" PIPE AS SHOWN IN PHASE II. DIVERT FLOW TO 60" PIPE NETWORK.
8. REMOVE TEMPORARY DIVERSION #3, IMPERVIOUS DIKE #5, SPECIAL STILLING BASIN #3 AND DEWATERING PUMP #3. REMOVE SPECIAL STILLING BASIN #4 AND DEWATERING PUMP #4.
9. COMPLETE ROADWAY FOR -SR2- AND -Y1ARPC-.

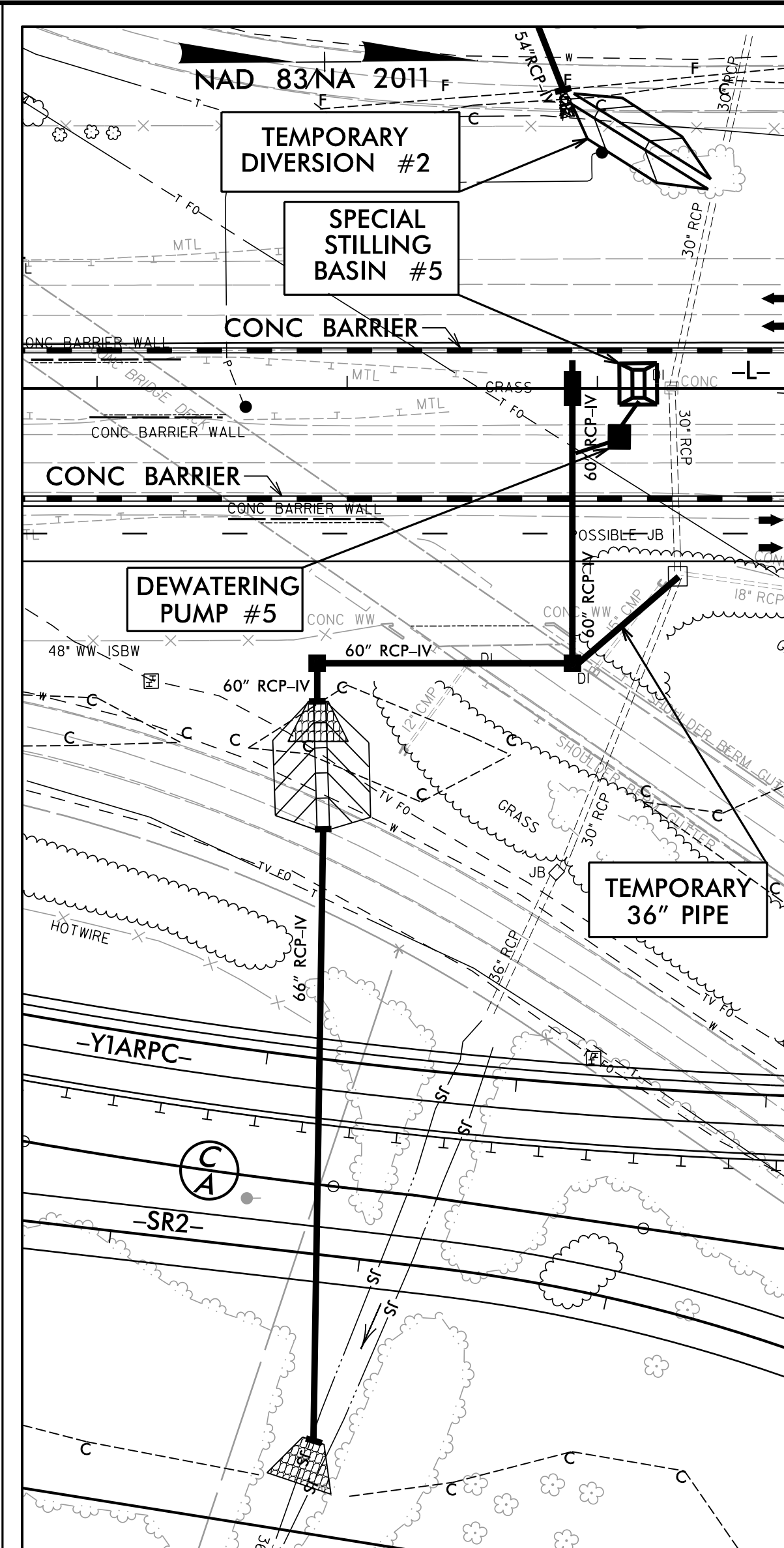

**CONSTRUCTION SEQUENCE  
STA. 282+90 -L-  
FOR PROPOSED 60" RCP-IV  
PHASE II**

1. APPLY A NIGHTTIME LANE CLOSURE TO EXTEND THE 60" RCP INTO THE NBL BEFORE SHIFTING TRAFFIC.
2. COMPLETE THE NBL ROADWAY AND SHIFT THE NB TRAFFIC ONTO THE NEWLY CONSTRUCTED NB SECTION.
3. INSTALL SPECIAL STILLING BASIN #5 AND DEWATERING PUMP #5.
4. INSTALL 60" RCP AND INLETS AS SHOWN.
5. REMOVE SPECIAL STILLING BASIN #5 AND DEWATERING PUMP #5.
6. CONSTRUCT ROADWAY ALONG MEDIAN AND STABILIZE ALL DISTURBED AREAS.

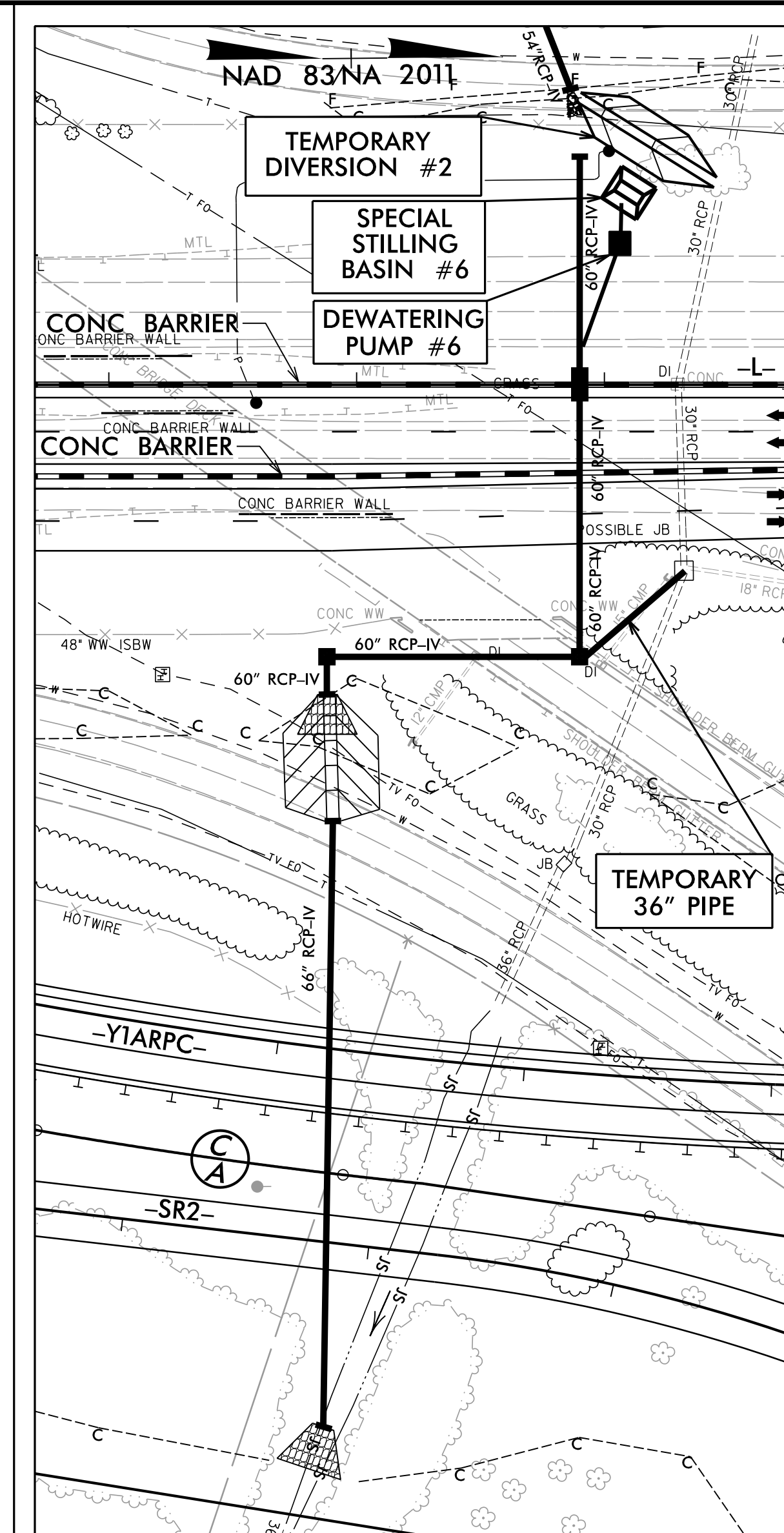

**CONSTRUCTION SEQUENCE  
STA. 282+90 -L-  
FOR PROPOSED 60" RCP-IV  
PHASE III**

1. CONSTRUCT THE WESTERN SECTION OF THE NBL AS SHOWN ON THE TRAFFIC CONTROL PLANS AND SHIFT SB TRAFFIC ONTO THE WESTERN NORTHBOUND LANES.
2. INSTALL SPECIAL STILLING BASIN #6 AND DEWATERING PUMP #6.
3. INSTALL 60" RCP AND HW. DIVERT FLOW FROM 54" RCP TO 60" RCP.
4. REMOVE TEMPORARY DIVERSION #2, SPECIAL STILLING BASIN #6 AND DEWATERING PUMP #6. REMOVE TEMPORARY 36" PIPE.
5. CONSTRUCT ROADWAY AND SHIFT SB TRAFFIC TO THE NEWLY BUILT SECTION OF THE SBL.

**TEMPORARY DIVERSION CHANNEL**

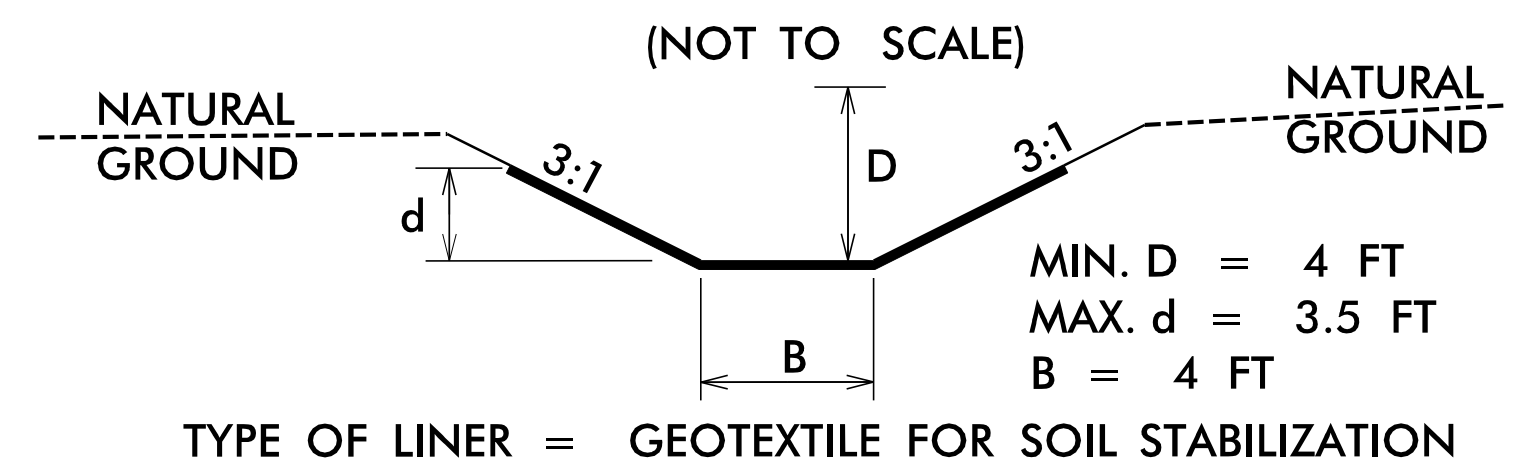

\* EXECUTE ALL PHASES OF CONSTRUCTION IN A CONTINUOUS MANNER, AS MUCH AS PERMITTED BY TRAFFIC MANAGEMENT PLAN PHASING.

4/7/2022 5:47:00 PM C:\CLIENT\Environmental\Design\15987A\_EC\_PSH\_017A.dgn