

**CONSTRUCTION SEQUENCE
STA. 111+25 -L-
FOR PROPOSED 7' X 7' RCBC**

EXECUTE ALL PHASES OF CONSTRUCTION IN A CONTINUOUS MANNER, AS MUCH AS PERMITTED BY TRAFFIC MANAGEMENT PLAN PHASING.

PHASE I

1. INSTALL SHEET PILING AS SHOWN ON THE TRAFFIC CONTROL PLANS.
2. INSTALL IMPERVIOUS DIKES #1, #2, #3 AND #4. CONSTRUCT IMPERVIOUS DIKES AT AN ELEVATION TO OVERTOP DURING HIGH STREAM LEVELS.
3. CONSTRUCT TEMPORARY DIVERSION CHANNELS #1 AND #2 WHILE MAINTAINING FLOW IN THE EXISTING RCP.

TEMPORARY DIVERSION CHANNEL

(NOT TO SCALE)

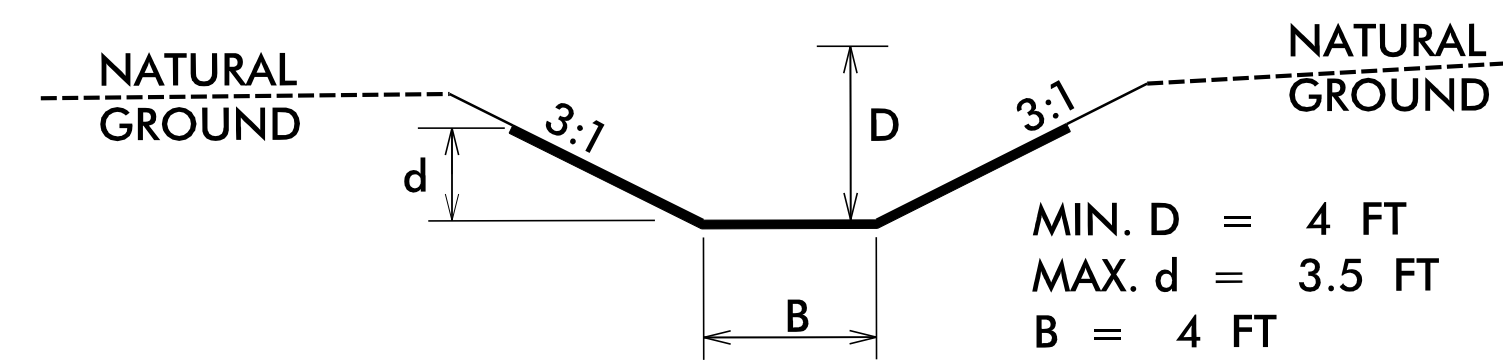

TYPE OF LINER = GEOTEXTILE FOR SOIL STABILIZATION

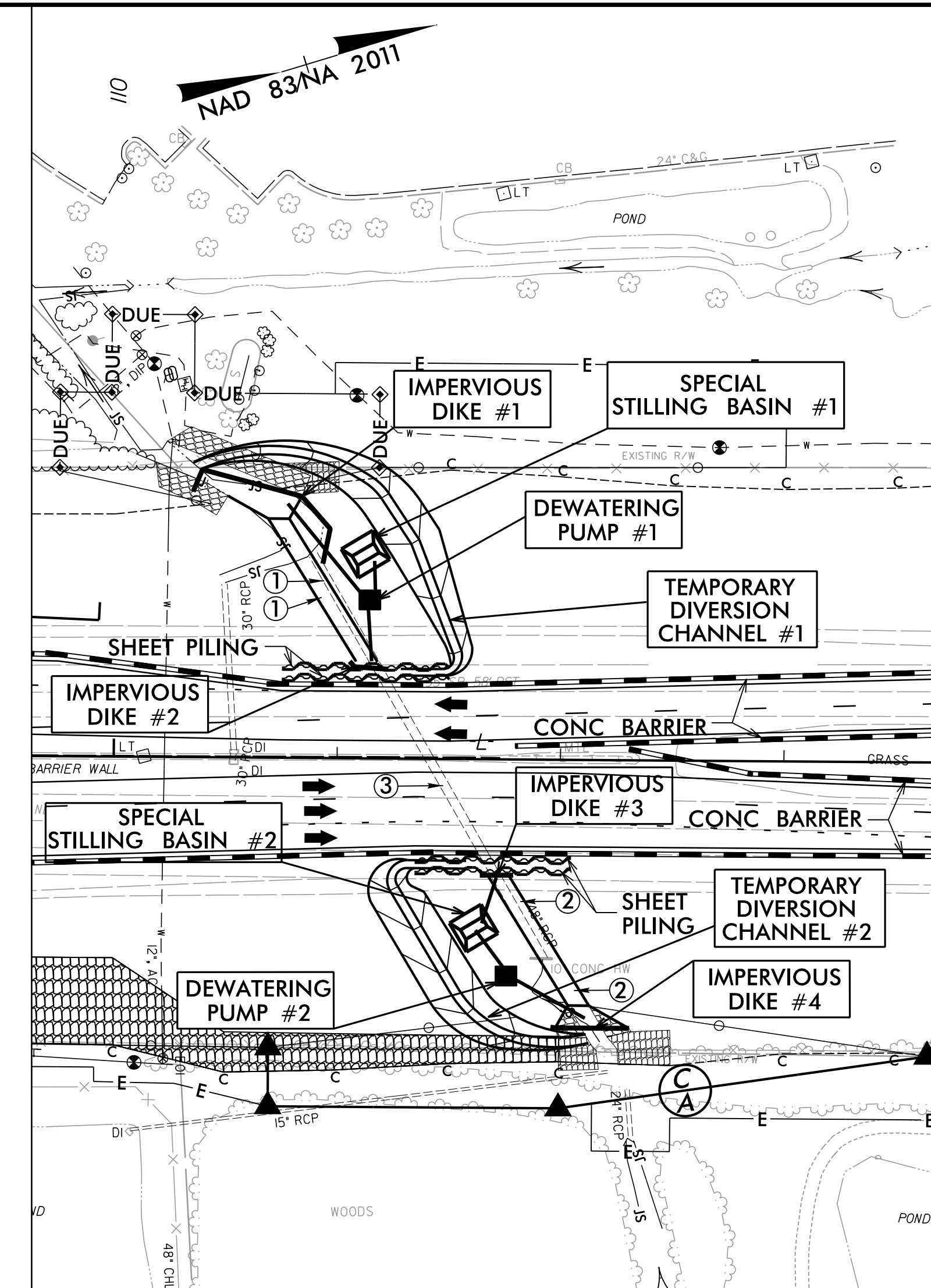

**CONSTRUCTION SEQUENCE
STA. 111+25 -L-
FOR PROPOSED 7' X 7' RCBC**

PHASE II

1. INSTALL SPECIAL STILLING BASIN #1 AND DEWATERING PUMP #1. MODIFY IMPERVIOUS DIKE #1 AND #2. CONSTRUCT IMPERVIOUS DIKE AT AN ELEVATION TO OVERTOP DURING HIGH STREAM LEVELS.
2. INSTALL SPECIAL STILLING BASIN #2 AND DEWATERING PUMP #2. MODIFY IMPERVIOUS DIKE #3 AND #4. CONSTRUCT IMPERVIOUS DIKE AT AN ELEVATION TO OVERTOP DURING HIGH STREAM LEVELS.
3. REMOVE SECTIONS #1 AND #2 OF THE EXISTING RCP AND THE EXISTING HW AS SHOWN.
4. MAINTAIN FLOW THROUGH THE CONSTRUCTION AREA UTILIZING THE MIDDLE SECTION (SECTION #3) OF THE EXISTING RCP AND TEMPORARY DIVERSION CHANNELS #1 AND #2.
5. CONSTRUCT SECTIONS #1 AND #2 OF THE 7'X7' RCBC AND THE UPSTREAM AND DOWNSTREAM HW AND OUTLET CHANNEL AND INSTALL BANK STABILIZATION.

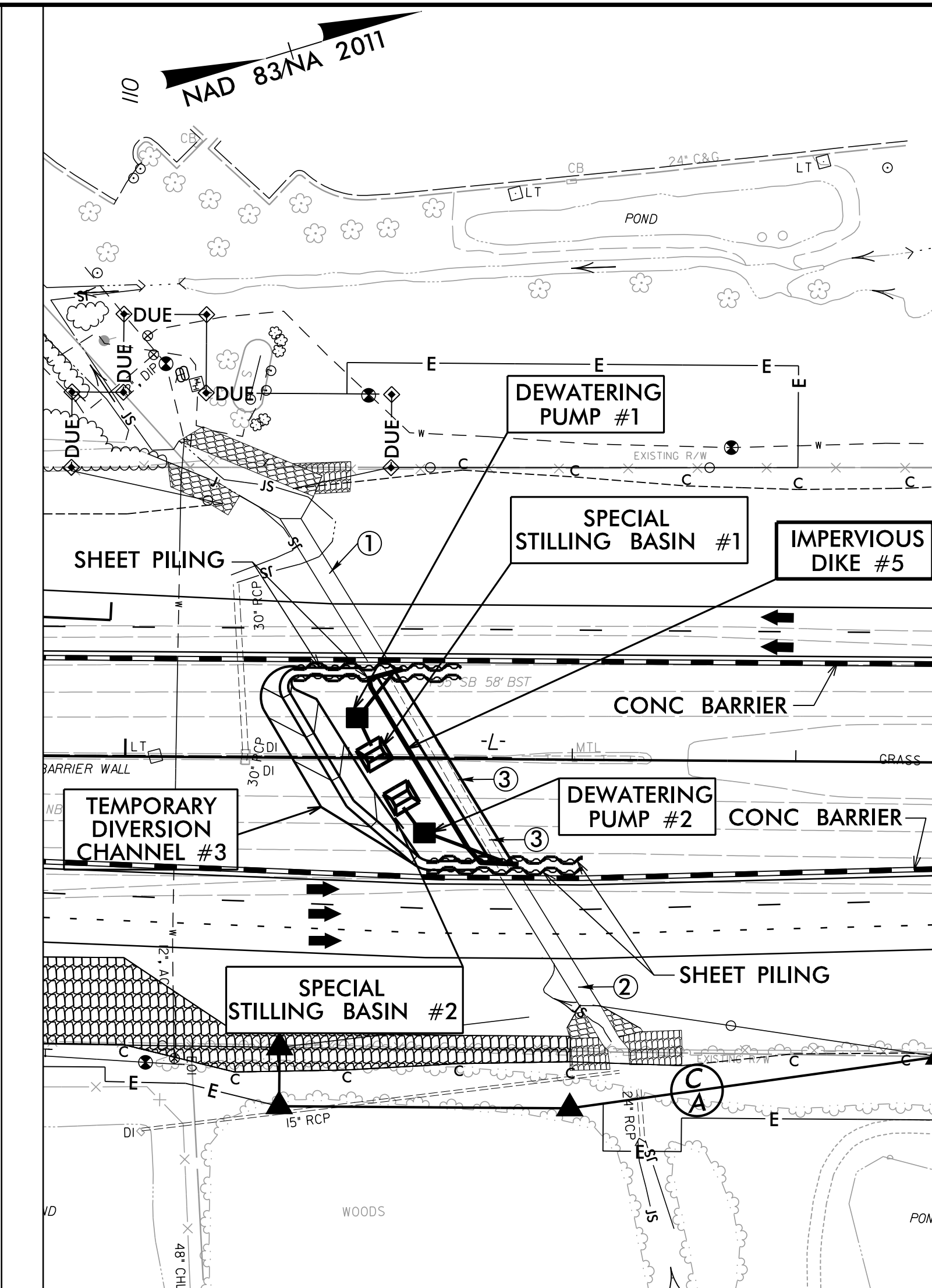

**CONSTRUCTION SEQUENCE
STA. 111+25 -L-
FOR PROPOSED 7' X 7' RCBC**

PHASE III

1. REMOVE TEMPORARY DIVERSION CHANNELS #1 AND #2, AND IMPERVIOUS DIKES #1, #2, #3, AND #4. DIVERT FLOW INTO THE NEWLY CONSTRUCTED SECTIONS OF THE 7'X7' RCBC. RELOCATE THE SPECIAL STILLING BASINS AND DEWATERING PUMPS.
2. COMPLETE THE NORTHBOUND AND SOUTHBOUND ROADWAY. SHIFT TRAFFIC AS SHOWN ON THE TRAFFIC CONTROL PLANS.
3. CONSTRUCT TEMPORARY DIVERSION CHANNEL #3 WHILE MAINTAINING FLOW IN THE CONSTRUCTION AREA THROUGH THE NEWLY CONSTRUCTED SECTIONS #1 AND #2 OF THE 7'X7' RCBC AND THE REMAINING SECTION OF THE EXISTING RCP.
4. INSTALL IMPERVIOUS DIKE #5. MAKE FINAL CONNECTION OF TEMPORARY DIVERSION CHANNEL #3 TO CONVEY FLOW BETWEEN SECTIONS #1 AND #2 OF THE 7'X7' RCBC. CONSTRUCT IMPERVIOUS DIKE AT AN ELEVATION TO OVERTOP DURING HIGH STREAM LEVELS.
5. REMOVE SECTION #3 OF THE EXISTING RCP.
6. CONSTRUCT THE REMAINING SECTION OF THE 7'X7' RCBC.
7. REMOVE IMPERVIOUS DIKE #5 AND TEMPORARY DIVERSION CHANNEL #3. CONNECT ALL SECTIONS OF 7'X7' RCBC AND DIVERT FLOW INTO THE NEWLY COMPLETED SECTION OF THE 7'X7' RCBC.
8. REMOVE THE SPECIAL STILLING BASINS, DEWATERING PUMPS, AND SHEET PILING. STABILIZE ALL DISTURBED AREAS.
9. COMPLETE BANK STABILIZATION AT BOTH ENDS OF THE NEWLY CONSTRUCTED RCBC.
10. COMPLETE ROADWAY.
11. SHIFT TRAFFIC AS SHOWN ON THE TRAFFIC CONTROL PLANS.

REVISIONS

8/17/99
 4/7/2022
 R:\E:\Environmental\Design\I5987A_EC_PSH_06A.dgn
 samuel.skalata