

**TEMPORARY PAVEMENT LOCATION A1-6**  
ON OUTSIDE SHOULDER OF NB I-95 ON  
-L- FROM STA 181+00+/- TO STA  
265+50+/- FOR TEMPORARY TRAFFIC  
PATTERN (17,029 SY)

**TEMPORARY PAVEMENT LOCATION A1-7**  
ON OUTSIDE SHOULDER OF SB I-95 ON  
-L- FROM STA 181+00+/- TO STA  
261+51+/- FOR TEMPORARY TRAFFIC  
PATTERN (15,685 SY)

A1-4 QUANTITY = 1,010 SF  
TEMPORARY SHORING  
FROM -L- STA. 208+99.81, 109.63'  
TO -L- STA. 209+72.44, 109.63' =  
FROM -Y2- STA. 28+63.30, 27.86'  
TO -Y2- STA. 28+10.16, 28.93'  
  
(SEE SHEET TMP-2TS2 FOR  
TEMPORARY SHORING NOTES)

A1-5 QUANTITY = 1,530 SF  
TEMPORARY SHORING  
FROM -L- STA. 208+75.00, 80.00'  
TO -L- STA. 211+30.00, 80.00'  
  
(SEE SHEET TMP-2TS2 FOR  
TEMPORARY SHORING NOTES)

A1-6 QUANTITY = 12,575 SF  
TEMPORARY SHORING  
FROM -Y2- STA. 17+50.00, 20.64'  
TO -Y2- STA. 28+84.86, 22.43'  
  
(SEE SHEET TMP-2TS2 FOR  
TEMPORARY SHORING NOTES)

**TEMPORARY PAVEMENT LOCATION A1-9**  
ON OUTSIDE SHOULDER OF WB  
POWERSVILLE RD ON -Y2- FROM STA  
15+99+/- TO STA 28+20+/- FOR  
TEMPORARY PCB (814 SY)

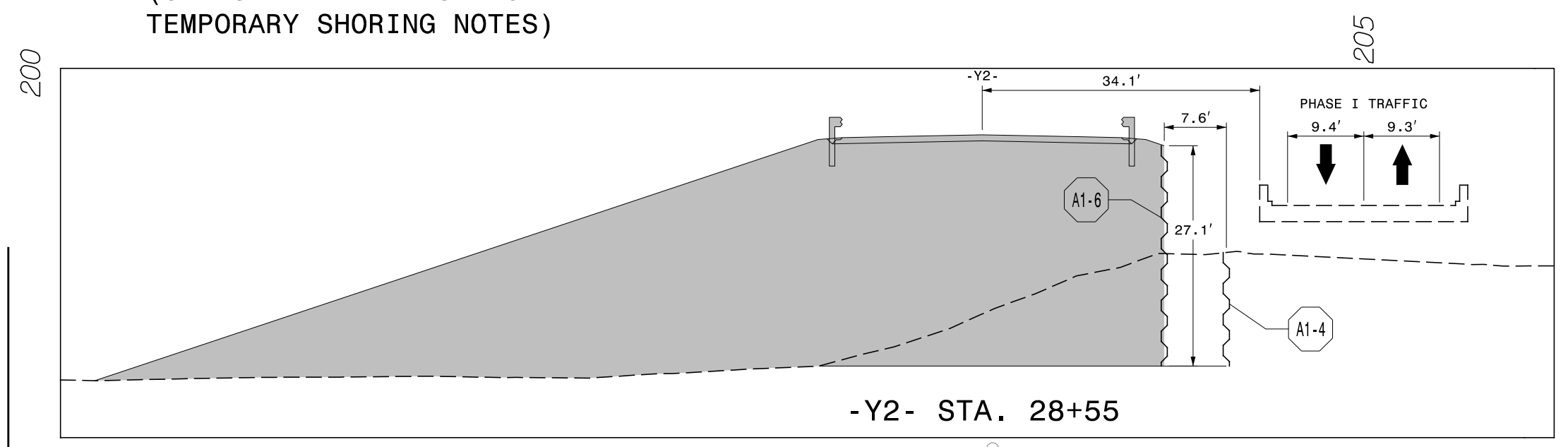

MATCHLINE -L- STA. 200+00 SEE SHEET TMP-13

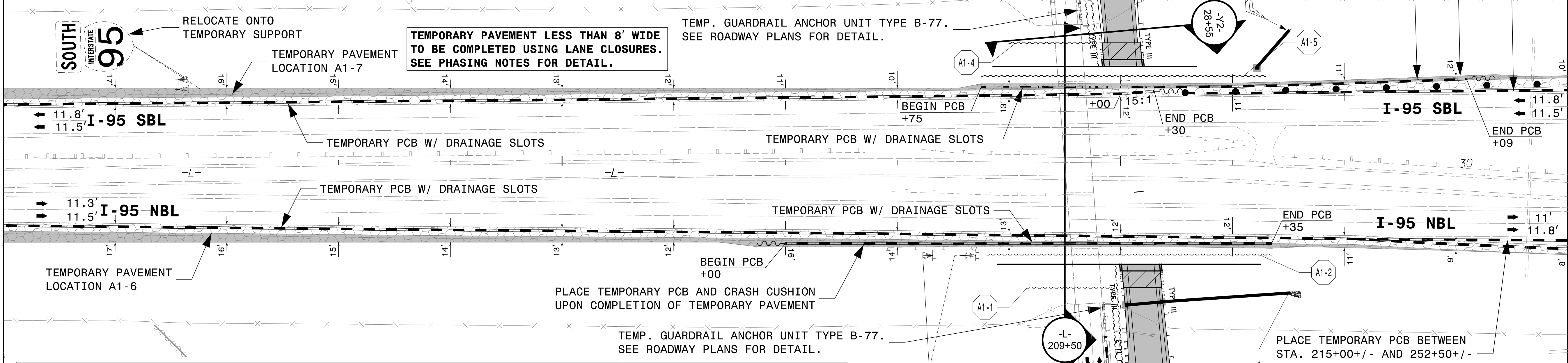

A1-1 QUANTITY = 1,270 SF  
TEMPORARY SHORING  
FROM -L- STA. 209+16.34, 109.58'  
TO -L- STA. 209+91.66, 109.58' =  
FROM -Y2- STA. 30+83.35, 27.83'  
TO -Y2- STA. 31+48.62, 29.13'  
  
(SEE SHEET TMP-2TS2 FOR  
TEMPORARY SHORING NOTES)

A1-2 QUANTITY = 1,530 SF  
TEMPORARY SHORING  
FROM -L- STA. 208+80.00, 80.00'  
TO -L- STA. 211+35.00, 80.00'  
  
(SEE SHEET TMP-2TS2 FOR  
TEMPORARY SHORING NOTES)

A1-3 QUANTITY = 1,040 SF  
TEMPORARY SHORING  
FROM -Y2- STA. 30+62.79, 22.41'  
TO -Y2- STA. 34+00.00, 20.95'  
  
(SEE SHEET TMP-2TS2 FOR  
TEMPORARY SHORING NOTES)

RELOCATE ONTO  
TEMPORARY SUPPORTS

PLACE TEMPORARY PCB BETWEEN  
STA. 215+00+/- AND 252+50+/-  
DURING WEIGH STATION CLOSURE

**TEMPORARY PAVEMENT LOCATION A1-8**  
ON OUTSIDE SHOULDER OF WB  
POWERSVILLE RD ON -Y2- FROM STA  
31+26+/- TO STA 35+83+/- FOR  
TEMPORARY PCB (260 SY)

MATCHLINE -L- STA. 214+00 SEE SHEET TMP-15

MATCHLINE -Y2- STA. 25+00 SEE SHEET TMP-24

MATCHLINE -Y2- STA. 33+00 SEE SHEET TMP-25

4/26/2022 R:\TrafficControl\CP\B987a\_tcp\_secd\_phase1\_Lps014.dgn User:Jtownsend



APPROVED: \_\_\_\_\_  
DATE: \_\_\_\_\_

5/18/2022

**DOCUMENT NOT CONSIDERED FINAL  
UNLESS ALL SIGNATURES COMPLETED**

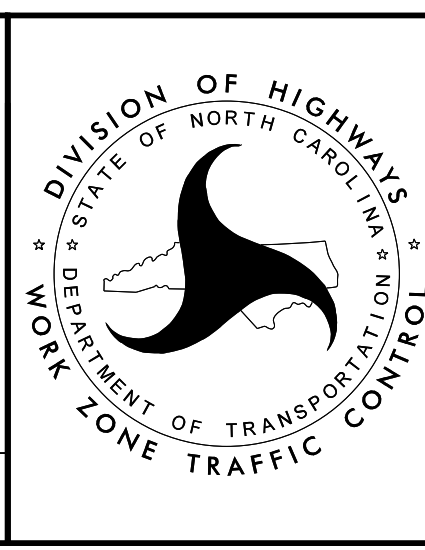

**TEMPORARY TRAFFIC CONTROL  
PHASE I DETAIL**