

5/28/2022

PIPE HYDRAULIC DATA
 -Y3- Sta. 39+30, 2@30" RCP

DRAINAGE AREA	= 11.8	AC
DESIGN FREQUENCY	= 25	YRS
DESIGN DISCHARGE	= 33	CFS
DESIGN HW ELEVATION	= 163.32	FT
100 YEAR DISCHARGE	= 39	CFS
100 YEAR HW ELEVATION	= 163.62	FT
OVERTOPPING FREQUENCY	= +50	YRS
OVERTOPPING DISCHARGE	= 37	CFS
OVERTOPPING ELEVATION	= 163.46	FT

BM# 24
 N: 372,380 E: 2,001,734
 -BY17- STA 37+79.00, 403' LT
 -Y3- STA 42+38.67, 390.19' LT
 ELEV. = 167.54', RRS IN 11" PINE

-Y3-

PI = 39+80.00
 EL = 165.60'
 K = 117
 VC = 400'
 DS = 55 mph

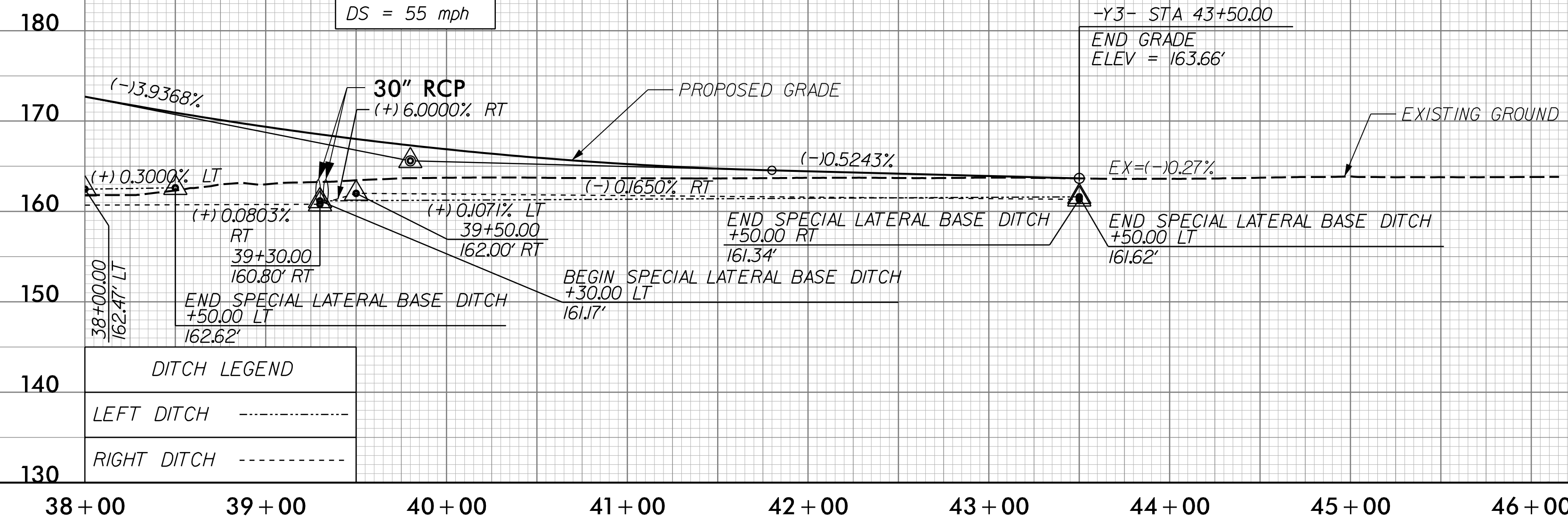

DITCH LEGEND

LEFT DITCH	-----
RIGHT DITCH	-----

PROJECT REFERENCE NO. 1-5987A	SHEET NO. 90
ROADWAY DESIGN ENGINEER 5/18/2022 Trent Hoffman	HYDRAULICS ENGINEER 5/19/2022 Linda Johns

**DOCUMENT NOT CONSIDERED FINAL
 UNLESS ALL SIGNATURES COMPLETED**

moftatt & nichol
 4700 FALLS OF WELLS ROAD, SUITE 100
 RALEIGH, NORTH CAROLINA 27615-9100
 (919) 851-6606 VOIC (919) 851-6606 FAX
 NC License No.: F-0105

MI ENGINEERING
 1011 SCHAUB DRIVE, SUITE 100
 RALEIGH, NC 27608
 (919) 851-6606
 FIRM PE NUMBER : P-0671

FOR -Y3- PLAN, SEE SHEET 39

-DR1-

PI = 10+60.00
 EL = 166.00'
 K = 14
 VC = 80'
 DS = 15 mph

PI = 12+20.00
 EL = 177.55'
 K = 9
 VC = 40'
 DS = 20 mph

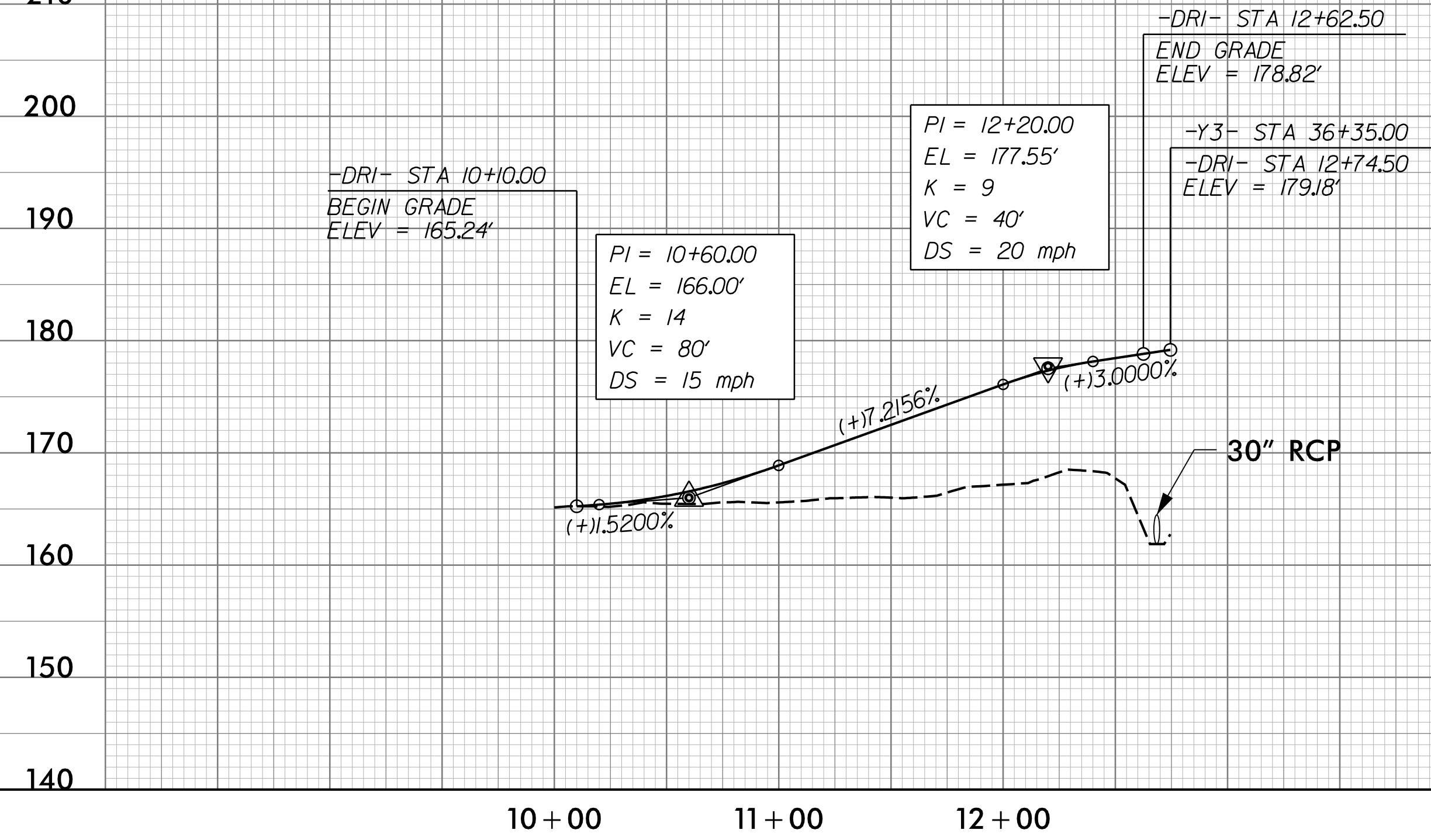

FOR -DR1- PLAN, SEE SHEETS 30 & 39

G:\16\1125\0500\CAD\15987A\Roadway\Proj\15987A_RDY_PSH_PFL_090.dgn
 5/18/2022 11:25:05 AM
 04/16/2022 11:25:05 AM
 04/16/2022 11:25:05 AM