

5/28/2022

PROJECT REFERENCE NO. I-5987A		SHEET NO. 71	
ROADWAY DESIGN ENGINEER 5/18/2022		HYDRAULICS ENGINEER 5/19/2022	
DOCUMENT NOT CONSIDERED FINAL UNLESS ALL SIGNATURES COMPLETED			
		<small>4700 FALLS OF NEUSE ROAD, SUITE 100 RALEIGH, NORTH CAROLINA 27615-3000 (919) 851-6600 VOIC (919) 851-7488 FAX NC License No.: F-0105</small>	
		<small>MI ENGINEERING 1011 SCHAUB DRIVE, SUITE 100 RALEIGH, NC 27608 (919) 851-6606 FIRM PE NUMBER: P-0671</small>	

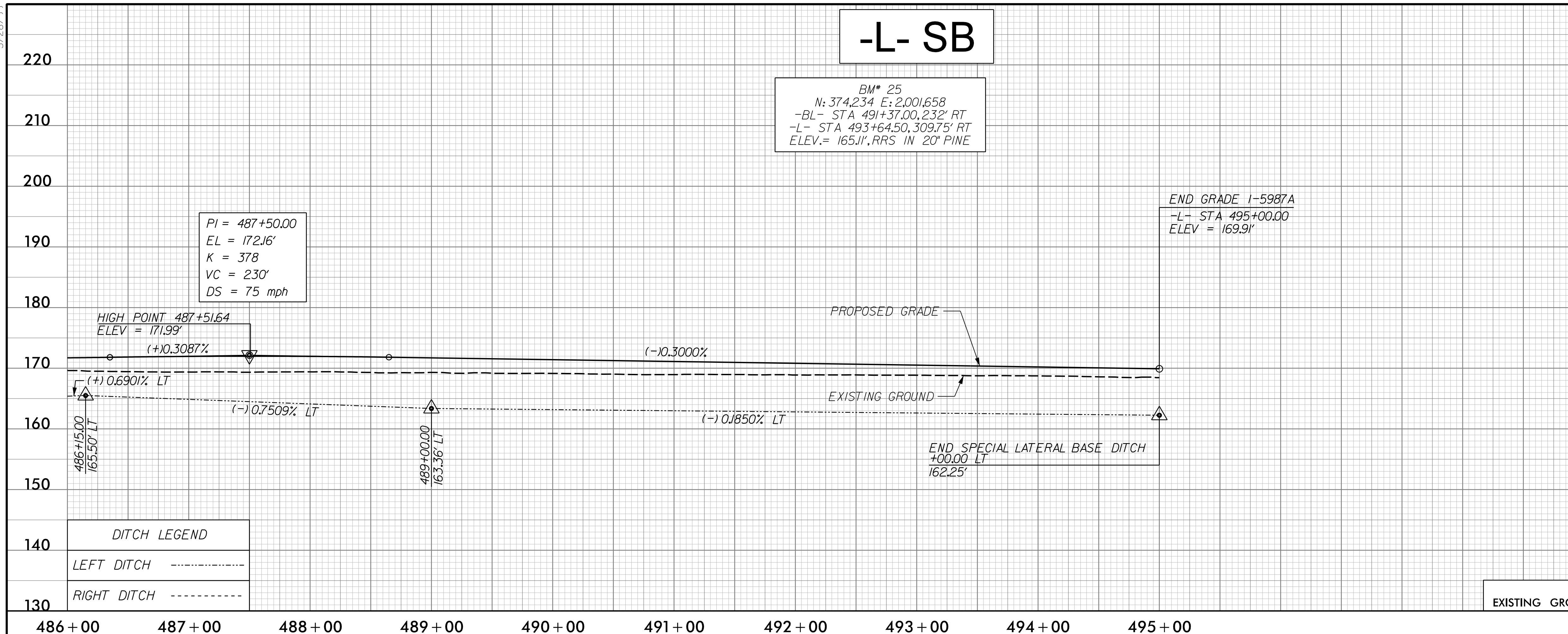

D:\182022\0500\CAD\I5987A\Roadway\Proj\I5987A_RDY_PSH_PFL_071.dgn

