

5/28/2022

PIPE HYDRAULIC DATA
 -L- Sta. 419+55, 54" RCP

| | | |
|-----------------------|----------|-----|
| DRAINAGE AREA | = 28.3 | AC |
| DESIGN FREQUENCY | = 100 | YRS |
| DESIGN DISCHARGE | = 93 | CFS |
| DESIGN HW ELEVATION | = 159.88 | FT |
| 100 YEAR DISCHARGE | = 93 | CFS |
| 100 YEAR HW ELEVATION | = 159.88 | FT |
| OVERTOPPING FREQUENCY | = -500 | YRS |
| OVERTOPPING DISCHARGE | = 105 | CFS |
| OVERTOPPING ELEVATION | = 160.20 | FT |

-L- SB

BM* 21
 N: 367.755 E: 2,000.645
 -BL- STA 426+16.00, 324' LT
 -L- STA 428+40.52, 264.27' LT
 ELEV. = 164.09', RRS IN 12" PINE

| | |
|---|-------------------------------------|
| PROJECT REFERENCE NO. 1-5987A | SHEET NO. 66 |
| ROADWAY DESIGN ENGINEER 5/18/2022 | HYDRAULICS ENGINEER 5/19/2022 |
| | |

**DOCUMENT NOT CONSIDERED FINAL
 UNLESS ALL SIGNATURES COMPLETED**

4700 FALLS OF WELLS ROAD, SUITE 100
 RALEIGH, NORTH CAROLINA 27608
 (919) 851-6606 VOICE (919) 851-6606 FAX
 NC License No.: F-0105

MI ENGINEERING
 1011 SCHAUB DRIVE, SUITE 100
 RALEIGH, NC 27608
 (919) 851-6606
 FIRM PE NUMBER: P-0671

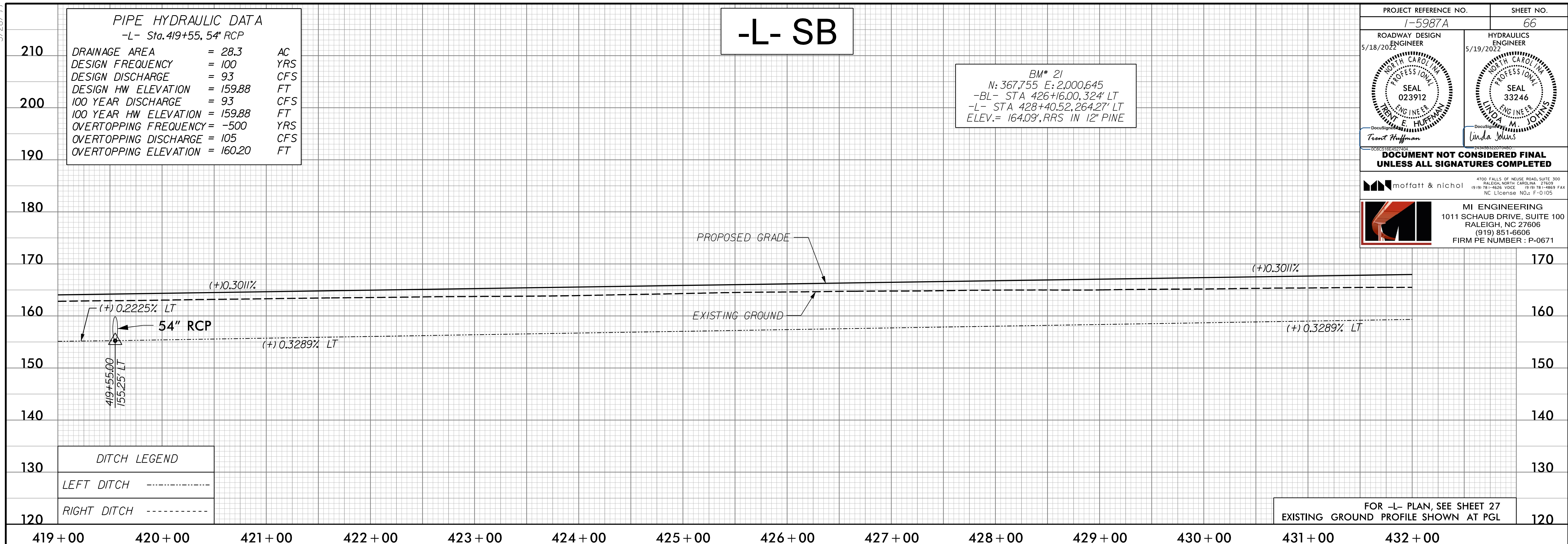

FOR -L- PLAN, SEE SHEET 27
 EXISTING GROUND PROFILE SHOWN AT PGL

-L- NB

BM* 21
 N: 367.755 E: 2,000.645
 -BL- STA 426+16.00, 324' LT
 -L- STA 428+40.52, 264.27' LT
 ELEV. = 164.09', RRS IN 12" PINE

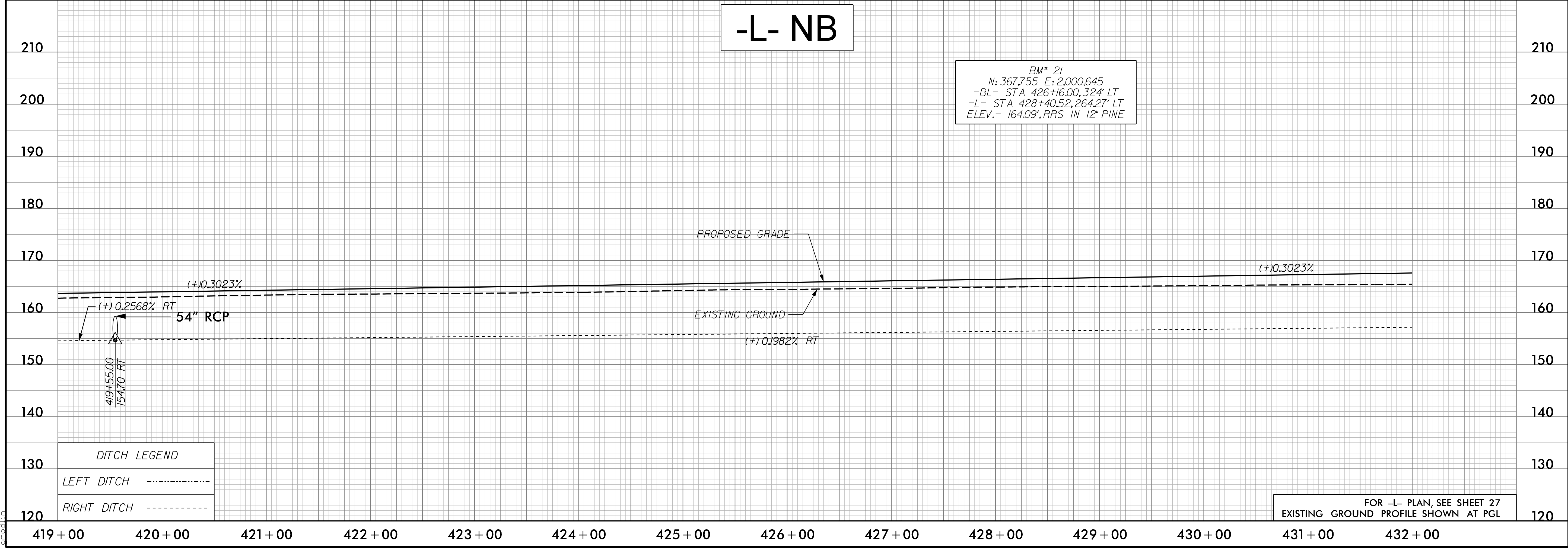

FOR -L- PLAN, SEE SHEET 27
 EXISTING GROUND PROFILE SHOWN AT PGL

G:\18\2022\1125\0500\CAD\15987A\Roadway\Proj\15987A_RDY_PSH_PFL_066.dgn
 5/28/2022 11:25:05 AM