

8.17.19

PROJECT REFERENCE NO. 1-5987A		SHEET NO. 29	
RW SHEET NO.			
ROADWAY DESIGN ENGINEER 5/18/2022	HYDRAULICS ENGINEER 5/19/2022		
DOCUMENT NOT CONSIDERED FINAL UNLESS ALL SIGNATURES COMPLETED			
		4100 FALLS OF NEUSE ROAD, SUITE 300 RALEIGH, NORTH CAROLINA 27619 (919) 781-4626 VOICE (919) 781-4869 FAX NC License No.: F-0105	
		MI ENGINEERING 1011 SCHAUB DRIVE, SUITE 100 RALEIGH, NC 27606 (919) 851-6606 FIRM PE NUMBER : P-0671	

JOSEPH G. RIDDLE
AND WIFE
GAIL A. RIDDLE
DB 1590 PG 865

120

NAD 83/NA 2011

MATCHLINE -L- STA 445 + 00.00 SEE SHEET 28

MATCHLINE -L- STA 458 + 00.00 SEE SHEET 30

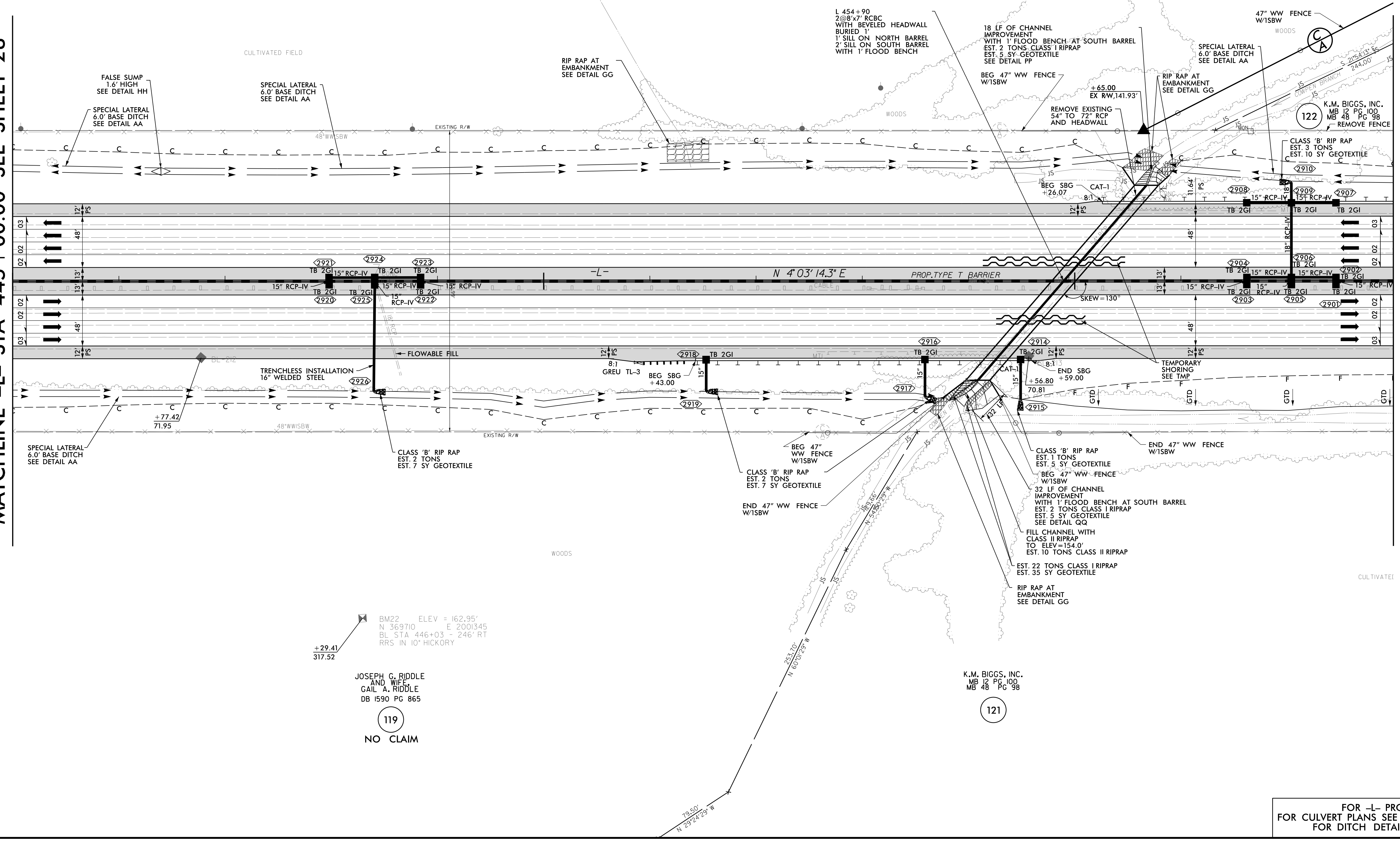

BM22 ELEV = 162.95'
N 369710 E 2001345
BL STA 446+03 - 246' RT
RRS IN 10' HICKORY

+29.41
317.52

JOSEPH G. RIDDLE
AND WIFE
GAIL A. RIDDLE
DB 1590 PG 865

119

NO CLAIM

K.M. BIGGS, INC.
MB 12 PG 100
MB 48 PG 98

121

FOR -L- PROFILE SEE SHEET 68
FOR CULVERT PLANS SEE C13-1 THRU C13-8
FOR DITCH DETAILS SEE SHEET 2D-3

D:\2022\1125\0500\CAD\15987A\Roadway\Proj\15987A_RDY_PSH_029.dgn