

PROJECT REFERENCE NO. 1-5987A		SHEET NO. 27	
RW SHEET NO.			
ROADWAY DESIGN ENGINEER 5/18/2022 Trent Hoffman		HYDRAULICS ENGINEER 5/19/2022 Linda J. Jones	
SEAL 023912 Trent Hoffman		SEAL 33246 Linda J. Jones	
DOCUMENT NOT CONSIDERED FINAL UNLESS ALL SIGNATURES COMPLETED			
moffatt & nichol		MI ENGINEERING 1011 SCHAUB DRIVE, SUITE 100 RALEIGH, NC 27606 (919) 851-6606 FIRM PE NUMBER : P-0671	

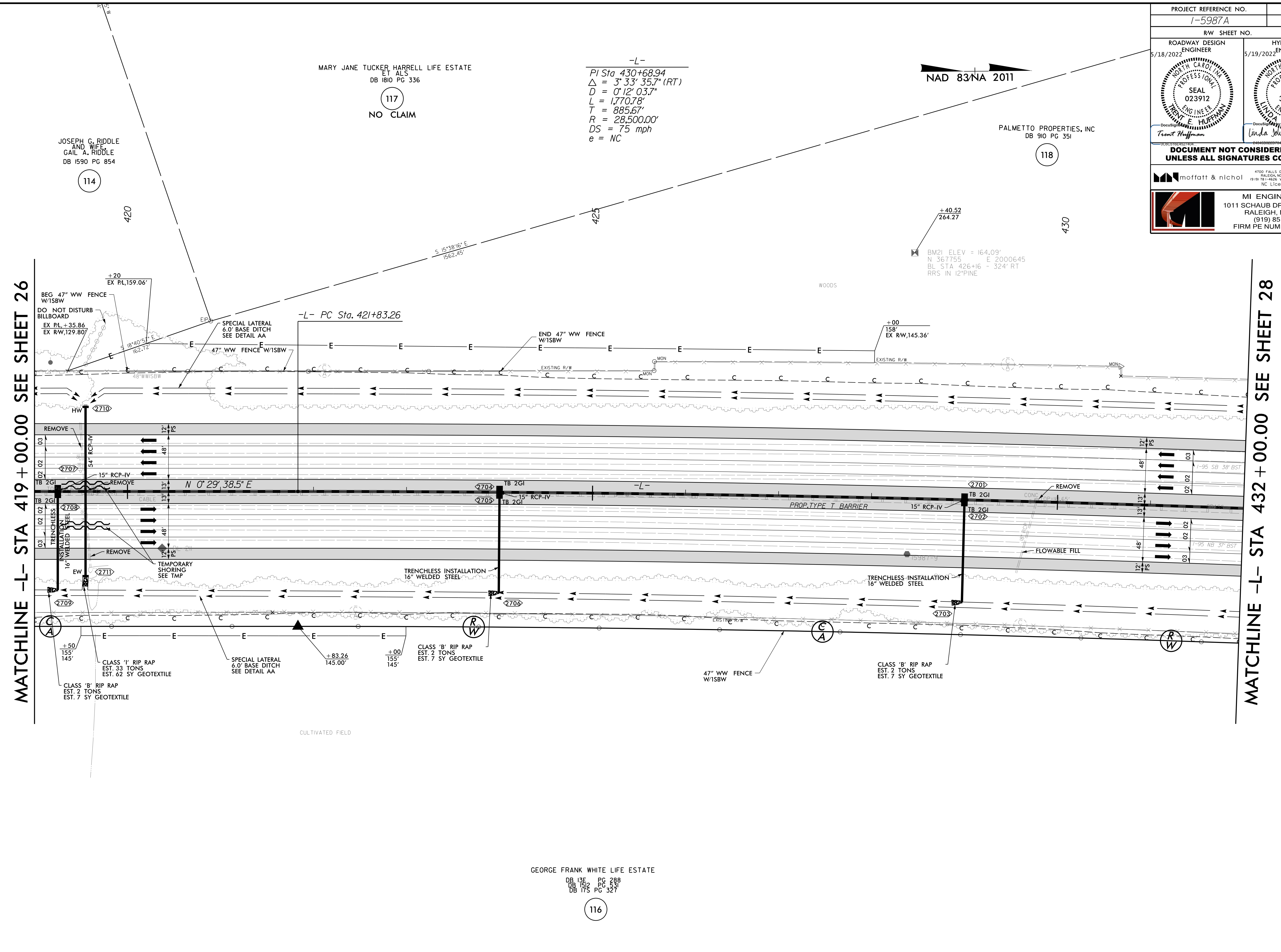

MATCHLINE -L- STA 419 + 00.00 SEE SHEET 26

MATCHLINE -L- STA 432 + 00.00 SEE SHEET 28

-L-
 PI Sta 430+68.94
 $\Delta = 3^\circ 33' 35.7''$ (RT)
 $D = 0' 12' 03.7''$
 $L = 1,770.78'$
 $R = 885.67'$
 $DS = 28,500.00'$
 $e = NC$

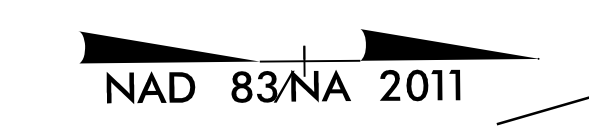

5/2/2022 11:25:05.00_CAD\CAD\15987A\Roadway\Proj\15987A_RDY_PSH_027.dgn

FOR -L- PROFILE SEE SHEET 66
FOR DITCH DETAILS SEE SHEET 2D-3