

PROJECT REFERENCE NO. 1-5987A		SHEET NO. 20	
RW SHEET NO.			
ROADWAY DESIGN ENGINEER 5/18/2022		HYDRAULICS ENGINEER 5/19/2022	
DocuSigned by: Steve Anthony Dean		DocuSigned by: Will Weathershee	
DOCUMENT NOT CONSIDERED FINAL UNLESS ALL SIGNATURES COMPLETED			
NV5		NV5 ENGINEERS & CONSULTANTS, INC. 7500 E. INDEPENDENCE BLVD, STE 100 CHARLOTTE, NC 28227 P: 704.537.7300 www.NV5.com NC License # F-1333	

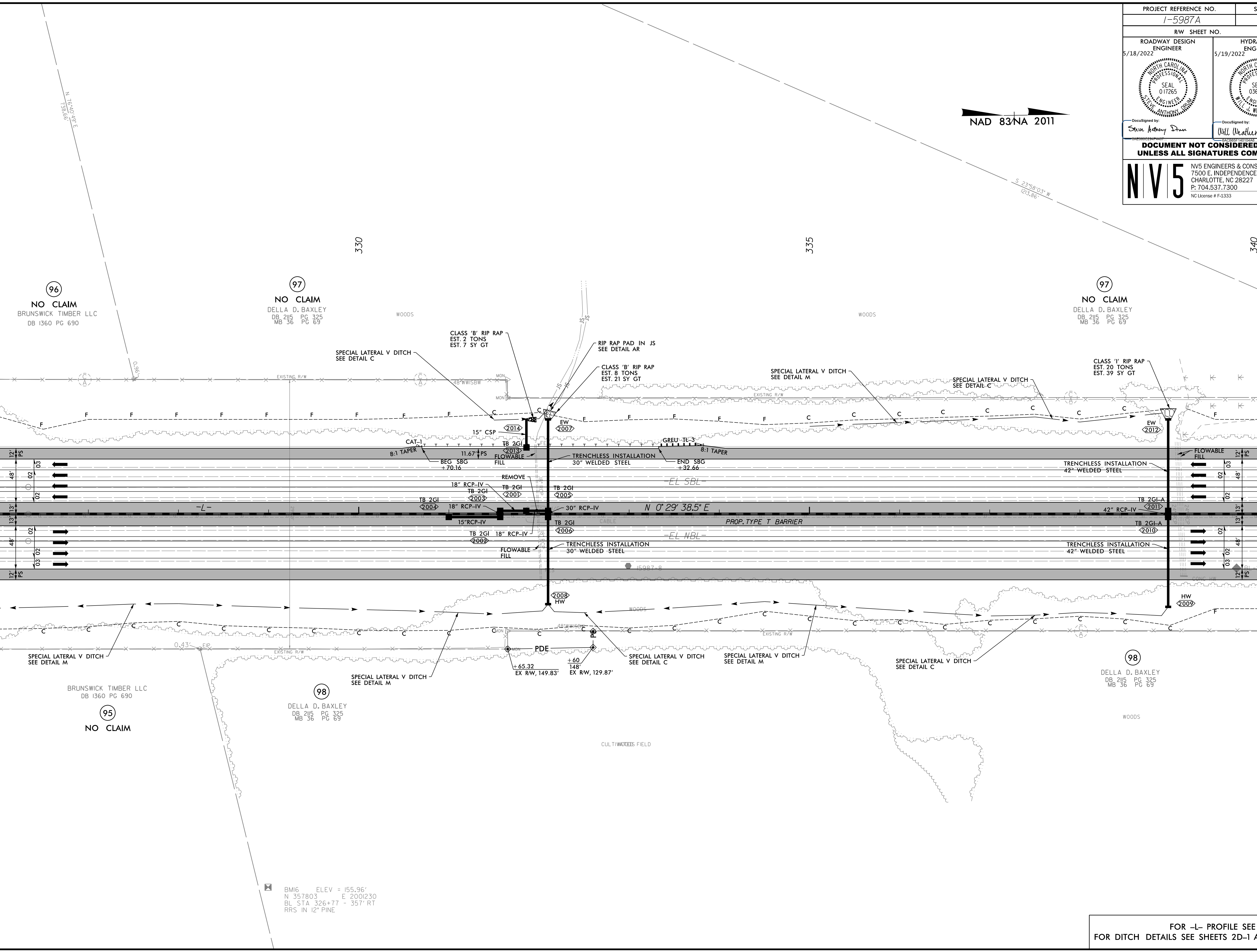

MATCHLINE -L- STA. 326 + 00 SEE SHEET 19

MATCHLINE -L- STA. 340 + 00 SEE SHEET 21



96
NO CLAIM
BRUNSWICK TIMBER LLC
DB 1360 PG 690

97
NO CLAIM
DELLA D. BAXLEY
DB 2115 PG 325
MB 36 PG 69

97
NO CLAIM
DELLA D. BAXLEY
DB 2115 PG 325
MB 36 PG 69

95
NO CLAIM
BRUNSWICK TIMBER LLC
DB 1360 PG 690

98
DELLA D. BAXLEY
DB 2115 PG 325
MB 36 PG 69

98
DELLA D. BAXLEY
DB 2115 PG 325
MB 36 PG 69

BM16 ELEV = 155.96'
N 357803 E 2001230
BL STA 326+77 - 357' RT
RRS IN 12" PINE

FOR -L- PROFILE SEE SHEET 59
FOR DITCH DETAILS SEE SHEETS 2D-1 AND 2D-2

3/30/2022
R:\Projects\15987A_R0Y_PSH_020.dgn
David