

8/17/2022

8/17/2022  
R:\Roadwork\Proj\15987A\_RDY\_PSH\_013.dgn  
Steve Drum

PROJECT REFERENCE NO. <b>1-5987A</b>		SHEET NO. <b>13</b>	
RW SHEET NO.			
ROADWAY DESIGN ENGINEER 6/8/2022		HYDRAULICS ENGINEER 6/8/2022	
<p>DOCUMENT NOT CONSIDERED FINAL UNLESS ALL SIGNATURES COMPLETED</p> <p><b>NV5</b></p> <p>NV5 ENGINEERS &amp; CONSULTANTS, INC. 7500 E. INDEPENDENCE BLVD, STE 100 CHARLOTTE, NC 28227 P: 704.537.7300 www.NV5.com NC License # F-13333</p>			

MATCHLINE -L- STA. 200+00 SEE SHEET 12

MATCHLINE -L- STA. 214+00 SEE SHEET 14

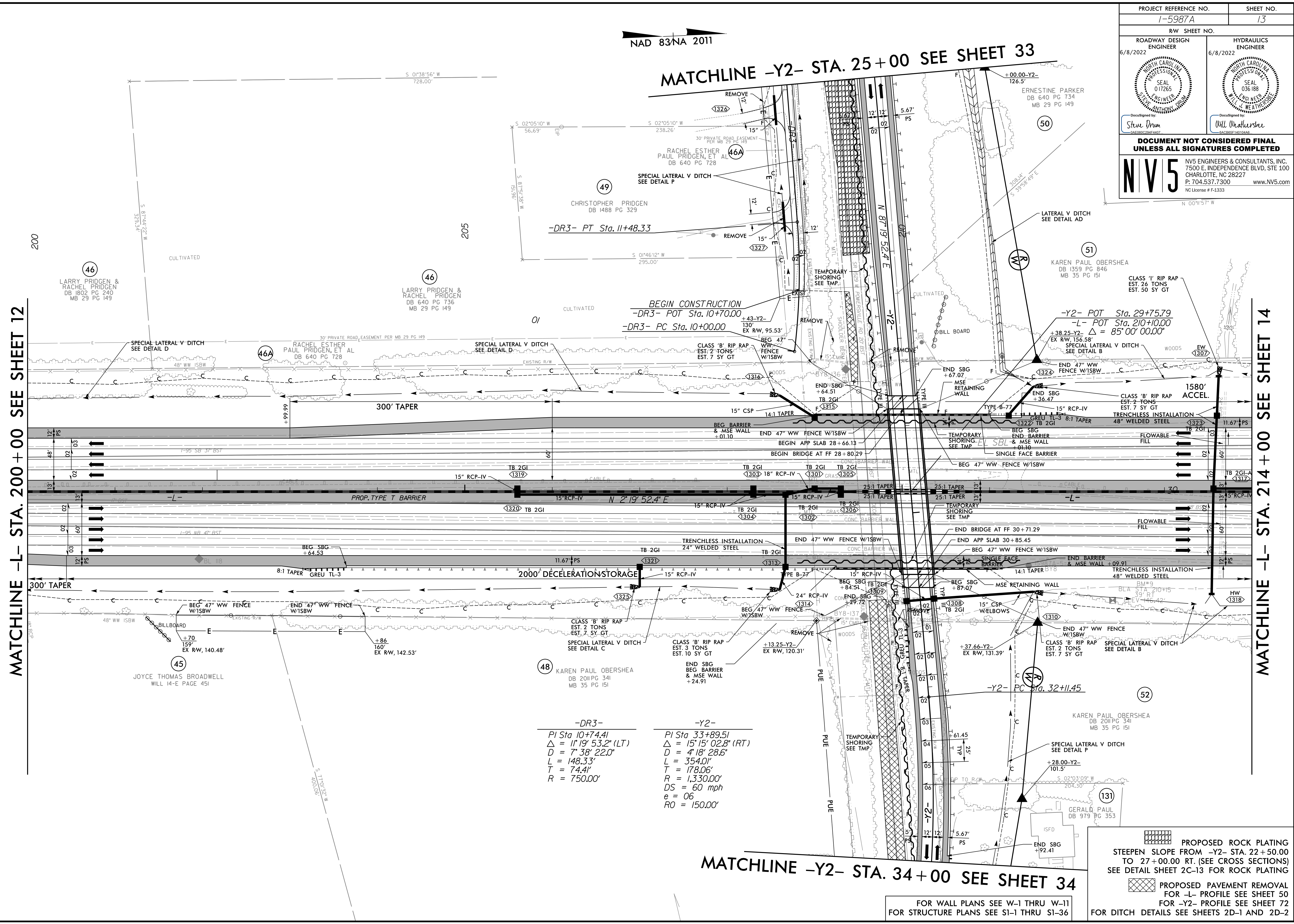

NAD 83/NA 2011

MATCHLINE -Y2- STA. 25+00 SEE SHEET 33

MATCHLINE -Y2- STA. 34+00 SEE SHEET 34

-DR3-  
 PI Sta 10+74.41  
 $\Delta = 11' 19" 53.2" (LT)$   
 $D = 7' 38" 22.0"$   
 $L = 148.33'$   
 $T = 74.41'$   
 $R = 750.00'$

-Y2-  
 PI Sta 33+89.51  
 $\Delta = 15' 15" 02.8" (RT)$   
 $D = 4' 18" 28.6"$   
 $L = 354.01'$   
 $T = 178.06'$   
 $R = 1,330.00'$   
 $DS = 60 \text{ mph}$   
 $e = 06$   
 $RO = 150.00'$

FOR WALL PLANS SEE W-1 THRU W-11  
FOR STRUCTURE PLANS SEE S1-1 THRU S1-36

PROPOSED ROCK PLATING  
 STEEPEN SLOPE FROM -Y2- STA. 22+50.00  
 TO 27+00.00 RT. (SEE CROSS SECTIONS)  
 SEE DETAIL SHEET 2C-13 FOR ROCK PLATING

PROPOSED PAVEMENT REMOVAL  
 FOR -L- PROFILE SEE SHEET 50  
 FOR -Y2- PROFILE SEE SHEET 72  
 FOR DITCH DETAILS SEE SHEETS 2D-1 AND 2D-2