

PROJECT REFERENCE NO. 1-5987A	SHEET NO. 12
RW SHEET NO.	
ROADWAY DESIGN ENGINEER 5/18/2022	HYDRAULICS ENGINEER 5/19/2022
DocuSigned by: Steve Anthony Dean	DocuSigned by: Will Watershe
DOCUMENT NOT CONSIDERED FINAL UNLESS ALL SIGNATURES COMPLETED	
NV5	NV5 ENGINEERS & CONSULTANTS, INC. 7500 E. INDEPENDENCE BLVD, STE 100 CHARLOTTE, NC 28227 P: 704.537.7300 www.NV5.com NC License # F-1333

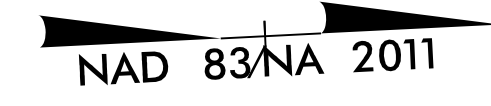

-L-
 PI Sta 180+96.63 PI Sta 189+25.79
 $\Delta = 11' 23" 06.4" (LT)$ $\Theta_s = 0' 44" 38.8"$
 $D = 0' 44" 38.8"$ $L_s = 200.00'$
 $L = 1,530.05'$ $LT = 133.33'$
 $T = 767.55'$ $ST = 66.67'$
 $R = 7,700.00'$
 $DS = 75 \text{ mph}$
 $e = 0.4$
 $RO = 200.00'$

MATCHLINE -L- STA. 186+00 SEE SHEET 11

MATCHLINE -L- STA. 200+00 SEE SHEET 13

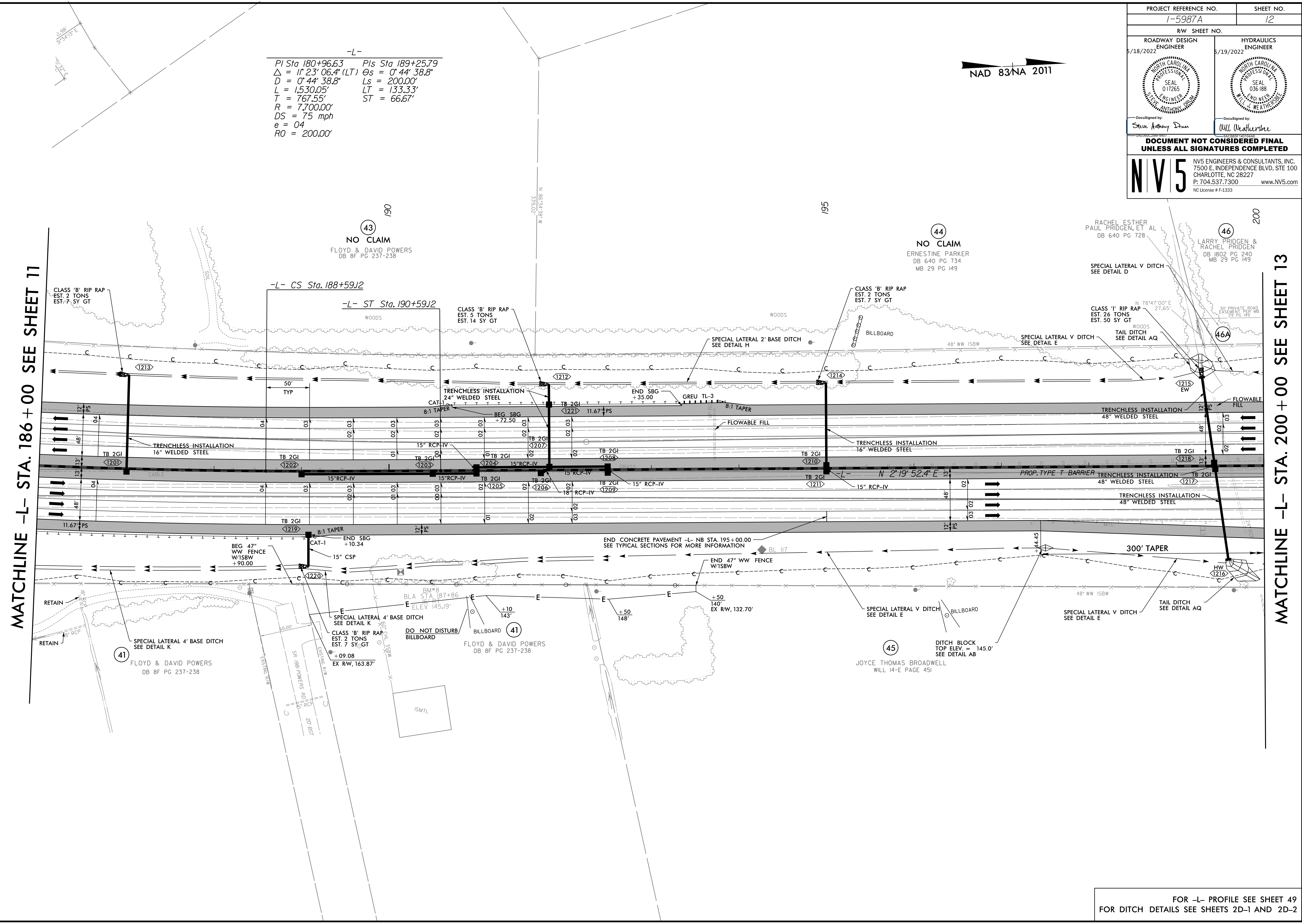

41
 FLOYD & DAVID POWERS
 DB 8F PG 237-238

41
 FLOYD & DAVID POWERS
 DB 8F PG 237-238

45
 JOYCE THOMAS BROADWELL
 WILL 14-E PAGE 451

44
 NO CLAIM
 ERNESTINE PARKER
 DB 640 PG 734
 MB 29 PG 149

43
 NO CLAIM
 FLOYD & DAVID POWERS
 DB 8F PG 237-238

RACHEL ESTHER
 PAUL PRIDGEN, ET AL
 DB 640 PG 728

46
 LARRY PRIDGEN &
 RACHEL PRIDGEN
 DB 1802 PG 240
 MB 29 PG 149

CLASS 'I' RIP RAP
 EST. 26 TONS
 EST. 50 SY GT

CLASS 'B' RIP RAP
 EST. 2 TONS
 EST. 7 SY GT

CLASS 'B' RIP RAP
 EST. 5 TONS
 EST. 14 SY GT

CLASS 'B' RIP RAP
 EST. 2 TONS
 EST. 7 SY GT

300' TAPER

END CONCRETE PAVEMENT -L- NB STA. 195+00.00
 SEE TYPICAL SECTIONS FOR MORE INFORMATION

BEG 47" WW FENCE
 W/15BW
 +90.00

END 47" WW FENCE
 W/15BW

RETAIN

41

41

45

3/30/2022
 R:\Projects\15987A_Proj\15987A_RDY_PSH_012.dgn
 David

FOR -L- PROFILE SEE SHEET 49
 FOR DITCH DETAILS SEE SHEETS 2D-1 AND 2D-2